

**ABSTRACT ESTIMATE FOR THE INTERIOR FURNISHING,  
ELECTRICAL, DATA CABLING AND AIR-CONDITIONING WORKS  
FOR BRANCH AT INDIAN BANK , VIRUDHUNAGAR BRANCH,  
(NEW PREMISES) TAMILNADU.**

**SUMMARY SHEET**

<b><u>Sl.NO</u></b>	<b>Type of work</b>	<b>Amount Quoted (Rs.)</b>
<b>1.</b>	<b>Interior Furnishing Works</b>	<b>Rs.</b>
<b>2.</b>	<b>Electrical Works</b>	<b>Rs.</b>
<b>3.</b>	<b>Data Cabling Works</b>	<b>Rs.</b>
<b>4.</b>	<b>Air Conditioning Works</b>	<b>Rs.</b>
	<b>TOTAL</b>	<b>Rs.</b>
	(inclusive of all taxes and expenses & GST etc.,)	

**(In words: \_\_\_\_\_ .)**

Notice: TENDERERS MUST VISIT THE SITE AND INSPECT FOR THEMSELVES THE ACTUAL WORKS TO BE CARRIED OUT BEFORE SUBMITTING THE TENDER

TENDERERS MUST VISIT THE SITE, INSPECT AND SUBMIT A COMPETITIVE BID FOR THE BUY BACK OF THE EXISTING FURNITURES IN THE RESPECTIVE COLUMNS PROVIDED IN THE TENDER DOCUMENTS.

# INDIAN BANK

## VIRUDHUNAGAR BRANCH (NEW PREMISES)

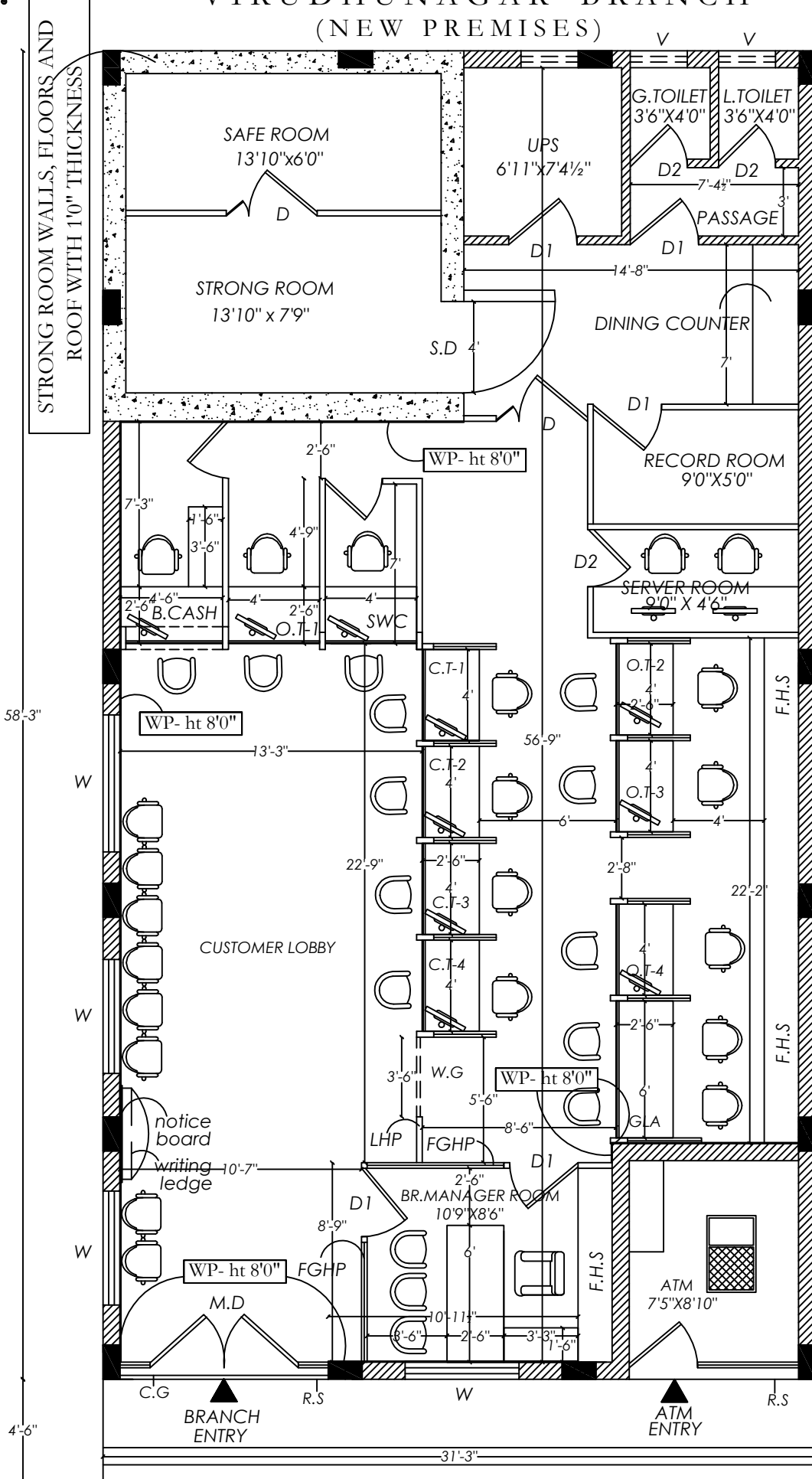

**NOTE:**  
 WINDOW SILL HEIGHT - 3'0"  
 LINTEL HEIGHT - 7'0" & 8'0"  
 ROOF HEIGHT LVL - 11'0"  
 ROOF BEAM BOTTOM LVL - 9'0"

**REFERENCE:**  
 FHGP- FULL HEIGHT GLAZED PARTITION  
 FHP - FULL HEIGHT PARTITION  
 LHP - LOW HEIGHT PARTITION  
 F.H.S - FULL HEIGHT STORAGE  
 G.L.A - GOLD LOAN APPRAISER  
 O.T - OFFICER'S TABLE  
 C.T - CLERICAL TABLE  
 R.S - ROLLING SHUTTER  
 C.G - COLLAPSIBLE GATE  
 W.G - WICKET GATE  
 M.D - MAIN DOOR (6'6" X 7'0")  
 D - DOOR (4'0" X 7'0")  
 D1 - DOOR (3'0" X 7'0")  
 D2 - DOOR (2'6" X 7'0")  
 W - WINDOW (5'0" X 4'0")  
 W1 - WINDOW (3'6" X 4'0")  
 V - VENTILATOR (2'6" X 2'0")

**CARPET AREA DETAILS:**  
 FOR BRANCH : 1536.00 sq.ft  
 BRANCH A/C AREA : 1536.00 sq.ft  
 FOR TOILET : 30.00 sq.ft  
 FOR ATM : 66.00 sq.ft

**TITLE**  
 TENDER DRAWING

DRAWN	- R.M
JOB NO	- 89-19
DATE	-18.05.2019
SCALE	- N.T.S.
SHEET NO	- 01

**MATHURA ASSOCIATES**  
 ARCHITECTURAL & STRUCTURAL CONSULTANT  
 INTERIOR DESIGNS - VALUERS - LANDSCAPE

Contact :  
 99658-81704  
 98006-31864

Proprietor :  
**Ar. D.MADHUKANNAN B.Arch., A.I.A., F.I.V., Mem.C.A.**  
 REGISTERED ARCHITECT - COA  
 EMPANELLED ARCHITECT - INDIAN BANK  
 GOVT. REGISTERED VALUER - INCOME TAX  
 47-B Town Hal Road, 1st Floor, Madurai-625001.

GROUND FLOOR PLAN

# INDIAN BANK

## VIRUDHUNAGAR BRANCH

(NEW PREMISES)

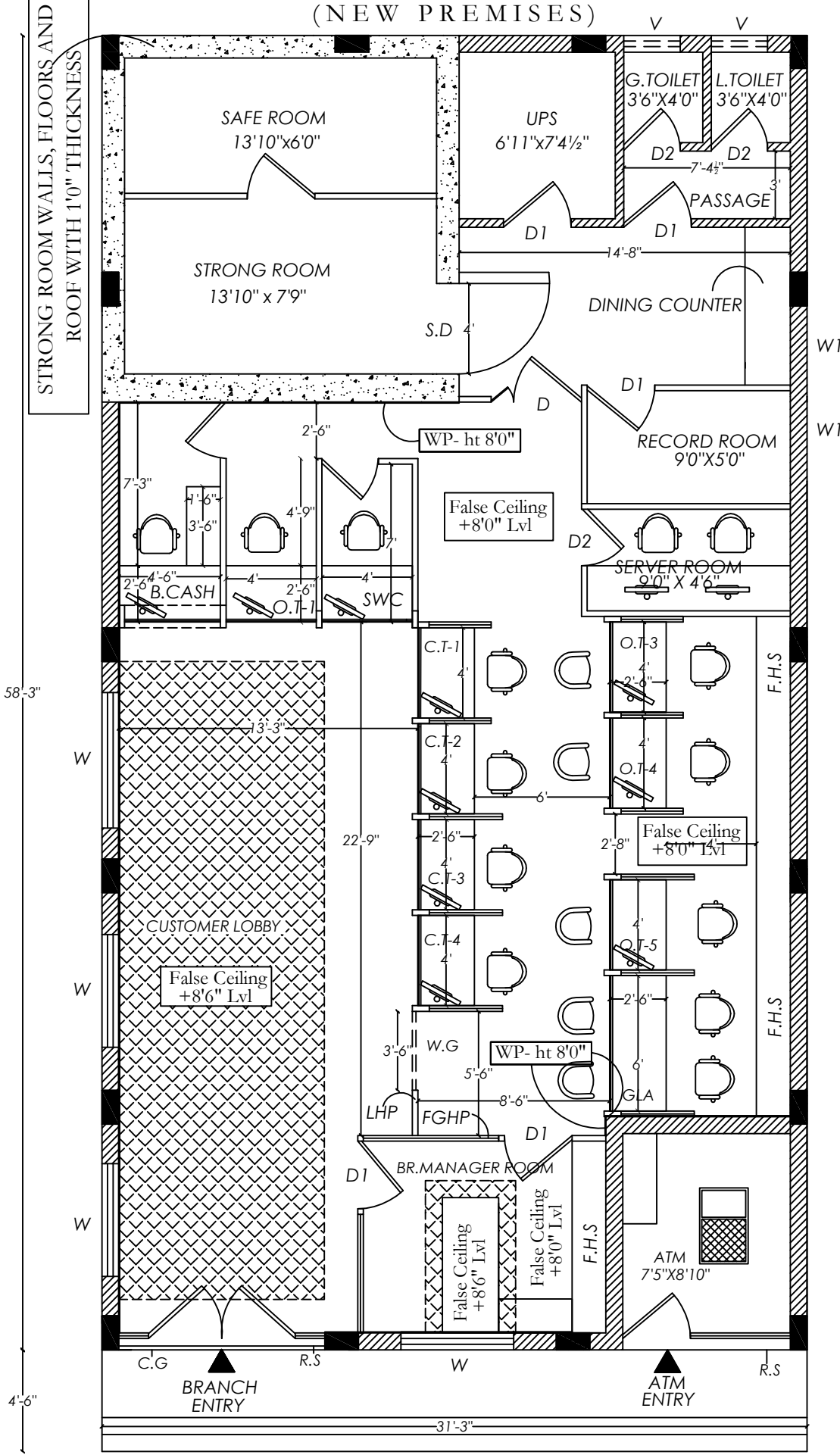

**NOTE:**  
 WINDOW SILL HEIGHT - 3'0"  
 LINTEL HEIGHT - 7'0" & 8'0"  
 ROOF HEIGHT LVL - 11'0"  
 ROOF BEAM BOTTOM LVL - 9'0"

- REFERENCE:**
- FHGP- FULL HEIGHT GLAZED PARTITION
  - FHP - FULL HEIGHT PARTITION
  - LHP - LOW HEIGHT PARTITION
  - F.H.S - FULL HEIGHT STORAGE
  - G.L.A - GOLD LOAN APPRAISER
  - O.T - OFFICER'S TABLE
  - C.T - CLERICAL TABLE
  - R.S - ROLLING SHUTTER
  - C.G - COLLAPSIBLE GATE
  - W.G - WICKET GATE
  - M.D - MAIN DOOR (6'6" x 7'0")
  - D - DOOR (4'0" x 7'0")
  - D1 - DOOR (3'0" x 7'0")
  - D2 - DOOR (2'6" x 7'0")
  - W - WINDOW (5'0" x 4'0")
  - W1 - WINDOW (3'6" x 4'0")
  - V - VENTILATOR (2'6" x 2'0")

**CARPET AREA DETAILS:**  
 FOR BRANCH : 1536.00 sq.ft  
 FOR TOILET : 30.00 sq.ft  
 FOR ATM : 66.00 sq.ft

**TITLE**  
 FALSE CEILING LAYOUT

DRAWN	- R.M
JOB NO	- 89-19
DATE	- 18.05.2015
SCALE	- N.T.S.
SHEET NO	- 02

**MATHURA ASSOCIATES**  
 ARCHITECTURAL & STRUCTURAL CONSULTANT  
 INTERIOR DESIGNS - VALUERS - LANDSCAPE

Contact :  
 99658-81704  
 99606-31864

Proprietor :  
**Ar. D. MADHUKANNAN B. Arch., A.I.A., F.I.V., Mem. C.A.**  
 REGISTERED ARCHITECT - COA  
 EMPANELLED ARCHITECT - INDIAN BANK  
 GOVT. REGISTERED VALUER - INCOME TAX  
 47-B Town Hal Road, 1st Floor, Madurai-625001.

**GROUND FLOOR PLAN**

# INDIAN BANK

## VIRUDHUNAGAR BRANCH (NEW PREMISES)

STRONG ROOM WALLS, FLOORS AND ROOF WITH 1'0" THICKNESS

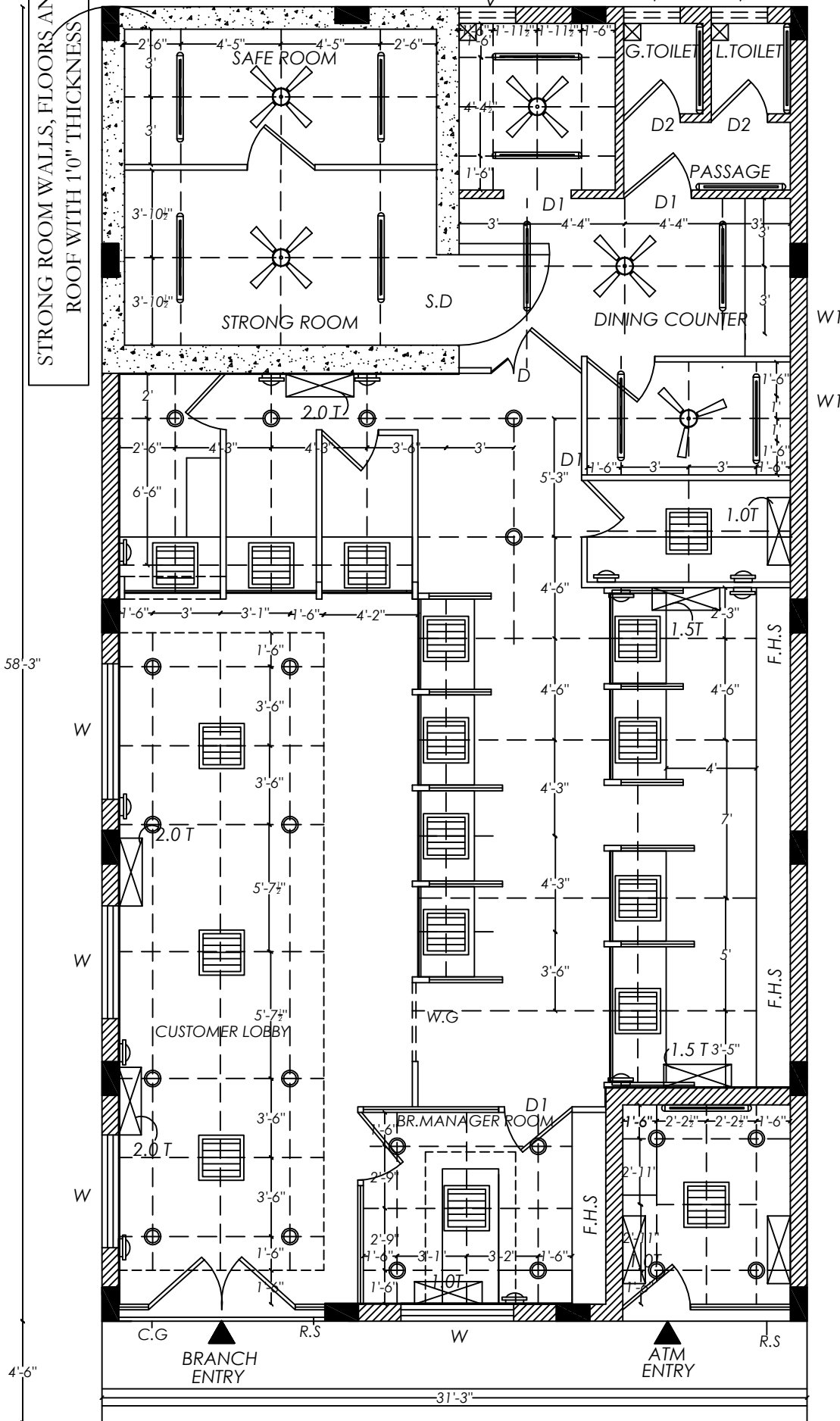

**NOTE:**  
 WINDOW SILL HEIGHT - 3'0"  
 LINTEL HEIGHT - 7'0" & 8'0"  
 ROOF HEIGHT LVL - 11'0"  
 ROOF BEAM BOTTOM LVL - 9'0"

- LEGEND:**
- A/C - 2 Ton - 3 Nos.
  - A/C - 1.5 Ton - 2 Nos.
  - A/C - 1 Ton - 2+2 Nos.
  - Wall mounted fan - 12 Nos
  - Recessed down light LED (2 x 18 W) - 17+4 Nos
  - Exhaust fan - 3 Nos
  - 3' Ceiling fan - 1 No
  - 4' Ceiling fan - 4 Nos
  - Tubelight - 13 Nos
  - 2'0" x 2'0" LED Recessed 16+1 Nos

**CARPET AREA DETAILS :**  
 FOR BRANCH : 1536.00 sq.ft  
 FOR TOILET : 30.00 sq.ft  
 FOR ATM : 66.00 sq.ft

**TITLE**  
 ELECTRICAL LAYOUT

DRAWN	- R.M
JOB NO	- 89-19
DATE	- 18.05.2019
SCALE	- N.T.S.
SHEET NO	- 03

**MATHURA ASSOCIATES**  
 ARCHITECTURAL & STRUCTURAL CONSULTANT  
 INTERIOR DESIGNS - VALUERS - LANDSCAPE

Contact :  
 99658-81704  
 99006-31864

Proprietor :  
**Ar.D.MADHUKANNAN B.Arch.,AIIA.,FIV.,Mem.C.A.**  
 REGISTERED ARCHITECT - COA  
 EMPANELLED ARCHITECT - INDIAN BANK  
 GOVT. REGISTERED VALUER - INCOME TAX  
 47-B Town Hal Road, 1st Floor, Madurai-625001.

**GROUND FLOOR PLAN**

**PROPOSED INTERIOR FURNISHING WORK FOR INDIAN BANK  
VIRUDHUNAGAR BRANCH, (NEW PREMISES) - BILL OF QUANTITIES**

Sl. No	Particulars	Qty	Unit	Rate (Rs)	Amount (Rs)
	<b>INTERIOR/FURNISHING WORKS</b>				
1	<p><b>Full height partitions with glass panels for manager cabin :</b> Supplying and fixing glazed partitions using aluminium section of size 2"x2" frame work having 2'x2' square grid on both sides covered with 8mm marine ply wood of approved make and finished with 1.5mm thk lamination which is to be used as per the drawing mentioned. Partitions frame is to be fixed properly to the roof slab, white wood lipping with white cedar finish to be fixed to fix the 12mm thk glass with etching for full height partition. A glazed door has to be provided as per the drawing with <b>door closer and locks of godrej make.</b>(the partitions area given below the false ceiling level cost includes for aluminium frame to be extended and fitted up to roof ceiling. <b>Doors</b> to be made out of 10mm thk glass with etching as per the design glass with etching has to be fixed on aluminium channel the bottom frame size is 6"x1½" and vertical frame size is 3'x1½" and the top frame size is 4"x1½" the aluminium frame shall be covered with 8mm plywood with 1.5mm thk lamination which is to be used as per the drawing mentioned the cost include 5" brass hinges(4nos/door) and door handle as approved by architect. <b>Partition size : (11'0"+8'9" )X 8'0"</b></p>	<b>158.00</b>	/ Sq.ft		
2	<p><b>Glazed partitions with entrance door:</b> Supply and fixing of first class <b>Burma teak wood</b> Main door frame of size 6'6"x 7'0". Main entrance consists of two fixed glass and two doors as per drawing. Main frame specifications-4"x3".Supply and fixing burma teak wood door(2nos) frame size 5"x2½"side and top and 6"x2½" at bottom, stainless steel 1'0" ht handles to be fixed on both sides with <b>door closer and lock of godrej make.</b> 12mm thk glass with edging is to be fixed on the door frame. Proper teak wood lipping is to be provided to fix the 12mm thk glass. Cost includes brass hinges 5"-8Nos with 10" brass tower bolt-4Nos. All round with locker polish of approved shade and colour.2" teak wood lipping is to be</p>				

<p><b>3a</b></p>	<p>provided on outer frame all sides. <b>Door size (6'6"X7'0")</b></p> <p><b>Cash cabin partition with Table Partition</b></p> <p>Providing and fixing in position of 2"x2" aluminium section (2feetx2feet grid)both side covered with 8mm thk marine ply wood and finished with 1.5 mm thk lamination which is to be used as per the drawing mentioned. Cash cabin size is 5'0"x8'0".White wood lipping with white cedar finish to be fixed to fix the 12mm thk glass with etching for cash counter partition. Cash counter 6'3" ht consists of plywood/glass partition with provision of opening at customer side and clerical side as per drawing. <b>Door</b> to be made out of 10mm thk glass with etching as per the design glass with etching has to be fixed on aluminium channel the bottom frame size is 6"x1½" and vertical frame size is 3'x1½" and the top frame size 3"x1½" the aluminium frame shall be covered with 8mm plywood with1.5mm thk lamination with <b>godrej night latch and godrej door closer</b>. White wood lipping with white cedar finish is to be used to fix the 10mm thk glass with etching as per the drawing mentioned. The cost includes 5" brass hinges-3Nos and door handle as approved by architect. door size(2'6"x6'3")</p> <p><u>Table height2'6"</u></p> <p>The table having 25mm thk machine made post formed top with side and front side drop made of 18mm thk ply wood and drawer units/shutter made of 18mm plywood. All exposed area is finished with 1.5mm thk lamination of which is to be used as per the drawing of approved make. For keyboard drawer and table drawers/shutters <b>set lock (godrej)</b>, stainless steel handles to be provided. Shutter is to be fitted with SS hinges of approved make to be provided for each clericals table. Front side edges of table/drops (clerical side) are to be finished with white wood with white cedar finish painting with one coat of primer and two coats of paint after doing patty is to be undertaken inside the drawer/shutter/table inner side. Powder coated metal key board of good quality is to be provided.</p> <p>25mm thk table machine made post formed top <b>4'6"x2'6"-1No</b></p> <p>25mm thk table machine made post formed top <b>4'0"x2'6" – 1 No</b></p>	<p><b>46.00</b> <b>Sq.ft</b></p>	<p>/ sq.ft</p>		
		<b>1 No</b>	1 No		
		<b>1No</b>	<b>1 No</b>		

4	<p>Front &amp; side partition with door as per drawing</p> <p>Front side (4'6"X4'6")+(4'0"X4'6") x 1No</p> <p>Side partition (10'0"X7'0") 1No +(7'6"X7'0") 2Nos</p> <p>Top side (4'9"+4'0") x1'6"</p> <p>Wall side (1'6"x7'0") 1No</p>	<p><b>237.00</b> <b>Sq.ft</b></p>	<p>/ sq.ft</p>		
5	<p>Aluminum grills for cash cabins (4'9"x9'9") + (7'3"x4'6")</p>	<p><b>79.00</b> <b>Sq.ft</b></p>	<p>/ sq.ft</p>		
6	<p><b>Clerical/officer table-25mm thk Machine made post formed table top and side table top</b> <u>Table height 2'6"</u> The table having 25mm thk machine made post formed top with side and front side drop, bottom base made of 18mm thk plywood and drawer units /shutter made of 18mm plywood. All exposed area is finished with 1.5mm thk lamination of which is to be used as per the drawing of approved make. For keyboard drawer and table drawers/shutters set lock (godrej), stainless steel handles to be provided. Shutter is to be fitted with SS hinges of approved make to be provided for each clericals table. Front side edges of table/drops(clerical side) are to be finished with white wood with white cedar finish painting with one coat of primer and two coats of paint after doing patty is to be undertaken inside the drawer/shutter/table inner side. For the customer side of clerical table 12mm glass partition with edging of 1'3" ht to be fixed above the table using metal clamp to be fixed on side partitions /front pillar partition to be fixed between tables. The front pillar partition is to be made with 2"x2" aluminium section both side covered with 8mm thk marine ply wood and finished with 1.5mm thk lamination as per drawing. The last table –side partition size4'6" htx4'0" customer side and 3'6" ht clerical side supported with 2"x2" aluminium section both side covered with 8mm thk marine plywood and finished with 1.5mm thk lamination as per drawing at the bottom and at top table 12mm thk edged glass fixed with metal clamp.</p> <p>Table with 25mm P/F table top 6'0" X 2'6" - 1 No (Mr.)</p> <p>Table with 25mm P/F table top 6'0" X 2'6"-1No (GLA)</p> <p>Table with 25mm P/F table top 4'0"X2'6"- 8 No (C.T –1, TO C.T - 4, O.T-1 TO O.T- 4)</p> <p>Table with 25mm P/F Side table top (3'3"x1'6") -1 No (3'6"x1'6")- 1 No (Mr, C/C)</p> <p>Table with 25mm P/F table top 4'6" X 2'0"- 2No</p> <p><b>SERVER TABLE</b></p>	<p><b>1No</b></p> <p><b>1No</b></p> <p><b>8 No</b></p> <p><b>2 Nos</b></p> <p><b>2 Nos</b></p>	<p>1No</p> <p>1No</p> <p>1No</p> <p>1No</p> <p>1No</p>		

7	<b>Dining counter Table</b> with 25mm P/F table top <b>7'0"X 2'0"- 1No</b> (with low height storage covered with shutters and foot rest, etc.,)	<b>1No</b>	1No		
8	<b>Storage Unit(Full height)</b> Providing and fixing 1'6" wide storage unit made of 18 mm marine plywood finished with 1 mm lamination of approved colour & pattern on top and all visible sides with shelves inside laminated with <b>0.8mm laminate</b> . All exposed edges are finished with hardwood lipping. Provided openable shutters with SS handles, lock and auto closing hinges as per design. <b>Size:( 8'6"+22'3") X 8'0" (Depth-1'6")</b>	<b>246.00 Sq.ft</b>	/ sq.ft		
9	<b>Front pillar partition</b> 4 Nos & side partition with glass <b>(3'6"X4'0") 11 Nos</b>	<b>154.00 Sq.ft</b>	/ sq.ft		
10	<b>Full Height Partition with Glass Door:</b> Supplying and fixing <b>PLYWOOD</b> partitions using aluminium section of size 2"x2" frame work having 2'x2' square grid on both sides covered with 8mm marine plywood of approved make and finished with 1.5mm thk lamination which is to be used as per the drawing mentioned. Partitions frame work to be fixed properly to the roof slab. A glazed door has to be provided as per the drawing with door closer and locks of Godrej make. <b>Doors</b> to be made out of 10mm thk glass with etching as per the design glass with etching has to be fixed on aluminium channel the bottom frame size is 6"x1½" and the vertical frame size is 2½"x1½" and the top frame size is 4"x1½" the aluminium frame shall be covered with 8mm plywood with 1.5mm thk lamination which is to be used as per the drawing mentioned. The cost include 5" brass hinges (4 nos) and door handle as approved by architect. Door size 3'0"X 7'0" Partition size : <b>(5'6"+5'3"+9'3"+14'0"+9'3") x 11'0" (5'0"+9'3"+1'3"+1'3") X 8'0" LHP: (2'0"X 4'0")</b>	<b>618 Sq.ft</b>	/ sq.ft		
11	<b>Fixing of glass</b> Glass with all side edging is to be fixed in between pillar partition on the table top using SS clamp as per drawing. 12mmthk glass of size <b>4'0" X 1'3" - 8 Nos</b> <b>4'0" X 0'9" - 8 Nos</b>	<b>8 Nos</b> <b>8 Nos</b>	1 No 1No		



12	<p><b>False ceiling(Gypboard)</b>  Supplying and fixing of gypsum/star board panel false ceiling using galvanized sections for hanging and holding the gypsum/star board panels of 12mm thk duly painted with 3 coats of plastic emulsion paints after necessary putty works provision are to be made for fixing of A.C. grills, light fittings as per the consultant instructions the cost including making holes and to assist in fixing the same etc.</p>	<p><b>1210.00</b>  <b>sq.ft</b></p>	<p>/ sq.ft</p>		
13	<p><b>CORNICE</b> length</p>	<p><b>98.00</b>  <b>Rft</b></p>	<p>Rft</p>		
14	<p><b>Writing ledge/challon holder</b>  Fabricating and fixing of writing ledge and challon holder made of 12mm glass supported with marine plywood stand finished with lamination glass edges beveled to half round safe suitably supported on ply wood as per drawing.</p>	<p><b>1No</b></p>	<p>1No</p>		
15	<p><b>Notice board</b>  Fabricating and fixing of notice board made of teak wood frame filled with soft board and covered with fabric, a color of the fabric to be math the décor the outer frame of the notice board is to be finished with locker polish.  (size 4'0"x3'0")</p>	<p><b>1No</b></p>	<p>1No</p>		
16	<p><b>Wicket door (3'6"x4'0")</b> 1No</p>	<p><b>14.00</b>  <b>Sq.ft</b></p>	<p>/ sq.ft</p>		
17	<p><b>Colour Washing:</b>  Applying two coats of <b>interior grade emulsion paint</b> of approved colour to internal walls and ceiling including labour charges, cost and conveyance of material etc complete.</p>	<p><b>2051.00</b>  <b>Sq.ft</b></p>	<p>/ sq.ft</p>		
18	<p><b>Painting</b> Entrance grill gate and Rolling Shutter etc., using <b>synthetic enamel paint</b> two coats of approved colour including all frameworks and related elements after removing the existing paint with sand paper and thereafter cleaning the surface including all labour charges, material charges etc complete.</p>	<p><b>260.00</b>  <b>Sq.ft</b></p>	<p>/ sq.ft</p>		
19	<p><b>Wall paneling :</b>  Aluminum section of size 2"x1" (grid 2'0"x2'0") frame work and covered with 8mm commercial plywood (one side fixing) finished in lamination. The paneling area given below the false ceiling level. Cost includes for</p>				

	aluminum frame to be extended and fitted up of roof ceiling. (42'0"+15'0"+4'6"+6'9"+1'0"+11'0"+0'9") x 8'6" Ded (5'0"x4'0") x 4 Nos	<b>609.00 Sq.ft</b>	/ sq.ft		
<b>20</b>	Providing and fixing <b>Cheque Drop Box</b> of size (1'6" x 1'6"x 1'0")	<b>1No</b>	1No		
<b>21</b>	Providing and fixing <b>Entrance Door ply Box</b> of size (9'3" X 2'9" )	<b>25 Sq.ft</b>	/ sq.ft		
<b>22</b>	Providing and fixing <b>Entrance Rolling shutter coverage box with lamination</b> of size (10'9"x6'0")+ (1'6"x 4'0" ) x 2No.	<b>77 Sq.ft</b>	/ sq.ft		
<b>23</b>	Providing and fixing <b>vertical blinds</b> for all windows Colour and materials selection by the Architect, Rates including material cost and labour charges etc. complete. (6'0"x4'6") 4 Nos.	<b>108.00 Sq.ft</b>	/ sq.ft		
<b>24</b>	<b>Shutters Above Loft :</b> Providing and fixing 19mm thk. BWR ply shutters with ply frame. Division of shutters shall be made equally according to the length of the loft. Shutters shall be hinged to the framework and finished with 1.0mm thk. Laminate of approved shade from outside, applied with approved oil paint from the inside and edges of shutters with steam beach lipping. Rate shall be inclusive of all necessary approved fittings like hinges, ball catch, handle, and any necessary hardware items. (7'9"x4'0")	<b>31.00 Sq.ft</b>	/ sq.ft		
	<b>TOTAL</b> (inclusive of all taxes and expenses & GST etc.,)				

**PROPOSED ELECTRICAL WORK FOR INDIAN BANK VIRUDHUNAGAR  
BRANCH (NEW PREMISES) - SCHEDULE OF QUANTITIES**

No	Description of work	Size/qty	Unit	Rate	Amount
<b>1</b>	Supply and laying of following size of original <b>FINOLEX</b> PVC insulated <u>copper wire</u> in suitable PVC conduit of 2mm thk with necessary PVC accessories like elbows, bends etc, necessary clappings				
<b>a</b>	4 x 6 sqmm + 1 x 4 sqmm from Main MCB DB to UPS input cost of 4 x 6sqmm wire & } 1 x 4 sqmm wire } Cost of PVC conduit pipes } Laying/fixing charges }	<b>10M</b>	1M		
<b>b</b>	<u>BM &amp; SERVER cabin one AC machine each</u> Cost of 2 x 4 sqmm wire 1 x 1.5 sqmm wire Cost of PVC conduit pipes Laying/fixing charges	<b>55M</b>	1M		
<b>c</b>	<u>Banking Hall 5AC machine</u> Cost of 2 x 4 sqmm wire } 1 x 1.5 sqmm wire Cost of PVC conduit pipes Laying/fixing charges	<b>110M</b>	1M		
<b>d</b>	2 x 4 sqmm + 1 x 2.5 sqmm from UPS output to UPS output main MCB DB & UPS output circuits DBs Cost of 2 x 4 sqmm wire & } 1 x 2.5 sqmm wire } Cost of PVC conduit pipes } Laying/fixing charges }	<b>20M</b>	1M		
<b>e</b>	3 x 2.5 sqmm from UPS output to circuit DBs to UPS points (three circuits) Cost of 3 x 2.5 sqmm wire & } Cost of PVC conduit pipes ) Laying charges }	<b>270M</b>	1M		

2a	Supply and fixing of 2 x 4 sq.mm and 1 x 2.5 sq.mm <b>original FINOLEX</b> copper wire in PVC conduit of 2mm thk from change over switch to generator point	<b>40M</b>	1M		
b	Supply and fixing of 15 A switch plug and socket with suitable surface mounted box. ( <b>make - ANCHOR ROMA</b> )	<b>5Nos</b>	1No		
3a	Supply and laying for 3.5 X 70 sq.mm aluminium armoured cable for EB meter to Main DB	<b>50M</b>	1M		
b	Supply & fixing of <b>HAVELL'S</b> make following 8way 3phase vertical type double door <b>MCCB</b> DBs in suitable MS enclosures with necessary interconnection main MCCB DB MS Enclosures -1No 100Amps MCCB -1No 63Amps 3pole MCB -7Nos SP 40Amps MCB -12Nos	<b>1No</b> <b>1No</b> <b>7Nos</b> <b>12Nos</b>	1No 1No 1No 1No		
c	UPS INPUT MAIN MCB DB <b>HAVELL'S</b> make with MS enclosure 63Amps 4pole MCB	<b>1set</b>	1set		
d	UPS OUTPUT MAIN MCB DB <b>HAVELL'S</b> make Double door single phase 8way with MS enclosure -1 40Amps 2pole MCB -1 SP 10 Amps MCB -6	<b>1No</b> <b>1No</b> <b>6Nos</b>	1No 1No 1No		
e	Supply & fixing of <b>HAVELL'S</b> make following 8way three phase vertical type double door MCB DBs in suitable MS enclosures with necessary interconnection main MCB DB for lighting MS Enclosures 63 Amps 4 pole MCB	<b>1No</b> <b>1No</b>	1No 1No		

	SP 25 Amps MCB	<b>12Nos</b>	1No		
<b>4a</b>	Change over with phase shifter Supply & Installation of 32Amps 4 pole change over switch for generator - ( <b>HAVELL'S make</b> )	<b>1No</b>	1No		
<b>b</b>	Supply & providing of indicating lamps (3Nos) in suitable box phase selector 3 phase( <b>HAVELL'Smake</b> )	<b>1set</b>	1set		
<b>c</b>	Supply and laying of 2pair Telephone cable ( <b>HAVELL'S</b> ) suitable PVC pipe/channel cost of cable cost of PVC pipe Laying charges	<b>250M</b>	1M		
<b>d</b>	Supply & installation/fixing of Modular type RJ11 Telephone sockets( <b>MK make</b> )	<b>15Nos</b>	1No		
<b>e</b>	Supply, installation and testing of dedicated earth pit for UPS as per standard using 600mm x 600mm x 3mm copper thick. The rate should include excavation, salt and charcoal powder, brick work 450mm x 450mm, cast iron cover/plate etc of & providing of copper plate ear thing as per standard for dedicated earth pit for UPS	<b>1set</b>	1set		
<b>f</b>	Supply & laying of <b>FINOLEX</b> 6sqmm copper wire within 20mm GI pipe from earth electrodes to the UPS	<b>25M</b>	1M		
<b>5a</b>	Supply & fixing of 3Nos 6amp socket with 2Nos.6amp switch in suitable surface mounted box. -UPS Power ( <b>make -ANCHOR ROMA</b> )	<b>16Nos</b>	1No		
<b>b</b>	Supply & fixing of 1Nos 6amp socket with 1Nos.6amp switch in suitable surface mounted box for Wall Fan and	<b>27Nos</b>	1No		

c	Officer Table. - (make -ANCHOR ROMA ) Supply & fixing of 2Nos 6amp socket with 1Nos.15amp switch in suitable box for Raw Power-Modular type- <b>MK make</b>	<b>12Nos</b>	1No		
6a	Supply and fixing of original <b>FINOLEX</b> 4 x 4 sq.mm + 1 x 2.5 sqmm copper wire in PVC conduit of 2mm thick from Main MCB DB to generator change over and from changeover to lighting board	<b>30M</b>	1M		
b	Supply and fixing <b>HAVELL'S</b> 20A Metal clad plug and socket for AC unit	<b>7Nos</b>	1No		
7	<b>Point wiring:</b> Point wiring for light,fan, 6A switched sockets with ( <b>FINOLEX / ANCHOR</b> ) 2R 1.5 Sqmm FRLS insulated multi strand single core copper conductor wire drawn in 20mm dia 2mm thick PVC conduit to be laid on false ceiling by clamping with GI clamps, concealed on wall and RCC roof etc with all accessories like conduit bends, junction boxes etc. The work also involves supply and fixing of 6A modular switch housed in manufacture's zinc passivated MS box to be concealed to wall.				
a	One light point controlled by one switch	<b>44Nos</b>	1No		
b	Two light controlled by one switch	<b>5Nos</b>	1No		
c	Fan point with fan hook	<b>5Nos</b>	1No		
d	6A switch box sockets in the switch board itself	<b>8Nos</b>	1No		
e	Supply and installation of 2R 2.5 Sqmm FRLS multi strand copper wire drwn in 20mm PVC conduit				

	2mm thick to be laid concealed on wall between DBs and switch boxes including terminations at both ends <b>(UPS &amp; RAW POWER CIRCUIT)</b>	<b>320M</b>	1M		
<b>9</b>	<b>LIGHT FIXTURE :</b> (Make – Philips / Wipro / Bajaj / Pierlite )				
<b>a</b>	Supply of commercial recessed mounted 36W LED luminates comprises of CRCA housing powder coated in white the LED cluster are PMMA diffuser uniform glare-free light distribution suitable for 600mmx600mm coiling and operating voltage 240V input current 0.140 – 0.160 AMP input wattage 33-37W	<b>16 Nos</b>	1 No		
<b>b</b>	Supply of ISW LED down lighter comprises of aluminium dia cast housing and ring finished white powder coated with high translucent frosted PMMA diffuser operation voltage 240V input current 0.06-0.075 AMP input wattage 14.5-15.5W	<b>17Nos</b>	1 No		
<b>c</b>	1 X 28 With Patti Light Fixture.	<b>13 Nos</b>	1 No		
<b>d</b>	48”-3 & 36”-3 Ceiling Fan of Crompton / Usha / havells / Bajaj make.	<b>5 Nos</b>	1 No		
<b>e</b>	Battern Holder with 11 Watts CFL Retrofit.	<b>2 Nos</b>	1 No		
<b>f</b>	Wall mounted Fan Crompton / Usha / havells / Bajaj make.	<b>12 Nos</b>	1 No		
<b>g</b>	Exhaust Fan havells / Crompton / Almonard make.	<b>3Nos</b>	1 No		
	<b>TOTAL</b> (inclusive of all taxes and expenses & GST etc.,)				

**PROPOSED DATA CABLING WORK FOR INDIAN BANK**  
**VIRUDHUNAGAR BRANCH, (NEW PREMISES) - BILL OF QUANTITIES**

No	Description of work	Qty	Unit	Rate	Amount
<b>1</b>	Supply & laying of <b>CAT 6</b> Data Communication cable in 2mm thk heavy duty 20mm dia PVC conduit and making holes in the partitions / wall all accessories as required (DLink)	<b>230m</b>	M		
<b>2</b>	Supply & Installation, Testing & Commissioning of Modular type 1Nos of RJ45 Female Jack housed in PVC box with suitable Face plate fixing the same in the wall / partition with all accessories etc.,as required.	<b>14</b>	/ Set		
<b>3</b>	Supply and fixing of 1M Mounting <b>CAT -6</b> Cord	<b>14</b>	/ Set		
<b>4</b>	Supply and fixing of 2M Mounting <b>CAT -6</b> Cord	<b>14</b>	/ Set		
<b>5</b>	Supply & Installation of 24 port SWITCH	<b>1</b>	/ Set		
<b>6</b>	Supply & Installation of 24 port <b>CAT 6</b> Jack Panel	<b>1</b>	/ Set		
<b>7</b>	Supply & Installation of 9u Wall mounting Server rack	<b>1</b>	/ Set		
	<b>TOTAL</b> (inclusive of all taxes and expenses)				



**PROPOSED SCHEDULE FOR AIR-CONDITIONING WORKS AT INDIAN  
BANK VIRUDHUNAGAR, BRANCH (NEW PREMISES),**  
**PROPOSAL FOR NEW GENERATION PACKAGED AC's / DUCTED SPLIT AC's  
FITTED WITH POWER SAVER SCROLL COMPRESSORS.**

**BASIS OF DESIGN**

- |                               |   |  |
|-------------------------------|---|--|
| 1. Area to be air conditioned | : | 1105.00 Sq.ft  |
| 2. Outside Design conditions  | : | 100 F DB and 83 F WB   |
| 3. Inside Design conditions   | : | 75 F + 2 % DB and RH<br>Not exceeding 50%  |
| 4. Lighting Load              | : | 1 watts per Sq.ft  |
| 5. Equipment Load             | : | 8 Computers + Printers   |
| 6. Occupancy Factor           | : | 45 persons   |
| 7. Fresh Air                  | : | One Air changes per Hour   |
| 8. Power Supply               | : | 415 V, 50 Hz, 3 PH   |
| 9. Exposed Glass              | : | To be shaded by using sun control<br>films or by thick curtains.   |
| 10. Exposed Roof              | : | To be insulated by 50 mm thick<br>TF quality thermocole or equivalent<br>Material. (In case of exposed roof) |

**SCOPE OF WORK**

Sl. No	Description of work	Size/qty	Unit	Rate	Amount
1	<p><b>AIR CONDITIONING WORKS</b>  Supply, installation, Testing and commissioning of indoor and outdoor split air conditioner with remote control, with 3 STAR rating units including stabilizer (Make : Everest) and necessary civil works etc., The rate of units and is including the supply and laying of 3 mts of copper pipes with insulations, rubbers, white cements etc.,  MAKE: Voltas, Blue Star, Carrier.</p> <p>2.0 TR- 3 for Customer Lobby, &amp; Banking Hall  1.0 TR- 2 for Branch Manager Cabin  1.5 TR- 2 for Branch Manager Cabin</p>	<p><b>3</b> <b>2</b> <b>2</b></p>	<p>Nos Nos Nos</p>		
2	<p><b>ANCILLARY WORKS;</b>  Supply and laying of copper pipes with rubber insulations, rubber, white cements, wall concealing works, etc.,  2.0 TR- 3 for Customer Lobby, &amp; Banking Hall  1.0 TR- 2 for Branch Manager Cabin &amp; Server  1.5 TR- 2 for Banking hall</p>	<p><b>15</b> <b>12</b> <b>16</b></p>	<p>Mtr Mtr Mtr</p>		
3	<p>Supply, installation, of Outdoor Stand with necessary civil works, etc.,</p>	<p><b>7</b></p>	<p>Nos</p>		
4	<p>Supply and laying of PVC Blue pipes for water drain from the indoor units with necessary wall concealing works, putty works, etc.,</p>	<p><b>60</b></p>	<p>Mtr</p>		
<p style="text-align: center;"><b>TOTAL</b> (inclusive of all taxes and expenses &amp; GST etc.,)</p>					