



PREMISES, ESTATE & EXPENDITURE DEPARTMENT,
CORPORATE OFFICE, NO: 254-260,
AVVAI SHANMUGAM SALAI,
CHENNAI – 600014.

**TENDER DOCUMENT - PROPOSED CIVIL & ALLIED WORKS IN
INDIAN BANK PREMISES
AT FIRST FLOOR, GEE GEE COMPLEX ,
NO.:42,ANNA SALAI, CHENNAI - 600002**

Ref.No: CO:EST:CAPC -02
Date : 04.01.2021

Name of the contractor:

.....
.....
.....

Last date of submission of tenders	12.01.2021 upto 15.00Hrs. at Indian Bank, Corporate Office, Premises, Estate & Expenditure dept, First Floor, No. 254-260, Avvai Shanmugam Salai, Royapettah, Chennai – 600 014.
Date of opening Tender	12.01.2021 upto 15.30Hrs . at Indian Bank, Corporate Office, Premises, Estate & Expenditure dept, First Floor, No. 254-260, Avvai Shanmugam Salai, Royapettah, Chennai – 600 014.
Cost Of Tender	Free Of Cost.

This Tender document contains 28 pages



I N D E X

<u>DESCRIPTION</u>	<u>PAGE NOS.</u>
FORM OF TENDER	3
NOTICE INVITING TENDER	4 - 5
GENERAL RULES AND INSTRUCTIONS TO TENDERERS	6 - 12
ARTICLES OF AGREEMENT	13 - 16
APPROVED LIST OF MATERIALS	17 - 19
SCHEDULE OF QUANTITIES	20 – 27
DRAWINGS	28



FORM OF TENDER

Indian Bank

Corporate Office,
Premises, Estate & Expenditure Dept,
No. 254-260, Avvai Shanmugam Salai,
Royapettah, Chennai – 600 014.

Dear Sirs,

SUB: Invitation of Tender for ‘Civil & allied works” in Indian Bank Premises at F.Floor, Gee Gee Complex, No.:42,Annasalai,Chennai-02 .

Having examined the drawings, specifications, conditions and schedule of quantities prepared by you, and satisfying ourselves as to the location of the site and working conditions, I/We hereby offer to execute the above works at the respective rates which I/We have quoted for the items in the Schedule of Quantities.

I/We herewith deposit **Rs.13,500/- (Rupees Thirteen Thousand Five Hundred only)** by crossed demand draft payable at Chennai and drawn in favour of Indian Bank as Earnest Money Deposit for the due execution of the works at my/our tendered rates, together with any variations should the work be awarded to me/us.

In the event of this tender being accepted, I/We agree to enter into and execute the necessary contract required by you. I/We do hereby bind myself/ourselves to forfeit the aforesaid Earnest Money Deposit of **Rs.13,500/- (Rupees Thirteen Thousand Five Hundred only)** in the event of our refusal or delay in signing the Contract Agreement. I/We further agree to complete the work within the stipulated time specified in the Appendix to General Conditions of Contract.

I/We agree to keep our tender open for 90 **(Ninety) days** from the date of opening of Envelope No.1.

I/We enclose the completed tender documents duly signed under sealed envelopes and the Earnest Money Deposit Rs._____ (Rupees _____ only) by Bank Draft / Bank Guarantee No. dated Issued by

Thanking you,

Yours faithfully,

[To be signed by the Authorized Representative of
Tenderer who has the Power to do so]

Place:
Date :

Witness Signature:
 Name:
 Address:
 Seal:





INDIAN BANK

NOTICE INVITING TENDER

Indian Bank, Corporate Office ,Premises ,Expenditure & Estate Department ,Chennai-14 invites sealed tenders (Single Bid System) from Indian Bank empanelled Civil Works Contractor with Indian Bank Corporate Office and having full time local office at Chennai for Proposed Civil & allied Works in Indian Bank premises at First Floor, Gee Gee Complex, No.:42, Annasalai, Chennai-02.

1.	Name of work	Interior works for setting CAPC & MCB at Indian Bank Annasalai Premises
2.	Estimated cost of work	Rs.13.48 Lakh (Rupees Thirteen Lakhs Forty Eight thousand Only)
3.	Period of completion	45 days reckoned from the date of issue of the Work Order or handing over of site whichever is later
4.	Validity of Tender	90 Days from the date of opening
5.	Defects Liability Period	12 Months from the date of virtual completion of work
6.	Earnest Money Deposit (EMD)	Rs.13,500/- (Rupees Thirteen Thousand Five Hundred only) by way of DD in favour of "Indian Bank" payable at chennai.
7.	Initial Security Deposit (ISD)	2% of the Bid Amount (Including EMD amount)
8.	Retention Money (RM)	8% against each RA bill excluding taxes
9.	Total Security Deposit (TSD) ISD+RM	10% of the project cost. (Initial Security Deposity 2% and Retention Money 8%) 50% will be released after 15days of payment of the final bill and the balance 50% will be released after the Defect liability Period of One year).
10.	Value of work for Interim/adhoc Payment	Minimum Rs.7,00,000/- (Rupees Seven Lakhs Only) or as decided by the Bank. The interim payment /adhoc payment shall be 80% of the works executed /Bill value at site.
11.	Period of honoring certificate for interim payment /Adhoc payment	10 days from the date of receipt of Bill payment and it is in order
12.	Period of honoring Final Certificate	Six weeks from the date of receipt of Bill payment and it is in order
13.	Liquidated Damages	1% per week of the Contract Value subject to maximum total of 10% of final Contract value
14.	Tender Documents	Tender documents can be obtained from Indian Bank, Corporate Office, Premises, Estate & Expenditure Dept, First Floor, No. 254-260, Avvai Shanmugam Salai, Royapettah, Chennai – 600 014 from 04.01.2021 to 11.01.2021 on all working days during office hours. (OR) The Tender Documents can be downloaded from the Bank's website www.indianbank.in
15.	Cost of Tender Documents	Free of Cost.
16.	Last date of submission of tenders	12.01.2021 upto 15.00Hrs. at Indian Bank, Corporate Office, Premises, Estate & Expenditure dept, First Floor, No. 254-260, Avvai Shanmugam Salai, Royapettah, Chennai – 600 014.
17.	Date of opening Tender	12.01.2021 at 15.30Hrs. at Indian Bank, Corporate Office, Premises, Estate & Expenditure dept, First Floor, No. 254-260, Avvai Shanmugam Salai, Royapettah, Chennai – 600 014.
18.	Recovery towards Taxes	As per rules applicable time to time





Note:

1. The bank reserves the right to reject any tender/bid without assigning any reason.
2. The rates quoted by the tenderer shall be based only on the specifications and conditions of the tender documents.
3. Bank is not liable to make any payment to tenderers for preparation to submit the tender/bid.

ASSISTANT GENERAL MANAGER (P&E)

Signature & Seal of the Tenderer



GENERAL RULES AND INSTRUCTION FOR THE GUIDANCE OF TENDERERS

1 Definition of terms / interpretation:

- i. *Employer/Owner/Bank /Indian Bank/ Accepting Authority shall mean Indian Bank with their Corporate Office at No. 254-260, Avvai Shanmugam Salai, Royapettah, Chennai – 600 014 and any of its employees representative authorized on their behalf.*
 - ii. *Throughout these bidding documents, the terms “bid” and “tender” and their derivatives (“bidder”/“tenderer”), “bidered /tendered”, “bidding”/“tendering”, etc. are Synonymous.*
 - iii. *Day means calendar day. Singular also means plural*
 - iv. *“Contractor” means the person whose Tender has been accepted by the Employer and the legal successors in title to such person, but not (except with the consent of the Employer) any assignee of such person*
 - v. *Tenderer: The term ‘Tenderer’ shall mean the individual or firm or company whether incorporated or not, undertaking the work and shall include legal representative(s) of such individuals or persons composing such firm or company or successors of such firm or company as the case may be and permitted assigns of such individual or firm or company*
- 2 Tenders, which should always be placed in sealed cover, with the name of the work written on the envelope **“Civil and allied works in Indian Bank Premises at F.Floor,Gee Gee Complex No.:42,Annasai,Chennai-02”** will be received by Assistant General Manager (P&E), Indian Bank, Corporate Office, Premises, Estate & Expenditure Dept, No. 254-260, Avvai Shanmugam Salai, Royapettah, Chennai – 600 014.
 - 3 **Earnest money amounting to Rs.13,500/- (Rupees Thirteen Thousand Five Hundred only)** in the form of Demand Draft drawn in favour of “Indian Bank, payable at Chennai” must accompany each tender. EMD amount will not carry interest. Tender without earnest money will be summarily rejected.
 - 4 The Indian Bank does not bind itself to accept the lowest or any tender and reserves to itself the right of accepting the whole or any part of the tender and the tenderer shall be bound to perform the same at the rate quoted.
 - 5 The rate quoted by the Tenderer shall be net (excluding GST), up to the stage of incorporation and handing over site. All taxes including (excluding GST) or any other tax on material or on finished works like Turn-over Tax, including taxes that may be newly introduced subsequent to the tender etc. in respect of this contract shall be payable by the Tenderer and the Indian Bank will not entertain any claim whatsoever in this respect.

The rate quoted should be excluding GST.

The vendor who wishes to quote for the tender should have GST registration and should mention the registration number.



- 5 The Tenderer shall give a list of his relatives working with the Indian Bank along with their designations and addresses.
- 6 No employee of the Indian Bank is allowed to work as a contractor for a period of two years of his retirement from Indian Bank service, without the previous permission of the Indian Bank. The contract is liable to be cancelled if either the contractor or any of his employees is found at any time to be such a person who had not obtained the permission of the Indian Bank as aforesaid before submission of the tender or engagement in the Tenderers service.
- 7 The tender for works shall remain open for acceptance for a period of 90 days from the date of opening of Tender. If any tenderer who withdraws his tender before the said period, then the Indian Bank shall be at liberty to forfeit Earnest Money paid along with the tender.
- 8 The tender for the work shall not be witnessed by a Tenderer or Tenderers who himself/themselves has/have tendered or who may and had/have tendered for the same work. Failure to observe this condition would render tenders of the Tenderers tendering as well as witnessing the tender liable to summary rejection.
- 9 It will be obligatory on the part of the tenderer to tender and sign the tender documents for all the component parts.
- 10 Transfer of tender documents purchased by one intending Tenderer to another is not permitted.
- 11 The Tenderer must pay the amount of Earnest Money as mentioned in the Notice of Tender Invitation by ~~Bank Guarantee~~ / Bank Demand Draft payable to Indian Bank. No interest on Earnest Money deposited by the Tenderer shall be allowed. The Tenderer should attach the ~~Bank Guarantee~~ / Bank Draft along with the tender failing which the tender will not be considered. No other mode of payment shall be accepted.
- 12 The Earnest Money Deposit of unsuccessful tenderers shall be refunded within three weeks of award of contract to the successful tenderer or within one week of actual commencement of work whichever is earlier and in any case not later than four months.
- 13 The Earnest Money Deposit of the successful tenderer shall be refunded on the acceptance by the Employer of the Contractor's ~~Bank Guarantee~~/ Demand Draft towards Security Deposit.
- 14 The EMD of the Tenderer, whose tender is accepted, shall be forfeited in full in case he does not start the work by stipulated date mentioned in the award letter.
- 15 **The retention amount at 8% on the value of the bill paid will be held by the Indian Bank apart from ISD. 50% of the retention amount & 50% ISD (i.e 50% of TSD) will be paid after 15 days of completion of the project and payment of final Bill** and balance 50% will be released at the end of Defects liability period(12 Months), subject to satisfactory rectification of defects noticed, if any. EMD & retention amount held in our Indian Bank's books will not carry any interest.
- 16 The acceptance of a tender will rest with the Indian Bank and the Indian Bank reserves to itself the authority to reject any or all of the tenders received without the assignment of a reason. Tenders in which any of the prescribed conditions are not fulfilled (or) are incomplete in any respect are liable to be rejected. The Indian Bank reserves the right to accept the tender in full or in part and the tenderer shall have no claim for revision of rates or other conditions if his tender is accepted in parts.
- 17 Canvassing in connection with tenders is strictly prohibited and the tenders submitted by the Tenderers who resort to canvassing will be liable to rejection.





- 18 All rates shall be quoted on the proper form of the tender alone. **All the entries to be made legibly in ink only.** Rates written in pencil or any other mode shall not be considered for evaluation and will be rejected.
- 19 An item rate tender containing percentage below / above will be summarily rejected. However, where a tenderer voluntarily offers a rebate for payment along with sealed tender, the same may be considered.
- 20 On acceptance of the tender the name of the accredited representative(s) of the Tenderer who would be responsible for taking instructions from the Indian Bank shall be communicated to the Indian Bank.
- 21 Special care should be taken to write the rates in figures as well as in words and the amounts in figures only, in such a way that interpolation is not possible. The total amount should be written both in words and in figures.
- 22 The Contractor shall within 7 days of receiving the WORK ORDER submit **initial security deposit of 2%** of the contract value in the form of a Demand Draft or ~~Bank Guarantee in an approved format..~~ On acceptance of the Demand Draft or Bank Guarantee by the Employer, the Earnest Money Deposit shall be refunded to the Contractor.
- 23 The Contractor shall comply with and give all notices required under any law, rules, regulations, or bye-law of Parliament, State Legislature or Local Authority relating to works. If needed, the Contractor has to obtain required permission/ approval from the building secretary/ association. The Contractor shall before commencing the execution of work issue a certificate to the Employer that he has obtained all the permissions Registrations and give all the notices as are required to be obtained or given under law particularly blasting permission, Police permission etc.
- 24 The Contractor shall be required to maintain the site and the building areas in a neat and clean condition at all times to the satisfaction of the Employer. The Contractor shall especially take care to keep areas free from getting water logged, from concrete/mortar dippings, bricks, steel, shuttering materials or any other material / rubbish.
- 25 Debris and items removed from the building have to be neatly stacked at site and then periodically removed (maximum of one week), carried away by the Contractor and disposed off as per the rules and regulations of the Local Authorities concerned. No debris shall be thrown loose from upper floors. No floor, roof or other part of the building shall be over-loaded with debris or materials as to render it unsafe.
- 26 Employer reserves the right to insist on selection of material, workmanship, detailing and finishes, which they consider, is appropriate, and suitable for the intended use. The contractor is not eligible to claim extra on this account.
- 27 Employer will require the contractor to produce, samples of all the materials, accessories/ finishes prior to procurement/ manufacture. The samples of the materials for the work shall be got approved from the Employer. Failure to comply with these instructions can result in rejection of the work/ materials.
- 28 For painting & Lamination, sample area shall be prepared and the shade got approved. It is also advised to give computer presentation of various colour schemes to the employer before going for sample painting/Lamination,
- 29 The Tenderer should note that he should execute his part of work without causing any damage to any component of the building and also without disturbing the occupants. Any damage so caused shall be made good at the cost & risk of the tenderer.
- 30 The successful tenderers shall include, in the quoted price, all allied civil works such as chasing in wall, drilling holes etc to support the frames, partitions, make the



surface good after grouting, scaffolding required if any to load/ unload the materials etc.

- 31 The successful contractor shall also be responsible for the safety and security of all their materials and also for ensuring fire prevention steps at all times in the working premises including their part of the work. The successful contractor has to place full time representative at site, the representative should have thorough subject knowledge.
- 32 The work shall be carried out without disturbing the existing occupants of other offices. Necessary barricading of the area, if required from the rest of the area shall have to be arranged by the successful contractor at no extra cost. The work is to be organized and executed so as to have least disturbance to the occupants of other Offices.
- 33 **Only one interim payment /ad hoc payment is permitted with minimum value of bill shall be of Rs.7.00 lakh.** or as decided by the Bank. The interim payment /ad hoc payment shall be 70% of the works executed /Bill value at site. The bills in proper forms must be duly accompanied by detailed measurements in support of the quantities of work done and must show deductions for all previous payments, retention money etc. The Employer after detailed scrutiny of the interim bill shall certify within **10 days** of the date of receipt of interim bill from the Contractor subject to submission of documentation as required
- 34 **The contractor should ensure payment of minimum wages + VDA to all labourers / workmen staff employed by him inline with central/ state labour wage act whichever higher.**

The Contractor shall at all times indemnify and keep indemnified the Employer against all losses, claims, damages or compensation including under the provisions of the payment of the Wages Act 1936, Minimum Wages Act 1948, Employer's Liability Act 1938, Workman's Compensation Act 1923, the Maternity Benefit Act 1961, the Bombay Shops and Establishments Act 1947, Industrial Disputes Act 1947, and Contract Labour (Regulation and Abolition) Act 1970 and Employees State Insurance Act 1948, Motor Vehicles Act 1988 or any modifications thereof or under any other law relating thereto and rules made thereunder from time to time or as a consequence of any accident or injury to any workman or other person in or about the work whether in the employment of the Employer or Contractor or not, and also against all costs, charges and expenses of any suit, action or proceedings whatsoever out of such accident or injury or combination of any such claims.

- 35 From commencement to completion of works, the Contractor shall take full responsibility for the care of the work and for taking precautions to prevent loss or damage to the work to the maximum extent possible and shall be liable for any damage or loss that may arise to the works or any part thereof from any cause whatsoever including causes of fire, lightning, explosion, earthquake, storm, hurricane, floods, inundation, subsidence, landslides, rock slides, riots (excluding civil war, rebellion, revolution and insurrection) or any latent defect or damage and shall at his own cost repair and make good the same so that at all times the work shall be in good order and condition and in conformity in every respect with the requirements of the Contract.

For the purpose of this condition this expression "from commencement to completion of works" shall mean the period starting with the date of issue of Work Order or date of handing over of site whichever is later and ending with issue of Virtual Completion Certificate.

Without limiting the obligations and responsibilities under this condition, the Contractor shall insure and keep insured the works from commencement to completion, as aforesaid, for the full contract value including Price Variation

Adjustment if any against the risk of loss or damage from any cause whatsoever including the causes enumerated in the foregoing paragraphs. In the event of there being a variation in the nature and extent of the works, the Contractor shall from time to time increase or decrease the value of the insurance correspondingly. All the premia for the insurance shall be borne and paid by the Contractor.

Before commencing the work, the Contractor shall without limiting his obligations and responsibilities under this condition, insure against any loss of life or injury to any personnel in the employment of Contractor / Sub-Contractor/nominated Sub-Contractor. For this purpose, an insurance shall be taken by the Contractor /Sub-Contractor. Such an insurance shall be taken to include both employees/workmen covered by the Workman's Compensation Act 1923, as well those employees/workmen not covered by the said Act. Separate insurance policies may be taken for employees/ workmen covered by Workman's Compensation Act 1923, and employees / workmen not covered by the said Act. All the premia shall be paid by the Contractor. Policy/Policies taken under this para for the personnel in employment with the Contractor / Sub-Contractor may be in their Employer's names of the Contractor / Sub-Contractor / nominated Sub-Contractors. In the event of any loss or injury to personnel in employment with the Contractor / Sub-Contractor / nominated Sub-Contractors, the Employer and Contractor shall recover directly from the Insurance Company and ensure that payment of the same is made to the affected parties including the Employer. The policy in original shall be deposited with the Employer.

The Contractor shall at all times indemnify and keep indemnified the Employer against all losses and claims for injuries or damage to any person or any property whatsoever which may arise out of or in consequence of the construction and maintenance of the work and against all claims, demands, proceedings, damages, costs, charges and expenses whatsoever in respect of or in relation thereto. Before commencing the execution of the works, the Contractor shall without in any way limiting his obligations and liabilities under this condition, insure at his cost and expense against any damage or loss or injury which may be caused to any person or property including the employees and directors of the Employer and their property by or in the course of the execution of the works. Such insurance to be known as the Third Party Insurance shall be in a sum of **Rs. 1.0 lakh**. The Insurance policy to be so obtained by the Contractor shall be deposited by the Contractor with the Employer within **Seven days** of its issue by the Insurer.

- 36 The Contractor shall take all precautionary measures to ensure the safety of the workmen employed by it. The contractor shall be fully responsible for the any injury or damage caused to the workmen deployed by him at site for carrying out the work and Bank has nothing to do with such happenings and in no way shall be held responsible for the same.
- 37 The contractor shall maintain all registers as required by the Regional Labour Commissioner and should furnish the same to the Bank or its representative as and when required.
- 38 If the work is not started within **7 days** from the date of issue of work order then Employer may terminate the work order without assigning any reason. If during the execution of the work, the progress of work is not considered to be satisfactory and is not consistence to be in contingent with the period of the completion of the work then the Bank may terminate the work order by giving a 5 days notice to the contractor.. In such case the contractor shall be liable to pay the employer any extra cost involved for the completion of the said work and will not obstruct any way in completing the work through other agency. After completion of entire work the contractor shall be paid for the actual work executed by him at the quoted rates after deducting any claims, damages.

- 39 The time allowed for completing the works is **45 days** to be reckoned from **7 Days** from the date of Work Order / date of handing over site whichever is later. Tenderers shall submit a programme (time schedule) for executing the entire project and shall furnish the details of their scheme indicating the proposed deployment of their machinery and resources.
- 40 If the Contractor fails to complete any or all the works by the date/s named in **Clause 39**(Date of Completion) or within any extended time (permitted by Bank) then the Contractor shall pay or allow the Employer the sum to be worked out at **1.0%** of contract value per week to be recovered as Liquidated Damages (and not by way of penalty) for the delay, beyond the said date or extended time, as the case may be, during which the works shall remain unfinished and such damages may be deducted from any moneys due or which may become due to the Contractor. The maximum amount of Liquidated damages shall be **10%** of contract value. The contractor shall be bound to extend validity of Insurance Cover till such period of completion as may be considered necessary at their cost.
- 40 The successful tenderer shall be required to execute an Agreement in the proforma attached with this tender document within **7 days** from the date of receipt of the notice of acceptance of tender. In the event of failure on the part of the successful tenderer to sign the agreement within the above stipulated period, the earnest money will be forfeited and the acceptance of the tender shall be considered as cancelled.
- 41 The final bill will be released on satisfactory completion of the entire work and on completion of all the terms and conditions / obligations spelt out and on proper submission of the bill together with the measurements. Final Bill settlement is within 45 days from the date of proper submission of bill & measurements.
43. At any stage i.e. during the execution of work, any kind of change required, whether it is in design or specification, the same has to be incorporated by the contractor and it shall be treated as a variation.
44. Single Power point & Water for work will be provide by bank at free of cost
45. The contractor shall not directly or indirectly sublet the work to other party without written permission of the bank.
46. The Bank reserves the right to distribute the work for which quotations have been called, among more than one parties, if found necessary. No claim in this respect shall be considered and the contractor agrees to cooperate with other agencies appointed by the Bank.
47. Bank shall not be responsible for any lose or damage to the contractor/labour due to any natural calamity during the course of construction. Contractor is liable to make good all the damages if any, till the work is completed and handed over to the Bank authorities
- 48 No advance payment shall be made to the contractor on supply of any material supplied at site for execution; payment shall only be made on execution and completion of any concerned/particulars item.
- 49 Contractor agencies are advised (before quoting the rates) to inspect the site of the proposed work. They must go through specifications and documents. Any clarification, if required, may be taken from the bank before submitting the quote..





- 50 The quantities mentioned in schedule are provisional and likely to increase /decrease to any extent or may be omitted thus altering the aggregate value of the contract. No claim for loss of profit/business shall be entertained on this account.
- 51 The contractor /vendor failed to carry out the works as per schedule/Quality, the same shall be carryout with different agencies and the actual amount will be deducted from the contractor bills.
- 52 Payment to the contractor shall be made as per actual work done of site.
- 53 The contractor agency shall keep particular vigil on his workers to maintain very good workmanship of all items, failing which no payment shall be made and no claim of material/labour used shall be made to him in any case, and the same work shall be executed by him again without charging any extra cost.
- 54 The Bank reserves the right to accept/reject any quotes without assigning any reasons.
- 55 Any work got executed in poor workmanship as pointed out by the Bank' Official will have to be dismantled and redone by the Contractor on his own cost
- 56 Any addition, alteration or correction in the quote shall be signed and stamped properly by the contractor

ASSISTANT GENERAL MANAGER (P&E),

Indian Bank Corporate Office,
Premises, Estate & Expenditure Dept,
No. 254-260, Avvai Shanmugam Salai,
Royapettah, Chennai – 600 014.

Signature & Seal of the Tenderer





ARTICLES OF AGREEMENT

THIS AGREEMENT is made on this day ofmonth of between Indian Bank and having its Corporate Office at **No. 254-260, Avvai Shanmugam Salai, Royapettah, Chennai – 600 014** (hereinafter referred to as the “Employer”) which expression shall include its successor, legal heirs and assignees of the one part.

AND M/s. having its office at
.....
(hereinafter referred to as the “Contractor”) which expression shall include its successor, legal heirs and assignees of the second part.

WHEREAS the Employer has caused drawings and tender documents for ‘**Civil and allied works in Indian Bank Premises**’ at No.:42,F.Floor,Gee Gee Complex,Annasalai,Chennai-02.

AND whereas the Employer has called for tender vide ref. no.
dated..... .

AND whereas the contractor has submitted the tender ref. no.
dated to the Employer on

AND whereas the Employer has issued the work order ref
dated..... to the contractor to do the work.

AND whereas the Contractor has agreed to execute the work as per drawings, specifications, conditions of contract and Work Order.

AND whereas the Employer has accepted the Contractor’s tender as aforesaid and whereas the tender submitted by the contractor has been accepted for such sum as may be ascertained to be payable in terms of the Bill of Quantities and which sum is estimated to be Rs. (Rupees) hereinafter referred to as the said “Contract Agreement”.

NOW THIS AGREEMENT WITNESSETH AS FOLLOWS:-

- 1) In consideration of the said Contract Sum to be paid at the times and in the manner set forth in the said Conditions the Contractor shall carry out and complete the Civil, Plumbing & Painting Works in terms and conditions herein contained and according to the general conditions of the contract, notice inviting tender, special conditions of contract, general scope of work, technical specifications, schedule of rates and instructions to be given by and the supervision of and to the entire satisfaction of the Employer.





2) **Contract Price, Taxes and Payment Terms :**

Total contract price is Rs. which is inclusive of cost of materials, equipment, installation charges and tools and tackles required for execution of the job. Above price is inclusive of all taxes & duties including excise duty, sales tax, works contract tax, income tax, octroi etc. in respect of this contract. No claim in this respect will be entertained. Sales tax on works contract & Income tax on payments will be deducted and deposited by Employer in accordance with the sales tax law of the state and the provisions of tax deductions at source under income tax act 1961.

However, interim payment will be made as per the site measurements on Item Rate basis.

3) **Completion Period:**

Time is the essence of the Contract. The work is to be completed in all respects within **45 days** reckoned from **7th day** from the date of issue of the Work Order or handing over of site whichever is later. If the Contractor fails to complete the job within the agreed time period the Contractor will have to bear liquidated damages as per the relevant clause mentioned in the Tender Documents.

4) **Earnest Money Deposit**

The Contractor has deposited an amount of **Rs.13,500/- (Rupees Thirteen Thousand Five Hundred only)** as earnest money by way of DD in favour of "Indian Bank" payable at chennai.

5) **Inspection of Site:**

The Contractor has inspected the site before submitting his tender and has satisfied himself as to the nature of the work to be executed on the site. Any difficulties which the Contractor may come across in the course of the work shall in no way relieve the contractor to claim or receive extra payment unless the Employer is of the opinion that such difficulties could not have been foreseen and the Employer consents in writing.

6) **Supply of Material and Labour:**

The Contractor shall arrange all labour, materials, equipments, tools, tackles and everything necessary for the completion of the work. The Contractor will assume all responsibility for the safety, protection and accounting of all material and equipment and the work during construction. All materials used by the Contractor shall be of the best quality conforming to the required specification mentioned in the tender document and will be subject to the approval of the Employer. All such materials not approved by the Employer shall be removed at once by the Contractor at his own expense. The Contractor shall also at his own expense arrange for carrying out any test of materials which the Employer may from time to time require or if so desired by the employer.

7) **Defective Work / Materials:**

If any part of the work done by the Contractor is found defective in workmanship or if bad or inferior materials have been used the Contractor shall at his own risk and cost demolish all such defective work and rebuild the same and / or replace the bad or inferior materials used within a time frame mentioned to the satisfaction of the Employer. The decision of the Employer in this regard shall be final and binding on the Contractor. In case of default of the contractor to remove the defective work and rebuild the same or replace bad or inferior materials as directed by the Employer, the



Employer shall be entitled to employ anyone else to carry out the same at risk and cost of the Contractor and recover all expenses incurred in this regard from the contractor.

8) **Inspection of Work:**

During progress of the work the Employer shall be entitled at all times to have access to and inspect the work.

9) **Supervision:**

The Contractor shall provide one or more competent and technical qualified engineers duly and fully authorized to act on his behalf in all matters relating to the works to be carried out under or any other matter concerning this agreement and who shall at all times be present at the works while any work is in progress as per directions, explanations & instructions of Employer.

10) **Compliance with Statutory Regulations & Work Rules:**

The Contractor shall be responsible for complying with the applicable laws / bye laws / Regulations in force from time to time and shall have to bear all statutory liabilities to the workers / personnel engaged for the job. Nothing will be paid extra in this regard. If any amount is paid by the Employer with this regard the same amount shall be deducted from the Contractor's dues. The Contractor shall have to arrange insurance cover for the workers / personnel engaged by him for the job and materials & works supplied/carried out at site/work place. Also to be adhered as per Tender Clause No.:34,35,36 & 37 of **General Rules And Instruction For The Guidance of Tenderers.**

11) **Termination of Contract:**

In the event of Contractor failing to keep / adhere to agreed schedule of work, or in the event of the Contractor failing to comply with the provisions of this contract by default and / or negligence and / or suspension of work or in the event of Contractor failing to complete the work within the stipulated period, the Employer may terminate this Agreement forthwith and employ, at the Contractor's risk and cost, another contractor or sufficient number of workmen to complete the work.

12) **Force Majeure:**

This clause will be operative only if the work is delayed by

- a) Acts of God
- b) Earthquake or floods or similar natural calamities.
- c) Serious loss or damage by fire or lightning.

In case any Force Majeure condition herein mentioned occurs and continues for a period exceeding 15 days the parties hereto undertake to sit together and devise ways for expeditious and proper performance of the obligations of the parties under this order.

13) **Arbitration:**

" In the event of any dispute or difference relating to interpretation and application of provisions of the contract and all disputes/ claims whatsoever which shall either during the continuance of the contract or afterwards either between the parties to the contract or the respective representatives touching the construction/ application of any provision/ clause mentioned in the contract or any account or liability between the



parties to the contract or as to any act or deed or omission of any party to the contract, in any way relating to these presents, shall be first at the discretion of the Bank attempted to be resolved in good faith by mutual discussion within 30 days of the dispute or question being raised failing which the same shall be settled by arbitration in accordance with provisions of Indian arbitration and Conciliation act 1996.

The Parties concerned shall designate an arbitrator on mutual consent/ consensus. The venue of the arbitration shall be exclusively at Chennai and any award passed by arbitrator shall be final, conclusive and binding upon the parties and shall be deemed to have been made between parties themselves. The parties to the dispute shall share equally the cost of arbitration as intimated by the arbitrator”.

Submitting to arbitration may be considered as an additional remedy and it does not preclude the right of the bank to seek other redressal/ Other Recourse.

- 14) The bank and the contractor agree that this agreement is entered in to on Principal to Principal basis. Nothing contained in this agreement shall be construed to create any association, Joint venture or Partnership or Relationship of Principal and Agent or Master and Servant or Employer and Employee between the Bank and the contractor. The parties to the agreement shall be deemed to be independent entity and employees of wither of the parties shall not deemed to the employees of the other. Neither party shall have authority to bind other other except to the extant authorized herein.

IN WITNESS whereof the said contracting parties have set their hands and seals on the day and year first hereinabove witness.

Witness Address

Employer

Witness Address

Contractor



List of Materials of Approved Brand And/ Or Manufacture

1	Cement	1. Ultra Tech 2. Coromandel 3. ACC 4. Dalmia or approved equivalent.
2	Steel	1. Sail 2. Tisco or approved equivalent.
3	Vitrified Tile	1. RAK 2. Kajaria 3. Nitco 4. Euro
4	Ceramic Tile	1. Kajaria 2. Somany 3. Nitco 4. Jhonson
5	Tile fixing Adhesive	1. Sika 2. Pidilite 3. Bal Endura 4. Fosroc 5. BASF or approved equivalent.
6	Marine Plywood (IS 303)	1. Century 2. Greenply 3. Archid 4. Mayur or approved equivalent
7	BWR grade phenol bonded plywood (IS 303)	1. Century 2. Greenply 3. Sharon Ply 4. Mayur or approved equivalent.
8	Particle Board	1. Greenply 2. Archid 3. Merino Duro or approved equivalent
9	Block Board	1. Century 2. Greenply 3. Swastik or approved equivalent
10	Flush doors	1. Century 2. Kuty 3. Green ply or approved equivalent
11	Fibre Board (MDF, LDF)	1. Century 2. Novapan 3. Swastik or approved equivalent
12	P.O.P.	1. Gyproc India 2. India Gypsum 3. Saint Gobain or approved equivalent
13	Putty	1. Birla Wall Care 2. JK Wall Putty 3. Asian
14	Laminates	1. Greenlam 2. AICA 3. Euro lam 4. Merino or approved equivalent.
15	Handles	1. Godrej 2. Hafele

		3. Dorset or approved equivalent.
16	Glass	1. Saint Gobain 2. Float Glass India (Asahi) 3. Modigaurd or approved equivalent.
17	Screws	1. GKW 2. Ebco 3. Oxidised or approved equivalent.
18	Hardware (Hinges & others)	1. EBCO 2. Godrej 3. Haffele 4. Dorset or approved equivalent.
19	Adhesive for fixing laminate	1. Fevicol SH 2. Araldite of Ciba Geigy 3. Bal Endura 4. Pidilite or approved equivalent.
20	Locks	1. Godrej 2. Ebco 3. Harrison 4. Dorset or approved equivalent.
21	Wood preservative	1. Bison by British paints or approved equivalent.
22	Cement Primer	1. Berger 2. Asian 3. ICI Dulux 4. Nerolac paints or approved equivalent
23	Acrylic Emulsion paints	1. Berger 2. Asian 3. ICI Dulux 4. Nerolac or approved equivalent
24	Enamel paints	1. Berger 2. Asian 3. ICI Dulux 4. Nerolac or approved equivalent
25	Wood primer	1. Berger 2. Asian 3. ICI Dulux or approved equivalent
26	Aluminium sections	1. Hindalco 2. Jindal 3. Nelco or approved equivalent
27	Curtain Rods	1. Vista 2. Trac 3. MAC or approved equivalent
28	Drawer – telescopic	1. EBCO 2. Efficient or approved equivalent.



Plumbing:

1	Cast Iron Pipes and fittings (ISI approved)	1. NECO 2. Raj iron Foundry 3. Kapilansh 4. Kajeco
2	CPVC pipes and Fittings	1. Ashirwad 2. Flowguard – Astral 3. Ajay or approved equivalent
3	SWR PVC/ UPVC Pipes and Fittings	1. Finolex 2. Supreme 3. Prince 4. Polypack 5. Jindal or approved equivalent
4	CP Brass Fittings	1. Jaguar 2. Parryware 3. Ess-Ess or approved equivalent.
5	Floor Drain Fixture, Rain Water Outlets & Channel Gratings	1. Supreme 2. ACO 3. GMGR 4. Neer or approved equivalent.
6	C.P. Grating for Floor Trap	1. GMGR 2. Chilly 3. Viking or approved equivalent.
7	GI / M.S Pipes (IS : 1239 and IS : 3589)	1. Jindal 2. Swastik 3. Surya 4. Tata or approved equivalent
8	Pipe clamp & supports	1. Chilly 2. Supreme 3. Euroclamp or approved equivalent.
9	HDPE Pipe	1. Duraline 2. Kimplas 3. Reliance or approved equivalent.
10	Butterfly Valve	1. Audco 2. Danfoss 3. Honeywell 4. Sant or approved equivalent.
11	Check Valve – Wafer Type	1. Advance 2. Danfoss 3. Sant 4. Kirlosker or approved equivalent.
12	Anchor bolts	1. Fischer 2. Hitli or approved equivalent.

Note –

1. Materials mentioned in the specification shall be used for the work. If specified material is not available prior approval of the Employer shall be taken to use other brands.
2. Preference of makes, supply of items should be consulted with client/consultant before effecting of supply.

NAME AND ADDRESS OF THE CONTRACTOR:

SIGN & SEAL OF THE CONTRACTOR:

Date:

Place:



Schedule of Quantities

**Civil & Allied works in Indian Bank Premises at F.Floor ,Gee Gee Complex, No.:42,
Anna Salai, Chennai - 600 002**

SI No	Description	Unit	Qty	Unit Rate	Amount
I	DISMANTLING /DEMOLITION WORK				
i	Partly Dismantling of Existing Wall 230mm/115 mm thick using suitable mechanical/ hilti machine tools according to the dimension provided by the employer, without disturbance to the existing structure/ Electro mechanical work. The items inclusive of disposal of unserviceable material to municipal dumping ground & stacking of serviceable material.	Cuft	100.00		
ii	Dismantling of existing concrete using suitable mechanical/ hilti machine tools according to the dimension and ,without disturbance to the existing sturcture. the items inclusive of disposal of unserviceable material to municipal dumping ground & stacking of serviceable material.	Cuft	10.00		
iii	Providing suitable core cutting on concrete floor slab(8") to install 100 mm floor traps by mechanical means. The rate inclusive of scaffolding and builder works etc	Nos	8.00		
iv	Providing suitable core cutting on Brick wall (400mm) to lay 100/75 mm floor traps by mechanical means. The rate inclusive of scaffolding and builder works etc	Nos	6.00		
v	Removing of existing wall & Floor tiles fixed in the toilet and mosaic in flooring by mechanical means or hand tools upto the existing wall/floor slab . The items inclusive of disposal of unserviceable material to municipal dumping ground & stacking of serviceable material. .	Sq.ft	400.00		
	DISMANTLING WORKS SUBTOTAL (I)				
II	Brick & Concrete Work				
i	Providing and constructing 230 mm thk. brick work or 200 mm thick block works in C.M.1:5 (1cement : 5 Fine aggregate) as per IS in super structure. The items shall include the cost of material, scaffolding, transportation, all labours and curing charges. The rate shall be inclusive of suitable surface preparation for brick works	Cuft	40.00		
ii	Providing and constructing 115/100 mm thk. brick work or 100 mm block works in C.M.1:4 (1cement : 4 Fine aggregate) as per IS in super structure. The rate shall include the cost of material, scaffolding, transportation, all labours and curing charges. The rate shall be inclusive of suitable surface preparation for brick works	Sqft	150.00		

iii	Providing and laying RCC 1:1.5:3 concrete works using 20 mm and down size graded crushed aggregate including providing and fixing necessary scaffolding, formworks, entering and shuttering, machine mixing, compacting by mechanical vibrators, curing, etc complete. Concrete shall conform to IS 456-Latest edition rate shall be exclusive of the cost of steel reinforcement, which will be paid under a separate item. The item include preparation of suitable surface for concrete and removing of foreign material etc.				
	for RCC above 3" thickness: beam, lintel ,machine pedestal etc	Cuft	20.00		
	For RCC below 3" thickness: Kitchen & Counter Slab	Sqft	32.00		
iv	Supplying, fabricating and placing in position HYSD reinforcement bar conforming to IS 1786 grade FE 415 including cutting, bending & supply and binding with 20 SWG annealed binding wire. Payment shall be made as per reinforcement drawings and at theoretical weights only. (for tor steel)	Kgs	80.00		
v	Providing 15-20 mm thk. internal and external plastering in C.M.1:4 (1 cement : 4 fine Aggregate) on brick/ concrete works including raking out joints where required and curing etc. complete as per instructions..The rate include suitable mixing of suitable integrated waterproofing compound in the mortar for plastering,pointing,finishing etc . The rate including repairing of concrete works.	Sqft	650.00		
	Brick & Concrete Work Subtotal (II)				
III	Water proofing work -Wet areas & including refilling				
i	Removing the existing ceramic tile/ mosaic/ cement flooring/ skirting etc. with bed mortar and brickbat jally to expose the R.C.C slab including sanitary ware, water lines, tap etc if any and water proofing layer in toilet area upto existing slab level including carting away of debris, surface preparation for water proofing including Polymer Non Shrinkable Grouting Compound and approved polymer modified acrylic cementitious water proofing compound with cement (1:1) 2 coat to be applied horizontal & vertical at the junction adjoining to wall up to 2 feet, with care that all crevices, cracks and unevenness is properly treated and laying of 1 layer of fibreglass mesh, over 1 coat of modified water proofing and including layer 20 mm thick rendering mixed with 2 to 3% Integral Water proofing Compound and curing for 48 hours and water testing should be carried out for water proofing work. The water proofing treatment is to be carried out by a specialized agency with approval of consultant and shall be guaranteed fully effective for a period of 10 years.	Sqft	400.00		

ii	Brickbats shall be laid in cement mortar (1:4) in all positions with an average thickness of 150 to 250 mm is to be provided. Brickbats should be laid in the fresh mortar, leaving a gap of half to one inch between each piece, taking care to provide the necessary slope. This brickbat layer should be cured for at 4 days. The joints in between the brickbats shall be first filled with cement slurry and immediately covered with a layer of cement mortar (1:3) so as to fill up gaps between the brickbats and also from a 25 mm thick layer over the brickbat surface complete to the entire satisfaction.	Sqft	400.00		
	Water proofing work -Wet areas & including refilling Subtotal (III)				
IV	STONE /TILING WORK				
A	Banking Hall Flooring				
i	Removing of Existing Tile flooring laid on mosaic and laying of new tiling				
	Providing & laying of joint free Double Charged Vitrified tiles 600X600mm/ 605X605 mm in pattern , Digital polished, stain free as approved by Bank laid on existing mosaic floors and skirting with 2/3 mm spacer joints by approved chemical adhesive. Filling the joints with polymer grouting compound to match with the shade of tiles and finally washing and clean water to bring the desired finish/ cleaning/ chipping the existing floor properly where the tiles fixed with adhesive towards proper gripping the tiles. The rate includes carefully removing of existing ceramic tiled flooring/skirting which are laid on mosaic etc.. the damaged mosaic flooring has to be filled with cement bed mortar curing, mending good the damages, removal of debris from the premises, cleaning the site and carting away from site and disposing to dump yard , including providing any short fall materials -All complete as per drawing / direction of Bank's Engineer, including the cost of curing. The measurement of skirting area shall be taken as a sq.ft i.e in line with floor area & Skirting Basic landing cost of Tiles Rs.60/- sft	Sq.ft	5200		
ii	Same as above ,but laying of tile on top mosaic after surface preparation with approved bonding adhesives.	Sq.ft	1000		



B	Wet area tiles				
i	<p>Bath room Tiles: Flooring Providing & laying antiskid type ceramic tiles in flooring of Bathroom in proper line, level and slope, of approx. size 400mmx400mm / 300 mm x 300 mm (minimum) to suit to site condition or as approved with (1 : 3) cement sand mortar mixed with water proofing compound of approved make as per manufacturer's specifications of minimum 20 mm thickness and above to suit the level of the floor (3/4" down). Filling the joints with white cement slurry mixed with pigment to match with the shade of tiles and finally washing and clean water to bring the desired finish/ cleaning/ chipping the existing floor properly where the tiles fixed with adhesive towards proper gripping the tiles. The rate also to include the cost of curing, mending good the damages, removal of debris from the premises, cleaning the site, including providing any short fall materials -ALL complete as per direction of Bank's Engineer. Basic cost of Tiles Rs.50/- sft</p>	Sqft	210.00		
ii	<p>Wall Tiles Fixing in dado of Kitchen, Wash basin area & Toilet glazed wall tiles of size 300X300mm/ 300x 450mm/ with minimum 15 mm thick or above cement sand mortar (1:3) mixed with approved make water proofing compound as per manufacturer's specifications by maintaining of proper line and level, filling the joints with white cement slurry to match with the shade of tiles, curing lifting, mending good to the damages as per existing surface. The rate should also include the cost of taking out the existing wall tiling and taps, water lines to expose the brick surface, applying cement slurry mixed with approved make water proofing compound as per manufacturer's specifications, carting away debris outside the premises, final cleaning by diluted acid. The rate shall be inclusive of taking out the existing plumbing/ sanitary fittings and fixtures and stacking the same all complete as directed by Bank's engineer. Basic cost of Tiles Rs.50/- sft</p>	Sqft	620.00		
iii	<p>Providing and laying Kitchen counter/washing basin counter with 19 mm thick prepolished Black Galaxy Granite slab of 620 mm (suit the site conditions) depth with 20 mm projection, double nosing (40mm) on front side in cement sand mortar (1 : 3) including finishing the joints with white cement mixed with matching pigment including curing, grinding the edges (half round nose) over existing RCC slab including necessary repairing of existing slab slab. The rate to be inclusive suitable mechanical means from existing R.C.C. slab, breaking the wall to the required height and also to include cutting hole for Gas tube, Wash basin, Kitchen and providing half round mould in granite . all complete as directed by Bank's Engineer. (Net area of granite shall be paid). Basic cost of Granite Rs.200/- sft.</p>	Sqft.	40.00		

iv	Providing and Fixing of 25 to 30 mm thick pre polished Granite stone for urinal partion Size (Basic Price Rs.200/- Per sq.ft). The rate including making suitable channel cutting the wall minimum 3" ,edge /half round polishing, grouting etc (Size 3'0" X1'9")	Nos	3.00		
v	Providing and Fixing of 25 to 30 mm thick pre polished Kaddapa stone for kitchen self below counter .	SQft	30.00		
Stone/Tiling Subtotal (IV)					
V	Vinyl Flooring				
i	Antistatic Flooring for Machine room				
	Providing & Fixing of 2 mm thick vinyl anti static flooring for machine & equipment room with approved colour laid with proper rubber based adhesive solutions , with all materials and labour complete. Basic price :Rs.80SFT. The rate including levelling of existing undulated flooring by suitable materials if any	Sq.ft	400.00		
ii	Vinyl Flooring				
	Vinyl flooring :Supply & Laying of 2mm thick vinyl strip flooring with approved colour laid with proper rubber based adhesive solutions suc , with all materials and labour complete. Basic price :Rs.50.00 Sft. The rate including levelling of existing undulated flooring by suitable materials	Sq.ft	500.00		
Vinyl Flooring & Antistatic Flooring Subtotal (V)					
VI	Door & Windows & Ironmongeries				
i	S/l pf 30 mm thick Glass Fibre Reinforced Plastic (FRP) panelled door shutter of required colour and approved brand and manufacture, made with fire - retardant grade unsaturated polyester resin, moulded to 3 mm thick FRP laminate for forming hollow rails and styles, with wooden/FRB frame (3"x2 1/2") and suitable blocks of seasoned wood inside at required places for fixing of fittings, cast monolithically with 5 mm thick FRP laminate for panels conforming to IS: 14856, including fixing to frames(Toilet Door) Door size shall be 2'6" X7' and Frame Size shall be (3"x2 1/2"). the rate including s/i of fixation of steel clamp.	Nos	5.00		
ii	S/l of 8" SS Chrome finish heavy duty Tower Bolt	Nos	5.00		
iii	S/l of 6" SS Chrome finish heavy duty Tower Bolt for toilet	Nos	5.00		
iv	S/l of mortice lock HML-480 Lock Body 304 Stainless Steel in the door . All complete as per approval and instructions of the Architect / employer.	Nos	2.00		
v	Do as above ,Supplying and fixing of lever handle without locking arrangement with SS handles	Nos	3.00		
vi	Providing and fixing fixed louvered ventilator for toilets with powder coated UPVC frames and 6mm reinforced pin head glass with edge polishing and all necessary accessories. Rate shall include sealant between the UPVC frame and masonry surface.(450mm X450mm)	Nos	2.00		
Subtotal (VI) Doors & windows					

VII	MS Grille Works				
i	Providing and fixing M.S. grills of required pattern in frames of windows etc. with M.S. flats, square or round bars etc. including priming coat with approved steel primer all complete. Fixed the steel to wall(1.75Kg/per Sq.ft). The rate including builders works.	Kgs	20.00		
	Subtotal (VII), MS Grille Works				
VIII	Plumbing Works				
i	Providing and fixing vitreous European type - Wall Mounted water closet (Parry ware: Cascade NXT or Equivalent) (color) with seat cover, flushing cistern including providing and connecting 110mm PVC pipes (6kg/sqcm),P/S traps of approved make ISI mark to external plumbing with necessary fitting such as bends, tees, etc., CP Angular Stop cock with metallic Hose - Parryware make (Cat. ref. No. G1907A1) and all other required accessories, including jointing with cement mortar 1:1, making holes in wall, filling the same from both sides, testing and removing existing pipes of any material and any diameters, taking out the existing fittings from floor, dismantling joints, stacking & sorting the pipes, scaffoldings etc. complete as directed by Bank's Engineer.	Nos	3.00		
ii	Providing and fixing off counter top wash basin (white) including plumbing fittings Supply and fixing,"Parryware" Off White colour glazed Undercut Oval Washbasin of 550x445mm size with (excluding RCC slab and marble / granite)Parryware Model of Washbasin : C0407 (Cascade NXT , fixing the same to perfect level, grouting to adjusting surfaces with waterproofing materials, cutting walls or RCC slab with C.I. brackets painted white, 15 mm C.P. brass pillar taps - Parryware Make (Trio - Catalogue ref. No. G1903A1), 332 mm C.P. brass waste coupling of standard pattern - Parryware Make (Catalogue ref. No. T9910A1/ T9911A1), C.P.Brass Angle Valve with Metallic Hose , Parryware Make (Catalogue ref. No. G1907A1) connecting C.I. pipes of required diameter & approved make . the rate including S/I of bottle trap Jaquar make 769 L 300 with ISI mark to external plumbing with necessary fitting such as nahani trap, bends, tees, etc. including jointing with cement mortar 1:1, making holes in wall, filling the same from both sides, testing and removing existing pipes of any material and any diameters, taking out the existing fittings from walls, dismantling joints, stacking & sorting the pipes, scaffoldings etc. complete as directed by Banks Engineer.	Nos	4.00		
iii	Providing and fixing CP Brass Two-way Bib Cock for EWC - Parry ware make (catalogue ref. No. G1934A1), fixed to Faucet with hose & hook - Parryware make (catalogue ref. No. T9941A1) with CP wall flange and necessary hardware like brass screws, washers, joints sealed with silicon sealant etc. complete.	Nos	4.00		

iv	Supply&Fixing,"Parryware make off White paste colour glazed urinal of top inlet with on pair of concealed non corrosive brackets, sensor type flush valve C.P . spreader , connecting tube , waste coupling with dome grating, bottle trap etc.,installing the urinal to plumbing complete with all accessories,testing,cutting walls wherever required, restoring the same to their original conditions with required materials, testing the installation, commission etc., complete. 1.Urinal Make : Parryware, Model : C0583 (New Magnum) 2. Waste coupling Make : Viking 3.Bottle trap Make : Jaquar, Model : 769 L 300 4. Sensor Flush valve Make : Jaquar, Model : F/V for urinal INSTL SNR-STL-5108	Nos	4.00		
v	Providing and fixing CP Brass Angle Valve in kitchen,urinal for water purifier - Parryware make (catalogue ref. No. G1907A1) with CP wall flange with SS waste pipe and necessary hardware like brass screws, washers, joints sealed with silicon sealant etc. complete.	Nos	6.00		
vi	Providing and fixing CP Brass Long Body Bib Cock with Wall Flange for Washing machine with necessary hardware like brass screws, washers etc. complete.	Nos	3.00		
vii	Providing and fixing CP Brass Sink Cock with Wall Flange of Parryware make (catalogue ref. No. G1921A1) for Kitchen sink with necessary hardware like brass screws, washers etc. complete.	Nos	1.00		
viii	Providing and fixing brass ball valve for external plumbing line including scaffolding etc complete as directed by the Bank's Engineer.				
	a) 25mm dia	Nos	2.00		
ix	Providing and fixing of heavy duty brass CP 150 mm square grating in floor traps as required as per direction Banks engineer	Nos	6.00		
x	Providing and fixing CPVC water supply pipes (CTS SDR 11 operating pressure 7 bar @82 Deg C and 28 bar @ 23Deg C) with necessary cpvc fittings with making necessary chasing in the walls/floor and making good the same including the cost of clamps, cpvc solvent cement, labour charges etc. and connecting to the existing water supply system complete as directed by Bank's Engineer. the rate include disconnecting and removing of existing plumbing items and testing etc				
	a) 15mm dia	Rft	125.00		
	b) 20mm dia	Rft	145.00		



xi	Providing & fixing in position under floor/ against wall in chases Rigid PVC Pipes (6kg/ sqcm), specials of make as mentioned below of approved make conforming to IS:4985 using lubricant as per manufacturer's specification, including cutting the pipes square to the required lengths, necessary excavation, chasing & restoring to the original condition, testing for water tightness etc., complete as directed by Bank's Engineer. The rate including S/l of necessary Upvc fittings such T,Y,bend,elbow etc				
	a) 50mm dia	Rft	40.00		
	b) 75mm dia	Rft	20.00		
	c)100 mm dia	Rft	15.00		
xii	Providing and fitting & fixing stainless steel sink of approved make of size 610x457x255 mm (Nirali - Olympia or Equivalent). The rate should be inclusive of cost of cutting granite slab for fixing the sink in position, C.P. waste, PVC waste flexible ring type pipe of 32 mm dia. up to length 3'-0" approx.etc. and finishing the same with white cement mixed with colour pigment etc. as directed by the Bank's Engineer.	Nos	1.00		
Sub Total IX, Plumbing work					

SUMMARY OF CIVIL & ALLIED WORKS

	Description of works	Amount in(Rs)		Amount in words
I)	Dismantling /Demolition work Civil Work			
II)	Brick & Concrete Work			
III)	Water Proofing Works- Wet area			
IV)	Stone/Tiling Works			
V)	Vinyl Flooring &Antistatic Flooring			
VI)	Door & Windows & Ironmongeries			
VII)	MS Grille Works & Rolling shutter			
VIII)	Plumbing works			
Grand Total :Civil & Allied works				

Total Amount in words: Rupeesonly

GST (taxes) will be extra

Place:

Signature & Seal of the Tenderer

Date:



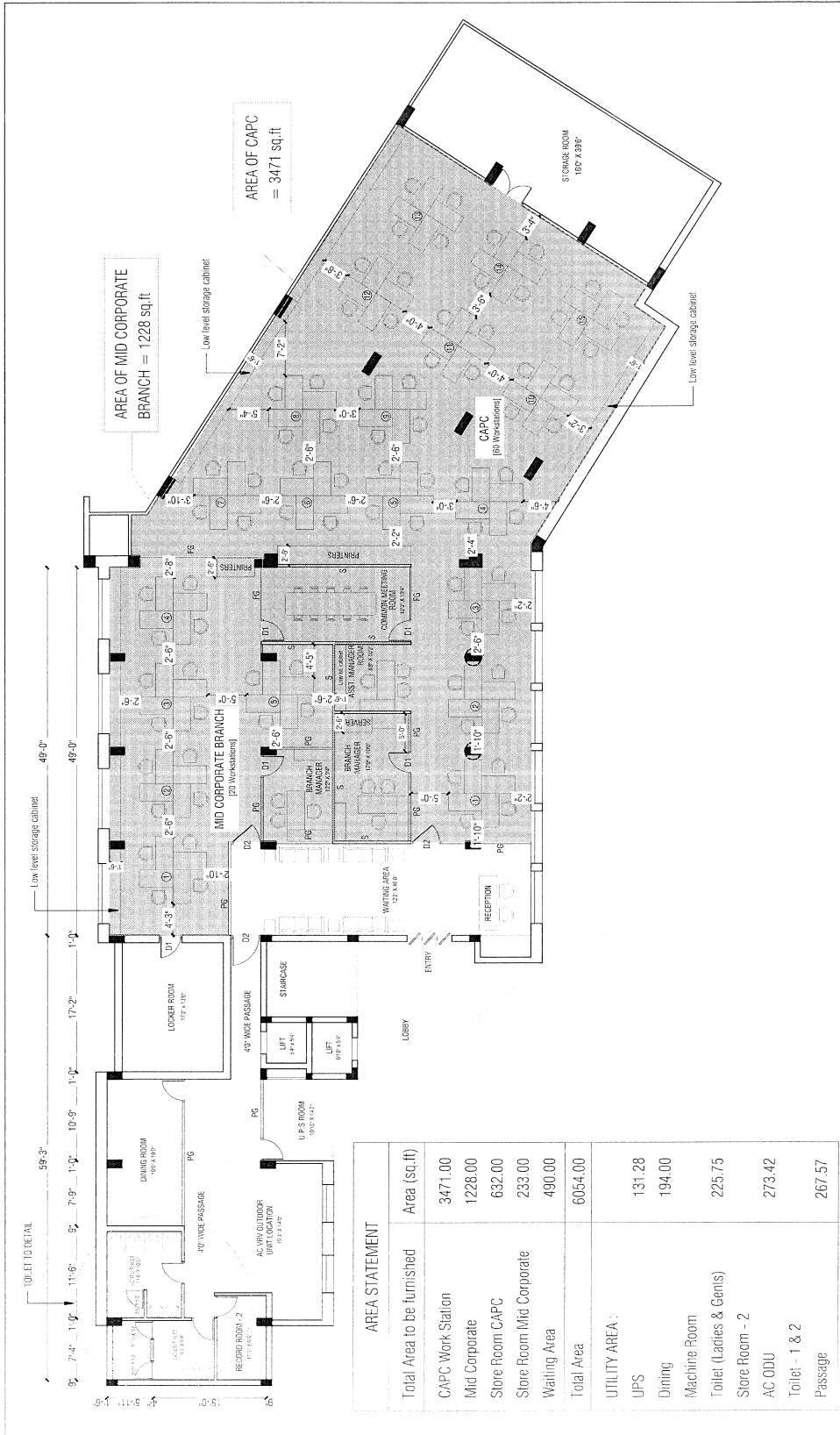

ARCHITECTURAL WORKING DRAWING		AREA STATEMENT	LEGEND	ARCHITECT
INTERIOR LAYOUT OPTION		AREA OF THE WORK STATION LAYOUT = 5236 Sq.ft	S - Solid Partition (7'0" ht. Solid) FG - Full Glazing (7'0" ht. Glazing) PG - Partial Glazing (3'0" Solid, 4'0" Glazing)	Laxmi & Shankar ARCHITECTS 3rd Floor, Anna Salai Complex, C-Block, 3rd floor, No - 183, Anna Salai, Chennai - 15. PH: 2220 0655, 2220 0966 Email: laxmiyashankar@gmail.com shankarlaxmiyashankar@gmail.com
DATE	10-11-2020	NO. OF WORKSTATION = 80	D1 - Door (3'0" wide) D2 - Door (4'0" wide)	
SHEET SIZE	A3			
DRAWN	Ar. Niharika			
APPROVED	Ar. Ramsprayan			

PROPOSED WORKSTATION LAYOUT FOR
INDIAN BANK AT ANNA SALAI, CHENNAI.

