

(A GOVT. OF INDIA UNDERTAKING)  
**ZONAL OFFICE, ASANSOL**  
**NOTICE INVITING TENDER**

Indian Bank, Zonal Office Asansol, invites competitive sealed tenders in the prescribed format on item rate basis two bids (technical & financial) systems from the interested, reputed, well experienced contractors / firms for the below mentioned work at new / alternate premises at Agradwip Branch (Rural) at Vill & PO- Agradwip, PS- Katwa, Dist- Purba Burdwan, WB- 713502.

Tender document along with other details may be downloaded from Bank's web site [www.indianbank.in](http://www.indianbank.in) or may be obtained from **Premises & Expenditure Department, Zonal Office Asansol, Udrej Bhavan, 2<sup>nd</sup> Floor, 8 G.T. Road, Asansol, Paschim Burdwan- 713304, W B,** as per following scheduled.

1	Name of work	Interior Furnishing, Electrical and Data Cabling Works etc. at new / alternate premises of Agradwip Branch (Rural) at Vill & PO- Agradwip, PS- Katwa, Dist- Purba Burdwan, WB- 713502.
2	Estimated Cost	Rs. 5,89,545.00
3	Publication of "Tender" inviting offers	15.01.2022
4	Submission of Tender	15.01.2022 to 31.01.2022 upto 4:00 P.M.
5	Opening of Tender	01.02.2022 at 3:00 P.M.
6	Date of Commencement	7 days from date of issue of letter awarding the job.
7	Time of completion of job	Maximum 25 calendar days from the date of issue of work order
8	Defect liability period	12 Months from virtual completion of work as certified by the architect, provided to the satisfaction to the Bank.
9	Tender Fee	Rs. 500/- in the form of DD/IOI in favour of Indian Bank payable at Asansol (non-refundable).
10	Earnest Money	Rs. 5000/- in the form of DD/IOI in favour of Indian Bank payable at Asansol. (The EMD of the unsuccessful bidders will be returned within 45 days from the date of opening the tender. No interest will be paid on the Earnest Money deposit.)
11	Liquidated Damages for delay	If the work is not completed within the stipulated period of time an amount of Rs. 1500/- to be deducted from each 2 days of delay.
12	Payment Terms	Neither advance nor Interim payment will be made. Payment will be made on satisfactory completion of the job on the basis of actual measurements. Income tax will be deducted as per the rules. Retention money 10% will be deducted from the bill and to be released after 12 months from the date of virtual completion provided no defects is observed during this period.
13	Documents to be attached with the Bill	Work Completion Certificate from Branch/Office Head, Manufacture Certification, Bills & 4-5 Photographs showing completion status of work.
14	Retention Money	10% (Including Earnest Money)
15	Terms and Conditions	As per Technical Bid – Part B (enclosed)

**Tenders Documents: - Technical Bid and Financial Bid.**

**A) Technical bid: Part-A & Part B**

**B) Financial bid: Schedule of Quantity**

The duly filled in offer completed in all respect in a separate sealed covers marked "Technical Bid" & "Financial Bid" and superscribing "Electrical Works, Light & Fan Fitting and Data Cabling Works etc. At new premises of Agradwip Branch (Rural)" on top and name, address & contact no. of the vendor at bottom left corner should be addressed to

**The Zonal Manager**  
**Indian Bank, Zonal Office: Asansol, Udrej Bhavan,**  
**2<sup>nd</sup> Floor, 8 G.T. Road (West), Asansol – 713304,**  
**Dist- Paschim Burdwan, WB**

The Bank will not be bound to accept the lowest tender and reserves the right to accept or reject any or all the tender without assigning any reason whatsoever. Late / delayed tender shall not be accepted after due date and time of submission of tender.

**Date: 14.01.2022**  
**Place: Asansol**

**(Zonal Manager)**

**FORM OF TENDER**

The Deputy General Manager  
Indian Bank,  
Zonal Office Asansol,  
Udrej Bhavan, 2<sup>nd</sup> Floor, 8 G.T. Road,  
Asansol, Paschim Burdwan- 713304, WB

Dear Sir,

**SUB: Invitation of Quotation for Interior Furnishing, Electrical, Data Cabling Works for new Premises of Agradwip Branch at Vill & PO- Agradwip, PS- Katwa, Dist- Purba Burdwan, WB- 713502**

I/We the undersigned have examined the tender documents and the site of works as hereby submit this tender amounting the sum of Rs.

and should the same be accepted hereby undertake to execute, complete and maintain all works as set forth in the schedule of quantities and Specifications in accordance with the conditions of Tendering, General Conditions of Contract, and the rates quoted by us in the aforesaid schedule of quantities all here to annexed or in default thereof to forfeit and pay to INDIAN BANK the sum of money mentioned in the aforesaid Documents.

I/We agree to abide by this Tender for the period of three months from the date fixed for opening of the same.

I/We undertake to complete and deliver the whole of the works covered under this tender within a period of 25 Calendar days from the date of issue of work order.

I/We shall be bound by the terms and conditions of the tender documents and our accepted tender.

Thanking you,

Yours faithfully,

[Signature of Tenderer]

Place:

Date:

Name:

Witness:

Address:

Name:

Mob. No.

Address:

Seal:

**GENERAL INFORMATION OF THE FIRM**

1	Name of Firm	
2	Head Office/ Main Office Address	
3	Address on which Correspondence should be done.	
	Tel. No.	
	Mobile no.	
	E-mail address	
4	Place of incorporation / registration	
5	Constitution of Firm	
	i) Specify, if the firm is	
	a) An individual	
	b) A proprietary firm	
	c) A firm in partnership	
	d) A Limited Company or Corporation	
	ii) Attach a copy of Proprietorship / Partnership / Deed / Article of Association / Incorporation of Company as the case may be	
6	Give particulars of empanelment with Public Sector Banks	
7	Give particulars of Work Experience of minimum 5 years of similar type of work	
9.	Other details: a) PAN No. b) GST Registration No. (Copies to enclosed)	
10.	Any other information considered necessary but not included above	
11.	Names and Titles of Directors and officers with designation to be concerned with this work with Designation of individuals authorized to act for the organization	
12.	Was the applicant ever required to suspend works for a period of more than six months continuously after commencement of works? If so, give the name of the project and give Reasons thereof.	
13.	Has the applicant or any constituent partner in case of partnership firm, ever abandoned the awarded work before its completion? If so, give the name of the project and give reasons thereof.	
14.	Has the applicant or any constituent partner in case of partnership firm, ever been debarred/ black listed for tendering in any organization at any time? If so, give details	
15.	Has the applicant or any constituent partner in case of partnership firm, ever been convicted by a court of law? If So, give details	

**Note: Only self-attested copies to be furnished.**

**Date:**

**Place:**

**Signature & seal of the applicant**

GENERAL TERMS & CONDITIONS OF THE CONTRACT

Unless otherwise provided for in the contract Documents, these general conditions shall apply to the work of all the specification attached herewith.

1. Attested copies of upto date Contractor's Trade License, latest Income Tax Return, GST will also have to be submitted along with the Tender, without which the tender will be considered as incomplete and liable to rejection. Contractor has to submit latest valid electrical license certificate issued by WBSEB, CESC or any Govt. authority.
2. The tender shall remain valid for three months from the date of opening of the tender.
3. The tender is to quote his rate in ink in both English figures and in English word.
4. All corrections in the tender should be initiated by the tender before submission of the tender.
5. Each page of the tender documents must be signed by the tenderer. All rates and prices quoted shall be in ink only.
6. Canvassing in any form is strictly prohibited and any tenderer found to have resorted to canvassing should be liable to have his tender rejection summarily.
7. In the event of the tender being submitted by a firm, it must be signed by a person holding a power of attorney authorizing him to do so, such power of attorney should be produced along with the tender.
8. The contractor shall provide all the necessary supervision during the execution of the works as long thereafter as the architect may consider necessary (which approval may at any time be withdrawn) is to be constantly on the works and shall give his whole time to the supervision of the same. Such authorized agent or representative shall receive on behalf of the contractor directions and instructions from the Architect or Architect's representatives.
9. The contractor shall employ in and about the execution of the only such persons as are careful skilled and experienced in their trade and calling and the Architect's shall be at liberty to object to and require the contractor to remove from the site any person employed by the contractor in or about the execution of the work who in the opinion of the Architect misconduct's himself or is incompetent or negligent in the proper performance of his duties and such persons shall not be again employed upon the works without permission of the Architect.
10. The contractor shall inspect and examine the site and its surrounding and shall satisfy himself before the submission of his tender as to the nature of the site, the quantities of the nature of the work and materials necessary for the completion of the works and in general shall obtain all necessary information's like risks contingencies which may influence or effect his tender.
11. Rate quoted shall cover in all the items like transport, octroi, value added tax, incidental Charges, duties, any other statutory govt. taxes, etc. for completing the works. No claim will be entertained by the bank due to any fluctuation in the rate of Labour, material, Freights, taxes, duties etc. at any stage. The rate quoted will be firm during the entire period of work. Only GST will be paid by bank as per govt. laws. Tenderer must have valid GST registration no. The contractor has to arrange photo passes in prescribed Performa for the man working in the site. The contractor has to pay all legal dues to the workman engaged by him during the work as per law in force. Contractor Labour ( Regulation & Allowance 1970, P.P.Act 1952, Bonus Act 1965, Est. Act 1972, Gratuity Act 1972, and latest amended Acts are to be complied to the Labourers for the execution of the work.
12. If the contractor fails to pay legal dues to Labour or any workmen, bank will reserve the right to deduct such due, from the final bill of the contractor and arrange for disbursement to the concerned Labour or workmen.
13. Work has to be carried out at the site without affecting the normal activities of the Bank. The contractor will be responsible for any damage caused during the period of work and has to pay damage.
14. Payment upon the Architect's Certificates be made by INDIAN BANK to the contractor after such certificate has been delivered to the Zonal Manager.
15. Liquidated Damages for delay - If the work is not completed within the stipulated period of time an amount of Rs. 1500/- to be deducted from each 2 days of delay.
16. Material and workmanship shall conform to relevant ISI specification. Contractor has to follow the instruction of the Architect or this authorized representatives during the period of work.
17. The quantities given in the schedule are approximate and may vary as per requirement of the site. Payment shall be made on the basis of actual measurement of the work to be certified by Architect. Measurement shall be made as per relevant IS code. **No discounts are allowed on the overall amount. Any discount to be given in the item wise rate only.**
18. MAXIMUM time to complete the work is 25 Calendar days from the date of issue of work order.
19. The contractor will get the bill amount after completion of work only. No advance money will be given prior to the start of work. or dumping the materials at site.
20. The contractor has to clear all the materials, tools, tackles, scaffoldings etc. after completion of work without any extra charge.
21. The Bank shall not be liable for or in respect of any damage compensation payable at law in respect or in consequence of any accident or injury to any workmen or other person in the employment of the contractor and the contractor shall indemnify and keep indemnified the bank against all such damages and compensation( save and except as aforesaid) and against all claims, demands, proceeding costs, charges and expenses in respect thereof or in relation thereto.
22. Contractor has to submit the Earthing Report Test and other Electrical Audit report certificate of the branch along with the final Electrical Circuit Diagram during the submission of final bill, to be issued by an Electrical Engineer having valid Electrical license of WBSEB / CESC /or any Govt. authority, without any extra charge. Without submission of these reports no payment will be release.



23. Contractor has to submit detail analysis of rates of all the items to justify their quoted rate. Without submission of the analysis tender will be cancelled.
24. The Indian Bank does not bind itself to accept the lowest or any quotation and reserves to itself the right of accepting the whole or any part of the QUOTATION and the Quotation offered shall be bound to perform the same at the rate quoted.
25. No employee of the Indian Bank is allowed to work as a contractor for a period of two years of his retirement from Indian Bank service, without the previous permission of the Indian Bank. The contract is liable to be cancelled if either the contractor or any of his employees is found at any time to be such a person who had not obtained the permission of the Indian Bank as aforesaid before submission of the quotation or engagement in the Quotation officer's service.
26. **The retention amount at 10% on the value of the bill paid will be held by the Indian Bank.** The Retention Money (10%) will be released after 15 days of expiry of Defect Liability Period (12 Months from the date of completion of work), subject to satisfactory rectification of defects noticed, if any. Retention Amount held in our Bank's Book will not carry any interest.
27. Rates shall be quoted on the proper form of the quotation alone. All the entries to be made legibly in ink only. Rates written in pencil or any other mode shall not be considered for evaluation and will be rejected.
28. Employer reserves the right to insist on selection of material, workmanship, detailing and finishes, which they consider, is appropriate, and suitable for the intended use. The contractor is not eligible to claim extra on this account.
29. Employer will require the contractor to produce, samples of all the materials, accessories/ finishes prior to procurement/ manufacture. The samples of the materials for the work shall be got approved from the Employer. Failure to comply with these instructions can result in rejection of the work/materials.
30. The Contractor should note that he should execute his part of work without causing any damage to any component of the building and also without disturbing the occupants. Any damage so caused shall be made good at the cost & risk of the Contractor.
31. The successful contractor shall also be responsible for the safety and security of all their materials and also for ensuring fire prevention steps at all times in the working premises including their part of the work. The successful contractor has to place full time representative at site, the representative should have thorough subject knowledge.
32. The contractor shall maintain all registers as required by the Regional Labour Commissioner and should furnish the same to the Bank or its representative as and when required.
33. Bank shall not be responsible for any loss or damage to the contractor/ labour due to any natural calamity during the course of construction. Contractor is liable to make good all the damages if any, till the work is completed and handed over to the Bank authorities
34. The contractor /vendor failed to carry out the works as per schedule/Quality, the same shall be carryout with different agencies and the actual amount will be deducted from the contractor bills.
35. Any work got executed in poor workmanships pointed out by the Bank' Official will have to be dismantled and redone by the Contractor on his own cost.

**DECLARATION:**

I / We hereby declare that I / We read and understood the above terms and conditions and that we shall abide by them if the work is awarded to us.

Signature & Seal of the Contractor

ARCHITECT

SANJOY PAUL &amp; ASSOCIATES

INDIAN BANK  
AGRADWIP BRANCHSCHEDULE OF SPECIFICATIONS AND QUANTITIES FOR INTERNAL FURNISHING WORKS AT INDIAN BANK  
AGRADWIP BRANCH

SI.No	PARTICULARS	Qty	Unit	Rate	Amount
1.	<b>FALSE CEILING ( Gypsum board )</b> --only for Managers room and ATM				
	<b>A.FALSE CEILING (GYPSUM BOARD)</b> : Providing & Fixing gypsum board false ceiling system in 2 steps / In combination the grid ceiling tiles ceiling vertical profile using 12.5mm gypsum plaster board on G.I.metal frame work. The frame work made up of perimeter channels of 20 x 27x 30x 3657mm fixed on wall & partitions and ceiling sections of 80 x 26 x 0.5x 3657mm as a cross member provided at 457mm c/c and the intermediate channel of 15x 45x.09 x 3657mm as a main runner at 1220mm c/c suspended by means of G.I. angle 25 x 25 x .05 mm from the existing ceiling by means of M.S. rawl plug with bolts/screws at 1200 mm c/c max. The joints of gypsum board to be taped 3 times and sealed with jointing compound. Finished with one coat of primer and min 3 coats colour or matching spectrum colour complete as per detail and specifications in drawing incl. all lights, diffuser cuttings complete. Rate to include the drops also.	210	sft		
2.	<b>PARTITION</b>				
	Providing and fixing partition in position as per design with 2" x 2" teak wood section .The frame work will be cladded with 6mm thk. commercial plywood both side and to be finished with approved 1.0 mm laminate as per design with approved band adhesive, extra frame work to be fixed for fixing glass. in the glazed partition 10 mm thk. clear float glass to be provided duly fixed with white beach/white ceader lipping 50 mm x 25 mm all complete duly reddish brown/ rose wood colour polish with melamine finish. The work should be completed as per specification, design & approval of the Architect. For the door 32 mm solid core bwp Flush door with a frame work of white beach/ white ceader size 75 mm x 62.5 mm with necessary hold fast fixed to the wall/partition, finished with 1.0 mm laminate and lipping in all sides and 1.5" x 1.5" white beach/ white ceader wooden moulding to be provided along the periferi of the door frame. supplying and fixing door accessories as door closure, brass hinges, Cylindrical / Night latch locks and s.s handle. ( Laminated skirting of 4" ht. as per approved colour to be placed all around the partition)				
2.A.	Partly glazed partition				
a	Partly glazed partition upto 4' ht ,including wicket gate	82	sft		
b	Partly solid and partly glazed partition 8' ht for Managers cabin	180	sft		
c	Partly glazed partition upto 7' ht for cash cabins	180	sft		
d	Sliding door of block wood with Aluminium channel at the top	21	sft		
e	12 mm th.. <b>TOUGHEND GLASS</b> at cash counter at front with 3" dia central gap for communication and 2.5" gap throughout at the bottom of the glass and at the open counter	36	sft		

3.	<b>Main Entrance Door</b>				
a	Providing and fixing glass door -2 way - 5' x 7' for main entrance of branch- . Aluminium frame size - 85 mm - 90 mm as top and bottom rail and vertical member of 83.5 mm , with a decorative handle of 600 mm of approved brand, floor spring , locks, etc all complete. 12 mm thk. etched glass and INDIAN BANK logo to be provided and edge should be machine beveled polished. the work to be completed as per design and specification of the architect all complete. the wooden portion to be duly melamine polished.	35	sft		
b	Providing and fixing Aluminium frame with 12mm glass at the front wall for ATM comprising of appropriate 83.5mm vertical members, approximate 85-90 mm top & bottom , approximate 83.5mm middle member, Black powder coated. . 6 mm clear polycarbonate sheet with scratch free film on both sides. Wool pile / Weather strip on one vertical member. . Overall area of front wall is 60 Sq.Ft. The job also includes one glass door and rest portion fixed glass embedded into aluminium frame.	60	sft		
	<b>TABLE</b>				
4	Providing and fixing tables made out of 18 mmth. commercial blockboard of approved make cladded with 1.0mm laminate (color with vertical grain ) as per design in all visible areas. All the exposed edges to be covered with wooden lippings and mouldings to be beachwood colour finish The drawers are to be made out of 18 mm thk. plywood duly 1.0 thk. laminated in the front, sides to be made out of 18 mm blockboard and bottom to be made out of 6 mm BWP and termiteproof plywood and it should play in drawer telescopic sliding channels. The inside of the drawer and the table to be duly polished. A legrest to be provided duly polished made out of 18mm thk.commercial blockboard. A shutter to be made by 18mm th. blockboard cladded with 1.0mm laminate. The necessary locks handles to be provided in each drawers and shutters. The table should have key board tray and ups trolley. The necessary wire managers to be provided on the tables and provision for lights to be kept in the front of the table. CPU to be fixed with the table at the bottom and it should not be placed on the floor or on the trolley.The work to be completed as per design and approval of Architect. 12 mm th. clear glass on top of Branch Manager's table				
a	Branch Manager ---3' x 6'	18	sft		
	<b>Cash / Open Counter</b>				
a	Providing and fixing top, front & side of cash counter made out of 18 mm BWP and termite proof blockboard as per design cladded with 1.0 mm thk. Laminated on side and front & the edges to be finished with necessary white beach or white cedar lippings, mouldings, etc. Special 6" drawer to be made for the cash with dividers of 12 mm plywood. the front of the drawer made out of 18mm blockboard finished with 1.0 mm laminate, sides 12 mm th. plywood and bottom to be made of 6 mm plywood. the inside and sides of the drawer to be duly polished. The drawers and shutters to be provided with necessary drawer sliding channels, hinges, locks etc.  A leg rest to be provided made out of 18 mm thk. blockboard duly polished. Inside of the unit to be polished in the matching tone. All visible areas to be covered with beach or cedar lippings, mouldings with reddish brown colour polish. Wire manager, CPU trolley, keyboard tray to be provided. 4" ht. laminated skirting to be provided in all visible ares and 12 mm thk. x 18" wide Plain Glass to be provided at counter top customer face horizontally at 3'-9" lvl. The work should be completed as per specification. Cash counter --- 9 rft Open counter --14 rft (spec. same as above).	9	rft		
b		9	rft		



6.	<b>Side Units : Low ht. Cabinet</b>				
	<p>Providing and fixing Side Unit/Back Unit made out of 18 mm th. commercial blockboard finished with 1.0mm laminate in all exposed areas. The drawers to be made out of 18 mm commercial blockboard in the front cladded with 1.0 mm laminate, side to be made out of 12 mm plywood and bottom made out of 6mm plywood duly painted in matching tone and it should play on drawer sliding channels. The shutters to be made out of 18mm blockboard and should play on drawer sliding castors on powder coated channels. The necessary locks, handles, etc to be provided. 4" laminated skirting to be provided all along the visible areas. Inside of the unit to be enamel painted of reddish brown colour and matching tone. All the exposed edges of the boards/plywoods to be covered with wooden lippings/mouldings duly polished all complete. The work to be completed as per approval and specification of the Architect.</p> <p>(3'-3" ) x 2'-6"ht. -- low ht. 3' x 4' ----- electrical panel board</p>	21	sft		
7.	<b>Standing Writing Ledge</b>				
	<p>Providing and fixing writing ledge with 10" wide as per design made out 18mm blockboard with necessary groove patterns 1.0mm laminate (color, vertical grain ) to be cladded. 12 mm thk. machine polished glass to be provided on top of the writing ledge.</p> <p>Small boxes to be made out of 18 mm th. blockboard to be made on top of the writing ledge finished with 1.0 mm laminate , inside enamel painted. The ledge finished with 1.0mm laminate, inside enamel painted. The work to be completed as per design and approval of the Architect. -</p>	5	rft		
8	<b>Notice board</b>				
	<p>Providing and fixing soft board with necessary frame work with 12 mm bwr plywood on top jolly board to be fixed finished with fabric @ Rs. 100, with necessary moulding duly polished along the periphery.</p>		sft		
9	<b>Complain and Cheque drop box</b>				
	<p>Providing &amp; fixing Sal wood frame, fixing of 12 mm plywood with 1 mm thk. laminate finish, openable shutter for outside area. 8"wide x 18" length x 15"ht x 2 nos</p>		sft		
	<b>Total</b>				
<b>GST EXTRA @ 18% AS PER GOVT. NORMS</b>					

**DETAIL SCHEDULE OF SPECIFICATIONS WITH QUANTITIES FOR  
ELECTRICAL WORKS AT INDIAN BANK, AGRADWIP BRANCH  
M/s Sanjay Paul & Associates, Architect**

SL.NO	DESCRIPTION OF ITEMS	UNIT	QTY	RATE	AMOUNT
<b>1</b>	<b>POINT WIRING i/c CIRCUIT WIRING</b>				
a	Wiring for the following light / wall / fan/ exhaust fan, call bell points with 1.5 sqmm PVC insulated stranded Cu conductor wire in concealed / exposed medium grade ISI marked PVC conduits as called for in specification including providing 1 sqmm insulated Cu earth wire including cost of circuit wiring from DB to the point with 2x2.5 sqmm + 1x1.5 sqmm complete with providing and fixing of accessories like saddles, clamps, flexible pipes, dash fasteners etc. modular switches with face plates , switch boxes, grid plates are included in the above rate . The rate shall include the cost of circuit wiring .				
	1. Primary points	nos	10		
	2. Loop points	nos	8		
	3. Primary point (wall and exhaust fan controlled by 1 switch and one 5 Amp. socket )	nos	10		
	The above work includes extensions of points with flexible conduits as reqd. to table bottoms etc. as reqd				
b	Wiring for 5Amp light plug point with 2 x 2.5 sq mm + 1 x 1.5 sqmm PVC single core copper wire in PVC polythene pipe with galvanized iron junction & switch boxes & clip in type, 6 Amp modular type switches,5Amp socket with all accessories, T&P & as directed by the Engineer-in-charge at counter/table. maximum 6 points per circuit , circuit shall not be paid extra.	nos	8		
c	Wiring of 15 Amp power sockets with switch on separate board with 2x4 sq mm + 1x1.5 sqmm) PVC single core copper wire in PVC/ Super polythene pipe with galvanized iron junction & switch boxes & clip in type 6 Amp modular type switches with all accessories, T&P & as directed by the Engineer-in-charge at counter/table.maximum 6 points per circuit , circuit shall not be paid extra.	nos	6		
d	Wiring of AC points with 20 Amp plug socket with switch on separate board with 2 x 6 sq mm + 1 x 2.5 sqmm PVC single core copper wire in PVC polythene pipe with galvanized iron junction & switch boxes & clip in type 20 Amp modular type switches with all accessories, including providing metal clad socket with SPMCB in sheet steel enclosure T&P & as directed by the Engineer-in-charge . 1 point per circuit ,circuit shall not be paid extra	nos	2		
e	Wiring for UPS power socket with 2 x 2.5sq mm + 1x1.5 sqmm PVC single core copper wire in PVC polythene pipe with galvanized iron junction & switch boxes & clip in type including 3 nos. 5 amp . sockets 1 no. 16 amp. switch. One indicator modular type with grid and face plates modular type.(maximum three stations per circuit .Circuit shall not be paid extra )	nos	8		
e	Concealed conduit wiring to call bell point with one gong bell of 6" dia placed at strategic point with 6 Amp switch bell push clip in type modular type fixed on G.I. boxes placed at skirting level for emergency use, the wiring details are as per Sr .no. - 01. The places as located in drawing & as per direction of Engineer-in-charge.	set	1		
<b>2</b>	<b>DISTRIBUTION BOARDS</b>				
	Distribution boards: Design, manufacture, supply, of 1.6 mm th. Sheet steel fabricated surface / recessed mounted, vertical configuration , double door type, distribution boards ( factory made with powder coating )				
A	<b>DB for normal Lighting and Power</b>				
	4 way TPN DB with				
	Incoming :				
	40A 4 Pole MCB	nos	1		
	Outgoing :				
	12 nos SPMCB				
B	<b>DB for Airconditioning</b>				
	4 way TPN DB for AC with				
	Incoming :				
	63A 4 Pole MCB	nos	1		
	Outgoing :				
	12 nos SPMCB				
C	<b>DB for UPS Input</b>				
	4 way TPN DB for AC with				
	Incoming :				
	40 A 4 Pole MCB ---1 no	nos	1		
	Outgoing :				
	60 A DP MCBs ----- 2 nos				
<b>3</b>	<b>UPS Output</b>	Set	1		
	40A DP MCB in MS box ( for UPS OUT PUT in UPS room )				
<b>4</b>	<b>UPS DB</b>				
	Distribution boards 1 No. 60A 2 pole MCB isolator	set	1		
	Out going 10 No. 6/10 SP MCB s ( for UPS distribution boards)				

<b>5</b>	<b>SUB MAINS WIRING</b>				
	Supply of all required materials and wiring to submains with following number and sizes of PVC insulated 1100 volt grade standard copper wire run inside pre-laid PVC conduit pipe of ISI mark as required and copper wire as earth continuity conductor and complete in all respect including making good to all damages caused and as per the direction of Consultant and Engineer-in-charge.				
a	4 x 6 sqmm + 1 x 2.5 sqmm Cu wire general ( for Light and Power DB )	mts	50		
b	4 x 16 sqmm + 1 x 2.5 sqmm Cu wire general ( for AC DB )	mts	35		
c	4 x 10 sqmm + 1 x 4 sqmm Cu wire general ( for UPS supply )	mts	75		
d	2 x 6 sqmm + 1 x 2.5 sqmm Cu wire general ( from UPS room to DB )	mts	50		
e	Supplying and laying 2 x 2.5 sqmm Cu. Wire in PVC conduit from panel to Sign board	mts	30		
<b>6</b>	<b>EARTHING</b>				
a	Providing and fixing of chemical earth electrode made out of 50mm dia class-B Asaha lock or equivalent 2m length with copper plate made out of 600 x 600 x 3.15 mm tinned copper plate along electrode with one number 40x5mm tinned copper strip grazed with the plate buried vertically with top edge of the plate at a depth of 1500 mm with arrangements for termination of copper strip of earth continuity conductor including cost of charcoal, saltoreign soil, water pouring arrangements brick massionry encloser on top with R.C.C cover complete with labour and material as per direction of Engineer-in-charge as per IS:3043 1987 ( for UPS )	set	1		
b	do as above with 600 mm x 600 mm x 6mm th. G.I plate ) for MAIN PANEL )	set	1		
<b>7</b>	<b>EARTH STRIPS / WIRES</b>				
	Supply, installation, effecting proper connection , testing, and commisioning of the following size CU. / G.I earth strip / wire or in recess as reqd.				
a	25 mm x 3 mm copper earth strip	rmt	25		
b	10 sqmm insulated Cu. Earth wire in PVC conduit pipe (for UPS)	rmt	20		
c	25 mm x 3 mm G.I earth strip	rmt	20		
d	8 mm dia G.I earth wire	rmt	20		
<b>8</b>	<b>FITTINGS AND FIXTURES</b>				
a	Supply, installation and testing of recess LED lights fittings (40 Watt) of square type - 2' x 2'. with all accessories complete of Philips / Havells make as required as per direction of Engineer in charge.	nos	3		
b	Supply, installation and testing of recess LED light fittings Nos. (10 watt) of round type -6" dia with all accessories complete of Philips /Crompton/ Wipro make as required as per direction of Engineer in charge.	nos	5		
c	Supply, installation and testing of single tube lights T5 patty Nos fittings (36 watt ) -LED type of surface mounting with all accessories complete of Philips/Crompton / Wipro make as required as per direction of Engineer in charge.	nos	14		
d	Providing and fitting of 450 mm sweep Wall mounted fan of approved make .	nos	8		
e	Providing and fitting of 1200 mm sweep celing fan of approved make .	nos	3		
f	Providing and fitting of 400 mm sweep cabin fan of approved make .	nos	3		
g	Providing and fitting of 400 mm sweep Exhaust fan of approved make .	nos	3		
h	Providing and fitting of call bell of approved make .	nos	1		
i	Providing and fitting LED Batten Light -2' length for cash counter-8W	nos	2		
j	Providing and fitting of modular fan regulator of approved make .	nos	3		
<b>9</b>	<b>PHONE WIRING .</b>				
a	Wiring for telephone points with 2 pair 4/5 pair 51mm dia ATC (annealed tinned Cu wire ) with pvc insulated PVC sheathed telephone cable from tag block to the point including providing ferrules at both ends and termination at both ends including providing RJ 11 outlet , faceplate and mounting box, complete of modular type (where 2 such points are shown , 2 such wires to be provided ).This work includes providing PVC conduits in chases from the raceway to the point .	nos			
b	Supplying, laying, effecting ,terminations, testing and commissioning of 0.51mm dia Cu conductor, twisted, colour coded with polythene capor barrier, telephone cables in the existing tray as reqd. from building tag block to the floor as reqd.				
b i	1x10 paired armoured cable for P&T connections	rmt			
b ii.	Supply and fixing 20 pair krone tag block with enclosure	nos			

<b>10</b>	<b>MAIN PANEL BOARD</b>				
<b>a</b>	Supply, delivery, installation, testing, commissioning, of L&T indoor wall floor mounted type distribution boards made out of 2 mm thk. CR sheet metal duely acid treated premised & painted with 2 coats of enamel paint compartment arrangement for each equipment & bus bar chamber on the top of the panel running horizontal through out its length duly lamp, vermin proof having provision cable by conduit entry, earthing stud as per specification mentioned below duly factory wired confirming to the relevant ISS & as per special condition of contract, making good the damages M.S. Cubical type Panel board should have hinged door at the front. The panel shall be provided with all accessories & following arrangements complete in all respect & direction of EIC (before fabrication of panel board drawing is to be approved by Engineer-in-charge).	set	1		
	<b>Incoming-</b>				
	160Amp TP MCCB --1 no				
	0-500V CTs --3 nos				
	3 nos. indication lamps with 3 fuses --1 set				
	200A 4P copper bus bar ---1 set				
	100A 4P copper bus bar ---1 set				
	125A -4P MCCB for ATM --- 1 SET				
	125A -4P MCCB for AC --- 1 SET				
	1No 125A- HRC FSU.with rewirable fuse links for generator				
	<b>Outgoing -</b>				
	100A 4P COS --2nos				
	63A 4P MCB --6 nos				
	63A DP MCB --6 nos				
	<b>Outgoing- 4 Nos 32A DP MCB for A.C</b>				
	2Nos 63 A TPN MCB for A.T.M				
	2Nos 63 A DP MCB for U.P.S incomer and outgoing				
	2 Nos 40 A DP MCB for LDB/PDB 40A DP MCB Spare				
	2Nos 32 A DP MCB for Glow sign board( Branch + ATM )				
	1No. VAF Digital meter with CT.				
<b>b</b>	<b>SWITCH NEAR METER</b>				
	Providing and fixing 200Amp MCCB in 16 gauge sheet cubicle box. of L/T DH -200 25KA (near meter ) completev with incoming and outgoing connections.	set	1		
<b>11</b>	<b>TIMER (1 for Branch and 1 for ATM )</b>				
	Supply & installation of Timer Box for Glow sign Supply comprising of the following :	set	2		
	2 no SP MCB				
	2 Nos 25A rated Contactor				
	2 no 24 Hours Timer				
<b>12</b>	Supply and erection of earth bus on wall ( min. length 0.3 mtr.) on insulator with drilled holes on the bus with GI bolt , nut , washer etc for the following:-				
	With (25x3) mm CU flat	each	2		
<b>13</b>	Supply & installation of 2 nos. 32A DP Changeover switch to be fixed and complete with one no.60A rated copper Bus bar for changing supply from one UPS to another with all accessories.	set	2		
<b>14</b>	Marking of all DB's & Main switches' Change over and power outlet points	job	1		
<b>15</b>	<b>DISTRIBUTION CABLE</b>				
<b>A</b>	Supply & lay 1.1 KV grade PVCA AL cable on wall having MS /HDP pipe protection near floor level and clamping as required for the following:-				
<b>a</b>	35 Sq mm 4 core Al with 2 nos 10 SWG GI wire-MAIN CABLE	35	Mtr		
<b>b</b>	16 Sq mm 4 core Al with 2 nos 10 SWG GI wire ---CABLE for generator	25	Mtr		
<b>d</b>	2.5 sq mm 2 core CU for UPS Plate Earthing	25	Mtr		
<b>e</b>	2 nos. 35 sq. mm. CU flexible wire through GI flexible pipe complete with end termination with CU sockets. ( Meter loop connection with Main SFU & Busbar)	10	Mtr		

B	Making end termination of 1.1 KV grade PVCA AI cable with supply of cable end box , brass Gland, CU crimping socket & jointing materials as required for the following:-			
a	35 Sq mm 4 core AI	2	Each	
b	16 Sq mm 4 core AI	2	Each	
18	COMPUTER LAN			
a	Supply,installaaton of rigid PVC conduit accessories bent flexible conduit etc and fixing by PVC bar saddle on wall or wooden surface	65	mt	
b	Supply ,installation of UTP cable in prelaid PVC conduit	65	mt	
c	Supply,installation of UTP cable patch chord 2 mts. Long including termination and socketing	8	Each	
d	Supply and fixing of RJ-45 UTP formation outlet -Cat-6e (1 module ) with front cover plastic /flush metal box on surface of wall	8	Each	
e	Supply and fixing of 24 port D-Link make 10/100mbps switch and front plate with cover flush metal box on surface of wall	1	each	
f	Supply and Installation of Cat-6-24 port patch panel	1	each	
g	Supply and Installation of 9U Metal rack HCL	1	each	
h	Supply and installation of UTP cable patch chord 1 mt including terminating and socketing Digi Link	8	Each	
			TOTAL	
	<b>GST EXTRA AS PER GOVT. NORMS — 18%</b>			

**LIST OF APPROVED MATERIALS FOR FURNISHING WORK AT INDIAN BANK, AGRADWIP BRANCH**

SL NO	ITEM	APPROVED MAKE/ MODEL
1	False Ceiling	INDIA GYPSUM / SAINT GOBAIN/ LAFARGE/ARMSTRONG
2	Inter mediate Channel/Ceiling Section/Aluminium Section	HINDALCO, JINDAL
3	Wood Frame Work/ Wood Section All wood must be well seasoned, free from knots, other defects, decay and defects due to handling and transportation. Wherever necessary, provide with anti – termite Treatment.	KAPOOR, 2 <sup>nd</sup> CLASS TEAK WOOD
4	Wood Skirting / Moulding/ Lipping/ Bidding / Door frame	WHITE BEACH/ WHITE CEADER
5	Modular furniture	GODREJ/ DECOR X/ SPACE WOOD/ METHODEX
6	Modular Toilet	MARINO/ GREEN
7	Fire Reterdent Paint	INDUSTRIAL GRADE OF NOBLE / VIPER
8	Plywood/ Block board (BWR GRADE)	GREEN PANEL, CENTURY, GREEN PLY
9	Flush Door	GREEN PANEL, CENTURY, GREEN PLY
10	Laminate (1.0mm thk.)	MERINO, GREEN LAM, CENTURY
11	Door Closure	GODREJ/ ARCHI (HEAVY DUTY)/ DORMA
12	Floor Spring :	GODREJ/ ARCHI (HEAVY DUTY)/ DORMA
13	Mortice Lock, Fitting	GODREJ, LINK
14	Handle	GODREJ/ HAFEKE/ DORSET
15	Screws	GKW / NETTLE FOLD/ APPROVED EQUIVALENT
16	Hinges	DORSET/ GARG/ EBCO
17	Sliding Drawer Channels	EARL BEHARI / CIEF
18	Adhesive	FEVICOL SH / PIDILITE (only marine type is allowed)
19	Soft board	JOLLY BOARD/ APPROVED EQUIVALENT
20	Vertical Blinds	MAC / ANNUMS/ UNIVERSAL/ VISTA
21	PVC Flooring	KRISHNA VINYL/ ARMSTRONG/LG
22	Glass	MODIGUARD / SAINT GOBAIN
23	Ceramic Tiles	KAJARIA/ JHONSON
24	Vitrified Tiles	KAJARIA/ JHONSON/ ASIAN
25	Tiles Chemical	Bal-endura / Latticrete
26	European WC / Wash Basin	Parryware / Hindware/ JAQUAR
2	Sanitary Fittings	Jaquar / Essco/ HINDWARE
28	G.I Pipe ( For Plumbing)	Tata / Jindal / Bansal
29	P.V.C Pipe ( For Plumbing)	Supreme / Oriplast/ FINOLEX
30	Readymade Keyboard / CPU Trolley ( metal	Ebco / Dortel
31	Paints ( Enamel / Acrylic Emulsion)	Asian Paints/ Nerolac/ ICI (as per BANK APPROVE COLOR)
32	Mirror	Modiguard / Saint Gobain
33	Carpet	Synthetic ( Close loop)
34	Wood Preservatives	STP Pentaphene Pale / Chloriphrophosh/BISON by BRITISH PAINT
35	Chairs	Décor – X/ GODREJ/ FEATHER LITE/ METHODEX
36	Wall Paper	Menara/Legend
37	All other items not covered above	As per sample approved by Employer /Consultant.

**LIST OF APPROVED MATERIALS FOR ELECTRICAL WORK AT INDIAN BANK, AGARDIH BRANCH**

SL NO	ITEM	APPROVED MAKE
1	MS pipe ISI mark. 16 SWG	BEC / NIC
3	M.S. fittings (Bend / Elbow / G.I Saddle / 3way circular box)	BEC / NIC
4	Wire PVC insulated copper flexible wire. FR	Finolex / Havell's
5	A.C. Starter	North-West / Crabtree/ MDS Legrand/indoasian
6	250 Volt 6/16 Amp. 3 pin modular type switch, socket	MDS Legrand / Crabtree / ABB/ Havell's
7	Capacitor	Mamal / L&T
8	Current Transformer	Kappa / L&T/ Schneider (CG) A.E
9	Changeover Switch	L&T / HPL / GEC / Havell's
10	Amps meter & Voltmeter 96x96 mm (Analog)	AE / IMP / L&T / ALSTOM / HPL / Havell's
11	Miniature Circuit Breaker & MCB Distribution Boards,RCBO	MDS / ABB / L&T(Hager) / Schneider(CG)/Siemens/LK Fuga / Havell's
12	Armoured Cable	NICCO / Fort Gloster / Havell's / CCI
13	Telephone Socket RJ – 11	Crabtree / ABB / MDS Legrand
14	Telephone Cable (0.51mmsq) 10/20 pair	National / Delton / Netco / Finolex / Retco
15	Lugs	Dowells
16	Light Fittings/ Fixtures	Havells / Philips
17	Terminal Connector	Havells
18	Exhaust Fan	E.P.C / HAVELS / Crompton
19	Wall mounted ( Osyliating Type) / Pedestal Fan	Halvels/ Crompton
20	SFU / SPN / TPN S.M. housing / Open execution front handle with housing	L&T / Siemens / Havell's
21	Telephone Connector	KORN type
22	Selector switch (Rotary type)	Kaycee / A.E / L&T/ Siemens
23	Rigid PVC conduit	B.E.C., Kalinga, Plaza, AKG, Precession
24	Sliding fuse / DZ fuse	Bharat Lender / BCH
25	Clock switch/time switch	L&T, MDS, GIC, T&C
26	PVC Tape	Steel Grip / Anchor
27	Join box 6"x4" MS box heavy type	Local make
28	Bearer Call Bell	Anchor / Max / Roma
29	Brass Cable gland	Arun(heavy type) / Dowells
30	LED Indicator ( bright type)	Mikadov / L&T / MDS
31	PVC flexible pipe	Hanuman / Precession / Kalinga
32	MCCB	Siemens / L& T / Havell's
33	Metal Clad socket & plug having scraping earth arrangement	Siemens / L&T / MDS / Schneider
34	All other items not covered above	As per sample approved by Employer/Consultant
35	SPLIT AIR CONDITION UNIT	CAREER/HITACHI/LG/DAIKIN

PRODUCED BY AN AUTODESK EDUCATIONAL PRODUCT

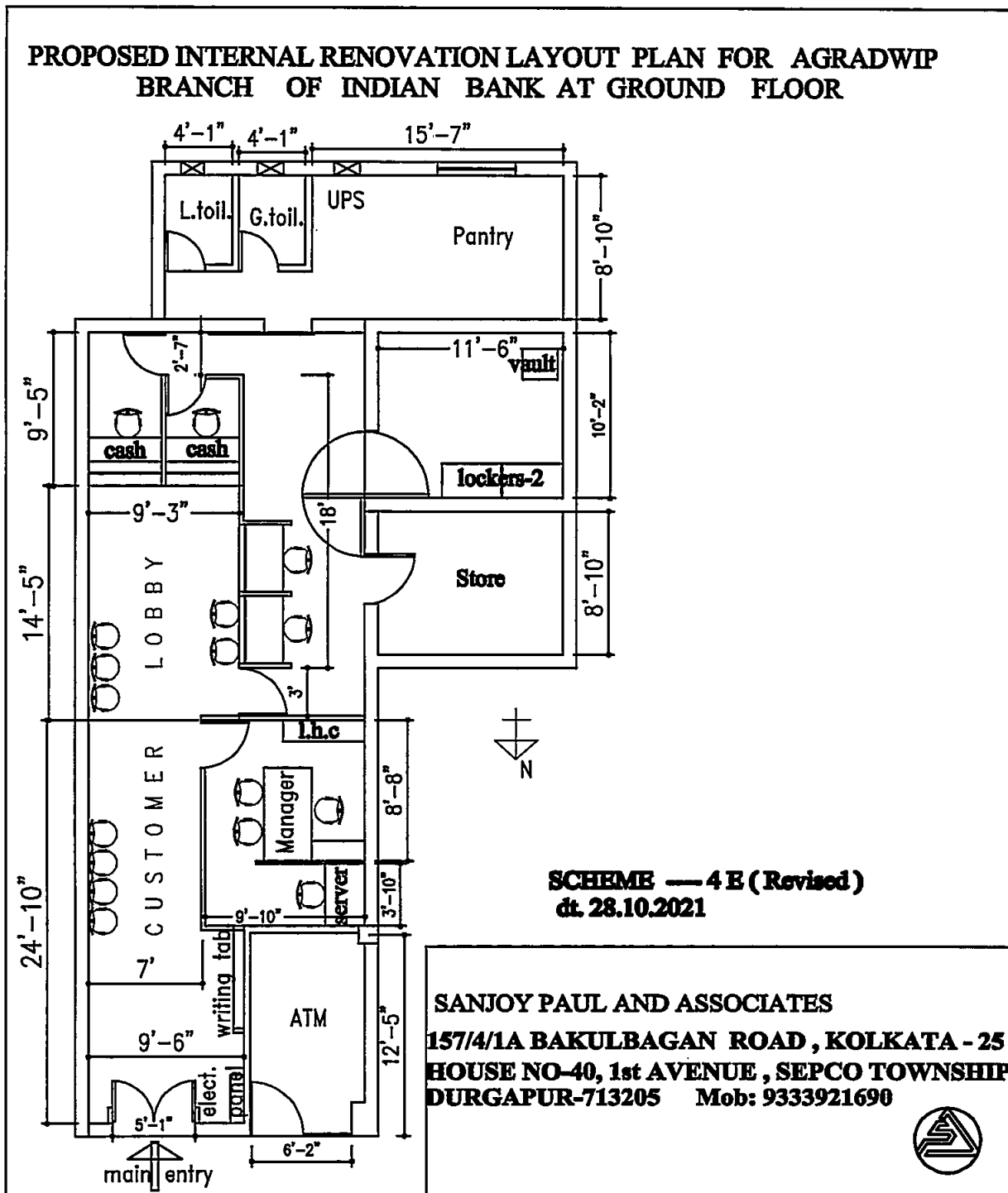

PRODUCED BY AN AUTODESK EDUCATIONAL PRODUCT