



INDIAN BANK
ZONAL OFFICE, Hyderabad
3-6-365, 4th floor, LIBERTY PLAZA, HIMAYATNAGAR
HYDERABAD-500029

**PROPOSED INTERIOR FURNISHING AND ELECTRICAL WORKS FOR INDIAN BANK
NAREPALY BRANCH & ATM AT NAREPALLY, HYDERABAD**

INDIAN BANK EMPANELLED CONTRACTORS ONLY

CONSULTANTS:



SRR ARCHITECTNIQUES

PLANNERS-ENGINEERS-VALUERS-INTERIOR-LANDSCAPE- INFRASTRUCTURE : DESIGNERS & PROJECT MANAGEMENT CONSULTANTS

**3-6-460, 101/A & 102, Gokulkunj Street – 5
Hardikarabagh, Himayat Nagar,
Hyderabad.**

CONTENTS

SL.NO.	PARTICULARS
1.	General rules and instructions for the guidance of tenderers
2.	General conditions of contract
3.	Out line conditions of contract
4.	Additional conditions of contract
5.	Preamble to schedule of quantities
6.	Articles of agreement
7.	Specifications
8.	Schedule of quantities
9	Drawings

1. GENERAL RULES & INSTRUCTIONS FOR THE GUIDANCE OF TENDERERS

1. Tenders are invited on behalf of Indian Bank Corporate office, No. 254-260, avvai shanmugam salai, Royapettah, Chennai - 600 014. **Tenders for Proposed Interior Furnishing and Electrical works for Indian Bank Narepally Branch & ATM at Narepally, Hyderabad, Telangana State.** Tender documents consisting of the plans, complete specifications, the schedule of quantities of the various classes of work to be done, and the set of conditions of contract to be complied with by the person whose Tenders may be accepted, can be purchased from the office of **M/s. SRR Architechniques, 3-6-460, 101/A & 102, Gokulkunj Street – 5, Hardikarabagh, Himayat Nagar, Hyderabad** between the hours of **10.00am to 4.00pm from 08.01.2022.** Tender document fee 1,000/- cash/ DD in favor of SRR Architechniques, Hyderabad.

The site for the work is available / or the site for the work shall be made available in parts as specified below.

2. Tenders, which should always be placed in a sealed cover, with the name of the project written on the envelope will be received by The **Assistant General Manager, Indian Bank Zonal office, Hyderabad (Premises & Expenditure Dept.) No: 3-6-365, Liberty Plaza, 4th floor, Himayat Nagar, Hyderabad** up to 3.00 **pm on 17.01.2022** The tenders will be opened on **17.01.2022** 4.00 pm

3. The time allowed for the carrying out of the work be **21 days** from the date of written orders to commence work.

4. The contractors should quote in figures as well as in words the rates, and amount tendered by them. The amount for each item should be worked out and the requisite totals given.

5. Earnest money, amounting to **Rs. 10,400 /-(Rupees Ten Thousand Four Hundred Only)** in the form of Bank draft draw in favour of **"INDIAN BANK" Zonal office, Hyderabad.** Must accompany each tender and each tender is to be in a sealed cover subscribed. **Tender for Proposed Interior Furnishing and Electrical works for Indian Bank Narepally Branch & ATM at Narepally, Hyderabad, Telangana State.** The EMD of the contractor whose tender is accepted, shall be forfeited in full in case he does not remit the Initial Security Deposit within the stipulated period or start the work by the stipulated date mentioned in the award letter.

6. The acceptance of tender will rest with **"INDIAN BANK"** which does not bind itself to accept the lowest tender, and or reserves to itself the authority to reject any or all of the tenders received without the assignment of a reason. All tenders in which any of the prescribed conditions are not fulfilled or are incomplete in any respect are liable to be rejected.

INDIAN BANK reserves the right to accept the tender in full or in part and the tenderer shall have no claim for revision of rates or other conditions if his tender is accepted in parts.

7. Canvassing in connection with tenders is strictly prohibited and the tenders submitted by the contractors who resort to canvassing will be liable to rejection.

8. All rates shall be quoted on the proper form of the tender alone.

9. An item rate tenders containing percentage below/ above will be summarily rejected.

10. On acceptance of the tender, the name of the accredited representative (s) of the contractor who would be responsible for taking instructions from the Employer/ Architects shall be communicated to the Employer.

11. Special care should be taken to write the rates in figures as well as in words and the amounts in figures only, in such a way that interpolation is not possible. The total amount should be written both in figures and words. `p` after the decimal figures, E.g Rs. 2.15 "p", and in case of words, the word "Rupees" should precede and the word "Paise" should be written at the end, unless the rate is in whole rupees and followed by the words `only` it should invariably be up to two decimal places. While quoting the rate in schedule of quantities, the word `only` should be written closely following the amount and it should not be written in the next line.

12. INDIAN BANK does not bind itself to accept the lowest or any tender and reserves to itself the right of accepting the whole or any part of the tender and the tenderer shall be bound to perform the same at the quoted rates.

13. Sales Tax or any other tax on material or on finished works like work's contract tax, Turnover Tax etc., in respect of this contract shall be payable by the contractor and the **INDIAN BANK** will not entertain any claim whatsoever in this respect. This particular aspect should be mentioned in tender notice.

14. The tender for works shall remain open for acceptance for a period of 3 months from the date of opening of tenders. If any tenderer withdraws his tender before the said period, then the bank shall be at liberty to forfeit Earnest Money paid along with the tender.

15. The tender for the work shall not be witnessed by a contractor or contractors who himself/ themselves has/have tendered or who may and had/have tendered for the same work. Failure to observe these conditions would render tenders of the contractors tendering as well as witnessing the tender liable to summary rejection.

16. It will be obligatory on the part of the tenderer to tender and sign the tender document for all the component parts and that, after the work is awarded, he will have to enter into an agreement for each component with the competent authority **INDIAN BANK**.

17. The tenderer, apart from being a competent contractor must associate himself with agencies of the appropriate class who are eligible to tender for other works.

18. The quoted price shall be firm & no discounts are acceptable on the final price.

19. If the contractor or his representatives are found to be absent from the site for more than 3 days the contract is deemed to be terminated by him.

Signature of the Competent Authority

2. GENERAL CONDITIONS OF CONTRACT

Except where provided for in the description of the individual item in the schedule of quantities and in the specifications and conditions laid down here in after and in the drawings, the work shall be carried out as per standard specification and under the direction of Employer/ Architects.

1. INTERPRETATION

In construing these conditions, the specifications, the schedule of quantities, tender and agreement, the following words shall have the meaning here in assigned to them except where the subject or context otherwise requires.

Employer: The term Employer shall denote **Indian Bank Zonal office, Hyderabad No : 3-6-365, Liberty Plaza, 4th floor, Himayat Nagar** any of its employees representative authorized on their behalf.

Architects: The term Architects shall mean **M/s. SRR Architechniques, 3-6-460, 101/A & 102, Gokulkunj Street – 5, Hardikarabagh, Himayat Nagar, Hyderabad** or in the event of his/their ceasing to be Architects for the purpose of this contract such other persons as the employer shall nominate for the purpose.

Contractor: The term Contractor shall mean his/their heirs, legal representative, assignees and successors.

Site: The site shall mean the site where the works are to be executed as shown within boundary in red border on the site plan including any building and creations thereon allotted by the Employer for the contractor use.

Drawings: The work is to be carried out in accordance with drawings, specifications, the schedule of quantities and any further drawings which may be supplied or any other instruction, which may be given by the Employer during the execution of the work. All drawings relating to work given to the contractor together with a copy of schedule of quantities are to be kept at site and the Employer/ Architects shall be given access to such drawings or schedule of quantities whenever necessary.

In case any detailed drawings are necessary the contractor shall prepare such detailed drawings and / or dimensional sketches there for and have it confirmed by the Employer / Architects prior to taking up such work. The contractor shall ask in writing for all clarifications on matters occurring anywhere in drawings, specifications and schedule of quantities or for additional instructions at least 5 days ahead from the time when it is required for implementation so that the employer may be able to give decision thereon.

“The Works” shall mean the work to be excited or done under this contract.

“Act of Insolvency” shall mean any act as such as defined by the Presidency Towns Insolvency Act or in Provincial insolvency Act or any amending statuaries.

“The Schedule of Quantities” shall mean the schedule of quantities as specified and forming part of this contractor.

2. Scope

The work consists of construction of Employer's (details of work) in accordance with the "drawings" and Schedule of Quantities". It includes all materials, labour, tools and equipment and management necessary for and incidental to the construction and completion of the work, during its progress and upon completion, shall conform to the lines elevations and grades as shown on the drawings furnished by the employer/architects. Should any detail essential for efficient completion of the work be omitted from the drawings and specifications it shall be for responsibility of the contractor to inform the Employers / Architects details with Employers/ Architects concurrence, so that upon completion of the proposed work the same will be acceptable and ready for use.

Employer / Architects may in their absolute direction issue; further drawings and written instructions, details, directions and explanations, which are, here after collectively referred to as "The Employers' / Architects Instructions" in regard to:

- a. The variation or modification of the design quality or quality of works or the addition or omission or substitution of any work.
- b. Any discrepancy in the drawing
- c. The removal from the site of defective material brought there on by the contractor and the substitution of any other material there of.
- d. The demolition, removal and re-execution of any work executed by the contractors.
- e. The dismissal from the work any persons employed there upon.
- f. The opening from the work of any persons covered up.
- g. The rectification and making good of any defects under causes hereinafter Mentioned and those arising during the maintenance period (retention period)

The contractor shall forthwith comply with and duly execute any work comprised in such Employer's /Architect's instruction, provided always that verbal instructions, directions and explanations given to the contractor or his representative upon the works by the Employer/ Architects shall if involving a variation be confirmed in writing to be contractor's with in five days. No works for which rates are not specifically mentioned in the period schedule of quantities shall be taken up without written permission of the Employer / Architect's. Rates of items not mentioned in the priced schedule of quantities shall be fixed by the employer in consultation with the Architects as provided in Clause "variation".

Regarding all factory make products for which BIS (Burcau of Indian Standard) marked products are available, only products bearing BIS marking shall be used in work.

3. TENDERER SHALL VISIT THE SITE

Intending tenderer shall visit the site and make himself thoroughly acquainted with the local site conditions, nature and requirements of the works, facilities of transport condition, effective use of materials, access and storage for materials and removal or rubbish. The tenderer shall provide in their tender for cost of carriage, Freight and other charges as also for any special difficulties including police restriction for transport etc. for proper execution of work as indicated in the drawings.

The successful tenderer will not be entitled to any claim of commencement of the work or which in the opinion of employer/Architects might be deemed to have been inferred to so exist before commencement of work.

4. TENDERS

The entire set of tender papers issued to the tenderers should be submitted fully priced and also signed. On the page together with initials on every page. Initial/signature will indicate the acceptance of the tender papers by the tenderer.

The Schedule of quantities shall be filled as follows:

- XIX. The rate column to be legibly filled in ink in both English figures and English Words.
- XX. Amount column to be filled in for each item and the amount for each sub head as detailed in "Scheduled of Quantities"
- XXI. All corrections are to be initialed.
- XXII. The Amount column for alternative items for which the quantities are to be mentioned shall not be filled up.
- XXIII. In case of any errors, the rates given in the tender marked 'original' shall be taken as correct rates.

No notification, writings or corrections can be made in the tender papers by the tenderer, but may at his option offer his comments or modification in a separate sheet of paper attached to the original tender papers.

The employer reserves the right to reject the lowest or any tender and also to Discharge any or all the tenders for each section or split up and distribute any item of work to any specialist firm of firms, without assigning any reason.

The tenderers should note that the tender is strictly on the item rate basis and their attention is drawn to the fact that each and every item should be correct, workable and self-supporting. If called upon by the employers / Architects detailed analysis of any or all rates shall be submitted. Employer /Architects shall be not be bound to recognize the contractor's analysis.

The works will be paid for as "measured work" on the basis of actual work done and not as 'lump sum' contract.

All items of work described in the schedule of quantities are to be deemed and paid as complete works in all respects and details including preparatory and finishing works involved, directly, related to and reasonably detectable from the drawings, specifications and schedule of quantities and no further extra charges will be allowed in this connection. In the case of lump sum charges in the tender in respect of any item of works, the payments of such items of work will be made for the actual work done on the basis of lump – sum – charges as will be assessed to be payable by the Employer/ Architects.

The employer has power to add, omit from any work as shown in drawings or described in specification include in schedule of quantities and intimate the same in writing, but no addition, omission or variation shall be made by the contractor without authorization from the Employer. No variation shall vitiate the contract.

5.AGREEMENT

The successful contractor may be required to sign an agreement as may be drawn up to suit local conditions and shall pay for all stamps and legal expenses, incidental there to.

6.TAXES AND DUTIES

The tenderers must include in their tender prices quoted for all duties royalties, less and sales for or any other taxes or local charges if applicable.

7.PROVISIONAL SUMS

All provisional sums described in the schedule of quantities as P.S. shall be exclusively allotted to the purchase of materials and not for any handling and fixing to be done by the contractor. Such costs of handling and fixing with profit (including transport charges if the contractor) shall be separately included in the contract price as described in the schedule of quantities. The disposal of the amounts covered under this head will be absolutely at the description of the Employer. The contractor is to make payments for these materials given to them by suppliers on certificate or order issued by the Employer/Architects and realize them through his bill from the Employer/Architects.

8.QUANTITY OF WORK OF BE EXECUTED

The quantities shown in the schedule of quantities are intended to cover the entire new structure in the drawings but the employer reserves the right to execute only a part of the whole or any excess thereof without assigning any reason therefore.

9. OTHER PERSONS ENGAGED BY THE EMPLOYEES

The employer reserves the right to execute that part of the work included in this contract or any work, which is not included in this contract by other agency or persons and contractor shall allow all reasonable facilities and use of his scaffolding for the execution of such work; The main contractor shall extend all cooperation in this regard.

10. EARNEST MONEY AND SECURITY DEPOSIT

The tender will have to deposit an amount equivalent to Rs. 10,400/- (Rupees Ten Thousand Four Hundred Only) in the form of Bank Draft in favour of **Indian Bank, Zonal office, Hyderabad** at the time of submission of tender as an Earnest Money Deposit. The Employer is not liable to pay any interest on the Earnest Money. The Earnest Money of the unsuccessful tenderers will be refunded without any interest soon after the decision to award the work is taken or after the expiry of the validity period of the tender.

The successful tenderer to whom the contract is awarded will have to deposit as initial security deposit a further sum to make up 2% of the value of the accepted tender including the Earnest Money. The initial security Deposit will have to be made within 3 days from the date of acceptance of tender, failing which the Employer at his discretion may revoke the letter of acceptance and forfeit the Earnest Money deposit furnished along with tender. The initial security deposit will be refunded after satisfactory completion of work (as certified by

architect). Apart from the initial security deposit made as above, retention money shall be deducted from progressive running bill @ 8% of the gross value of each running bills.

The retention amount will be refunded to the contractor 14 (fourteen) days after the end of defect liability period provided he has satisfactorily carried out all the work and attended to all defects in accordance with the conditions of the contract. No interest is allowed on retention money.

11. CONTRACTOR TO PROVIDE EVERYTHING NECESSARY

The contractor shall provide everything necessary for the purpose of execution of the Work according to the intent and meaning of the drawings, schedule of the drawings, schedule of quantities and specifications taken together whether the same may or may not be particularly shown described therein provided that the same can reasonably be inferred there from. The contractor shall provide himself for ground and fresh water carrying out of the works at his own cost. The Employer shall on no account be responsible for the expenses incurred by the contractor for hired ground or fresh water obtained from elsewhere.

The rates quoted against individual items will be inclusive of everything necessary to complete the said items or work within the contemplation of the contract, and beyond the unit price no extra payment, will be allowed for incidental or contingent work. Labour and /or materials inclusive of all taxes and duties what ever except for specific items, if any stipulated in the tender documents.

The contractor shall at all times give access to workers employed by the Employer or any employed on the buildings and to provide them with water and leave or make any holes, grooves etc., in work. Where directed by the employer as may be required to enable such workman to lay or fix pipes, electrical wiring special fittings etc. The quoted rates of the tenderers shall accordingly include all these above mentionable contingent works.

12. TIME OF COMPLETION / EXTENSION OF TIME & PROGRESS CHART

The entire work is to be completed in all respects within the stipulated period of **21 days**. The work shall deemed to be commenced within 2 days from the date of acceptance letter or date of handing over of site, whichever is earlier. Time is the essence of contract and shall be strictly observed by the contractor.

The work shall not be considered as complete until the Employer / Architects have certified in writing that this has been complete and the Defects Liability Period shall commence from the date of such certificate.

Extension of Time: If in the opinion of the Employer/Architects the works are delayed (a) by reason of any exceptionally inclement weather or (b) by reason of instructions from the employer in consequences of proceedings taken or threatened by or disputes, with adjoining or neighboring owners or (c) by the works, or delay of other contractors nominated by the employer and not referred to in the specification or (d) by the reason of authorized extra and additions or (e) by reason or any combination or works men or strikes or lock – out affecting any of the building trade or (f) from other causes which the Employer may consider are beyond the control of the contractor, the Employer at the completion of the time allowed for the contract for the control shall make fair and reasonable extension of time for completion in respect therefore. In the event of the employer failing to give possession of the site upon the day specified above, the time of completion shall be extended suitably.

In case of such strikes or lockouts as are referred to above, the contractor, shall, immediately give the employer, written notice thereof. Nevertheless he shall use his best endeavors to prevent delay, and shall do all that may be reasonably required, to the satisfaction of the Employer for any extension of time for completion hereunder (which shall be final and binding on the contractor) shall be promulgated at the conclusion of such strike or lock – out and the Employer shall be then, in the event of an extension being, granted, determine, and declare the final completion date. The provision in clause 13 with respect to payment of liquidated damages shall be construed as if the extended date fixed by the Employer was submitted for and the damages shall be deducted accordingly.

Progress of Work: During this period the contractor shall maintain proportionate progress on the basis of Program me Chart submitted by the contractor immediately before commencement of work and agreed to by the Employer/Architects. Contractor should also include planning for procurement of scarce material well in advance and reflect the same in the program me Chart so that is no delay in completion of the project.

13. LIQUIDATED DAMAGES

The entry for the quantum of LD per week of delay, appropriate for the case in hand, should be selected from the following:

For contracts having time for completion 6 months and less.	1.00% of the estimated amount shown the Tender per week.
For contracts having time for completion Exceeding 6 months But not exceeding years (24 months)	0.50% of the Estimated amount shown the tender per week
For contracts having Time for completion In excess of 2 years	0.25% of the Estimated amount shown the tender per week.
The entry of the quantum of the maximum LD, the accrual of which entitles the Bank conclude the the contract should be selected from the following as may applicable:	
For contracts having Time for completion 6 months and less	10.0% of the accepted Contract Sum
For contracts having Time for completion Exceeding 6 months But not exceeding year	7.5% of the accepted contract sum. Subject to the provision of para below.

14. NOTICE AND PATENTS OF APPROPRIATE AUTHORITY AND OWNERS

The contractor shall conform to the provisions of any acts of the legislature relating to the work, and to the Regulations and Bye laws of any authorities and / or any water, lighting and other companies, and / or authorities with whose systems the structures were proposed to have connection.

The contractor shall arrange to give all notices required for by the said Acts. Regulations or Bye – laws to be given to any authority and to pay such authority or any public officer all fees that may be properly chargeable in respect of the work and lodge the receipt with the Employer.

The contractor shall indemnify the Employer against all claims in respect or patent rights, royalties damages to building, roads or members of public in case of execution of work and shall defend all actions arising from such claims and shall keep the Employer saved harmless and indemnified in all respects from such actions, costs and expenses.

15. ACCESS:

Any authorized representative of the employer shall at the reasonable times have free access to the workshop, factories or other place where materials are being prepared or constructed for the works and also to any place where the materials are lying or from where that are being obtained, and the contractor shall give every facility to the bank or their representative everything necessary for inspection and examination and test of the materials and workmanship. Except the representative of the employer no person shall be allowed at any time without the written permission of the Employer.

16. MATERIALS, WORKMANSHIP, SAMPLE, TESTING OF MATERIALS

All the works specified and provided for in the specifications or which may be required to be done in the manner with materials of the best and approved quality of the respective kinds in accordance with the particulars contained in and implied by the specifications as any from their entire satisfaction. If required by the Employer / Architects during the execution of the work, and their entire satisfaction. If required by the employer / Architects the contractor shall carry tests on materials and workmanship in approved materials testing laboratories or as prescribed by the Employer/Architects at his own cost to prove that the materials etc. under test conform to the relevant B.I.S. or as specified in the specifications. The necessary charges for preparation of mould (in case of concrete cube) transporting, testing etc, shall have to be borne by the contractor. No extra payments in this account should in any case be entertained. All the materials (Except where otherwise described) stores equipment required for the full performance of the work under the contract must be provided through normal channels and must include charge for import duties, sales, tax control and other charges and must be the best of their kind available and the contractor's must be entirely responsible for the proper and efficient carrying out of work.

The work must be done in the best workman like manner. Samples of all materials to be used would be submitted to the Employer / Architects when so directed by the Employer / Architects and written approval from Employer / Architects must be obtained prior to placement of order. Should the work be suspended by reason of rain, strike, lock out or any other cause the contractor shall take all precautions necessary for the protection of work at his own expenses and shall make good any damage arising from, any of these causes. The contractor shall cover up and protect from damage from any cause, all new work and supply, temporary/doors, protection to windows and any other requisite protection for execution of the work whether by himself or special trades men or sub contractor and any damage caused must be made good by the contractor at his own expense

17. REMOVAL OF IMPROPER WORK

The Employer shall during the progress of the work have power to order in writing from time to time the removal from the work within such reasonable time or time as they be specified in the order of any materials which in the opinion of the Employer/Architects are not in accordance with specification or instructions. The substitution or proper re-execution of any work executed with materials or workmanship not in accordance with the drawings and specification or instructions, in case the contract or refuses to complete and pay other agencies to carry out the work and all expenses consequent thereon or incidental therein or incidental thereto as certified by the Employer / Architects shall be borne by the contractor or may be deducted from any money that may become due to the contractor. No certificate,

which may be given by the Architects, shall relieve the contractor from his liability in respect of unsound work or bad work.

18. CONTRACTOR EMPLOYEES

The contractor shall employ technically qualified and competent supervisor for the work who shall be available (by turn) throughout the working hours to receive and comply with instructions of Employer / Architects. The Contractor shall engage at least new-experienced Engineer as site – in – charge for execution of the work. The contractor shall employ in connection with the work persons having the appropriate skill or ability to perform their job efficiently.

The contractor shall employ labourers on the work as far as possible.

No one below the age of sixteen years and who is not an Indian National shall be employed on the work.

Any worker supplied by the contractor to be engaged on the work on day – work basis either wholly or partly under the direct order or control of the Employer or his representative shall be deemed to be a person employed by the contractor.

The contractor shall comply with the provision of all labour legislation including the requirements of:

- a. The payment of Wages Act
- b. Employer's Liability Act
- c. Workmen's Compensation Act.
- d. Contract Labour (Regulation & Abolition) Act, 1970 and Central Rules 1971.
- e. Apprentices act 1961.
- f. Any other Act or enactment relating thereto and rules framed there under from time to time.

The contractor shall keep the Employer saved harmless and indemnified against claims if any of the workmen and all costs and expenses as may be incurred by the Employer in connections with any claim that may be made by any workman.

19. DISMISSAL OF WORKMEN

The contractor shall on the request of the Employer immediately dismiss from works any person employed thereon by him, who in the opinion of Employer is unsuitable or incompetent or who may misconduct himself. Such discharge shall not be the basis of any claim for compensation damages against the Employer or their office or employees.

20.DAMAGE TO PERSONS AND PROPERTY INSURANCE ETC.,

The contractor shall be responsible for any injury to the work or workmen to persons, animals or things and for all damages to the structural and / or of any sub-contractor or of any of his or sub-contractor's employees, whether such injury or damages arise from carelessness, accident or any other cause whatsoever in any way connected with the carrying out of this contract. The causes shall be held to include inter – alias, streets, foot path or ways as well as damages caused to the buildings and the works forming the subject of this Contract by rain, wind or other inclemency of the weather. The contractor shall

indemnify the employer and hold harmless in respect of all and any expenses arising from any such injury or damages to persons or property as aforesaid or damage consequent upon such claim.

The employer shall be at liberty and is hereby empowered to deduct the amount of any damages, compensation, costs charges and expenses arising or accruing from or in respect of any such claim or damage from any sums due or to become due to the contractor.

21.INSURANCE

Unless otherwise instructed the contractor shall insure the works and keep them insured until the virtual completion of the contract against loss or damages by fire and/or earthquake flood. The insurance must be placed with a company approved by the employer, in the joint names of the Employer and the contractor for such amount and for any further sum if called to do by the employer, the premium, of such further sum being allowed to the contractor as an authorized extra.

The contractor shall deposit the policy and receipt for premiums paid with the Employer within 7 days from the date of issue of work order unless otherwise instructed. In default of the contractor insuring as provided above, the employer on his behalf may insure and may deduct the premium paid from any bills which may become due to the contractor. The contractor shall as soon as the claim under the policy is settled or the work reinstated by the Insurance Company should they elect to do so, proceed with due diligence with the completion of the works in the same manner as through the fire has not occurred and in respects of the conditions of the contract.

22. ACCOUNTS RECEIPT AND VOUCHERS

The contractor shall, upon the request of the Employer/Architects furnish them all the invoices, accounts, receipts and other vouchers that they may require in connection with the works under this contract. If contractor shall use materials less than what he is required under the contract, the values of the difference in the quantity of the materials he was required to use and that he actually used shall be deducted from his dues. The decision of employer shall be final and binding on the contractor as to the amount of materials the contractor is required to use for any work under this contract.

Before taking any measurement of any work, the Site Engineer or subordinate deputed by him shall give reasonable notice to be contractor. If the contractor fails to attend at the measurements after such notice or fails to countersign or to record the difference with a week from the date of measurement in the manner required by the Site Engineer then in any such event the measurement after such notice taken by the Site Engineer or by subordinate deputed by him as the case may be is final and binding on the contractor and contractor shall have no right to dispute the same.

23. ADVANCE PAYMENTS AND SECURED ADVANCES

Advance payment for works actually executed but not measured and billed for, should not be made generally. Payment should only be made after the detailed measurements of the work are taken recorded and the contractor's bill for the same is approved by the competent Authority.

However, advance payment on the running bills to the extent of 75% of the Architect certified amount might be made whenever found necessary. In such cases, it shall be the

test checking of the measurements & scrutiny of bills are completed before payment of the next running bills.

Secured advances on the security of materials brought to site may be made to the contractors whose contract is for finished work. In such cases, the competent Authority may sanction advances up to an amount not exceeding 75% of the value (invoiced/assessed value) of such materials, provided that they are of a durable / non – failure nature and that an Indemnity Bond is required on the materials and is a safeguard against losses due to the contractor postponing the execution of the work or to the shortage or misuse or the materials, and against the expense entitled, if any, for their proper watch and safe custody. Recoveries of advances so made should not be postponed until the whole of the work entrusted to the contractor is completed. They should be made from his bills for works done as the materials are used, the necessary deductions being made wherever the item of work in which they are used are billed for.

24. PAYMENTS

All bills shall be prepared by the contractor in the form prescribed by the Employer/Architects. One interim bill shall be prepared every week subject to minimum value for interim certificate as stated in these documents. The bills in proper forms must be duly accompanied by detailed measurements in support of the quantities or work done and must show deductions for all previous payments etc.,

The Employer/Architects shall issue a certificate after due scrutiny of the contractor's bill stating the amount due to the contractor from the Employer and the contractor shall be entitled to payment thereof, within the period of honouring certificates named in these documents.

The Amount stated in an interim certificate shall be the total values of work properly executed and 70% of invoiced value of materials brought to site for permanent incorporation into the work up to the date of the bill less the amount to be retained by the employer as retention money vide clause 10 of these conditions and less installment previously paid under these conditions provided the certificate shall only include the value of said materials and goods as from such time as they are reasonably, properly and not prematurely brought and placed adjacent to the work and then only if adequately protected against weather or other casualties.

The employer will deduct retention money as described in clause 10 of these conditions. The refund of retention money will be made as specified in the said clause. If the Employer has supplied materials or goods to the contractor, the cost of any such materials or goods will be progressively deducted from the amount due the contractor, in accordance. All the interim payments shall be regarded as payments for work actually done and completed, and imperfect or unskilled work to be removed and taken away and reconstructed or re-erected or be considered as an admission of the due performance of the contract, or any part thereof in any respect or the according of any claim, nor shall, it determine or affect in anyway the power of the employer under these conditions or any of them as to the final settlement and adjustment of the accounts or otherwise or in any other way affect the contract. The final bill shall be submitted by the contractor within one week of the date fixed for completion of the work or of the date of certificate of completion furnished by the Site Engineer. All final payments shall be made within 3 months.

25. FINAL PAYMENTS

The final bill shall be accompanied by a certificate of completion from the Architects. Payments of final bill shall be made after deduction of Retention Money as specified in clause 10 of these conditions, which sums shall be refunded after the completion of Defects Liability Period after receiving the Architects' certificate that the contractor has rectified all defects to the satisfaction of Employer. The acceptance of payment of the final bill by the contractor would indicate that he will have no further claim in respect of the work executed.

26. VARIATION /DEVIATION

The price of all such additional items/non – tendered items will be worked out on the basis of rates quoted for similar items in the contract wherever existing or on engineering rate analysis based on prevalent fair price of labour, material and other components are required. The tender rates shall hold good for any increase or decrease in the tendered quantities upon variation of 25%. For variation beyond + or – 25% the rate for the respective item may be reviewed on mutually agreed terms.

27. SUBSTITUTION

Should the contractor desire to substitute any materials and workmanship, he/they must obtain the designated in this specification indefinitely by such terms as "Equals" or "Other approved" etc. specific approval of the Employer/Architects has to be obtained in writing.

28. PREPARATORY OF BUILDING WORKS FOR OCCUPATION AND USE ON COMPLETION

The Whole of the work will thoroughly be inspected by the contractor and deficiencies and defects put right. On completion of such inspection the contractor shall inform the Employer/Architects that he has completed the work and it is ready for inspection.

29. CLEARING SITE ON COMPLETION

On the completion of the works the contractor shall clear away and remove from the site all construction plan, surplus materials, rubbish and temporary works of every kind and leave the whole of the site and the works clean and in a workman like condition to the satisfaction of the Employer / Architects.

30. PERIOD OF FINAL MEASUREMENT

The entry for the period of final measurement after completion shall be made after taking into account the complexity of the work and staff available for carrying out measurements.

All hidden works shall have already been measured as the work progressed.

It should be noted that unless a longer period is stipulated, the condition of contract generally lays down three months (maximum) from the date of completion of the contract as the period of final measurement.

Even though the maximum period of three months is mentioned, it shall be endeavored to complete the measurements as expeditiously as possible.

31. VALUE OF WORK FOR INTERIM CERTIFICATE

The maximum value of work done, entitling the contractor to receive an interim payment is generally arrived at after dividing the estimated value of the contract (as announced in the Notice of Tender) by the time (in months) allowed for completion of work.

The above value rounded off to the nearest thousand is entered.

32. DEFECTS AFTER COMPLETION

The contractor shall make good at his own cost and to the satisfaction of employer all defects, Shrinkage, settlements or other faults, which may appear within 12 months after completion of work. In default the Employer may employ a person and amend and make good such damage, losses and expenses consequent thereon or incidental thereto shall be made good and borne by the contractor and such damages, loss and expenses shall be recoverable from his by the Employer or may be deducted from the contractor deduct from any money due to the contractor a sum equivalent to the cost of amending such work and in the event of the amount retained being insufficient, recover that balance from the contractor from amount retaining under clause No.10 together with any expenses the Employer may have incurred in connection their with.

33. ESCALATION

The rate quoted shall be firm throughout the tenure of the contract (including extension of time, if any, granted) and will not be subject to any fluctuation due to increase in cost of materials, sales tax, octroi, etc., Unless specifically provided in the documents. The price variation clause being adopted by the RBI may be followed, if such a situation arises on a case – to – case basis.

34. IDLE LABOUR

Whatever the reasons may be, no claim for idle labour, additional establishment cost of hire and labour charges of tools and plants would not be entertained under any circumstance.

35. SUSPENSION

If the contractor except on account of any legal restraint upon the Employer preventing the continuance of the work or in the opinion of the employer shall or fail to proceed with due diligence in the performance of his part of the contract or if he shall more than once make default, the Employer shall have the power to give notice in writing to the contractor requiring the work be proceeded within a reasonable manner and with reasonable dispatch, such notice purport to be notice under this clause.

After such notice shall have been given the contractor shall be at liberty to remove from the site of the works or from any contiguous there to any plant or materials to subsist from the date of such notice being given until the notice shall have been complied with.

36. TERMINATION OF CONTRACT BY EMPLOYER

If the contractor being a company into liquidation whether voluntary or compulsory or being a firm shall be dissolved or being an individual shall be adjudicated insolvent or shall make an assignment or a composition for the benefit of the greater part, in numbers of amount of his creditors or shall enter into a Deed or arrangement with his creditors, or if the official

Assignee in insolvency, or the Receiver of the contractor in solvency, shall repudiate the contract, or if a insolvency, or if a Receiver of the contractor's firm appointed by the court shall be unable, within fourteen days after notice to him requiring him to do so, to show to the reasonable satisfaction of the employer that he is able to carry out and fulfill the contract, and if so required by the employer to give reasonable security therefore, or if the contractor shall suffer execution to be issued, or shall suffer any payment under this contract to be attached by or on behalf of and of the creditors of the contractor, there under, or shall neglect or fail to observe and perform all or any of the acts matters of things by contract, to be observed and performed by the contractor within the clear days after the notice shall use improper materials on workmanship in carrying on the works, or shall in the opinion of the employer not exercise such due diligence and make such due progress as would enable the work to be completed within due time agreed upon, and shall fail to proceed to the satisfaction of the employer after three clear days notice requiring the contractor so to do shall have been given to the contractor as hereinafter mentioned or shall abandon the contract, then and in any of the said case, the employer may notwithstanding previous waiver determine the same by a notice in writing to the effect as hereafter, mentioned, but without hereby effecting the powers of the employer of the obligations and liabilities of the contractor the whole of which shall continue in force as fully as if the contract, had not been so determined and as if the works subsequently executed had been executed by or on behalf of the contractor (without thereby creating any trust in favour of the contractor) further the employer or his agent, or servants, may other power, utensils and materials lying upon a premises or the adjoining lands or roads and sell the same as his own servants and workmen in carrying on and completing the works or by the employing any other contractor or other persons or person to complete the works and the contractor shall not in anyway interrupt or contractor or others person to complete the works and finishing or using the materials and plants for the works when the works shall be completed, or as soon thereafter as conveniently may be the employer shall give notice writing to the contractor to remove his surplus materials and plants and should the contractor fail to do so within a period of 14 days after receipt by him the employer may sell the same by public auction and shall give credit to the contractor for the amount so realized. Any expenses or losses incurred by the employer in getting the works carried out by other contractor shall be adjusted against the amount payable to the contractor by way of selling his tools and plants or due on account of work carried out by the contractor prior to engaging other contractor or against the security deposit.

37. ARBITRATION

All disputes or difference of any kind whatsoever which shall at any time arise between the parties to touching or concerning the works or the execution or maintenance there of this contract or the rights over the remaining operation or effect therefore or to the right or liabilities of the parties or arising out of in relation thereto whether during or after determination foreclosure or breach of the contract (other than those in respect of which the decision of any person is by the contract expressed to be final and binding) shall after written notice by either party to the contract to the either of them to employer hereinafter mentioned be referred for adjudicating to a sole arbitrator to be appointed as hereinafter provided. For the purpose of appointing the sole arbitrator referred to above, the employee shall send within thirty days of receipt of the notice, to the contractor a panel of three names of persons who shall be presently unconnected with the organization for which the work is executed. The contractor shall on receipt of the names as aforesaid, select any one of the persons name to be appointed as a sole arbitrator and communicate his name to the employer within thirty days of receipt of the names. The employer shall thereupon without any delay appoint the said person as the sole arbitrator. If the contractor fails to communicate such selection as provided above within the period, specified the competent authority shall make the selection and appoint the selected person as the Sole Arbitrator.

The work under the Contractor, shall, however, continue during the arbitration proceedings and no payment due or payable to the contractor shall be withheld on account of such proceedings.

The arbitrator may from time to time, with the consent of the parties, enlarge the time for making and publishing the award.

The arbitrator shall give a separate award in respect of each dispute of difference referred to him. The Arbitrator shall decide each dispute in accordance with the terms of the contract and give a reasonable award. The venue of arbitration shall be such place as may be fixed by the Arbitrator at his sole discretion.

The fees, if any, of the arbitrator, shall, if required, to be paid before the award is made and published, be paid half and half by each of the parties. The cost of the reference and of the award including the fees, if any, of the Arbitrator who may direct to and by whom and in what manner, such costs or any part there of shall be paid and, may fix or settle and amount of costs to be so said.

The award of the Arbitrator shall be final and binding on both the parties.

Subject to aforesaid the provisions of Arbitrator Act 1940 or any statutory modification or reenactment thereof and the rules made there under, and for the time being in force, shall apply to the arbitration under this clause.

The Employer and the contractor hereby also agree that arbitration under clause shall be a condition precedent to any right to action under the regard to the matter hereby expressly agreed to be so referred to arbitratio

OUTLINE CONDITIONS OF CONTRACT

1. Earnest Money Deposit	:	Rs. 10,400/-
2. Defects liability period (DLP)	:	One Year
3. Date of Commencement	:	Two days from the date of award of work.
4. Date of Completion	:	21 days
5. Security Deposit (ISD)	:	2%
6. Period of Final Measurement	:	One week from the date of Completion
7. Liquidated damages	:	1% per week
8. Value of work of interim certificate	:	Rs. 2.50 Lakhs
9. Retention Money	:	8% of the certified bill
10. Period of Honouring Certificate	:	15 days

11. Insurance : Workmen compensation and Contractor all risk for full Value of contract, third party liability.

4. ADDITIONAL CONDITIONS OF CONTRACT

1. SCOPE OF WORK

The schedule of Quantities and the tender drawings are only indicative of the scope of work. There may be variation in quantities of individual items as well as in the total quantum of work of upto + 20%. The contractor will not be liable to omission altogether of some of the items.

2. COMPLETION SCHEDULE

The contractor will be required to work according to a program me given to them by the Consulting Architects, based on the priorities of the Employers. The contractor will be required to prepare bar charts on the basis of the program me given to them and get these approved by Employer/Architects. While the overall completion program me of the work will be 14 days, certain items may be required to be completed in shorter periods, varying from 7 to 14 days.

3. WATER AND ELECTRICAL ENERGY

Water and electrical energy required for work be provided by the employer at one point free of charge, and the contractor will be required to make his own distribution and arrangements for them. Cost of electrical energy consumed would be payable by the contractors according to Government tariffs.

4. OTHER RULES AND REGULATIONS

- a. All E.S.I formalities or prescriptions under Workmen Compensation Act will be adhered to by the contractor. He will have to observe the regulations prescribed under the contracts Labor – Regulations & Abolition Act, 1970 and rules formed hereunder.
- b. The contractor shall not employ labor below the age of 18 years and shall pay them not less than the wages paid for similar work on the fair wage. Fair wage men’s wage whether for time of piece work as defined in the Minimum Wages Act.

5. PREAMBLE TO SCHEDULE OF QUANTITIES

1. Tender shall be on the basis of item rates which shall include the cost of materials, labour, all taxes, duties, and all other appurtenant services required for the complete installation, testing and commissioning in accordance with relevant drawings and meeting the requirements of the specification and relevant I.S Specification including the fees for inspection together with the liabilities and obligations as detailed in the general conditions of contract.
2. Prices shall remain firm and free from variation due to rise and fall in the cost of materials and labor or any other price variation whatsoever whether during the stipulated

period of execution or during extended period of completion if any, except direct statutory, increases by the Act of Govt. or Local bodies.

3. Item rates shall remain valid for any variation in the estimated quantities given in the schedule of quantities.

4. In order to facilitate the technical scrutiny of various quotations, the tenderer must supply with their quotations detailed technical particulars, make catalogues and erection drawings for various items under different parts specified in the schedule of quantities.

5. The drawings and specifications lay down minimum standards for equipments and workmanship. Deviations, if any, shall be clearly set down. In the absence of any deviations, it will be deemed that the tenderer is fully satisfied with the intents or the specifications and drawings and their compliance with the statutory and fire insurance provision including local codes. Where the drawings and specifications conflict the more stringent shall supply.

6. All installations shall be tested as specified and a test certificate in the prescribed form required by the authorities shall be furnished.

7. The entire installation shall be guaranteed against defective materials of workmanship for a period of 12 months from the date of installation as certified by the Architects and taken over by the owner. During the guarantee period, all the defects shall be rectified by the contractor, free of cost.

8. Water and power required for the works may be made available at site. Use of electrical power will be on chargeable basis. If the water available at site is unsuitable for construction purpose, the contractor will have to make their own arrangement for water.

9. The tenderer must acquaint themselves of the site conditions and take note of all factors while quoting the rates, so no extra will be allowed on any ground.

10. The successful tenderer shall supply completion drawings of the entire installations as executed at site drawn to a scale approved by the architects after the completion of the work but before completion certificate is given by the Architects.

11. The materials of the 1st preference shall be used and the contractor may exclude himself of not doing so only if the required range as per tender specifications is not manufactured, by the particular manufacturer. The evidence of such case shall be supported by a letter from the respective manufacturer. Samples of all fittings and accessories shall be approved by the Employer/Architects prior to their installation.

6. ARTICLES OF AGREEMENT

Made at Chennai between **Assistant General Manager, Indian Bank Zonal office, Hyderabad, 3-6-365, Liberty Plaza, 4th floor, Himayat Nagar, Hyderabad.** (Herein after referred to as the Employer, which expression, which expression shall include his heirs, Executors, administrators & assigns) of the one part and (hereinafter referred to as the Contractor, which expression shall include his heirs, executors Administrators & Assigns) of the other part.

WHEREAS the employer is desirous of **Tender for Proposed Interior work for Indian Bank Narepally Branch & ATM at Narepally, Hyderabad, Telangana State.**

Caused Drawing and specifications describing the work to be done by SRR Architechniques (herein after referred to as the Consulting Architects)

WHEREAS the said Drawings and the specifications and the priced Schedule of Quantities have been signed by or on behalf of the parties hereto and

WHEREAS the Contractor has agreed to execute upon and subject to the conditions, set forth herein (hereinafter referred to as "the conditions") the work shown upon "the said Drawings" and described in "the said Specification" and "the said Priced Schedule of Quantities" at the representative rates mentioned in the priced Schedule of Quantities.

NOW IT IS HEREBY AGREED AS FOLLOWS:

1. In consideration of the payment to be made to the Contractor as hereinafter he shall upon and subject to said conditions, execute and complete the works shown upon said drawings and such further detailed drawings as may e furnished to him by the said consulting architects and described in the said specification and the said priced Schedule of Quantities.
2. The term "Consulting Architects" in the conditions shall mean the said SRR Architechniques or in the event of their death or ceasing to be the Consulting Architects for that purpose of this contract, such other person as shall be nominated for that purpose by the Employer, not being a person to whom the Contractor shall object for reasons considered to be in sufficient by the Employer. Provided always that no persons subsequently appointed to be consulting Architects under this contract shall be entitled to disregard or over-rule any decision or approval or direction or expressed in writing by the consulting Architects for the time being.
3. The plan, agreement and documents above mentioned shall form the basis of this contract and the decision of the said Consulting Engineers/Architects for the time being as mentioned in the Conditions of contract in reference to all matter of dispute as to the materials, workmanship or account and so as to the intended interpretation of the clauses of the Agreement of any other document attached hereto shall be final and binding on both parties and may be made a Rule of Court.
4. The said contract comprises the works above mentioned and all subsidiary works connected therewith within the same site as may be ordered to be done from time to time by the said employer through the consulting Architects or other the Consulting Architects for the time being, even though such works may not be shown on the drawings or described in the said specifications or the Priced Schedule of quantities.
5. The Employer reserves to himself the right of altering the drawings and nature of the work and of adding to or omitting any items of work or of having portions of the same carried out without prejudice to this contract.
6. The said conditions shall be read as forming part of this Agreement, and the parties hereto will respectively, abide by and submit themselves to the conditions

and stipulations and perform the agreement on their parts respectively in such conditions contained.

7. Further, letter exchange between the Employer and the Contractor after the receipt of this contract as listed, shall form an integral part of this contract.
8. The several parts of this contract form have been read to us and fully understood by us.

As witness our hands this

Day of 2022

Signed by the Said

Employer

In the presence of

Contractor

Signed by the said

In the presence of

7. SPECIFICATIONS

All works should conform to Standards laid down by the Bureau of Indian Standards.

Wherever detailed specifications are not given, the works shall be carried out as per CPWD specifications Vol I & II with latest addition and corrections.

SPECIFICATIONS – GENERAL REQUIREMENTS

1A. List of Tender drawings is given elsewhere in the Tender Documents. These drawings are meant for Tenders and Construction also. These drawings may be revised and fresh revised copies issued to the contractor from time to time for adoption in the work to suit the final Designs and the physical conditions encountered during the progress of the work.

1B. Figured dimensions on drawings shall only be followed and drawings to large scale shall take precedence over these to smaller scale.

1D. The contractor shall prepare, at his own cost, detailed shop drawings and shall obtain the approval of the consultant / Client before adoption.

2A. The specification is intended for general description of quality and workmanship of materials and finished work. They are not intended to cover minute details. The work shall be executed in accordance with sound engineering and other professional practice.

2B. Where reference is made to any standard specification of Bureau of Indian Standards or any other similar body, the information and provision of the latest revised edition of the specification on the date of submission of such standard specification are in

conflict with the provisions standard in these specifications the latter provisions shall have procedures.

2C. All materials shall be of standard quality manufactured by reputed concerns conforming to Indian Standard or equivalent and shall have "BIS" mark as far as possible unless otherwise approved by the Consultant/ Client. The contractor shall get all materials approved by the Consultant / Client prior to procurement and use.

3. MEASUREMENT AND PAYMENTS

3A. The quantities stated in the Bills of Quantities are tentative. The contractor shall be paid at the quoted rate and on the basis of actual measured dimensions of the finished work, limited however by those dimensions shown in the drawings, or as directed by the consultant / Client.

3B. Measurement of work shall be generally in accordance with IS: 1200 "Method of Measurement of Building and Civil Engineering Work" except where the stipulations of the Tender are contradictory.

4. LAYOUT AND SURVEYS

The contractor shall be responsible for the true and proper setting out of works, for the correctness of position, levels, dimension and alignment of all part of the works and for the provision of all necessary instruments, appliances and labor in connection there with. If at dimensions or alignments of any part of work, the Contractors, on being required to do so, shall at his expenses rectify such errors. Checking of any setting out or of any line or level by the Consultant / Client shall not in any way relieve the Contractor of his responsibility for the corrections there of.

5. CONSTRUCTION SHCHEDULE AND TIME OF COMPLETION

5A. A BAR chart shall be submitted by the contractor detailing out the complete construction activities for each work with in 7 days of start of work at site. This chart shall be reviewed by the Consultant / Client and alterations, if any, shall be made by the contractor; this chart will form the basis or reappraisal to evaluate the progress of work at site.

5B. The drawings shall be issued to the contractor at least one week in advance before commencement of work.

5C. No extension of time shall be granted on the plea of drawings not having been received in time provided the above time schedule is adhered to.

6. CO-OPERATION WITH OTHER AGENCIES

6A. During the course of implementation of this contract, several other agencies and contractors shall be working at site simultaneously. In order to effect proper co-ordination and avoid delays, it shall be the responsibility of the contractor of this Tender to give adequate notice and exact dates of the work proposed to be executed by him which requires the placement and fixation of embedment, et., by the other agencies. The safety and prevention from damage of all materials, plant etc., of other agencies or the owners during construction activities would remain with the contractor. In the event of damage or

loss, caused, indirectly or directly by contractor or his labour, he will be responsible to make good the same as advised/instructed by the Consultant /Client.

7. DELIVERY OF WORKS

Every portion of the work shall be kept clear of accumulation from time to time and delivered up clear and free from all defects of every kind at the conclusion of the work.

8. RELATION TO OTHER DOCUMENTS

8A. The technical specification is intended for general description of items listed in the Bills of quantities. All works specified or implied in the Technical Specification form a part of the items in the Bills of Quantities. Similarly, all indications in drawings and General description of works, whether specified or implied. form a part of the items in the Bills of Quantities.

8B. The quoted rates in the bills of Quantities shall be assumed to include all the specified and implied work of the Technical specifications, drawings and General Description of works even when not specifically mentioned in the Bills of quantities.

9. LIFTS AND LEADS

9A. The rates quoted for all items of work shall include all lifts and leads where applicable.

9B. All debris and waste materials shall be disposed away from the site to a far off place as directed.

Summary

<u>Sl.No</u>	<u>Description of item</u>	<u>Amount (Rs)</u>
1	Interior Furnishing Works	
2	Electrical Works	
3	ATM Interior & Electrical Works	
	Total	
	GST @ 18%	
	Total of Interior Furnishing & Electrical Works	

Place:

Date:

Signature of contractor with seal.

SCHEDULE OF QUANTITIES**INTERIOR FURNISHING WORKS.**

PROPOSED INTERIOR FURNISHING WORKS FOR INDIAN BANK, NAREPALLY BRANCH, NAREPALLY, HYDERABAD.					
SCHEDULE OF QUANTITIES, SPECIFICATIONS AND ESTIMATE: INTERIOR FURNISHING WORKS					
S.No	Item. / Particulars.	Qty.	Unit.	Rate.	Amount.
	BRANCH INTERIOR WORKS:				
1	PARTITIONS:				
	<p>Providing and fixing partition in position as per design with 50mmx50mm solid wood finished section frame work @ 600mmc/c both ways screwed to the floor and ceiling with M.S.Cleats and to be treated with anti termite oil. The measurement will be taken upto the false ceiling visible height in case of full height partition. The frame work will be claded with 9mm thick BWR Grade plywood both sides and to be finished with 1.0mm laminate as per design with approved band adhesive. extra frame work to be fixed for fixing glass. In the glazed partition 12mm thk. modiguard/Saint Gobain clear float glass with Etching/sand blusting/granular blasting to be provided duly fixed with White beach/White ceader lipping 50mmx 25mm all complete duly natural polished and Melamine finish. In case of Full ht Partly glazed partition some portion to be raised as per drawing.</p> <p>The work should be completed as per specification, design & approval of the Architect. For the door 32mm solid core BWR flush door with a frame work of White beach/White ceader size 75mm x 62.5mm with necessary hold fast fixed to the wall/partition. Finished with 1.0MM laminate and lipping in all sides and 40mmx40mm white beach/white ceader wooden molulding to be provided along the periphery of the door frame. Supplying and fixing door accessory as door closure, brass hinges, Cylindrical/ Night latch locks and s.s.handle etc.</p>				
1.1	MAIN ENTRANCE FULL GLASS PARTITION	43.00	SFT		
	Providing and fixing in position partly glazed Full Height Glazed Partition work as shown in the drawings in frame work at 50x100mm thick beach wood frame, glass 12mm thick toughened glass work as shown in the drawings with melamine polish, item including all necessary accessories, all labour charges, all taxes, complete for the finished item of work.				
1.2	PARTLY GLAZED FULL HT PARTITION AT MANAGER CABIN	153.00	SFT		

	Providing and fixing in position partly glazed Full Height Partition work as shown in the drawings including door as shown in the drawings in frame work at 2' x 2' grid (horizontally and vertically) comprising of 2" x 2" saal wood Section and / or as per frame work shown in the drawings with 9mm thick BWR plywood on both sides finished with 1mm thick laminates of approved shade and colours as shown in drawings.				
1.3	SOLID FULL HEIGHT PARTITION AT UPS AND CASH COUNTERS WITH GRILL AND DOORS	293.00	SFT		
	Providing & fixing in position solid Full height Double Skin Partition in frame work including door in 2' x 2' grid (horizontally and vertically) comprising of 2" x 2" saal wood Section with 9mm thick BWR Grade make plywood on both sides finished with 1mm thick laminates of approved make and colour, Item to include 2" x 2" sal wood member for door frame. All exposed beech wood surfaces to be finished in melamine polish of matching laminate colour as directed including all necessary Stainless Steel finish fittings/ hardware, door closers, Godrej locks and wood preservative paint etc. as per list of approved material and as approved by the Project Consultant/ Bank officer complete for finished item of work in all respects.				
1.4	GRILL WORK AT CASH COUNTER TOP	42.00	SFT		
	Aluminium Grill – Providing & Fixing of Aluminium Grills Glazed at Cash Counter. Made out of 2" x 2" hollow square frame section as directed. Work includes antirust coat & two coats of first quality enamel paint. All necessary Items, all taxes, Labour charges, etc., complete for finished of work in all respects.				
1.5	PARTLY GLAZED HALF HEIGHT PARTITION WICKET GATE	85.00	SFT		
	Providing and fixing in position partly glazed low height partition (2½" thick) in frame work with saal wood vertical members at 2' c/c and 3 horizontal members at equal distance comprising of 2" x 2" saal wood section with 9mm thick BWR plywood on both sides finished with 1mm thick laminates of approved make and shade as shown drawings. Item to include 12mm thick glass Saint gobain make (clear / frosted) to be fixed as shown drawing. The exposed edges of the glass to be finished in mirror polish. Beech wood runner should be melamine polished in matching colour of laminate etc., complete for finished of work in all respects.				
1.6	12MM THK TOUGHENED GLASS	50.00	SFT		

	Providing & Fixing in position 12 mm thick toughened Glass at cash counter & Work Station Counters front side, including all necessary items, labour charges, all taxes etc., Complete for the finished item of work in all respects.				
1.7	COVER FOR ROLLING SHUTTER AT BANK	59.25	SFT		
	Aluminium composite panels of approved colour and the panel shall be of 3mm thick aluminum composite panel material consisting of 2.5mm thick FR grade mineral based polymer (2 hrs Fire resistance as per ASTM E119-12 and Class- O as per BS476 and compliance to NBC Guidelines 2016) sandwiched between two Aluminum coated sheets (each 0.25mm TCT thick coil. The aluminum composite panel cladding sheet shall be coil coated, with Exterior Grade based lead free coating of approved colour and shade on face # 1 and polymer (Service) coating on face # 2 with overall weight of not less than 5.0 kg per Sqm. The manufacturer should be having all the required test equipment's (yearly calibrated from NABL accredited Lab) for providing Technical Data Sheet mentioning the required Technical Parameters for Quality Check of all the batches supplied and OEM should have valid F.P.C (Factory Production control) Certificate on Reaction to fire as per Class O, item including extruded aluminium basis frame (50x25x1.5mm) angle cleats, weather sealants, rivets, GI brackets all as approved, using suitable bolts on structural steel work including necessary accessories complete in all respects including all labour charges, & all other taxes etc., complete for finished item of work including cost of structural steel fabrication, scaffolding charges				
2.0	DOORS				
2.1	MANAGER DOOR	42.00	SFT		
	Providing, fabricating and fixing door frame in 2"x3" steam beach wood and fixing with frame of all round 5" x 2" steam beach wood frame of approved make. The door shall be glazed with 8 mm thick float glass fixed with beach wood beading of 12mm thick and having etching work (Etching cost considered @ 40/sft). Glazing portion of door shall be done in the same line / pattern as of the partition to which it is fixed. All open edges of door shall be leaped with beach wood beading and all wood to be finished with melamine polish. The door shall be fitted with door closer of approved make, 3 nos of heavy brass hinges, brush steel finish 6 lever mortise lock (set of three keys) and heavy door stopper, Indian bank logo of approved bank and all other fittings and fixture etc. complete and as per design and approval of Engineer-in-charge.				

2.2	BRANCH MAIN ENTRANCE DOOR	42.00	SFT		
	Providing and fixing glass door for entry with 100mmx75mm beech frame wood work duly fixed with the partition/wall with hold fast duly polished. A white beach wood frame work size100mmx50mm as all round frame work with a decorative handle of 600mm of approved brand, floor spring Locks, etc all complete. 100mmx50mm thk stiles to be fixed on the frame 3 sides. 12mm thk toughened etched glass and Indian Bank logo frosted design with necessary sand blasting/granular blasting to be provided and edge should be machine beveled polished. The work to be completed as per design and specification of the Architect all complete. The wooden portion to be duly melamine polished.				
3.0	TABLES:				
	Providing and fixing in position Manger's Table of size 6'-0" x 3'-0", Officer's table of size 5'-0" x 2'-6", Work station table 4'-0" x 2'-6" including Built in Storage (Credenza) by using 25 mm thick BWR plywood for top and 19mm thick BWR plywood for all other horizontal and vertical members Including Telescopic CPU Stand/ ready made keyboard tray shall be provided of approved model and make. Footrest made with T.W. member of size 4" x 1 1/2" "finished with French polish. All exposed plywood surfaces to be finished with 1mm thick laminate of approved make & shade and all exposed edges of table top & ply verticals to have 1" x 1/4" beech lipping. All exposed beech sections to be melamine and Internal surfaces to have white enamel paint as directed. Item to include plywood boxing, all necessary hardware and fittings in Stainless Steel finish, lipping to all edges etc. complete for the finished item of work in all respects.				
3.1	Branch Manager (6'-0"x3'-0")	1	NO		
3.2	W.S Table (4'-0"x2'-6")	5	NOS		
3.3	Server Table (5'-0"x1'-6")	1	NO		
4	SIDE UNITS	2	NOS		

	Providing and fixing Side Unit/Back unit made out of 19mm thick BWR ply wood finished with 1.0mm laminate in all exposed areas. The drawers to be made out of 18mm thick Make BWR plywood in the front cladded with 1.0mm laminate sides to be made out of 12mm thick BWR plywood and bottom made out of 6mm thick BWR plywood duly painted in matching tone and it should play on drawer sliding channels. The shutters to be made out of 18mm thick BWR plywood and should play on drawer sliding castors on powder coated channels. The necessary locks, handles, etc to be provided. 75mmx12mm wooden skirting to be provided duly polished as per matching tone all along the visible areas. Inside of the unit to be enamel painted in matching tone. All the exposed edges of the boards/plywoods to be covered with wooden lippings/mouldings duly polished all complete. The work to be completed as per approval and specification of the Architect				
5.0	CASH COUNTER	1	NO		
	Providing and fixing top, front & side of cash counter made out of 19mmthick BWR plywood as per design cladded with 1.0mm thk laminate on side and front & the edges to be finished with necessary white beach or white ceader lippings, mouldings, etc. Special 150mm drawer to be made for the cash with dividers of 12mm thick BWR plywood The front of the drawer made out of 19mm thick BWR plywood finished with 1.0mm laminate, sides 12mm thick BWR plywood and bottom to be made of 6mm thick BWR plywood. The inside and sides of the drawer to be duly polished. The drawers and shutters to be provided with necessary drawer sliding channels, hinges, locks etc. A foot rest to be provided made out of 19mm thick BWR plywood duly polished. Inside of the unit to be polished in the matching tone. All visible areas to be covered with white beach of white ceader lippings, mouldings with natural polish. Wire manager, CPU trolley, keyboard tray, tea tray to be provided 75mmx12mm white beach white ceader skirting to be provided with natural polish in all visible areas and 18mm thick Plain Glass to be provided at counter 2nd top customer face. counter top at 1100 mm lvl.				
	The work should be completed as per specification.				
	Size: 8'-0" x 7'-6" x 8'-3"				
6	WALL MOUNTED WRITING LEDGE:	2	EACH		

	Providing and fixing writing ledge as per design made out 18mm plywood with necessary grove patterns 1.0mm thick laminate (colour, vertical grain) to be cladded. Small boxes to be made out of 19mm BWR plywoods to be made on top of the writing ledge finished with 1.0mm laminate, inside enamel painted. The work to be completed as per design and approval of the architect.				
7	SOFT BOARD/NOTICE BOARD	1	EACH		
	Providing and fixing soft board with necessary framework with 12mm BWR plywood on top jolly board to be fixed finished with fabric @Rs 100, with necessary mouldings duly polished along the periphery.				
8	FALSE CEILING	710.69	SFT		
	Providing & fixing false ceiling at all heights with GRG (Glass Fibre, Reinforced Gypsum) false ceiling tiles of Size 595x595 mm of approved texture, design and patterns having moisture content less than 2%, humidity resistance of 99%, NRC 0.50 to 0.75 as per IS 8225:1987, Non combustible as per BS 476 (part-4)-1970 and light reflectance of 85% (minimum) to be laid in true horizontal level suspended on interlocking metal T-Grid of hot dipped galvanised iron section of 0.33mm thick (galvanized @ 120 grams per sqm including both sides) comprising of main-T runners of size 15x32 mm of length 3000 mm, cross - T of size 15x32 mm of length 1200 mm and secondary intermediate cross-T of size 15x32 mm of length 600mm to form grid module of size 600 x 600 mm, suspended from ceiling using galvanised mild steel items (galvanizing @ 80 grams per sqm) i.e. 50 mm long, 8 mm outer diameter M-6 dash fasteners, 6 mm dia fully threaded hanger rod upto 1000 mm length and L-shape level adjuster of size 85x25x2 mm. Galvanised iron perimeter wall angle of size 24x24x0.40 mm of length 3000 mm to be fixed on periphery wall / partition with the help of plastic rawl plugs at 450 mm center to center and 40 mm long dry wall SS screws. The work shall be carried out as per specifications, drawing and as per directions of Engineer-in-Charge.				
	With semi perforated 12 mm thick micro tegular edged GRG false ceiling tiles				
9	STORAGES				

	Providing and fixing in position Back & Half height storages using 18mm thick BWR Grade Plywood of Shutters, Vertical and bottom, back 6mm thick BWR Grade plywood finished with 1mm thick laminates and all other sides shall be finished with white enamel paint as detailed therein. The Storage Units shall be provided with handles(Stainless Steel finish)as per approval of the Project Consultant / Bank. All exposed plywood surfaces to be finished with 1mm thick laminate of approved make & shade and all exposed edges of plywood to have 1" x ¼" Hard wood lipping. All exposed Hard wood sections to be melamine in matching colour laminate and internal surfaces to have white enamel paint as directed. Item to include all necessary hardware and fittings in Stainless Steel finish, Godrej multipurpose locks including magnetic ball catcher etc. complete for the finished item of work.				
9.1	STORAGE	95.00	SFT		
10	SUGGESTION/ CHEQUE DROP BOX	2.00	EACH		
	Manufacturing, supplying and fixing of suggestion box made of 19mm plywood and 1.0 mm thick lamination on top as per Bank's specifications				
11	RUNNING TABLE TOP	7.00	RFT		
	Providing & Fixing of Running Table top 1' -6" width using of 19mm thk BWR grade plywood finished with 1mm thk laminate, including all necessary items, labour charges, screws, Taxes. The work to be completed as per specification and approval of the architect.				
12	ROLLER BLINDS	110.00	SFT		
	Supply and fixing of Roller Blinds of approved make Mac/ Vista, quality and colour shade & pattern. The roller blinds to be fitted on to aluminium powder coated channels with height adjustment ropes complete with installation hardware etc.,				
	TOTAL OF BRANCH INTERIOR FURNISHING WORKS			Rs.	

Place:

Date:

Signature of contractor with seal.

SCHEDULE OF QUANTITIES**ELECTRICAL WORKS.**

PROPOSED ELECTRICAL WORKS FOR INDIAN BANK, NAREPALLY BRANCH, NAREPALLY, HYDERABAD.					
SCHEDULE OF QUANTITIES, SPECIFICATIONS AND ESTIMATE: ELECTRICAL WORKS					
Sl. No.	Particulars	Qty.	Unit	Rate	Amount (Rs.)
	BRANCH ELECTRICAL WORKS				
I.	POINT WIRING				
Note:	Supply, laying, connection & testing of light, fan point, wiring by 2x1.5sq.mm+1x1.5sqmm PVC insulated copper flexible wire maintain the colour code as per direction in PVC conduit of 20mm with ISI mark 1.5mm thickness to conceal in wall partition mending good the damage, complete with PVC circular box, bend to be done as per drawings including 3point ceiling orse wherever required GI saddle to be used for fixing, metal flexible, PVC flexible pipe may use if required in partition wall. All PVC pipes should be with ISI mark.No joints will be allowed inside pipe, light, fan & plug point complete with modular type switch plate & MS box.Including the main circuit line 2x2.5sqmm+1x1.5sqmm earth PVC insulated copper wire, maintain the color code. Circuit line for lighting switch board, 6Amps plug board are to be drawn from lighting DB to lighting board & plug point board,6/16 amps plug point line are to be draw from power DB amps plug to be & to 6/16plug point board.3no's lighting board,3no's 6amps connected from one circuit & one 2 no's 6/16plug to be connected from one circuit.				
	All the wires 4 Sqmm and above shall be terminated with Copper pin type Lugs.				
	Light point complete with modular type witch, plate, M.S conceal box.				
1.1)	a)1 Light control by 1switch	32	PTS		
	b)2 Light control by 1switch	3	PTS		
1.2)	5 Amp. Socket (Dependent)				
	Supply and fixing of 5 Amp. 5 pin combined switch socket outlet with switch in lighting control board including interconnections. (Lopped from nearest switch board)	8	NOS		
1.3)	Ceiling Fan Point				

	Supply and wiring for ceiling fan point with 3 runs 1.5 sq.mm FRLS PVC insulated copper conductor single core cable in surface / recessed steel conduit, with odular switch, modular plate, suitable GI box and earthing the point with 1.5 sq.mm FRLS PVC insulated copper conductor single core cable etc. as required, the item included 120w step type regulator, anchor fastener, providing of fan hook.	4	PTS		
1.4)	Wall Mounted Fan Point				
	Supply and wiring similar to item similar to the above but for wall Mounting fan point including box and 5 Amp. Control switch, Providing Clamp.	9	PTS		
1.5)	Exhaust fan point				
	Supply and wiring for exhaust fan point with 3runs of 1.5 sq.mm FRLS PVC insulated copper conductor single core cable in surface / recessed medium class PVC conduit, with piano type switch, phenolic laminated sheet, suitable size M.S. box and earthing the point with 1.5 sq.mm. FRLS PVC insulated copper conductor single core cable etc. as required.	3	PTS		
1.6)	Call bell point with 1 Buzzer				
	Supply and wiring same as item 1.1 above but for Call bell point including supply and fixing of 5A bell push along with Buzzer	1	NO		
	RAW POWER:				
1.7)	Raw Power Socket: Supplying and fixing metal box of 180mm X 100mm X 60mm deep (nominal size) on concealed with suitable size of phenolic laminated sheet cover in front including providing and fixing 6 pin ,15/16 A socket outlet and 15/16 A piano type switch, connections, painting etc. as required, supply and wiring with 2 runs of 2.5 Sq.mm with 1 runs of 1.5 Sq.mm copper wire FRLS for earth continuity in 2mmsqmm thick PVC conduit with all required accessories, complete for the finished item of work.	7	NOS		
1.8)	Supply and fixing of 16A DPMCB on a suitable metal box concealed in wall with supply and laying of 3 Core 4.0 Sq mm Copper armoured cable as required for Spilt Air conditioners.	4	NOS		
1.9)	RUN OF MAINS:				

	Supply and wiring with 650V grade PVC insulated Copper Conductor multistrand wires in heavy gauge 25/32mm dia MS conduit concealed in wall/in suitable width casing and capping of approved quality along with required accessories etc. Laid on ceiling through partitions.				
a)	3 runs of 4 Sq.mm copper multistrand wire including supply and laying of suitable dia PVC conduit with all accessories from UPS Upto Sign Board.	22	MTS		
b)	4 runs of 6 Sq.mm with 2 runs of 4 Sq.mm including supply and laying of suitable dia MS conduit with all accessories(LDB& PDB)	12	MTS		
c)	Incoming Cable from CT Meter : Supply and installation of Aluminium Armoured, 50sqmm x 3½core surface cable 1100V grade IS 1554 either in ground, treach, Surface with all required accessories including labour complete.	32	MTS		
d)	Supply and End termination of 3½ x 50 Sqmm Aluminium Armored Cables with required Gland, Copper Lugs and all materials etc., complete.	2	SETS		
1.10)	MCB Distribution Boards				
	Supply and installation of following size MCB.				
	Distribution Boards (Double door IP 42) with MCBs. The MCBs/MCB Isolators shall conform to IS 8828.				
a)	MAIN DB: Supply, installation of 8way VTPN DPX double door type as per IP 43 or IP 55 with 1No.125A 4 pole MCCB 25KA as incoming and 2Nos of 63A TP MCB's and 2Nos 32A TPMCB's and 14Nos of 6 to 32A MCB's with required accessories including termination with suitable sized copper lugs complete.	1	NO		
b)	4 way TPN MCB DB - Double Door - (Horizontal type) with 63A, TPN MCB as incomer and 12 nos.6-32A SPMCBs as out goings (L & P DB's)	1	NO		
2.00	TELEPHONE WIRING				
a)	Supply and fixing of RJ 11 Telephone point socket with 2 Pair Telephone Cable From Each Table to EPABX , this include suitable Surface/concealed box and required all materials this Includes Supply and fixing of Suitable PVC Conduits and Cable Numbers to provided, item including Wiring of Telephone Points Wiring with 5 Pair Copper cable and suitable conduits, required all materials etc.	8	Sets		

c)	Supply and fixing of 30Pair Termination EPBX Box with Connectors	1	Nos		
d)	Main Lines Upto EPBX Line 10 Pair Finolex .5mm Copper Cable With Conduits etc	15	Mts		
3.00	LAN WIRING:				
a	Providing and fixing of Lan points Double Line Laying of 4Pair, UTP cat 6 Systimax Lan Cable with Information outlet and Suitable 2mm Thick PVC Pipe Laying Below Flooring/Wall/Slab etc MS Junction Boxes to All Tables , Including all Related Civil Works etc All Cable Numbers to be Provided at both ends	7	Nos		
b	Supply of 7 feet Patch Cords.	14	Nos		
c	Supply of 3 feet Patch Cords.	14	Nos		
d	Supply and Fixing of CAT-6 , 24 Port Jack Panel,	1	No		
e	Supply and fixing of 9U Rack with all accessories (Self, Cable Manager, Power Manager)	1	No		
f	Supply and fixing of d-Link 10/100A mbps port switch	1	No		
4	SUPPLY AND FIXING & CONNECTION OF LED LIGHT FITTING /FANS:				
a)	Supply & Fixing of Havells Make 18W four feet LED Light (LHEXBQP7IN1W018) or equivalent with all required accessories, including the cost and conveyance and all necessary taxes, GST Tax etc., for required labour, material and necessary tools and accessories to execute the work complete for finished item of work.	16	NOS		
b)	Supply and Fixing of Havells Make LED Venus Neo 2x2 34W Panel Light (LHEWBPP7PK1W034) or equivalent with all required accessories, including the cost and conveyance, required labour charges, material and necessary tools and accessories to execute the work complete for finished item of work	11	NOS		
c)	Supply and Fixing of Havells 15W LED Down Light (LHEWEKP7PL1W015) or equivalent with all required accessories, including the cost and conveyance and all necessary taxes, GST Tax etc., for required labour, material and necessary tools and accessories to execute the work complete for finished item of work.	8	NOS		
4.1)	Supply and fixing of 400mm dia. wall mounted fans (Make/Model: Orient Electric Wall-45 400mm Wall Fan	9	NOS		
4.2)	Supply and fixing of 48" double ball bearing Ceiling fan for High Speed	4	NOS		

4.3)	Supply & Fixing of 12" (300mm) Light duty exhaust fan with wire guard etc complete of makes Crompton / Bajaj Bahar WG / Havells Ventil Air-DB / Orient hill air.	2	NOS		
5	UPS WIRING				
5.1)	Supply and fixing of 3 nos. of flush type 6A, 5 pin combined switch socket outlets in the modular type plastic box including 1 no of 16A switches in a separate box above table and front plates including interconnections, item including 3 core x 2.5sqmm multistrand copper conductor FRLS wires with suitable size heavy guage PVC Conduit concealed in wall/flooring (including cutting and filling) or suitable width casing and capping of approved quality along with required accessories and interconnections.	14	NOS		
5.2)	Supply and fixing of 1no. of flush type 16A, 5 pin sockets with 1 No 16A Switch in the modular type plastic box including Interconnections With 3x2.5Sqmm Wire for Printer point at Cash machines.	1	No		
5.3)	Run of mains				
	Supply and wiring with 650V grade PVC insulated Copper Conductor multistrand wires of following sizes in suitable size heavy gauge MS conduits concealed in will/flooring and with suitable width casing and capping of approved quality along with required acc				
a)	2runs of 6sq.mm with 1run of 4 sq.mm for earth (UPS to UPS DB)	42	MTR		
5.4)	8 way SPN MCB DB - Double Door - (Horizontal type) with 32A, DP MCB as incomer and 6 nos.6-10A SPMCBs as out goings (UPSDB)	2	NOS		
5.5)	Supply, installation, testing and commissioning of 40 A DP MCB with encloser for UPS Incoming.	4	NOS		
6)	EARTHING				
a	Providing standard Copper Plate Earth station, with 600x600x3.15mm thick copper plate including construction of brick pedestal, providing meshed funnel, CI cover and other Civil Engineering Works, spreading a homogeneous mixture of salt charcoal around the pipe etc, for sophishicated Earthing.	1	SET		

b	Providing G.I earth station, with 40mm dia, 2500mm long galvanised iron pipe including construction of brick pedestal, providing meshed funnel CI cover and other Civil Engineering Works, spreading a homogeneous mixture of salt charcoal around the pipe etc, for Earthing.	1	SET		
c	Supply and laying of following size copper earth wire/strips including excavation and refilling of earth when laid in ground and with all fixing accessories when laid inside the building including all necessary interconnections with earth station.				
	i) 8 SWG Copper wire in PVC Conduit	25	MTR		
	ii) 8 SWG GI wire	25	MTR		
	TOTAL OF BRANCH ELECTRICAL WORKS			Rs.	

Place:

Date:

Signature of contractor with seal.

SCHEDULE OF QUANTITIES**ATM INTERIOR & ELECTRICAL WORKS.**

PROPOSED INTERIOR AND ELECTRICAL WORKS FOR INDIAN BANK, NAREPALLY BRANCH ATM AT NAREPALLY, HYDERABAD.					
SCHEDULE OF QUANTITIES, SPECIFICATIONS AND ESTIMATE: INTERIOR AND ELECTRICAL WORKS					
S.No	Item. / Particulars.	Qty.	Unit.	Rate.	Amount.
A)	ATM INTERIORS :				
1.0	Providing & fixing fully glazed full ht partition with Floting glass of 2" x 2" aluminium section of 3 No's of Verticle frames and 2 No's of Horizontal frames Complete for finished item of work including cost of structural steel fabrication, scaffolding charges, if any, item including all taxes, labour charges, complete for the finished item of work.				
1	MAIN ENTRANCE FULL GLAZED FULL HT. PARTITION AT ATM	89.00	SFT		
2	A.T.M WALL ACP CLADDING	282.25	SFT		
	Aluminium composite panels of approved colour and the panel shall be of 3mm thick aluminum composite panel material consisting of 2.5mm thick FR grade mineral based polymer (2 hrs Fire resistance as per ASTM E119-12 and Class- O as per BS476 and compliance to NBC Guidelines 2016) sandwiched between two Aluminum coated sheets (each 0.25mm TCT thick coil. The aluminum composite panel cladding sheet shall be coil coated, with Exterior Grade based lead free coating of approved colour and shade on face # 1 and polymer (Service) coating on face # 2 with overall weight of not less than 5.0 kg per Sqm. The manufacturer should be having all the required test equipment's (yearly calibrated from NABL accredited Lab) for providing Technical Data Sheet mentioning the required Technical Parameters for Quality Check of all the batches supplied and OEM should have valid F.P.C (Factory Production control) Certificate on Reaction to fire as per Class O, item including extruded aluminium basis frame (50x25x1.5mm) angle cleats, weather sealants, rivets, GI brackets all as approved, using suitable bolts on structural steel work including necessary accessories complete in all respects including all labour charges, & all other taxes etc., complete for finished item of work including cost of structural steel fabrication, scaffolding charges.				
3	ATM MAIN ENTRANCE DOOR	21.00	SFT		

	Providing & Fixing of ATM Main Entrance door of D.I in given dimensions with door closure as per annexure B to be used with 2" x 2" top and verticals frame section with 6" x 2" aluminium box section complete for finished item of work including cost of structural steel fabrication, scaffolding charges, if any, item including all taxes, labour charges, complete for the finished item of work.				
4	SYNTHETIC DOOR MAT, SS DUSTBIN & WRITING DESK	1.00	SET		
	Providing and placing in position synthetic door mat SS dustbin and writing desk as per approval of the Architect.				
	TOTAL OF ATM INTERIOR WORKS			Rs.	
B)	A.T.M ELECTRICAL WORKS				
1	Supply Fixing & connections of 16 Amps power pointing socket with switch control for UPS points. Modular switches	2	NOS		
2	Supply and fixing of 16A DPMCB on a suitable metal box concealed in wall with supply and laying of 3 Core 4.0 Sq mm Copper armoured cable as required for Spilt Air conditioners.	2	NOS		
3	Supply and fixing of 12A SPDB with 40AMPS FP Isolator and 8Nos. Of Switches (For ATM Mains) MDS Make	1	SET		
4	Supply and fixing of 6/8 way SPDB with 40AMPS DP Isolator and 6Nos. Of Switches For Ups outgoing: Make Legrand or Crabtree	1	SET		
5	Supply and laying of light wiring using 1.5 and 2.5 Sq mm multistand cables for Ups power lights and raw power point lights.	3	NOS		
6	Providing standard Copper Plate Earth station, with 600x600x3.15mm thick copper plate including construction of brick pedestal, providing meshed funnel, CI cover and other Civil Engineering Works, spreading a homogeneous mixture of salt charcoal around the pipe etc, for sophisticated Earthing.	1	SET		
7	Supply and laying of CU 8 gauge from earth pit to Ups.	25	MTS		

8	Supply & Fixing of Havells Make 18W four feet LED Light (LHEXBQP7IN1W018) or equivalent with all required accessories, including the cost and conveyance and all necessary taxes, GST Tax etc., for required labour, material and necessary tools and accessories to execute the work complete for finished item of work..	1	NO		
9	Supply and Fixing of Havells Make LED Venus Neo 2x2 34W Panel Light (LHEWBPP7PK1W034) or equivalent with all required accessories, including the cost and conveyance and all necessary taxes, GST Tax etc., for required labour, material and necessary tools and accessories to execute the work complete for finished item of work.	1	NO		
10	Supply and Fixing of Havells 15W LED Down Light (LHEWEKP7PL1W015) or equivalent with all required accessories, including the cost and conveyance and all necessary taxes, GST Tax etc., for required labour, material and necessary tools and accessories to execute the work complete for finished item of work.	1	NO		
11	Supply and fixing of 40 Amps DP Isolator for UPS input and output.	2	NOS		
12	6Sqmm x 4 Core copper flexible wire + 4Sqmm Copper Flexible wire.	28	MTS		
13	Lane Cabling CAT 6 pair complete with fitting including 1" PVC pipe sudhakar with base saddles, gattis and screws.	48	MTS		
14	Supply and fixing of lan outlet (RJ.45) with GI box of AT NT make with Front plate.	2	NOS		
	TOTAL OF ATM ELECTRICAL WORKS			Rs.	
	TOTAL OF (A+B)			Rs.	
	TOTAL OF ATM INTERIOR AND ELECTRICAL WORKS			Rs.	

Place:

Date:

Signature of contractor with seal.

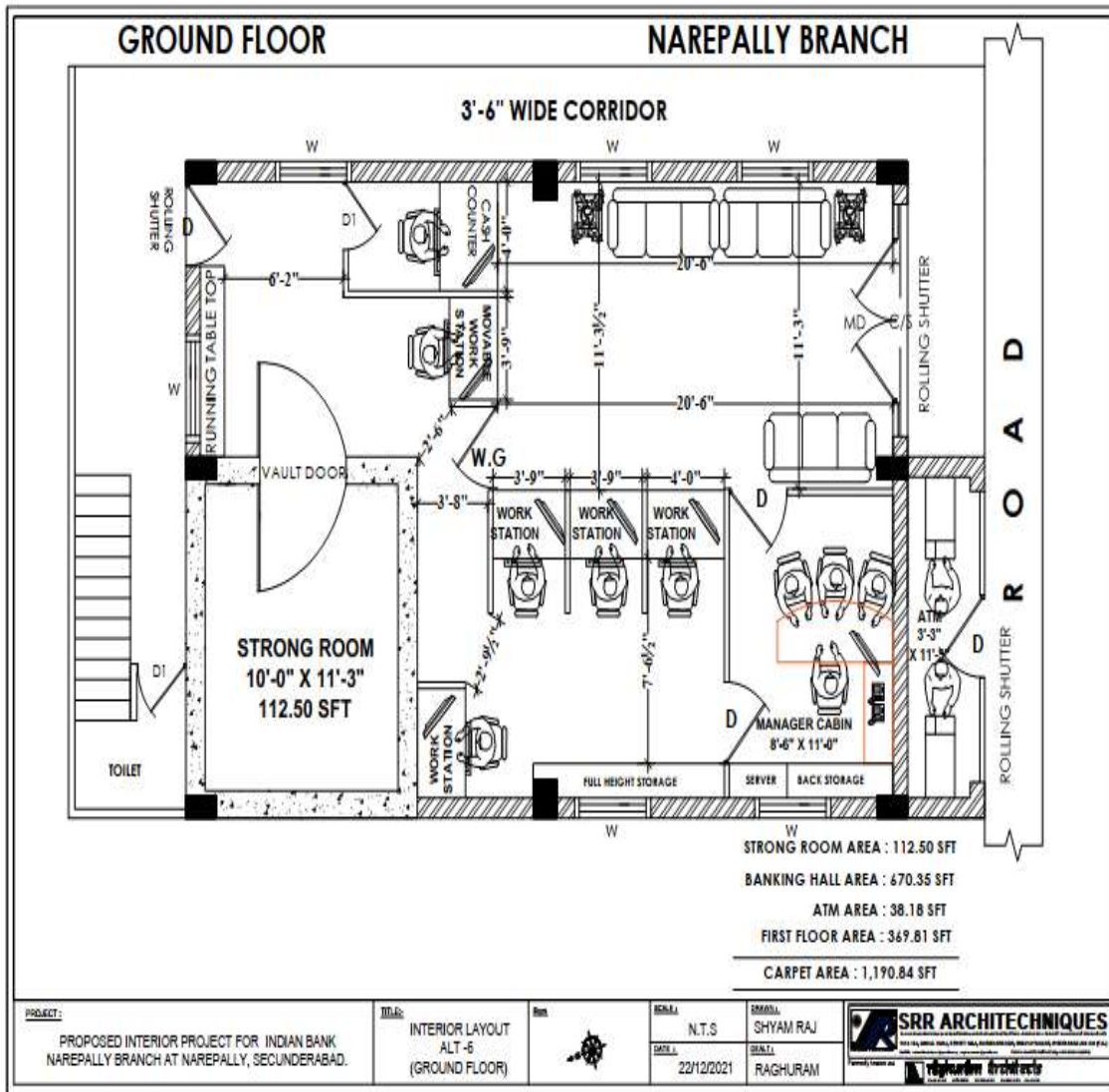

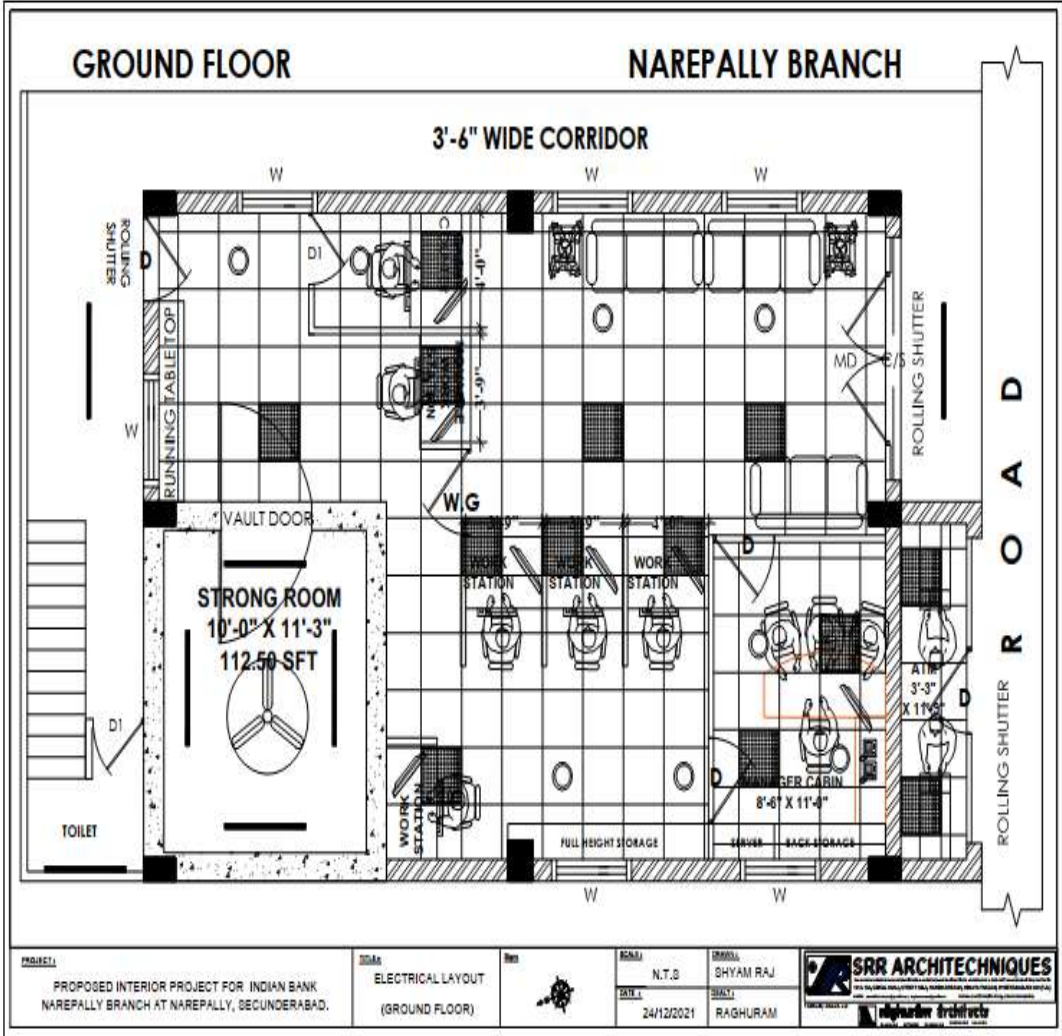

LIST OF TYPE AND MAKE OF MATERIALS TO BE USED
(INTERIOR WORKS)

Sl. No.	Description	Material	1.Colour shade 2. Code No. 3. Name of Manufacturer
1	False ceiling - Bankin hall	12mm thick Gypsum Board & 12mm thick Mineral fiber tile*	1.India Gypsum & Armstrong , Gyproc, USG ceiling or equivalent*
2	False ceilings - Cabins	15mm thick Mineral fiber tile* 600mm x 600mm	1. Armstrong false ceiling tiles
3	Partitions	Frame work: Made of 50 x 50mm hard wood like sal wood/ hillock or equivalent	1. 2. 3.
		Plywood : 9mm thick plywood (BWR Grade) with ISI certification	1. Century 2. Green ply, 3. Priwin ply, 4. Archid ply equivalent*
		Laminates: 1.0mm thick laminate*	1. Fusion Maple (wood finish)* 2. 3.Formica, Euro lam, Green lam, Merino or equivalent*
4	Counters/tables	Plywood:19mm/12mm/6mm thick (BWR Grade) plywood with ISI certificate	Century Ply, Green Ply, Priwin ply, Archid ply or equivalent.
		Laminates:1.5mm thick for table top and other s 1.0mm thick laminate*	1. Fusion Maple (wood finish)* Formica, Euro lam, Green lam, Merino or equivalent*
5	Column cladding	Laminate	1. Fusion Maple (wood finish)* with regular skirting* Formica, Euro lam, Green lam, Merino or equivalent*
6	Wall painting	Acrylic Emulsion	1.Sugarcane Asian paints, Berger paints, ICI, Nerolac or equivalent
7	Ceiling painting	Premium Emulsion	1.White/ Raindrops* Asian Paints, Berger Paints, ICI, Nerolac or equivalent*
8	Pinup Board for work station	Fabric	1.Maroon Velvet or equivalent
9	Sofa sets	Fabric - back & sides	1.Maroon

		Visitor seating	1. SS perforated* seated with end arm airport chair*
10	Chairs	Fabric	1. Maroon Godrej, wipro, Featherlite or equivalent*
11	Painting exterior	Texture – Classic or fine*	1. Grey – white Heritage, Spectrum, Alltek or equivalent
		Exterior emulsion	1. Grey/White Asian Paints, Berger Paints, ICI, Nerolac or equivalent*
12	Painting for Rolling shutter	Synthetic enamel paint	1. Oxford Blue Asian paints, ICI Paints, Nerolac or equivalent*
13	Vertical blinds	Fabric*	1. Trident MAC, Universal, Vista or equivalent*
14	Doors and windows painting	Synthetic Enamel paint	1. Light Brown (Sandstone colour) Asian paints, Berger paints, ICI, Nerolac etc or equivalent
15	Hardware	Locks, Handle, Floor spring, Door closer	1. Dorma 2. Dorset
16	Roller Blinds	Fabric*	Mac, Vista

LIST OF TYPE AND MAKE OF MATERIALS TO BE USED

(ELECTRICAL WORKS)

	Approved Make	Make Offered by the Tenderer
Switches	M.K Blenze/ Legrand Myrius	
PVC insulated copper conductor – FRLS Grade	Anchor FRLS / Finolex FRLS	
PVC conduit – Medium thick	Vasavi / Avon / ITP/ Sudhakar	
DBs	Legrand/ INDO ASIAN	

MCBs, ELCBs, RCBOs	Legrand/ INDO ASIAN	
Cables	Wipro Suraksha, Finolex, Havells	
Metal clad sockets	Legrand/ INDO ASIAN	
6 - 16 A single pole switches, sockets, ceiling roses etc.	Legrand Myrius, MK Blenze	
FANS	HAVELLS/ ORIENT	
Light LED fixtures	Wipro/ Philips/ Havells	
Data/ Lan	D-Link	

LIST OF TYPE AND MAKE OF MATERIALS TO BE USED
(ATM INTERIOR WORKS)

Sl. No.	Description	Material	1.Colour shade 2. Code No. 3. Name of Manufacturer
1	False ceilings - Cabin	12mm thick Mineral fiber tile* 600mm x 600mm	Diamond (GRG), 2 hours fire rated
2	Partitions	Aluminium Frame work	Jindal, Hindalco
3	Cladding	ACP cladding	Aludecor, 2 hours fire rated
4	Plywood	9mm thick BWR Grade	Archid
5	Laminate	1.0 mm thick	Sunmica, Formica, Archid

LIST OF TYPE AND MAKE OF MATERIALS TO BE USED
(ATM ELECTRICAL WORKS)

	Approved Make	Make Offered by the Tenderer
Switches	Legrand Myrius	
PVC insulated copper conductor - FRLS Grade	Finolex FRLS	
PVC conduit - Medium thick	Vasavi / Avon / ITP/ Sudhakar	

DBs	NCI/ Wipro North west	
MCBs, ELCBs, RCBOs	MDS/ Wipro North west	
Cables	Wipro Suraksha, Finolex, Havells	
Metal clad sockets	legrand	
6 – 16 A single pole switches, sockets, ceiling roses etc.	Legrand Myrius	
FANS	HAVELLS/ ORIENT	
Light LED fixtures	STANJO/ Wipro/ Philips/ Havells	
Data/ Lan	D-Link	

NOTE :

The contractor shall use only above mentioned material or equivalent make to be approved by the Consultant. All other materials shall confirm to the specifications laid down. The tenderer shall take this into account while tendering rates / prices. The Consultant / Owner have got every right to select any of the above Makes for the Project. However the samples of every material including all fixing accessories shall be got approved by Owner / Consultant before Execution.