

Zonal Office Sitapur

NOTICE INVITING TENDER

**Sub: COMPETITIVE QUOTATION FOR Electrical Works
Of Biswan Branch, Under ZO Sitapur**

Competitive Sealed Quotations are invited in the prescribed format from the Contractors who are already empanelled with Bank having Electrical Works License and executed Interior Furnishing & Electrical Works of Nationalized Banks in last three years.

Format of Quotation Document is enclosed for submission of Electrical works of Biswan Branch, Distt. Sitapur. Full details and tender documents are available on Bank's website: www.indianbank.co.in or can be obtained from Zonal Office, Sitapur. Dully filled in tenders should be submitted as per following schedule:

1	Issue of Tender Document	From 29.03.2022 to 16.04.2022
2	Submission of Tender	On or before 16.04.2022 up to 02:00 PM
3	Opening of Tender	On 18.04.2022 at 03:00 PM
4	Date of Commencement	7 Days from the date of issue of letter awarding the job.
5	Time of Completion	20 days
6	Defect Liability Period	12 Months
7	Earnest Money	Rs.4000/- in the form of DD/IOI in favour of Indian Bank payable at Sitapur.
8	Liquidated Damages for delay	Rs.2000/- per day subject to Max. of 10% of total accepted contract amount: (If the work is not completed to the satisfaction of the Employer within the stipulated period, the contractor shall be bound to pay to the Employer a sum equivalent to Rs.2000/- per day subject to ceiling of 10% of the accepted contract amount by way of liquidated damages and not as penalty during which the work remains un-commenced or unfinished after expiry of the completion date.)
9	Payment Terms	Neither any advance nor any Interim payment will be made. Payment will be made on satisfactory completion of the job on the basis of actual measurements. Income tax will be deducted as per the rules. Retention money 10% will be deducted from the bill and to be released after 12 months from the date of virtual completion provided no defects is observed during this period.
10	Documents to be attached with the Bill	Managers Completion Certificate, Manufacture Certification, Bills & 4-5 Photographs showing completion status of work.
11.	Retention Money	10% (Including Earnest Money)

The Bank will not be bound to accept the lowest tender and reserves the right to accept or reject any or all the tender without assigning any reason whatsoever. Late/delayed tender shall not be accepted after due date and time of submission of tender.

(Deputy General Manager)

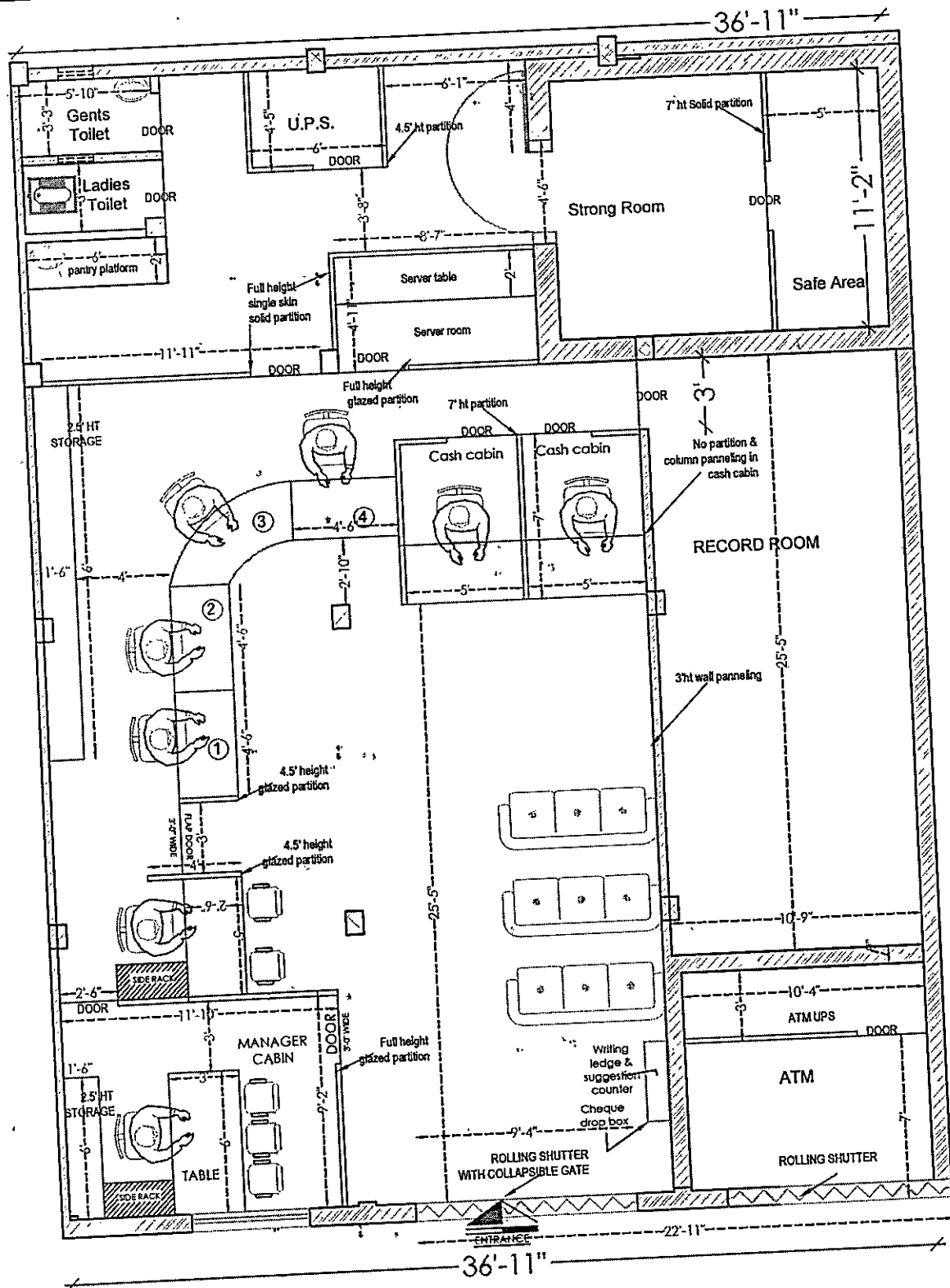

CLIENT

INDIAN BANK

ZONAL OFFICE, Sitapur - PREMISES DEPARTMENT
Opposite Gajanan Complex
Civil Lines Sitapur
Uttar Pradesh- 261001

WORK / PROJECT

PROPOSED ELECTRICAL WORKS AT
INDIA BANK, BISWAN BRANCH, DISTT. SITAPUR

COMPETITIVE QUOTATION
FOR ELECTRICAL WORKS AT ABOVE PROJECT

Tender Issued to:

M/S _____

Address _____

Contact No: _____

Tender Issued on: _____

Last Date of Submission: _____

Signature of the Contractor

Seal

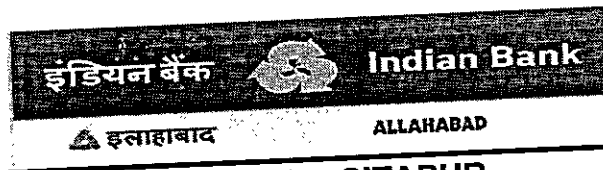

Zonal Office SITAPUR

NOTICE INVITING COMPETITIVE QUOTATION

**Work: COMPETITIVE QUOTATION FOR ELECTRICALS WORK
Of BISWAN Branch, UNDER ZO SITAPUR**

General terms & Conditions:-

- 1) Sealed quotation should be addressed to The DGM, Indian Bank, Zonal Office, Sitapur and super scribed name of Work ELECTRICAL WORK Of Biswan Branch, at Biswan and should reach before 2:00 p.m. on 16.04.2022 at Zonal Office Sitapur.

Mailing Address:

The Deputy General Manager,
Opposite Gajanan Complex
Civil Lines Sitapur
Uttar Pradesh- 261001

- 2) No quotation will be accepted after 2:00 pm on 16.04.2022 and quotations will be opened on 18.04.2022 at 3:00 pm unless otherwise informed.
- 3) The quotations will remain valid for a period of 3 months from the date of opening.
- 4) Bank reserves the right to accept or reject any or all the quotations accept part of any tender, entrust the entire work to any contractor or divide the work to more than one contractor (item wise) without assigning any reason to do so or giving any explanation. The rates quoted by the contractors will help well for bifurcation and no compensation will be paid on this account.
- 5) At the time of submission every quotation must be accompanied by IOI/ Demand Draft for an amount of Rs.4000/- in favor of INDIAN BANK payable at Sitapur towards EMD. Any quotation which is not accompanied by EMD will be summarily rejected.
- 6) Contract should quote rates in figures as well as in words.
- 7) All erasures and alterations made must be attested with the initials of tenderers. No overwriting is permitted.
- 8) The EMD of the unsuccessful bidders will be returned within 45 days from the date of opening the tender.
- 9) Joint tenders shall not be considered. Conditional tenders quoted by the contractor are liable to be rejected.
- 10) No escalation in the rates will be allowed under any circumstances.
- 11) On receipt of the intimation from the bank of the acceptance of his quotation, the contractor should submit his acceptance within 3 days. If the successful contractor/ tenderer fail to undertake the work within 7 days after work allotment, the EMD will be forfeited and acceptance of his tender may be withdrawn.
- 12) The rate quoted in the tenders shall be inclusive of all materials as required and shall be inclusive of all charges of scaffoldings, lifting, tools and plants, freights/ transportation, labor conditions and fluctuations in rates of excise duty, octroi, GST, VAT, Excise Duty, service tax and any other taxes or expenditure of carrying out the works.
- 13) The Agency is advised to inspect and examine the sites and satisfy himself as to the condition prevailing at sites and its surrounding extent of work, scope and

- conditions under which the work is to be executed. The contractor shall also satisfy himself about the accessibility to the premises.
- 14) The agency shall submit the offer which satisfies each and every condition laid down in this notice, failing which the tender will be liable to be rejected. Conditional bids shall not be considered and will be outrightly rejected in the very first instance.
 - 15) Work will be completed within the period of 20 days from the date of issue of tender or work order whichever is earlier. If the work be not completed to the satisfaction of employer within the stipulated period, the contractor will be bound to pay to the Employer a sum equivalent to Rs.2000/- per day subject to ceiling of Max 10% of the accepted contract amount by way of liquidated damages and not as penalty during which the work remains uncommenced or unfinished after expiry of the completion date. The contract may be rescind by giving one week notice in case work is not executed as per specification and as per time schedule given in tender document.
 - 16) The liquidated damages as mentioned in the Notice inviting tender may not be enforced if the contractor applies for extension of time mentioning the genuine reasons for extension. If an extension of time of completion of the work is sought on the grounds of having unavoidable hindrances in its execution or any other ground, the contractor shall apply in writing to the Deputy General Manager, Zonal Office, Sitapur with full details of the circumstances which is causing such an extension. Extension of time in days will be granted by the bank if it is proved that the contractor is not at fault for extending the work beyond stipulated date of completion. All the decisions in this regard taken by the Bank shall be binding to the contractor.
 - 17) The successful contractor is bound to carry item of work necessary for completion of job even though the same are not included in the schedule of quantity. Rates of extra item will be derived from quotation. In case the rates do not exist in quotation and extra item is not similar to the quoted item, then the rates will be worked out on actual cost of material and labour, any other expenditure for completing that work plus 15% towards contractors profit and overheads.
 - 18) The work shall be carried out in such a way that, there is least disturbance to the staff of Bank. Contractors are required to organize the work in such a way that workings of staff and officers/executives of Office are not affected. Contractor is required to take adequate care during progress of work to protect belongings. In case any damage, contractors at their own cost shall make the same good.
 - 19) The contractor must co-operate with other contractors appointed by the bank so that entire work shall proceed smoothly and to the complete satisfaction of the Bank.
 - 20) Contractor will arrange necessary tools and plants for completing own work at their cost. In case of any accident the total responsibility will be on the contractor. Contractors are required to submit time schedule of work. After completion of work, cleaning of floors, walls etc are to be done on daily basis to the satisfaction of Branch Head / engineer-in-charge. After completion of jobs, the site shall be cleared of all rubbish malba /debris etc in all respect and handover the site in proper manner on completion of the work.
 - 21) No advance will be paid. Payment will be released on satisfactory completion of job and submission of bills. Retention Money @10% will be deducted from the bill and to be released after twelve months from the date of virtual completion provided no defects is observed during the period.
 - 22) In case of non-completion or delay in completion of work or removal of defects in time, the bank shall be free to appoint another agency to get the job done at contractors risk and cost.

- 23) The contractor will attend to all the defects noticed during defect liability period. If the contractor fails to attend the defects these defects will be got rectified by the bank and the expenditure incurred on this account will be recovered from security deposit / retention money.
- 24) The work shall be got approved by by the Architect / engineer and the contractor shall rectify any bad workmanship pointed out at any stage and remove from the site all the rejected materials immediately at his own cost.
- 25) The contractor shall acquaint himself with the site conditions making his own arrangements for storing of materials at site, lift, cartage etc. at his own risk and safety.
- 26) The contractor shall make adequate arrangement for watch and ward of material and shall ensure the safety, breakage and any theft of material fixed or unfixed by him or the other sub contractors. The bank shall not be liable for any sort of loss incurred.
- 27) The contractor shall be responsible for application of labour laws, compensation for injury and accident to person, whether employed by him or his sub-contractor.
- 28) The contractor shall ensure that the workmen employed by him for the execution of work are suitably covered against Workmen Compensation Act and that all liabilities arising out of Workmen's compensation Act, ESIS and other legislative enactment applicable to such works and workmen shall be to the contractor's account and responsibility.
- 29) Civil, Interior Furnishing and Electrical Works will be carried out as per Bank's standard drawing / specifications and to the entire satisfaction of the bank.
- 30) The contractor shall inform the bank, well in time, to check measurements of any work, which is likely to be hidden before covering.
- 31) Income tax at the prevailing rates will be deducted at source from contractor's bill and will be deposited with I.T.O. as per rules.
- 32) Any extra work or item can only be started by contractor after obtaining written approval from the Zonal Office. Item executed without prior approval from the Zonal Office will not be considered for payment.
- 33) The quantities mentioned in the schedule of quantities are approximate. Payment will be made on the actual work done by the contractor. However the contractor should not deviate the quantity without Bank's permission.
- 34) The Bank has the right to alter the nature of work and to add or omit any items of work or to have the option of the same carried out departmentally or otherwise and such alterations or variations shall be carried out without prejudices to the contract.
- 35) The Bank has the right to terminate the contract if the contractor abandons the work or fails to commence the work in time, or fails to abide by the terms & conditions of the contract.

I have read and understood all the instructions/conditions given above and I have taken into account the above instructions/conditions while quoting the rates.

(SIGNATURE OF THE CONTRACTOR)

Date:

Place:

SEAL

Seal & Signature of Contractor

SUMMARY FOR INTERIOR FURNISHING WORK FOR INDIAN BANK AT BISWA BRANCH		
S.NO	DESCRIPTION	AMOUNT (Rs.)
A	SCHEDULE - 'A' (FURNISHING WORK)	
1.0	FALSE CEILING	
2.0	PARTITION WORK	
3.0	DOOR & ACCESSORIES	
4.0	WORKING COUNTER	
5.0	TABLE & FURNITURE	
6.0	CUPBOARDS AND SIDE UNIT	
7.0	OTHER MISC. WORK	
	TOTAL SCHEDULE " A "	
B	SCHEDULE - 'B' (ELECTRICAL WORK)	
I	ELECTRICAL WORK , DB , WIRING ETC	
II	ELECTRICAL WORK & LIGHT FIXTURE & FITTINGS	
	TOTAL SCHEDULE "B "	
	TOTAL (SCHEDULE - A+B)	
	IF ANY DISCOUNT	
	DISCOUNT AMOUNT	
	GRAND TOTAL	
	NOTE :- GST (WCT) TAX WILL BE EXTRA.	
	Contractor Signature & Seal	
	GST No:-	

B.O.Q OF INTERIOR FURNISHING WORK FOR INDIAN BANK AT BISWA BRANCH					
A	SCHEDULE - 'A' (FURNISHING WORK)	UNIT	QTY.	RATE	AMT
S.NO.	DESCRIPTION				
1	SUSPENDED FALSE CEILING				
1.1	FALSE CEILING (GYPSUM BAORD)				
	Providing and fixing Gypsum false ceiling as per drawing including of providing and fixing G.I. Frame work shall comprise of G.I. perimeter channel (MF-6A) of size 0.50mm thick having one flange of 19.6mm and another flange shall be of size 29.6mm and a web of 26.6mm along with perimeter of ceiling, screw fixed to the beam to the required curvature with nylon sleeves and screws at not exceeding 610mm centers. Then suspending G.I. intermediate channel (MF-7) of size 45mm, 0.9mm thick with two flanges of 15mm each bent to the required curvature by cutting both its flanges. Suitable bracing to be provided where ever the flanges are cut with 0.9mm G.I. Flat and nuts and bolts at specific positions and thereafter at 1220mm centers with ceiling angle of width 25mm x 10mm x 0.50mm thick fixed to soffit with G.I. cleats and steel expansion fasteners as per specification of India gypsum at a distance of 2'0" c/c both ways complete with 12.5mm board and all necessary perimeter channels etc.	Sq.Ft.	683.00		
	The joints to be properly mended with paper tapes and gypsum compound all complete. The boards are to be jointed and finished which includes filling and finishing the tapered and square edges of the boards with jointing compound and fiber tape suitable for Gypsum board. A layer up to of 3.00mm thickness of Veneer Plaster is applied followed by two coats of topcoat (primer) at the face of board to give smooth seamless finish. 2 or more coats of plastic emulsion paint (roller finish) of approved shade and make shall be applied. The rate should include the full completion of the ceiling. At the time of handing over the site all necessary repairing work to be considered if required. The work to be completed as per specification , approval of the bank. No Drop or design (if any) will be considered as extra measurement it will be considered flat ceiling. (Only plan area to be measured for payment) .No extra payment will be made for the cutting of light points , stain glass, cove lighting etc. The measurement will be taken in one level , rate should include the drops also, no extra amount will be paid for the drops.				
1.2	FALSE CEILING (ARMSTRONG CEILINGS - FINE FISSURED MICROLOOK EDGE WITH SILHOUETTE GRID (BLACK REVEAL)				
	Providing and fixing false ceiling system manufactured by M/s. Armstrong World Industries using hot dipped galvanized steel section, rotary stitched main tee of size 15mm x 42 mm web height, having 0.36 mm gauge at every 600 mm centre to centre maximum and rotary stitched cross tee of size 15 mm x 42 mm, having 0.33 mm gauge at every 600 mm. c/c. and wall angle of size 19 x 19 mm., having 0.35 mm gauge fixed to the periphery of the wall. The above grid is suspended at every 600mm c/c. in both directions using 2.0 mm. thick pre-straightened GI wire laying FINE FISSURED MICROLOOK WITH SILHOUETTE GRID (BLACK REVEAL) ceiling tiles manufactured by M/s. Armstrong World Industries, of size 600mmx600mmx15mm having NRC 0.55, Light reflectance of >84% (WT), thermal conductivity k = 0.052-0.057 W/mOK, Humidity Resistance of 99%, having Fire Performance CLASS O / CLASS 1 (BS 476), surface having 3 coats of white paint with Fine Fissured, back of the tile duly sanded and finished with a coat of protective paint over the formed grid complete. (Branch & ATM) .	Sq.Ft.	575.00		
TOTAL OF SUSPENDED FALSE CEILING					

S.NO.	DESCRIPTION	UNIT	QTY.	RATE	AMT
2	PARTITIONS WORK				
		Sq.Ft.	150.00		
2.1	FULL / LOW HEIGHT SOLID PARTITION				
	Full ht. Solid Partition including flush door & strong room partition up to 7' only WITH LOUVRE :- Providing and fixing solid partition, the framing shall made out of aluminium hollow section of 65mm x 37mm size 1.5mm thick of JINDAL / INDAL as internal frame structure placed horizontally & vertically at max distance of 2'-0" x 2'-0" center to center. Fixing 6 mm thick commercial ply on both sides with 1.0mm thick laminate on top of approved shade with groove pattern as per instructions of Architect. The rate shall include the cost of providing skirting of 100mm wide lined with 1mm thk laminate and providing & fixing a border at top of 100mm wide lined with 1mm thk laminate complete. Laminate Should be considered up to two or three color combination. The edge beadings with steam beach wood should be finished with melamine polish if required, frame work above false ceiling done shall not be measured but contractor may factor it while quoting there rates as measurment up to false ceiling lvl..				
	The rate inclusive of providing & fixing of required flush door of 37mm thick approx. with 1.0mm th.laminate both side with steem beech wood chowkhat of size 75mm x 65mm approx and Item includes Heavy-duty SS ball bearing butt hinges 100 x 5.5 mm (4 Nos. per shutter) with screws etc.The shade of laminate finish to be got approved from Bank. . All as per the design and instructions Bank.				
	Note :- For the purpose of payment partition shall be measured including the area of door/door frames up to false ceiling heaight.				
	Framework shall be regidly secured to floor, bottom of slab & existng walls at 2'-0" c/c with dash fasteners.				
		Sq.Ft.	270.00		
2.2	Single skin partition				
	As of the above but Providing and fixing single skin partition above false ceiling(where false ceiling is provided only on one side) for a height of up to 600mm or near about soffit of roof using aluminium frame as specified above along with 6mm thick Commercial ply wood lined on only one side and lining with 1mm thk laminate of approved shade and amke along with grooves.				
		Sq.Ft.	255.00		
2.3	Full/ Low height Glazed partition				
	Same as of Solid ht. partition , providing 8mm thick Modi/saint Gobin float glass above 1'-0" / 3'-0" & up to 7'-0" fixed with steam beech wood beading of finished size 1 1/2" X 1" all along the edge. All edge-to-edge glass joint to be machine cut and polished and sealed with silicon sealant. joint shall be located strictly as shown in the drawing. All exposed woodwork to be mealamine polished. Item includes frosted/striped/designer glass film of 3m, Avery Dennison or equivalent (basic rate of Flim Rs. 50/ Sq.ft.) on existing glass as per manufacturer's specifications. All as per the design and instruction Bank.				
		Sq.Ft.	175.00		
2.4	Single window Partitions				
	Providing and fixing in position Double skin partition 7'-0" height.The framing shall made out of aluminium hollow section of 65mm x 37mm size 1.5mm thick of JINDAL / INDAL as internal frame structure placed horizontally & vertically at max distance of 2'-0" x 2'-0" center to center. Fixing 6 mm thick commercial ply on both sides with 1 mm thick laminate of approved colour and shade as per approval of the Architect. The partition to include 8 mm. thick Modi Float glass with etching on the sides and back including a door 3'-0" wide as per the approval, with all necessary hardware, night latches etc. All exposed edges to be covered with steam beech wood Beading,4mm grooves in places as per design duly melamine polished inclusive of all materials,hardware, night latches, labour, T&P, taxes, levies, etc. completed to the satisfaction of the bank & drawing.				

S.NO.	DESCRIPTION	UNIT	QTY.	RATE	AMT
2.5	Low. Height Semi Glazed Partition. Same as above but of Low height as per design including 10mm Toughened glass with edges polished to be used. All other specs are same as of above, Edges of the partition to be covered with 3" X 1.5" Steam beech wood duly melmine polished moulding. 38mm thick flush door: wicket gate also shall be included for a measurement. All as per the design and insturction bank.	Sq.Ft.	51.00		
2.6	Front Glazeing In head cash cabin & SWO Providing & fixing 10mm thick toughened clear float glass to shape for front side of the cash counters including cutting the holes and providing & fixing TW beading polished and tinted to approved shade. (including SWO/Chief Cashier front Glass).	Sq.Ft.	40.00		
2.7	Aluminium grill on the ceiling of Cash cabin	Sq.Ft.	70.00		
2.6	ACP WALL PANELLING (ATM) :- Providing & fixing in position ACP (Aluminium Composite Panel) with framing of Aluminium Tube sections of min 1.5"x 1" and 20 gauge 2'-0" C/C both ways. ACP to be in 2' wide panels or distributed equally. Panels to be fixed to the frame with 3M or equi-valent adhesive. Joints to be finished with Silicon based sealant. Minimum ACP thickness-3 mm. Aluminum foil thickness to be min 0.25 mm on both sides. Alubond, Eurobond, Fujibond, Alcobond or equivalent ISO certified or approved brands to be used. White (IVORY) & Blue to be as per bank's approval. Additional Sections to be provided to fix the Indoor AC units. Both AC units to be installed near the machine area at the highest position. The rate shall be included for providing proper access panel for ATM power point and shall have proper locking arrangement for plug point by provding additional framing. (The measurement shall be made up to falseceiling).	SQ.FT	120.00		
2.7	BACK ROOM (ATM) - Providing and fixing partition made up on Aluminium box section with 2"x2" and 20 gauge with 2'0" C/c Both ways ,and to be fixed on inside 3 mm thick Aluminum Composite panel and rear side (only where backroom/storage is available) with 8 mm thick plywood finished with 2 -coat colour enamel paint.The rate inclusive of providing and fixing of suitable shelve for fixatation CCTVs instrument & UPS extra (1Nos.) & Access Door with teak wood louvers, and necessary accessories including handle & locking arrangement and necessary hardware complete as per details. All as per the design and instructions Bank. The item shall include suitable cutting & provision for installation of ATM facility.	SQ.FT	90.00		
	Note: - For the purpose of payment partition shall be measured including the area of door / door frames up to false ceiling height. Framework shall be rigidly secured to floor, bottom of slab & existing walls at 2'-0" c/c with dash fasteners. -				
2.8	Grouting:- ATM to be firmly embedded into the ground with para bolts/anchor bolts through the SAFE of the ATM. Scope of work includes moving/tilting of machine ,Drilling 8"-10" holes in the existing flooring using concrete drill bits, Hammering metal sleeves inthese holes, Repositioning the machines over the existing markings, Anchor fasteners to be put inplaces, Min. 6" long anchor fasteners, preferably of Fischer make, Applying resin adhesive (Araldite)over the finished bolt positions for improved bonding and Repairing the broken tiles, if any	job	1.00		
TOTAL OF PARTITIONS WORK					

S.NO.	DESCRIPTION	UNIT	QTY.	RATE	AMT
3	DOOR & ACCESSORIES				
		Sq.Ft.	43.60		
3.1	Main Entrance Door PT Door Providing and fixing toughend glass door shutters of 12mm thickness in opening of glazed partitions with stainless steel patch fittings of approved make (DORMA/ DLINE / GEZE or approved equivalent) including heavy duty double action floor-spring with steel cover plate of approved make, pull handle SS brushed finishes 24" long thick 25mm on both sides of door shutters, locking arrangement of Dorma / D Line or equivalent or better quality as approved by Engineer-in-charge. Exposed edges of glass shall be machine cut & polished. Cost includes cutting and making good the floor, walls, ceiling etc. for fixing floor spring and patch fittings. All complete as per approval of the Architect.				
		Sq.Ft.	110.00		
3.2	Main Entrance Fixed PT Glazing Providing and fixing toughend glass partition of 12mm thickness with stainless steel patch fittings of approved make (DORMA/ DLINE / GEZE or approved equivalent as approved by Engineer-in-charge. Exposed edges of glass shall be machine cut & polished. Cost includes cutting and making good the floor, walls, ceiling etc. for fixing patch fittings. All complete as per approval of the Architect.				
3.3	Supplying and fixing of Dorma/GEZE Dline / Hardwyn/Godrej or approved equivalent Door Closer for wooden door for Branch manager, Banking hall, Chief Cashier, Dinning, UPS, Toilet	Nos	3.00		
3.4	Supplying and fixing of mortice door lock of hardwyn make HML-480 Lock Body 304 Stainless Stell. (in BM Cabin, Store room 0. Cash cabin shall be Godrej Night latch.(atm 1 No.)	Nos	3.00		
3.5	Supplying and fixing of door stopper SS Grade 304, HESSF-2C hardwyn make.	Nos	5.00		
	TOTAL OF DOOR & ACCESSORIES				
4	WORKING COUNTER				
		Rft.	10.00		
4.1	CASH COUNTERS Providing and fixing Chief Cash Counter in split-levels @ 2'-6" (height 750mm) & 18" (1140mm) with 2'-6" & 15" wide each respectively. Upper levels having 12mm thick frosted toughened glass (1/c taxes and transportation). Edges of 18" wide counter shall be 12mm thick frosted toughened glass. Lower tier shall be made of 19mm thick ply wood finished in 1.5mm thick laminate. Exposed edge having steam beech wood edging of size 1 1/2" x 1". Vertical face shall have 12mm thick frosted toughened glass as per requirement of design. All exposed surfaces shall be finished with 1.0mm thick laminate of approved shade and colour.				
	1 no. prefabricated metal computer key board tray including drawer slides 12.5" x 22" tray with 14" telescopic slides including L - brackets for securing to the table top. Chest of drawers (size 1'-4" x 2'-0" x 2'-5") made of 19mm thick commercial ply wood having three drawers finished with 1.0mm thick Laminate on all sides. Each drawer shall have locking system and 6" long S.S. brushed finished handle, drawer slides etc. of approved make. All exposed edges of ply wood sealed with Steam beech wood beading of size 3/4" x 3/4". All beading and exposed wood shall be melamine polished and the Internal surfaces shall be .75 mm thick laminate. Item includes readymade metal powder coated CPU trolley, grommet, footrest for each seat. All complete as per approval and instructions of the Architect / employer. The rate also include providing and fixing painting a foot rest using hard wood 100 x 25mm size 1st class seasoned country frame.				

S.NO.	DESCRIPTION	UNIT	QTY.	RATE	AMT
	Payment will be made only on the centerline measurement. The rate shall include the cost of providing skirting of 100mm wide lined with 1.0mm thk laminate and providing & fixing a border at top of 100mm wide lined with 1.0mm thk laminate complete. the internal surfaces shall be .75 mm thick laminate.				
4.2	RUNNING COUNTER Providing and fixing staff counter/SWO in split-levels @ 2'-6" (750 mm) & 3'1" with 2'-6" (750 mm) & 9" wide each respectively. Upper levels having 1 mm thick laminate with 19 mm thick commercial ply top. Lower tier shall be made of 19mm thick ply wood and finished in 1 mm thick laminate. Working top having steam beech wood edging of size 1 1/2" x 1". Vertical face shall have 19 mm thick commercial ply over pine wood framework as per requirement of design. All exposed edges of ply wood sealed with Steam beech wood beading of size 1/4" x 3/4". All exposed surfaces shall be finished with 1.0mm thick laminate of approved shade.	Rft.	21.00		
	The item includes Chest of drawers (size 1'-4" x 2'-0" x 2'-5") made of 19mm thick commercial ply wood having One drawers at top and a storage cabinet below having shutters of 19mm thick ply wood finished with 1.0mm thick Laminate on all sides. 1 no. prefabricated metal computer key board tray including drawer slides 12.5" x 22" tray with 14" telescopic slides including L - brackets for securing to the table top for each seat. All beading and exposed wood shall be melamine polished and the internal surfaces shall be .75 mm thick laminate. Item includes 1'-3" high 12mm thick toughned glass above upper tier and readymade metal powder coated CPU trolley, grommet, foot rest for each seat. All complete as per approval and instructions of the Architect. / emplpyer; The rate also include providing and fixing painting a foot rest using hard wood 100 x 25mm size 1st class seasoned country frame. Payment will be made only on the centerline measurement.				
	The rate shall include the cost of providing skirting of 100mm wide lined with 1.0mm thk laminate and providing & fixing a border at top of 100mm wide lined with 1.0mm thk laminate complete.				
TOTAL OF WORKING COUNTER					
5	TABLE & FURNITURE				
5.1	MANAGER TABLE (Size:- 6'-0" x 3'-0") ht. 2'-6" Providing and fixing tables made out of 19 mm thick commercial ply over hard wood frame work finished with 1 mm thick laminate of approved shade. Top having steam beech wood edging of size 2" x 1 3/4". 10mm thick clear float glass with beveled edges shall be provided on the finished to 19mm thk Comm.ply wood of approved make cladded with 1mm thk laminate(color with vertical grain) as per design in all visible areas. All the exposed edges to be covered with wooden steam beech lippings and mouldings duly malamine polish. The drawers to be made out of 19mm thk ply wood with 1.0 mm laminate finish in the front , and bottom to be made out of 6mm plywood and it should play in drawer sliding telescopic channels. The inside of the drawer shall be .75 mm thick laminate. & Table back side wil be 1mm laminate. A leg rest to be provided duly polished made out of 3"x2" Wooden Section.The rate inclusive of providing & fixing wooden cabinet to suit the DVR for size 2'X6"X1'9" or as per the requirements)	Nos	1.00		
	A shutter to be made by 19mm ply wood cladded with 1.0mm laminate .The necessary locks handles to be provided in each drawers and shutters. 3" x 1/2" wooden skirting to be provided in all visible areas duly polished. The necessary wire managers(SS) to be provided on the tables and provision for lights to be kept if required in the front of the table. All the exposed areas to be duly malamine polished The work to be completed as per design and approval of the Bank. The table should have key board tray and CPU Trolley to be Modular. All as per the design and instructions Bank the Internal surfaces shall be .75 mm thick laminate.				

S.NO.	DESCRIPTION	UNIT	QTY.	RATE	AMT
5.2	Officer TABLE (Size:- 5'-0" x 2'-6") ht. 2'-6" same as above specification without glass top	Nos	1.00		
		Rft.	8.50		
5.3	SERVER TABLEE (2'-0" WIDE) Providing and fixing of Utility//Server Counter 2'-0" wide top made up of 19mm thick commercial pasted on 1.0 mm thk laminate. The Top of table will be finish with 1.00 thk laminate.all hardware fittings fixtures etc. The drawers to be made out of 19mm thk board with 1.0 mm laminate finish in the front ,sides to be made out of 12mm plywood and bottom to be made out of 6mm plywood and it should play in drawer sliding telescopic channels. The inside of the drawer to be duly paint. All exposed edges to have wooden lipping stained to match the desk and melamine finished.Design and detail of the table shall be as per design. (As per Site, Designing of Table and specification may be Changed). The works to include a keyboard try and CPU trolley to be modular. All as per the design and instructions Bank. (S.S. Finish Lock & Handle to be included)				
TOTAL OF TABLE & FURNITURE					0
6	STORAGE & SIDE UNIT				
6.1	Side and Back Unit Providing and fixing Side Unit/ Back unit 400 mm depth made out of 19mm ply wood finished with 1.0mm laminate in all exposed areas and top shall be 1 mm thick . The drawers to be made out of 19mm commercial plywood and cladded with 1.0mm laminate and bottom made out of 6mm comm ply duly painted in matching tone and it should play on drawer sliding channels . The shutters to be made out of 19mm commercial ply wood and should play on drawer sliding castors on powder coated channels. The necessary locks , handles, etc to be provided . 3" x1/2 wooden skirting to be provided duly polished as per matching tone all along the visible areas . Inside of the unit shall be .75 mm thick laminate. in matching tone . All the exposed edges of the boards/ply woods to be coverd with woden lippings/mouldings duly polished all complete. The work to be completed as per approval and specification of the Architect.	Nos	2.00		
6.2	Low / FULL HT cabinet Providing and fixing Full /Low height Cabiner400mm deep made out of 19mm thk plywood finished with 1.0mm laminate in all exposed areas . The Shutter to be made out of 19mm ply wood in the front cladded with 1.0mm laminate(color, vertical grain) . and bottom made out of 6mm plywood duly painted in matching tone and shelves 19mm thk comm ply wood to fixed inside storage. The shutters to be made out of 19mm ply wood . The necessary locks , handles, etc to be provided . 3" x1/2 wooden skirting to be provided duly polished as per matching tone all along the visible areas . Inside of the unit shall be .75 mm thick laminate finish . All the exposed edeges of the boards/plywoods to be coverd with woden lippings/mouldings duly polished all complete.All as per the design and instructions Bank.	Sq.Ft.	55.00		
6.3	Main Electrical Panel Cabinet Providing and fixing of DB Shuttering formed of 12mm thk plywood wood on 12mm thick Gypsum board (fire,Proof) with finsih as per Item, no 1 for inside and out side shutters finished with laminate on outer surface with SS (4Nos) louvre perforation and necessary hardware,hinges etc complete as per details. All as per the design and instructions Bank. Only front face taken for measurment only	Sq.Ft.	50.00		
TOTAL OF STORAGE & SIDE UNIT					
7	OTHER MISCELLANEOUS ITEMS				
7.1	PIN UP / NOTICE BOARD Providing and fixing soft board with necessary framework with 12mm BWR plywood on top 12 jolly board to be fixed finished with fabric @Rs80 , with necessary mouldings duly polished along the periferi. All as per the design and instructions Bank.	Sq.Ft.	24.00		

S.NO.	DESCRIPTION	UNIT	QTY.	RATE	AMT
7.4	WRITING LEDGER & Cheque & suggestion box Providing and fixing writing ledge as per design minium 5 ft length made out 19mm comm. board with necessary grove patterns with 1.0mm laminate. 10mm thk machine pollshed glass to be provided on top of the writing ledge. Small boxes to be made out of 12mm comm. ply to be made on top of the writing ledge finished with 1.0 mm laminate, inside surfaces shall be .75 mm thick laminate. and rate should be included providing fixing of suggestion box & Cheque deposit box as per approval of bank .The work to be completed as per design and approval of the architect.	NO	1.00		
7.5	Outer Shutter Boxing Overhead outside shutter box: p/f sal wood frame fixing of 12mm plywood with 1mm thk. Laminate finish and openable shutter for out side area inside shall be 2 coat enamel paint with primer	Sq.Ft.	150.00		
7.6	WOODEN COLUMN PANELLING Wall panneling 3 feet height in customer lobby Fabricating and fixing wall/column paneling, the framing shall made out of aluminium hollow section of 65mm x 37mm size 1.5mm thick of JINDAL / INDAL at spacing not exceeding 600mm bothways (horizontal and vertical). Paneling framework to be secured to wall surface/column surface. Paneling framework to be clad on one side with 9mm thick ply finished with 1.0mm thk laminate including skirting of 100mm high & 12mm x 12mm groove at skirting level. All as per the design and instructions Bank.	Sq.Ft.	150.00		
7.7	ROLLING/ VERTICAL BLINDS Providing and fixing Roller blinds of approved design and shade by the Architect, incl all std fittings as per manufacturer's specification. The work to be completed as per specification and approval of the architect. (approved brand Vista, Hunter Dogulus)	Sq.Ft.	20.00		
TOTAL OF OTHER MISCELLANEOUS ITEMS					
GRAND TOTAL FOR FURNISHING (A)					
* GST EXTRA AS APPLICABLE					