



B.O.Q OF INTERIOR FURNISHING WORK FOR INDIAN BANK BRANCH AT TAMBOUR					
A SCHEDULE - 'A' (FURNISHING WORK)					
S.NO.	DESCRIPTION	UNIT	QTY.	RATE	AMOUNT
1	<b>SUSPENDED FALSE CEILING</b>				
1.1	<b>FALSE CEILING ( GYPSUM BAORD)</b>				
	Providing and fixing Gypsum false ceiling as per drawing including of providing and fixing G.I. Frame work shall comprise of G.I. perimeter channel (MF-6A) of size 0.50mm thick having one flange of 19.6mm and another flange shall be of size 29.6mm and a web of 26.6mm along with perimeter of ceiling, screw fixed to the beam to the required curvature with nylon sleeves and screws at not exceeding 610mm centers. Then suspending G.I. intermediate channel (MF-7) of size 45mm, 0.9mm thick with two flanges of 15mm each bent to the required curvature by cutting both its flanges. Suitable bracing to be provided where ever the flanges are cut with 0.9mm G.I. Flat and nuts and bolts at specific positions and thereafter at 1220mm centers with ceiling angle of width 25mm x 10mm x 0.50mm thick fixed to soffit with G.I. cleats and steel expansion fasteners as per specification of India gypsum at a distance of 2'0" c/c both ways complete with 12.5mm board and all necessary perimeter channels etc.	Sq.Ft.	550.00		
	The joints to be properly mended with paper tapes and gypsum compound all complete. The boards are to be jointed and finished which includes filling and finishing the tapered and square edges of the boards with jointing compound and fiber tape suitable for Gypsum board. A layer up to of 3.00mm thickness of Veneer Plaster is applied followed by two coats of topcoat (primer) at the face of board to give smooth seamless finish. 2 or more coats of plastic emulsion paint (roller finish) of approved shade and make shall be applied. The rate should include the full completion of the ceiling. At the time of handing over the site all necessary repairing work to be considered if required. The work to be completed as per specification, approval of the bank. No Drop or design (if any) will be considered as extra measurement it will be considered flat ceiling. (Only plan area to be measured for payment) .No extra payment will be made for the cutting of light points, stain glass, cove lighting etc. The measurement will be taken in one level, rate should include the drops also, no extra amount will be paid for the drops.				
1.2	<b>FALSE CEILING (ARMSTRONG CEILINGS - FINE FISSURED MICROLOOK EDGE WITH SILHOUETTE GRID (BLACK REVEAL)</b>				
	Providing and fixing false ceiling system manufactured by M/s. Armstrong World Industries using hot dipped galvanized steel section, rotary stitched main tee of size 15mm x 42 mm, web height, having 0.36 mm gauge at every 600 mm centre to centre maximum and rotary stitched cross tee of size 15 mm x 42 mm, having 0.33 mm gauge at every 600 mm. c/c. and wall angle of size 19 x 19 mm., having 0.35 mm gauge fixed to the periphery of the wall. The above grid is suspended at every 600mm c/c. in both directions using 2.0 mm. thick pre-straightened GI wire laying FINE FISSURED MICROLOOK WITH SILHOUETTE GRID (BLACK REVEAL) ceiling tiles manufactured by M/s. Armstrong World Industries, of size 600mmx600mmx15mm having NRC 0.55, Light reflectance of >84% (WT), thermal conductivity k = 0.052-0.057 W/m0K, Humidity Resistance of 99%, having Fire Performance CLASS O / CLASS 1 (BS 476), surface having 3 coats of white paint with Fine Fissured, back of the tile duly sanded and finished with a coat of protective paint over the formed grid complete. (Branch & ATM).	Sq.Ft.	676.00		
	<b>TOTAL OF SUSPENDED FALSE CEILING</b>				
2	<b>PARTITIONS WORK</b>				

S.NO.	DESCRIPTION	UNIT	QTY.	RATE	AMOUNT
2.1	<b>FULL HEIGHT SOLID PARTITION</b>	Sq.Ft.	80.00		
	Full ht. Solid Partition including flush door & strong room partition up to 7' only WITH LOUVRE :- Providing and fixing solid partition, the framing shall made out of aluminium hollow section of 65mm x 37mm size 1.5mm thick of JINDAL / INDAL as internal frame structure placed horizontally & vertically at max distance of 2'-0" x 2'-0" center to center. Fixing 6 mm thick commercial ply on both sides with 1.0mm thick laminate on top of approved shade with groove pattern as per instructions of Architect. The rate shall include the cost of providing skirting of 100mm wide lined with 1mm thk laminate and providing & fixing a border at top of 100mm wide lined with 1mm thk laminate complete. Laminate Should be considered up to two or three color combination. The edge beadings with steam beach wood should be finished with melamine polish if required, frame work above false ceiling done shall not be measured but contractor may factor it while quoting there rates as measurement up to false ceiling lvl.				
	The rate inclusive of providing & fixing of required flush door of 37mm thick approx. with 1.0mm th.laminate both side with steem beech wood chowkhat of size 75mm x 65mm approx and Item includes Heavy-duty SS ball bearing butt hinges 100 x 5.5 mm (4 Nos. per shutter) with screws etc.The shade of laminate finish to be got approved from Bank. All as per the design and instructions Bank.				
	Note :- For the purpose of payment partition shall be measured including the area of door/door frames up to false ceiling height.				
	Framework shall be rigidly secured to floor, bottom of slab & existing walls at 2'-0" c/c with dash fasteners.				
2.2	<b>Single skin partition</b>	Sq.Ft.	90.00		
	As of the above but Providing and fixing single skin partition above false ceiling(where false ceiling is provided only on one side) for a height of up to 600mm or near about soffit of roof using aluminium frame as specified above along with 6mm thick Commercial ply wood lined on only one side and lining with 1mm thk laminate of approved shade and amke along with grooves.				
2.3	<b>Full height Glazed partition</b>	Sq.Ft.	350.00		
	Same as of Solid ht. partition, providing 8mm thick Modi/saint Gobin float glass above 1'-0" / 3'-0" & up to 7'-0" fixed with steam beech wood beading of finished size 1 1/2" X 1" all along the edge. All edge-to-edge glass joint to be machine cut and polished and sealed with silicon sealant. joint shall be located strictly as shown in the drawing. All exposed woodwork to be mealamine polished. Item includes frosted/striped/designer glass film of 3m, Avery Dennison or equivalent ( basic rate of Flim Rs. 50/ Sq.ft. ) on existing glass as per manufacturer's specifications. All as per the design and instruction Bank.				
2.4	<b>Low. Height Semi Glazed Partition</b>	Sq.Ft.	270.00		
	Same as above but of Low height as per design including 10mm Toughened glass with edges polished to be used. All other specs are same as of above, Edges of the partition to be covered with 3" X 1.5" Steam beech wood duly melmine polished moulding. 38mm thick flush door: wicket gate also shall be included for a measurement. All as per the design and insturction bank.				
2.5	<b>Front Glazing In head cash cabin &amp; SWO</b>	Sq.Ft.	38.00		
	Providing & fixing 10mm thick toughened clear float glass to shape for front side of the cash counters including cutting the holes and providing & fixing TW beading polished and tinted to approved shade. ( including SWO/Chief Cashier front Glass).				
2.6	<b>ACP WALL PANNELLING (ATM) :-</b> Providing & fixing in position ACP (Aluminium Composite Panel) with framing of Aluminium Tube sections of min 1.5"x 1" and 20 gauge 2'-0" C/C both ways. ACP to be in 2' wide panels or distributed equally. Panels to be fixed to the frame with 3M or equi-valent adhesive. Joints to be finished with Silicon based sealant. Minimum ACP thickness-3 mm. Aluminum foil thickness to be min 0.25 mm on both sides. Alubond, Eurobond, Fujibond, Alcobond or equivalent ISO certified or approved brands to be used. White (IVORY) & Blue to be as per bank's approval. Additional Sections to be provided to fix the Indoor AC units. Both AC units to be installed near the machine area at the highest position. The rate shall be included for providing proper access panel for ATM power point and shall have proper locking arrangement for plug point by provding additional framing. ( The measurement shall be made up to falseceiling).	SQ.FT	100.00		

S.NO.	DESCRIPTION	UNIT	QTY.	RATE	AMOUNT
2.7	BACK ROOM (ATM) - Providing and fixing partition made up on Aluminium box section with 2"x2" and 20 gauge with 2'0" C/c Both ways, and to be fixed on inside 3 mm thick Aluminum Composite panel and rear side (only where backroom/storage is available) with 8 mm thick plywood finished with 2-coat colour enamel paint. The rate inclusive of providing and fixing of suitable shelves for fixation CCTVs instrument & UPS extra (1Nos.) & Access Door with teak wood louvers, and necessary accessories including handle & locking arrangement and necessary hardware complete as per details. All as per the design and instructions Bank. The item shall include suitable cutting & provision for installation of ATM facility.	SQ.FT	65.00		
	Note: - For the purpose of payment partition shall be measured including the area of door / door frames up to false ceiling height. Framework shall be rigidly secured to floor, bottom of slab & existing walls at 2'-0" c/c with dash fasteners.				
2.8	Grouting:- ATM to be firmly embedded into the ground with para bolts/anchor bolts through the SAFE of the ATM. Scope of work includes moving/tilting of machine, Drilling 8"-10" holes in the existing flooring using concrete drill bits, Hammering metal sleeves in these holes, Repositioning the machines over the existing markings, Anchor fasteners to be put in places, Min. 6" long anchor fasteners, preferably of Fischer make, Applying resin adhesive (Araldite) over the finished bolt positions for improved bonding and Repairing the broken tiles, if any	job	1.00		
<b>TOTAL OF PARTITIONS WORK</b>					
<b>3</b>	<b>DOOR &amp; ACCESSORIES</b>				
3.1	<b>Main Entrance Door PT Door</b>	Sq.Ft.	43.00		
	Providing and fixing toughend glass door shutters of 12mm thickness in opening of glazed partitions with stainless steel patch fittings of approved make ( DORMA/ DLINE / GEZE or approved equivalent) including heavy duty double action floor-spring with steel cover plate of approved make, pull handle SS brushed finishes 24" long thick 25mm on both sides of door shutters, locking arrangement of Dorma / D Line or equivalent or better quality as approved by Engineer-in-charge. Exposed edges of glass shall be machine cut & polished. Cost includes cutting and making good the floor, walls, ceiling etc. for fixing floor spring and patch fittings. All complete as per approval of the Architect.				
3.2	<b>Main Entrance Fixed PT Glazing</b>	Sq.Ft.	65.00		
	Providing and fixing toughend glass partition of 12mm thickness with stainless steel patch fittings of approved make ( DORMA/ DLINE / GEZE or approved equivalent as approved by Engineer-in-charge. Exposed edges of glass shall be machine cut & polished. Cost includes cutting and making good the floor, walls, ceiling etc. for fixing patch fittings. All complete as per approval of the Architect.				
3.5	Supplying and fixing of Dorma/GEZE Dline / Hardwyn/Godrej or approved equivalent Door Closer for wooden door for Branch manager, Banking hall, Chief Cashier, Dining, UPS, Toilet	Nos	5.00		
3.6	Supplying and fixing of mortice door lock of hardwyn make HML-480 Lock Body 304 Stainless Steel. (in BM Cabin, Store room 0. Cash cabin shall be Godrej Night latch. (atm 1 No.)	Nos	4.00		
3.7	Supplying and fixing of door stopper SS Grade 304, HESSF-2C hardwyn make.	Nos	6.00		
<b>TOTAL OF DOOR &amp; ACCESSORIES</b>					

S.NO.	DESCRIPTION	UNIT	QTY.	RATE	AMOUNT
4	<b>WORKING COUNTER</b>				
4.1	<b>CASH/STAFF COUNTERS</b>	Rft.	10.00		
	Providing and fixing Chief Cash Counter in split-levels @ 2'-6" (height 750mm) & 18" (1140mm) with 2'-6" & 15" wide each respectively. Upper levels having 12mm thick frosted toughened glass (i/c taxes and transportation). Edges of 18" wide counter shall be 12mm thick frosted toughened glass. Lower tier shall be made of 19mm thick ply wood finished in 1.5mm thick laminate. Exposed edge having steam beech wood edging of size 1 1/2" x 1". Vertical face shall have 12mm thick frosted toughened glass as per requirement of design. All exposed surfaces shall be finished with 1.0mm thick laminate of approved shade and colour.				
	1 no. prefabricated metal computer key board tray including drawer slides 12.5" x 22" tray with 14" telescopic slides including L - brackets for securing to the table top. Chest of drawers (size 1'-4" x 2'-0" x 2'-5") made of 19mm thick commercial ply wood having three drawers finished with 1.0mm thick Laminate on all sides. Each drawer shall have locking system and 6" long S.S. brushed finished handle, drawer slides etc. of approved make. All exposed edges of ply wood sealed with Steam beech wood beading of size 3/4" x 3/4". All beading and exposed wood shall be melamine polished and the Internal surfaces shall be .75 mm thick laminate. Item includes readymade metal powder coated CPU trolley, grommet, footrest for each seat. All complete as per approval and instructions of the Architect / employer. The rate also include providing and fixing painting a foot rest using hard wood 100 x 25mm size 1st class seasoned country frame.				
	Payment will be made only on the centerline measurement. The rate shall include the cost of providing skirting of 100mm wide lined with 1.0mm thk laminate and providing & fixing a border at top of 100mm wide lined with 1.0mm thk laminate complete. the Internal surfaces shall be .75 mm thick laminate.				
4.2	<b>RUNNING COUNTER</b>	Rft.	20.00		
	Providing and fixing staff counter/SWO in split-levels @ 2'-6" (750 mm) & 3'1" with 2'-6" (750 mm) & 9" wide each respectively. Upper levels having 1 mm thick laminate with 19 mm thick commercial ply top. Lower tier shall be made of 19mm thick ply wood and finished in 1 mm thick laminate. Working top having steam beech wood edging of size 1 1/2" x 1". Vertical face shall have 19 mm thick commercial ply over pine wood framework as per requirement of design. All exposed edges of ply wood sealed with Steam beech wood beading of size 3/4" x 3/4". All exposed surfaces shall be finished with 1.0mm thick laminate of approved shade.				
	The item includes Chest of drawers (size 1'-4" x 2'-0" x 2'-5") made of 19mm thick commercial ply wood having One drawers at top and a storage cabinet below having shutters of 19mm thick ply wood finished with 1.0mm thick Laminate on all sides. 1 no. prefabricated metal computer key board tray including drawer slides 12.5" x 22" tray with 14" telescopic slides including L - brackets for securing to the table top for each seat. All beading and exposed wood shall be melamine polished and the Internal surfaces shall be .75 mm thick laminate. Item includes 1'-3" high 12mm thick toughned glass above upper tier and readymade metal powder coated CPU trolley, grommet, foot rest for each seat. All complete as per approval and instructions of the Architect / employer. The rate also include providing and fixing painting a foot rest using hard wood 100 x 25mm size 1st class seasoned country frame. Payment will be made only on the centerline measurement.				
	The rate shall include the cost of providing skirting of 100mm wide lined with 1.0mm thk laminate and providing & fixing a border at top of 100mm wide lined with 1.0mm thk laminate complete.				
	<b>TOTAL OF WORKING COUNTER</b>				
5	<b>TABLE &amp; FURNITURE</b>				

S.NO.	DESCRIPTION	UNIT	QTY.	RATE	AMOUNT
5.1	<b>MANAGER TABLE ( Size:- 6'-0" x 3'-0") ht. 2'-6"</b>	Nos	1.00		
	Providing and fixing tables made out of 19 mm thick commercial ply over hard wood frame work finished with 1 mm thick laminate of approved shade. Top having steam beech wood edging of size 2" x 1 3/4". 10mm thick clear float glass with beveled edges shall be provided on the finished to 19mm thk Comm.ply wood of approved make clad with 1mm thk laminate( color with vertical grain) as per design in all visible areas. All the exposed edges to be covered with wooden steam beech lippings and mouldings duly malamine polish. The drawers to be made out of 19mm thk ply wood with 1.0 mm laminate finish in the front, and bottom to be made out of 6mm plywood and it should play in drawer sliding telescopic channels. The inside of the drawer shall be .75 mm thick laminate. & Table back side will be 1mm laminate. A leg rest to be provided duly polished made out of 3"x2" Wooden Section.The rate inclusive of providing & fixing wooden cabinet to suit the DVR for size 2'X6'X1'9" or as per the requirements)				
	A shutter to be made by 19mm ply wood clad with 1.0mm laminate. The necessary locks handles to be provided in each drawers and shutters. 3" x 1/2" wooden skirting to be provided in all visible areas duly polished. The necessary wire managers(SS) to be provided on the tables and provision for lights to be kept if required in the front of the table. All the exposed areas to be duly malamine polished The work to be completed as per design and approval of the Bank. The table should have key board tray and CPU Trolley to be Modular. All as per the design and instructions Bank the Internal surfaces shall be .75 mm thick laminate.				1
5.2	<b>Officer table same as above without glass top(5'0X2'6") height 2'6".</b>	Nos	1.00		
5.3	<b>SERVER TABLEE ( 2'-0" WIDE )</b>	Rft.	5.50		
	Providing and fixing of Utility//Server Counter 2'-0" wide top made up of 19mm thick commercial pasted on 1.0 mm thk laminate. The Top of table will be finish with 1.00 thk laminate.all hardware fittings fixtures etc. The drawers to be made out of 19mm thk board with 1.0 mm laminate finish in the front ,sides to be made out of 12mm plywood and bottom to be made out of 6mm plywood and it should play in drawer sliding telescopic channels. The inside of the drawer to be duly paint. All exposed edges to have wooden lipping stained to match the desk and melamine finished.Design and detail of the table shall be as per design. (As per Site, Designing of Table and specification may be Changed). The works to include a keyboard try and CPU trolley to be modular. All as per the design and instructions Bank. (S.S. Finish Lock & Handle to be included )				
	<b>TOTAL OF TABLE &amp; FURNITURE</b>				
6	<b>STORAGE &amp; SIDE UNIT</b>				

S.NO.	DESCRIPTION	UNIT	QTY.	RATE	AMOUNT
<b>6.1</b>	<b>Side and Back Unit</b>				
	Providing and fixing Full /Low height Cabiner400mm deep made out of 19mm thk plywood finished with 1.0mm laminate in all exposed areas . The Shutter to be made out of 19mm ply wood in the front claddd with 1.0mm laminate( color, vertical grain) . and bottom made out of 6mm plywood duly painted in matching tone and shelves 19mm thk comm ply wood to fixed inside storage. The shutters to be made out of 19mm ply wood . The necessary locks , handles, etc to be provided . 3" x1/2 wooden skirting to be provided duly polished as per matching tone all along the visible areas . Inside of the unit shall be .75 mm thick laminate finish . All the exposed edeges of the boards/plywoods to be coverd with wooden lippings/mouldings duly polished all complete.All as per the design and instructions Bank.	Sq.Ft.	66.00		
<b>6.2</b>	<b>Full HT cabinet UNIT</b>	Sq.Ft.	0.00		
	Providing and fixing Full /Low height Cabiner400mm deep made out of 19mm thk plywood finished with 1.0mm laminate in all exposed areas . The Shutter to be made out of 19mm ply wood in the front claddd with 1.0mm laminate( color, vertical grain) . and bottom made out of 6mm plywood duly painted in matching tone and shelves 19mm thk comm ply wood to fixed inside storage. The shutters to be made out of 19mm ply wood . The necessary locks , handles, etc to be provided . 3" x1/2 wooden skirting to be provided duly polished as per matching tone all along the visible areas . Inside of the unit to be enamel paint finish . All the exposed edeges of the boards/plywoods to be coverd with wooden lippings/mouldings duly polished all complete.All as per the design and instructions Bank.				
<b>6.3</b>	<b>Main Electrical Panel Cabinet</b>	Sq.Ft.	50.00		
	Providing and fixing of DB Shuttering formed of 12mm thk'plywood wood on 12mm thick Gypsum board (fire Proof) with finsih as per Item no 1 for inside and out side shutters finished with laminate on outer surface with SS (4Nos) louvre perforation and necessary hardware,hinges etc complete as per details. All as per the design and instructions Bank.				
<b>TOTAL OF STORAGE &amp; SIDE UNIT</b>					
<b>7</b>	<b>OTHER MISCELLANEOUS ITEMS</b>				
<b>7.1</b>	<b>PIN UP / NOTICE BOARD</b>				
	Providing and fixing soft board with necessary framework with 12mm BWR plywood on top 12 Jolly board to be fixed finished with fabric @Rs80 , with necessary mouldings duly polished along the periferi. All as per the design and instructions Bank.	Sq.Ft.	24.00		
<b>7.4</b>	<b>WRITING LEDGER &amp; Cheque &amp; sugestion box</b>	NO	1.00		
	Providing and fixing writing ledge as per design minium 5 ft length made out 19mm comm. board with necessary grove patterns with 1.0mm laminate. 10mm thk machine polished glass to be provided on top of the writing ledge. Small boxes to be made out of 12mm comm. ply to be made on top of the writing ledge finished with 1.0 mm laminate, inside enamel painted and rate should be included providing fixing of sugestion box & Cheque deposit box as per approval of bank.The work to be completed,as per design and approval of the architect.				

S.NO.	DESCRIPTION	UNIT	QTY.	RATE	AMOUNT
7.5	<b>Outer Shutter Boxing</b>				
	Overhead outside shutter box: p/f sal wood frame fixing of 12mm plywood with 1mm thk. Laminate finish and openable shutter for out side area inside shall be 2 coat enamel paint with primer	Sq.Ft.	200.00		
7.6	<b>WALL PANELLING</b>				
	Fabricating and fixing wall/column paneling, the framing shall made out of aluminium hollow section of 65mm x 37mm size 1.5mm thick of JINDAL / INDAL at spacing not exceeding 600mm bothways (horizontal and vertical). Paneling framework to be secured to wall surface/column surface. Paneling framework to be clad on one side with 9mm thick ply finished with 1.0mm thk laminate including skirting of 100mm high & 12mm x 12mm groove at skirting level. All as per the design and instructions Bank.	Sq.Ft.	0.00		
7.9	<b>ROLLING BLINDS</b>				
	Providing and fixing Roller blinds of approved design and shade by the Architect, incl all std fittings as per manufacturer's specification. The work to be completed as per specification and approval of the architect. (approved brand Vista, Hunter Dogulus)	Sq.Ft.	20.00		
	<b>TOTAL OF OTHER MISCELLANEOUS ITEMS</b>				
	<b>GRAND TOTAL FOR FURNISHING (A)</b>				
	<b>* GST EXTRA AS APPLICABLE</b>				



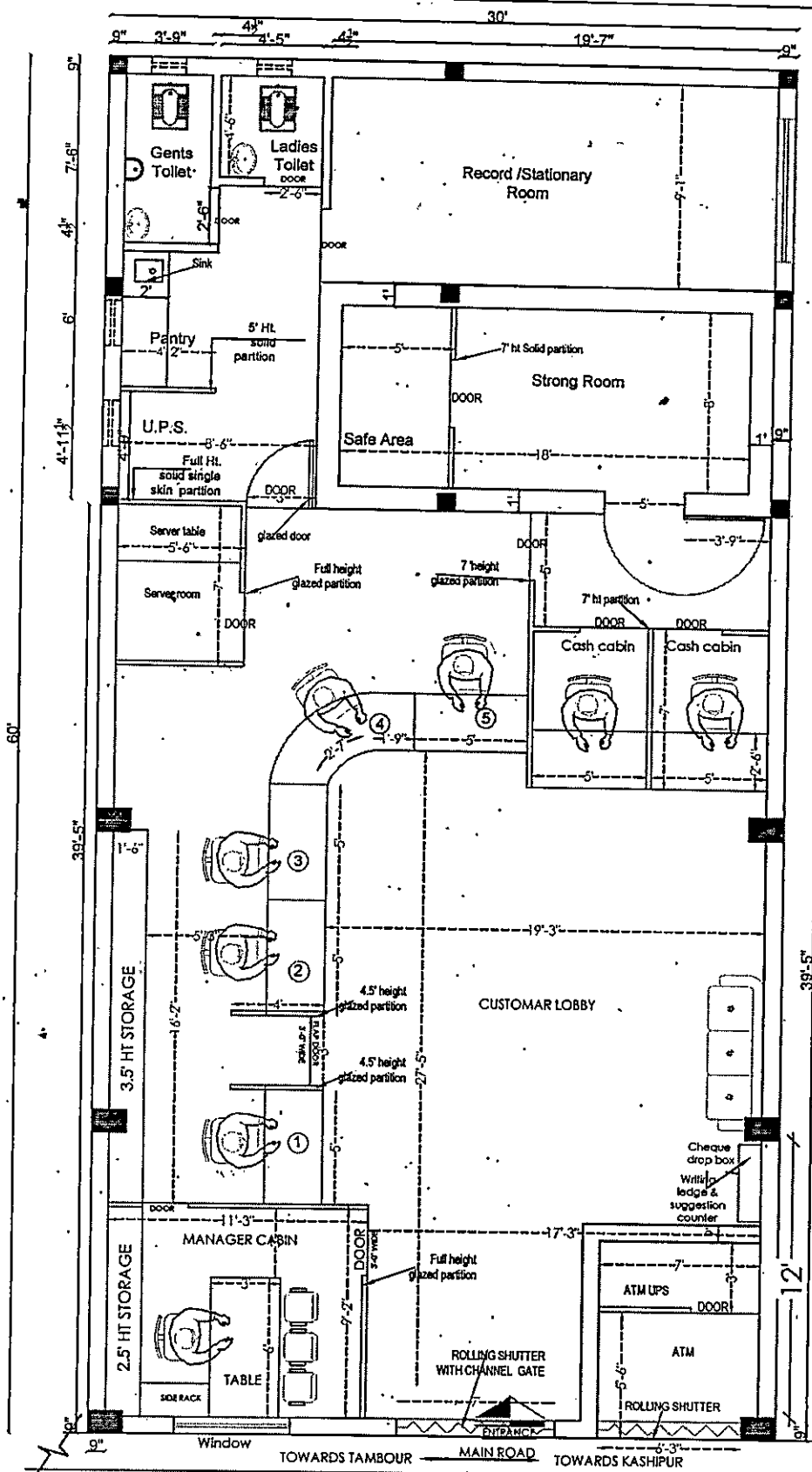

OPTION-5

<p>PROJECT          PROPOSED LAYOUT OF INDIAN BANK BRANCH AT SHRI KRISHANA PAL SINGH P.G COLLEGE TAMBOUR - DISTRICT - SITAPUR - U.P</p>	<p>DRAWING          FURNITURE LAYOUT</p>	<p>NORTH  </p>	<p>SCALE          N.T.S.          DATE          FEB 2022</p>
---	--	--------------------	--