

Zonal Office:Lakhimpur Kheri

NOTICE INVITING QUOTATION

Sub: COMPETITIVE QUOTATION FOR INTERIOR FURNISHING WORK AT NEW PREMISES OF MAMARI BRANCH UNDER LAKHIMPUR KHERI ZONE

Competitive sealed quotations are invited in the prescribed format from the contractors who are already empanelled with bank executed interior furnishing of nationalized Banks in last three years.

Formats of quotations document is enclosed for submission of interior furnishing, electrical work at new Premises of Mamari branch Distt-Lakhimpur Kheri. Full details and quotation document are available in Bank's website www.indianbank.co.in or can be obtained from Zonal Office Lakhimpur Kheri. Duly filled quotations along with duly signed enclosed general terms and conditions should be submitted as per following schedule:

1	Issue of Quotation Document	From 16.12.2022 to 31.12.2022
2	Submission of Quotation	On or before 31.12.2022 up to 3:00PM
3	Opening of Quotation	On 02.01.2023 at 11:00 AM
4	Date of Commencement	7 Days from the date of issue of letter awarding the job
5	Time of Completion	20 days
6	Defect Liability Period	12 Months
7	Earnest Money	Rs.5000/- in form of DD/IOI in favour of Indian Bank payable at Lakhimpur Kheri
8	Liquidated Damages for delay	Rs.2000/- per day subject to Max. of 10 % of accepted contract amount. (If the work is not completed to the satisfaction of the Employer within the stipulated period the contractor shall be bound to pay to the employer a sum equivalent to Rs. 2000/- per day subject to ceiling of 10% of the accepted contract amount by way of liquidated damages and not as penalty during which the work remains un-commenced or unfinished after expiry of the completion date).
9	Payment Terms	Neither any advance nor any running payment will be made. Payment will be made on satisfactory completion of the job on the basis of actual measurements. Income tax will be deducted as per the rules. Retention money 10% will be deducted from the bill and will be released after 12 months from the date of actual completion of the work provided no defect is observed during this period.
10	Document to be attached with the Bill	Completion Certificates issued by Project architect along with the certificate that materials used are as per specification mentioned in the quotation document and Completion Certificates issued by Branch Manager & 4-5 photographs showing completion status of work. Bill must be verified by project architect.
11	Retention Money	10% (Including Earnest money)

The Bank will not be bound to accept the lowest quotation and reserves the right to accept or reject any or all the quotations without assigning any reason whatsoever. Late/delayed quotation shall not be accepted after due date and time of submission of quotation.

Zonal Manager



Zonal Office: Lakhimpur Kheri

NOTICE INVITING COMPETITIVE QUOTATION

Work: COMPETITIVE QUOTATION FOR INTERIOR FURNISHING WORK AT NEW PREMISES OF MAMARI BRANCH UNDER LAKHIMPUR KHERI ZONE

General terms & Conditions:- (To be signed by the contractor and enclosed with the quotation)

- 1) Sealed quotation should be addressed to The Zonal Manager, Indian Bank, Zonal Office Lakhimpur Kheri and super scribed name of Work **Furnishing work at new Premises of Mamari Branch, Distt- Lakhimpur Kheri** and should reach before 3:00 p.m. on or before 08.09.2022 at Zonal Office Lakhimpur Kheri.
MailingAddress:
The ZonalManager,
Indian Bank
Zonal Office,Lakhimpur Kheri
Radhey Complex, Kachahary Road,
Lakhimpur Kheri-262701 (U.P)
- 2) No quotation will be accepted after 3:00 pm on 31.12.2022 and quotations will be opened on 02.01.2023 at 11:00 AM unless otherwise informed.
- 3) The quotations will remain valid for a period of 3 months from the date of opening.
- 4) Bank reserves the right to accept or reject any or all the quotations accept part of any quotation, entrust the entire work to any contractor or divide the work to more than one contractor (item wise) without assigning any reason to do so or giving any explanation. The rates quoted by the contractors will help well for bifurcation and no compensation will be paid on this account.
- 5) At the time of submission every quotation must be accompanied by IOI/ Demand Draft for an amount of Rs.5000/- in favour of INDIAN BANK payable at Lakhimpur Kheri towards EMD. Any quotation which is not accompanied by EMD will be summarily rejected.
- 6) Contract should quote rates in figures as well as in words.
- 7) All erasures and alterations made must be attested with the initials of contractor. No overwriting is permitted.
- 8) The EMD of the unsuccessful contractor will be returned within 45 days from the date of opening of the quotation.
- 9) Joint quotations shall not be considered. Conditional quotations quoted by the contractor are liable to be rejected.
- 10) No escalation in the rates will be allowed under any circumstances.
- 11) On receipt of the intimation from the bank of the acceptance of his quotation, the contractor should submit his acceptance within 3 days. If the successful contractor fails to undertake the work within 7 days after work allotment, the EMD will be forfeited and acceptance of his quotation may be withdrawn.
- 12) The rate quoted in the quotations shall be inclusive of all materials as required and shall be inclusive of all charges of scaffoldings, lifting, tools and plants, freights/ transportation, labour conditions and fluctuations in rates of excise duty, octroi, GST, VAT, Excise Duty, service tax and any other taxes or expenditure of carrying out the works.
- 13) The Agency is advised to inspect and examine the sites and satisfy himself as to the condition prevailing at sites and its surrounding extent of work, scope and conditions under which the work is to be executed. The contractor shall also satisfy himself about the accessibility to the premises.
- 14) The agency shall submit the offer which satisfies each and every condition laid down in this notice, failing which the quotation will be liable to be rejected. Conditional quotations shall not be considered and will be out rightly rejected in the very first instance.

- 15) Work will be completed within the period of 15 days from the date of issue of quotation or work order whichever is earlier. If the work is not completed to the satisfaction of employer within the stipulated period, the contractor will be bound to pay to the Employer a sum equivalent to Rs.2000/- per day subject to ceiling of Max 10% of the accepted contract amount by way of liquidated damages and not as penalty during which the work remains uncommenced or unfinished after expiry of the completion date. The contract may be rescinded by giving one week notice in case work is not executed as per specification and as per time schedule given in quotation document.
- 16) The liquidated damages as mentioned in the Notice inviting quotation may not be enforced if the contractor applies for extension of time mentioning the genuine reasons for extension. If an extension of time of completion of the work is sought on the grounds of having unavoidable hindrances in his execution or any other ground, the contractor shall apply in writing to the Zonal Manager, Zonal Office Lakhimpur Kheri with full details of the circumstances which is causing such an extension. Extension of time in days will be granted by the bank if it is proved that the contractor is not at fault for extending the work beyond stipulated date of completion. At the decision in this regard taken by the Bank shall be binding to the contractor.
- 17) The successful contractor is bound to carry item of work necessary for completion of job even though the same are not included in the schedule of quantity. Rates of extra item will be derived from quotation. In case the rates do not exist in quotation and extra item is not similar to the quoted item, then the rates will be worked out on actual cost of material and labour, any other expenditure for completing that work plus 15% towards contractor's profit and overheads.
- 18) The work shall be carried out in such a way that, there is least disturbance to the staff of Bank. Contractors are required to organize the work in such a way that workings of staff and officers/executives of Office are not affected. Contractor is required to take adequate Care during progress of work to protect belongings. In case any damage, contractors at their own cost shall make the same good.
- 19) The contractor must co-operate with other contractors appointed by the bank so that entire work shall proceed smoothly and to the complete satisfaction of the Bank.
- 20) Contractor will arrange necessary tools and plants for completing the work at their own cost. In case of any accident the total responsibility will be on the contractor. Contractors are required to submit time schedule of work. After completion of work, cleaning of floors, walls etc are to be done on daily basis to the satisfaction of Branch Head / engineer-in-charge. After completion of jobs, the site shall be cleared of all rubbish /malba /debris etc in all respect and handover the site in proper manner on completion of the work.
- 21) No advance will be paid. Payment will be released on satisfactory completion of job and submission of bills. Retention Money @10% will be deducted from the bill and to be released after twelve months from the date of actual completion of the work provided no defects is observed during the period.
- 22) In case of non-completion or delay in completion of work or removal of defects in time, the bank shall be free to appoint another agency to get the job done at contractor's risk and cost.
- 23) The contractor will attend to all the defects noticed during defect liability period. If the contractor fails to attend the defects these defects will be got rectified by the bank and the expenditure incurred on this account will be recovered from security deposit / retention money.
- 24) The work shall be got approved by the Architect / engineer and the contractor shall rectify any bad workmanship pointed out at any stage and remove from the site all the rejected materials immediately at his own cost.
- 25) The contractor shall acquaint himself with the site conditions making his own arrangements for storing of materials at site, lift, cartage etc. at his own risk and safety.
- 26) The Contractor shall make adequate arrangement for watch and ward of material and shall ensure the safety, breakage and any theft of material fixed or unfixed by him or the other sub contractors. The bank shall not be liable for any sort of loss incurred.
- 27) The contractor shall be responsible for application of labour laws, compensation for injury and accident to person, whether employed by him or his sub-contractor.
- 28) The contractor shall ensure that the workmen employed by him for the execution of work are suitably covered against Workmen Compensation Act and that all liabilities arising out of Workmen's compensation Act, ESIS and other legislative enactment applicable to such works and workmen shall be to the contractor's account and responsibility.

- 29) Civil, Interior Furnishing and Electrical Works will be carried out as per Bank's standard drawing / specifications and to the entire satisfaction of the bank.
- 30) The contractor shall inform the bank, well in time, to check measurements of any work, which is likely to be hidden before covering.
- 31) Income tax at prevailing rates will be deducted at source from contractor's bill and will be deposited with I.T.O. as per rules.
- 32) Any extra work or item can only be started by contractor after obtaining written approval from the Zonal Office. Item executed without prior approval from the Zonal Office will not be considered for payment.
- 33) The quantities mentioned in the schedule of quantities are approximate. Payment will be made on the actual work done by the contractors. However the contractor should not deviate the quantity without Bank's permission.
- 34) The Bank has the right to alter the nature of work and to add or omit any items of work or to have the option of the same carried out departmentally or otherwise and such alterations or variations shall be carried out without prejudices to the contract.
- 35) The Bank has the right to terminate the contract if the contractor abandons the work or fails to commence the work in time, or fails to abide by the terms & conditions of the contract.

I have read and understood all the instructions/conditions given above and I have taken into account the above instructions/conditions while quoting the rates.

Date:

(Signature of the Contractor)

Place:

Seal

SUMMARY FOR INTERIOR FURNISHING WORK FOR INDIAN BANK AT MAMRI BRANCH		
S.NO	DESCRIPTION	AMOUNT (Rs.)
A	(FURNISHING WORK)	
1.0	FALSE CEILING	
2.0	PARTITION WORK	
3.0	DOOR & ACCESSORIES	
4.0	WORKING COUNTER	
5.0	TABLE & FURNITURE	
6.0	CUPBOARDS AND SIDE UNIT	
7.0	OTHER MISC. WORK	
	TOTAL	
	IF ANY DISCOUNT	
	DISCOUNT AMOUNT	
	GRAND TOTAL	
	NOTE :- GST (WCT) TAX WILL BE EXTRA.	
	Contractor Signature & Seal	
	GST No:-	

B.O.Q OF INTERIOR FURNISHING WORK FOR INDIAN BANK AT MAMRI BRANCH

S.NO.	DESCRIPTION	UNIT	QTY.	RATE	AMT
1	SUSPENDE FALSE CEILING				
1.1	FALSE CEILING (GYPSUM BAORD)				
	Providing and fixing Gypsum false ceiling as per drawing including of providing and fixing G.I. Frame work shall comprise of G.I. perimeter channel (MF-6A) of size 0.50mm thick having one flange of 19.6mm and another flange shall be of size 29.6mm and a web of 26.6mm along with perimeter of ceiling, screw fixed to the beam to the required curvature with nylon sleeves and screws at not exceeding 610mm centers. Then suspending G.I. intermediate channel (MF-7) of size 45mm, 0.9mm thick with two flanges of 15mm each bent to the required curvature by cutting both its flanges. Suitable bracing to be provided where ever the flanges are cut with 0.9mm G.I. Flat and nuts and bolts at specific positions and thereafter at 1220mm centers with ceiling angle of width 25mm x 10mm x 0.50mm thick fixed to soffit with G.I. cleats and steel expansion fasteners as per specification of India gypsum at a distance of 2'0" c/c both ways complete with 12.5mm board and all necessary perimeter channels etc.	Sq.Ft.	600.00		
	The joints to be properly mended with paper tapes and gypsum compound all complete. The boards are to be jointed and finished which includes filling and finishing the tapered and square edges of the boards with jointing compound and fiber tape suitable for Gypsum board. A layer up to of 3.00mm thickness of Veneer Plaster is applied followed by two coats of topcoat (primer) at the face of board to give smooth seamless finish. 2 or more coats of plastic emulsion paint (roller finish) of approved shade and make shall be applied. The rate should include the full completion of the ceiling. At the time of handing over the site all necessary repairing work to be considered if required. The work to be completed as per specification , approval of the bank. No Drop or design(if any)will be considered as extra measurement it will be considered flat ceiling. (Only plan area to be measured for payment) .No extra payment will be made for the cutting of light points , stain glass,cove lighting etc. The measurement will be taken in one level , rate should include the drops also, no extra amount will be paid for the drops.				
1.2	FALSE CEILING (ARMSTRONG CEILINGS – FINE FISSURED MICROLOOK EDGE WITH SILHOUETTE GRID (BLACK REVEAL)				
	Providing and fixing false ceiling system manufactured by M/s. Armstrong World Industries using hot dipped galvanized steel section, rotary stitched main tee of size 15mm x 42 mm web height, having 0.36 mm gauge at every 600 mm centre to centre maximum and rotary stitched cross tee of size 15 mm x 42 mm, having 0.33 mm gauge at every 600 mm. c/c. and wall angle of size 19 x 19 mm., having 0.35 mm gauge fixed to the periphery of the wall. The above grid is suspended at every 600mm c/c. in both directions using 2.0 mm. thick pre-straightened GI wire laying FINE FISSURED MICROLOOK WITH SILHOUETTE GRID(BLACK REVEAL) ceiling tiles manufactured by M/s. Armstrong World Industries, of size 600mmx600mmx15mm having NRC 0.55, Light reflectance of >84% (WT), thermal conductivity k = 0.052-0.057 W/m0K, Humidity Resistance of 99% , having Fire Performance CLASS 0 / CLASS 1 (BS 476), surface having 3 coats of white paint with Fine Fissured, back of the tile duly sanded and finished with a coat of protective paint over the formed grid complete.(Branch & ATM) .	Sq.Ft.	540.00		
	TOTAL OF SUSPENDE FALSE CEILING				
2	PARTITIONS WORK				

S.NO.	DESCRIPTION	UNIT	QTY.	RATE	AMT
2.1	FULL / LOW HEIGHT SOLID PARTITION	Sq.Ft.	95.00		
	Full ht. Solid Partition including flush door & strong room partition up to 7' only WITH LOUVRE :- Providing and fixing solid partition , the framing shall made out of aluminium hollow section of 65mm x 37mm size 1.5mm thick of JINDAL / INDAL as internal frame structure placed horizontally & vertically at max distance of 2'-0" x 2'-0" center to center. Fixing 6 mm thick commercial ply on both sides with 1.0mm thick laminate on top of approved shade with groove pattern as per instructions of Architect. The rate shall include the cost of providing skirting of 100mm wide lined with 1mm thk laminate and providing & fixing a border at top of 100mm wide lined with 1mm thk laminate complete. Laminate Should be considered up to two or three color combination. The edge beadings with steam beach wood should be finished with melamine polish if required, frame work above false ceiling done shall not be measured but contractor may factor it while quoting there rates as measurment up to false ceiling lvl..				
	The rate inclusive of providing & fixing of required flush door of 37mm thick approx. with 1.0mm th.laminate both side with steem beech wood chowkhat of size 75mm x 65mm approx and Item includes Heavy-duty SS ball bearing butt hinges 100 x 5.5 mm (4 Nos. per shutter) with screws etc.The shade of laminate finish to be got approved from Bank. . All as per the design and instructions Bank.				
	Note :- For the purpose of payment partition shall be measured including the area of door/door frames up to false ceiling heaight.				
	Framework shall be regidly secured to floor, bottom of slab & existng walls at 2'-0" c/c with dash fasteners.				
2.2	Single skin partition	Sq.Ft.	0.00		
	As of the above but Providing and fixing single skin partition above false ceiling(where false ceiling is provided only on one side) for a height of up to 600mm or near about soffit of roof using aluminium frame as specified above along with 6mm thick Commercial ply wood lined on only one side and lining with 1mm thk laminate of approved shade and amke along with grooves.				
2.3	Low height Glazed partition Manager Cabin	Sq.Ft.	100.00		
	Same as of Solid ht. partition , providing 8mm thick Modi/saint Gobin float glass above 1'-0" / 3'-0" & up to 7'-0" fixed with steam beech wood beading of finished size 1 1/2" X 1" all along the edge. All edge-to-edge glass joint to be machine cut and polished and sealed with silicon sealant. joint shall be located strictly as shown in the drawing. All exposed woodwork to be mealamine polished. Item includes frosted/striped/designer glass film of 3m, Avery Dennison or equivalent (basic rate of Flim Rs. 50/ Sq.ft.) on existing glass as per manufacturer's specifications. All as per the design and instruction Bank.				
2.4	Single window Partitions	Sq.Ft.	260.00		
	Providing and fixing in position Double skin partition 7'-0" height.The framing shall made out of aluminium hollow section of 65mm x 37mm size 1.5mm thick of JINDAL / INDAL as internal frame structure placed horizontally & vertically at max distance of 2'-0" x 2'-0" center to center. Fixing 6 mm thick commercial ply on both sides with 1 mm thick laminate of approved colour and shade as per approval of the Architect. The partition to include 8 mm. thick Modi Float glass with etching on the sides and back including a door 3'-0" wide as per the approval with all necessary hardware, night latches etc. All exposed edges to be covered with steam beech wood Beading,4mm grooves in places as per design duly melamine polished inclusive of all materials,hardware, night latches, labour, T&P, taxes, levies, etc. completed to the satisfaction of the bank & drawing.				
2.5	Low. Height Semi Glazed Partition	Sq.Ft.	90.00		

S.NO.	DESCRIPTION	UNIT	QTY.	RATE	AMT
	Same as above but of Low height as per design including 10mm Toughened glass with edges polished to be used. All other specs are same as of above, Edges of the partition to be covered with 3" X 1.5" Steam beech wood duly melmine polished moulding. 38mm thick flush door: wicket gate also shall be included for a measurement. All as per the design and insturction bank.				
2.6	Front Glazeing In head cash cabin & SWO	Sq.Ft.	30.00		
	Providing & fixing 10mm thick toughened clear float glass to shape for front side of the cash counters including cutting the holes and providing & fixing TW beading polished and tinted to approved shade. (including SWO/Chief Cashier front Glass).				
2.7	Aluminium grill on the ceiling of Cash cabin	Sq.Ft.	70.00		
2.6	ACP WALL PANELLING (ATM) :- Providing & fixing in position ACP (Aluminium Composite Panel) with framing of Aluminium Tube sections of min 1.5"x 1" and 20 gauge 2'-0" C/C both ways. ACP to be in 2' wide panels or distributed equally. Panels to be fixed to the frame with 3M or equi-valent adhesive. Joints to be finished with Silicon based sealant. Minimum ACP thickness-3 mm. Aluminum foil thickness to be min 0.25 mm on both sides. Alubond, Eurobond, Fujibond, Alcobond or equivalent ISO certified or approved brands to be used. White (IVORY) & Blue to be as per bank's approval. Additional Sections to be provided to fix the Indoor AC units. Both AC units to be installed near the machine area at the highest position. The rate shall be included for providing proper access panel for ATM power point and shall have proper locking arrangement for plug point by provding additional framing. (The measurement shall be made up to falseceiling).	SQ.FT	0.00		
	TOTAL OF PARTITIONS WORK				
3	DOOR & ACCESSORIES				

S.NO.	DESCRIPTION	UNIT	QTY.	RATE	AMT
3.1	Main Entrance Door & Fixed glazing	Sq.Ft.	75.00		
	Providing and fixing aluminium entrance doors with 12mm floatglass (3M frosted sticker) as/design with top & bottom section of 45 by 90mm , 2mm thick section of hindalco/indal anodized in approved colour with 25 micron anodizing along with SS C shaped handles of kitch or equivalent make along with floor spring of hemco/everite make. The item also includes door lock completed to the satisfaction of the architect.				
3.5	Supplying and fixing of Dorma/GEZE Dline / Hardwyn/Godrej or approved equivalent Door Closer for wooden door for Branch manager, Banking hall, Chief Cashier , Dinning ,UPS,Toilet	Nos	2.00		
3.6	Supplying and fixing of mortice door lock of hardwyn make HML-480 Lock Body 304 Stainless Stell. (in BM Cabin , Store room 0. Cash cabin shall be Godrej Night latch.(atm 1 No.)	Nos	3.00		
3.7	Supplying and fixing of door stopper SS Grade 304, HESSF-2C hardwyn make.	Nos	5.00		
	TOTAL OF DOOR & ACCESSORIES				
4	WORKING COUNTER				
4.1	CASH COUNTERS	Rft.	10.00		
	Providing and fixing Chief Cash Counter in split-levels @ 2'-6" (height 750mm) & 18" (1140mm) with 2'-6" & 15" wide each respectively . Upper levels having 12mm thick frosted toughened glass (i/c taxes and transportation). Edges of 18" wide counter shall be 12mm thick frosted toughened glass. Lower tier shall be made of 19 mm thick ply wood finished in 1.5mm thick laminate. Exposed edge having steam beech wood edging of size 1 ½" x 1". Vertical face shall have 12mm thick frosted toughened glass as per requirement of design. All exposed surfaces shall be finished with 1.0mm thick laminate of approved shade and colour.				
	1 no. prefabricated metal computer key board tray including drawer slides 12.5" x 22" tray with 14" telescopic slides including L - brackets for securing to the table top. Chest of drawers (size 1'-4" x 2'-0" x 2'- 5") made of 19mm thick commercial ply wood having three drawers finished with 1.0mm thick Laminate on all sides. Each drawer shall have locking system and 6" long S.S. brushed finished handle, drawer slides etc. of approved make. All exposed edges of ply wood sealed with Steam beech wood beading of size ¼" x ¾". All beading and exposed wood shall be melamine polished and the Internal surfaces shall be .75 mm thick laminate.Item includes readymade metal powder coated CPU trolley, grommet, footrest for each seat. All complete as per approval and instructions of the Architect / employer.The rate also include providing and fixing painting a foot rest using hard wood 100 x 25mm size 1st class seasoned country frame.				
	Payment will be made only on the centerline measurement. The rate shall include the cost of providing skirting of 100mm wide lined with 1.0mm thk laminate and providing & fixing a border at top of 100mm wide lined with 1.0mm thk laminate complete. the Internal surfaces shall be .75 mm thick laminate.				
4.2	RUNNING COUNTER	Rft.	13.00		

S.NO.	DESCRIPTION	UNIT	QTY.	RATE	AMT
	Providing and fixing staff counter/SWO in split-levels @ 2'-6" (750 mm) & 3'1" with 2'-6" (750 mm) & 9" wide each respectively. Upper levels having 1 mm thick laminate with 19 mm thick commercial ply top. Lower tier shall be made of 19mm thick ply wood and finished in 1 mm thick laminate. Working top having steam beech wood edging of size 1 1/2" x 1". Vertical face shall have 19 mm thick commercial ply over pine wood framework as per requirement of design. All exposed edges of ply wood sealed with Steam beech wood beading of size 1/4" x 3/4". All exposed surfaces shall be finished with 1.0mm thick laminate of approved shade.				
	The item includes Chest of drawers (size 1'-4" x 2'-0" x 2'-5") made of 19mm thick commercial ply wood having One drawers at top and a storage cabinet below having shutters of 19mm thick ply wood finished with 1.0mm thick Laminate on all sides. 1 no. prefabricated metal computer key board tray including drawer slides 12.5" x 22" tray with 14" telescopic slides including L – brackets for securing to the table top for each seat. All beading and exposed wood shall be melamine polished and the Internal surfaces shall be .75 mm thick laminate. Item includes 1'-3" high 12mm thick toughened glass above upper tier and readymade metal powder coated CPU trolley, grommet, foot rest for each seat. All complete as per approval and instructions of the Architect / employer. The rate also include providing and fixing painting a foot rest using hard wood 100 x 25mm size 1st class seasoned country frame. Payment will be made only on the centerline measurement.				
	The rate shall include the cost of providing skirting of 100mm wide lined with 1.0mm thk laminate and providing & fixing a border at top of 100mm wide lined with 1.0mm thk laminate complete.				
TOTAL OF WORKING COUNTER					
5	TABLE & FURNITURE				
5.1	MANAGER TABLE (Size:- 6'-0" x 2'-6") ht. 2'-6"	Nos	1.00		
	Providing and fixing tables made out of 19 mm thick commercial ply over hard wood frame work finished with 1 mm thick laminate of approved shade. Top having steam beech wood edging of size 2" x 1 3/4". 10mm thick clear float glass with beveled edges shall be provided on the finished to 19mm thk Comm.ply wood of approved make cladded with 1mm thk. laminate(color with vertical grain) as per design in all visible areas. All the exposed edges to be covered with wooden steam beech lippings and mouldings duly malamine polish. The drawers to be made out of 19mm thk ply wood with 1.0 mm laminate finish in the front, and bottom to be made out of 6mm plywood and it should play in drawer sliding telescopic channels. The inside of the drawer shall be .75 mm thick laminate. & Table back side will be 1mm laminate. A leg rest to be provided duly polished made out of 3"x2" Wooden Section. The rate inclusive of providing & fixing wooden cabinet to suit the DVR for size 2'X6"X1'9" or as per the requirements)				
	A shutter to be made by 19mm ply wood cladded with 1.0mm laminate. The necessary locks handles to be provided in each drawers and shutters. 3" x 1/2" wooden skirting to be provided in all visible areas duly polished. The necessary wire managers(SS) to be provided on the tables and provision for lights to be kept if required in the front of the table. All the exposed areas to be duly malamine polished The work to be completed as per design and approval of the Bank. The table should have key board tray and CPU Trolley to be Modular. All as per the design and instructions Bank the Internal surfaces shall be .75 mm thick laminate.				
5.2	Officer TABLE (Size:- 5'-0" x 2'-6") ht. 2'-6" as per above specification	Nos	1.00		
	without glass top				
5.3	Server TABLE (Size:- 5'-0" x 2'-0") ht. 2'-6" as per above specification	Nos	1.00		

S.NO.	DESCRIPTION	UNIT	QTY.	RATE	AMT
	without glass top				
	TOTAL OF TABLE & FURNITURE				
6	STORAGE & SIDE UNIT				
6.1	Side and Back Unit				
	Providing and fixing Side Unit/ Back unit 400 mm depth made out of 19mm ply wood finished with 1.0mm laminate in all exposed areas and top shall be 1 mm thick . The drawers to be made out of 19mm commercial plywood and cladded with 1.0mm laminate and bottom made out of 6mm comm ply duly painted in matching tone and it should play on drawer sliding channels . The shutters to be made out of 19mm commercial ply wood and should play on drawer sliding castors on powder coated channels. The necessary locks , handles, etc to be provided . 3" x1/2 wooden skirting to be provided duly polished as per matching tone all along the visible areas . Inside of the unit shall be .75 mm thick laminate. in matching tone . All the exposed edges of the boards/ply woods to be coverd with woden lippings/mouldings duly polished all complete. The work to be completed as per approval and specification of the Architect.	Nos	2.00		
6.2	Low HT cabinet	Sq.Ft.	60.00		
	Providing and fixing Full /Low height Cabiner400mm deep made out of 19mm thk plywood finished with 1.0mm laminate in all exposed areas . The Shutter to be made out of 19mm ply wood in the front cladded with 1.0mm laminate(color, vertical grain) . and bottom made out of 6mm plywood duly painted in matching tone and shelves 19mm thk comm ply wood to fixed inside storage. The shutters to be made out of 19mm ply wood . The necessary locks , handles, etc to be provided . 3" x1/2 wooden skirting to be provided duly polished as per matching tone all along the visible areas . Inside of the unit shall be .75 mm thick laminate finish . All the exposed edeges of the boards/plywoods to be coverd with wooden lippings/mouldings duly polished all complete.All as per the design and instructions Bank.				
6.3	Main Electrical Panel Cabinet	Sq.Ft.	40.00		
	Providing and fixing of DB Shuttering formed of 12mm thk plywood wood on 12mm thick Gypsum board (fire Proof) with finsih as per Item no 1 for inside and out side shutters finished with laminate on outer surface with SS (4Nos) louvre perforation and necessary hardware,hinges etc complete as per details. All as per the design and instructions Bank. Only front face used for measurement only				
	TOTAL OF STORAGE & SIDE UNIT				
7	OTHER MISCELLANEOUS ITEMS				
7.1	PIN UP / NOTICE BOARD				
	Providing and fixing soft board with necessary framework with 12mm BWR plywood on top 12 jolly board to be fixed finished with fabric @Rs80 , with necessary mouldings duly polished along the periferi. All as per the design and instructions Bank.	Sq.Ft.	24.00		
7.4	WRITING LEDGER & Cheque & sugestion box	NO	1.00		
	Providing and fixing writing ledge as per design minium 5 ft length made out 19mm comm. board with necessary grove patterns with 1.0mm laminate. 10mm thk machine polished glass to be provided on top of the writing ledge. Small boxes to be made out of 12mm comm. ply to be made on top of the writing ledge finished with 1.0 mm laminate, inside surfaces shall be .75 mm thick laminate. and rate should be included providing fixing of sugestion box & Cheque deposit box as per approval of bank .The work to be completed as per design and approval of the architect.				
7.5	BOXING FOR ROLLING SHUTTER				
	WITH ACP FINISH	Sq.Ft.	150.00		

S.NO.	DESCRIPTION	UNIT	QTY.	RATE	AMT
	Providing and fixing boxing for the rolling shutters.l. Framing shall consist of Aluminium Sections of 50 mm x 25 mm @ 600mm C/C. Both ways horizontally and vertically on the wall / with Aluminium Sections of 2"x1" as directed by Bank / Architect. This framing would be covered by with 2mm thick "Aluminium Composite Panel". The rate shall inclusive of necessary fixtures and fittings, sealant etc. complete.				
	Note : rate shall include all necessary hardware fittings, etc.				
7.6	WOODEN COLUMN PANELLING	Sq.Ft.	50.00		
	Fabricating and fixing wall/column paneling, the framing shall made out of aluminium hollow section of 65mm x 37mm size 1.5mm thick of JINDAL / INDAL at spacing not exceeding 600mm bothways (horizontal and vertical). Paneling framework to be secured to wall surface/column surface.Paneling framework to be clad on one side with 9mm thick ply finished with 1.0mm thk laminate including skirting of 100mm high & 12mm x 12mm groove at skirting level. All as per the design and instructions Bank.				
7.7	ROLLING/ VERTICAL BLINDS	Sq.Ft.	35.00		
	Providing and fixing Roller blinds of approved design and shade by the Architect,incl all std fittings as per manufacturer's specification. The work to be completed as per specification and approval of the architect. (approved brand Vista, Hunter Dogulus)				
7.8	Customer Table - (4'-0" X 2'-6")	No	1		
	Providing and making a table of over all size of top as mentioned above. It shall consist of ¾" thk. Comm. Ply top as per design (double edge on outer edge with 1 1/2" thk half moulding on the edges) supported on ¾" thk. Comm. Ply verticals.supported on wooden base (as designed by the architect). Suitable wooden moulding as architect design with mellamine shall be provided to the edge of the top. All external surfaces to be finished in 1 mm laminate. & the Internal surfaces shall be .75 mm thick laminate.				
	TOTAL OF OTHER MISCELLANEOUS ITEMS				
	GRAND TOTAL FOR FURNISHING				
	* GST EXTRA AS APPLICABLE				

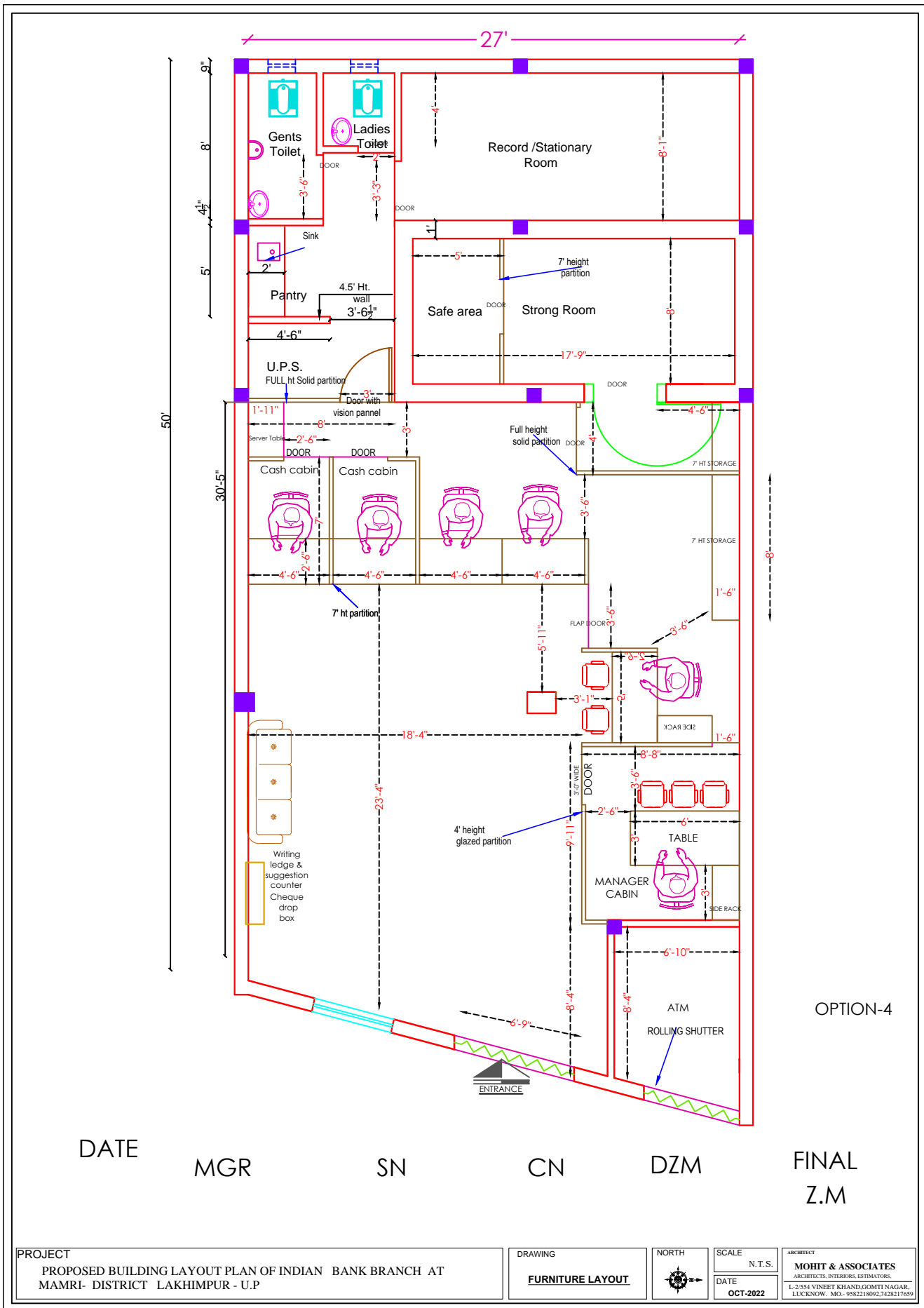

DATE

MGR

SN

CN

DZM

FINAL
Z.M

PROJECT
PROPOSED BUILDING LAYOUT PLAN OF INDIAN BANK BRANCH AT
MAMRI- DISTRICT LAKHIMPUR - U.P

DRAWING
FURNITURE LAYOUT



SCALE
N.T.S.
DATE
OCT-2022

ARCHITECT
MOHIT & ASSOCIATES
ARCHITECTS, INTERIORS, ESTIMATORS,
L-2554 VINEET KHAND, GOMTI NAGAR,
LUCKNOW, MO. - 9582218092, 7428217659