



PREMISES DEPARTMENT  
ZONAL OFFICE MIDNAPORE

**INVITATION OF QUOTATION  
INTERIOR FURNISHING, ELECTRICAL & DATA CABLING  
WORKS FOR RENOVATION OF EXISTING PREMISES OF  
INDIAN BANK KHARAGPUR IB BRANCH  
DISTRICT –WEST MIDNAPORE**

Ref No : ZOMID/PRMS/2023/K069/01  
Date : 28/06/2023

Issued to:

M/S. : .....  
ADDRESS : .....  
CONTACT : .....  
E-MAIL : .....

Last date of submission of QUOTATION	12/07/2023 upto 14:00 HRS at Indian Bank, Zonal Office, Premises Department, Near Old Water Tank, Station Road, Midnapore-721101
Date of QUOTATION opening	12/07/2023 at 16:00 HRS Indian Bank, Zonal Office, Premises Department, Near Old Water Tank, Station Road, Midnapore-721101

**CONSULTANT:**

M/s. BurmanEt.Al.  
Architecture .Interior. Engineering. QAQC  
164-B, Rash behari Avenue,  
Kolkata-700029.  
(M): 9874797597, 9811210589,  
Email: burmanetal2008@gmail.com.  
burmanetalkol@gmail.com.

## INDEX

<u>DESCRIPTION</u>	<u>PAGE NOS.</u>
NOTICE INVITING QUOTATION	3-4
FORM OF QUOTATION	5
GENERAL INFORMATION OF THE FIRM (ANNEXURE-1)	6 – 7
GENERAL TERMS AND CONDITIONS (ANNEXURE-2)	8 – 13
ARTICLES OF AGREEMENT	14 – 16
APPROVED LIST OF MATERIALS	17 – 18
SCHEDULE OF QUANTITIES	19 - 31
DRAWING	32



## INDIAN BANK ZONAL OFFICE - MIDNAPORE

### NOTICE INVITING QUOTATION

Indian Bank, Zonal Office Midnapore invites competitive sealed quotations in the prescribed format on item rate basis from experienced contractors empanelled in Interior Furnishing & Electrical Work with Indian Bank or in at least two Public Sector Banks for proposed Interior Furnishing, Electrical Works, and Data Cabling Works for renovation of existing Premises of KHARAGPUR IB Branch, situated at Malanchak Main road, Kharida, Kharagpur-721301.

The quotation documents may be downloaded from the Banks web site ([www.indianbank.in](http://www.indianbank.in)) under Tender Column or may be obtained from Premises & Expenditure Department, Zonal Office Midnapore, near old water tank, Station Road, Midnapore-721101, West Bengal, as per following schedule:

1	Name of work	Interior Furnishing, Electrical Work & Data Cabling Work for renovation of Premises of KHARAGPUR IB Branch situated at, KHARAGPUR
2	Estimated cost of work	Rs.6.19 Lakhs
3	Period of completion	20 days to be reckoned from 2 <sup>ND</sup> day from the date of issue of the Work Order or handing over of site whichever is later
4	Validity of Quotation	90 Days from the date of opening
5	Defects Liability Period	12 Months from the date of virtual completion of work
6	Retention Money (RM)	10% of the Bill Amount excluding Taxes The Retention Money will be refunded after 15 days of expiry of defect liability period.
7	Interim / Adhoc Payment	No Interim / Adhoc Payment will be paid
8	Payment terms	Payment will be made on satisfactory completion of the job on the basis of actual measurements. Income tax will be deducted as per the rules. Retention money of 10% will be deducted from the bill excluding taxes and to be released after 15 days of expiry of defect liability period (12 months from the date of virtual completion) provided no defects is observed during this period.
9	Documents to be attached with the Bill	Manager and Architect's Completion Certificate, Bills & Photographs showing completion status of work
10	Liquidated Damages	1% per week of the Contract Value subject to maximum total of 10% of final Contract value
11	Eligibility	<p>1. The firm must be empanelled with Indian Bank or in at least two Public Sector Banks for both Interior Furnishing &amp; Electrical Works (<b>Firms empanelled in only Interior Furnishing or Electrical Work only are not eligible</b>)</p> <p style="text-align: center;"><b>Empanelment letter must be enclosed</b></p> <p>2. Should have minimum 5 years' experience in similar type of</p>





		works (Proof to be attached)
12	Buy Back	OLD PLY, WIRE, ELECTRICAL INSTALLATION ETC
13	Quotation Documents	Quotation documents can be downloaded from the Bank's website (www.indianbank.in) under Tender Column or can be obtained from Indian Bank, Zonal Office, Premises & Expenditure Department, Near Old Water Tank, Station Road, Midnapore-721101 from 28.06.2023 to 12.07.2023 on all working days during office hours.
14	Last date of submission of Quotation	12.07.2023 upto 14:00 HRS at Indian Bank, Zonal Office, Premises Department, Near Old Water Tank, Station Road, Midnapore-721101
15	Date of opening Quotation	12.07.2023 at 16:00 HRS at Indian Bank, Zonal Office, Premises Department, Near Old Water Tank, Station Road, Midnapore-721101
16	Terms and conditions	As per part - B

**Note:**

1. The Bank will not be bound to accept the lowest quotation and reserves the right to accept or reject any or all the quotations without assigning any reason whatsoever. Late / delayed quotation shall not be accepted after due date and time of submission of quotation.
2. The rates quoted by the firm shall be based only on the specifications and conditions of the Schedule of Quantities (SOQ)
3. Bank is not liable to make any payment to the firm for preparation to submit the quotation.

The duly filled in offer completed in all respect **in sealed cover marked and super scribing "Interior Furnishing, Electrical, Air Conditioning Work and Data Cabling" Works etc. for ELECTRICAL AND FURNISHING WORK of existing Premises of KHARAGPUR IB Branch** on top and name, address, contact no. & e-mail id of the vendor at bottom left corner should be addressed to

**The Zonal Manager**  
**Indian Bank, Zonal Office: Midnapore, Near Old Water Tank, Station Road Midnapore-721101**  
**Dist- Paschim Midnapore, West Bengal**

**Date : 28/06/2023**  
**Place : Midnapore**

  
**(ZONAL MANAGER)**







### FORM OF QUOTATION

Indian Bank  
Zonal Office MIDNAPORE  
Premises Department  
Near Old Water Tank, Station Road  
MIDNAPORE – 721101

Dear Sir,

**SUB: Invitation of Quotation for Interior Furnishing, Electrical and Data Cabling Works for existing Premises of KHARAGPUR IB Branch at KHARAGPUR.**

Having examined the drawings, specifications, conditions and schedule of quantities prepared by you, and satisfying ourselves as to the location of the site and working conditions, I/We hereby offer to execute the above works at the respective rates which I/We have quoted for the items in the Schedule of Quantities.

I/We further agree to complete the work within the stipulated time as specified in the Quotation document.

I/We understand that Indian Bank is not bound to accept the lowest quotation and reserves the right to accept or reject any or all the quotation without assigning any reason whatsoever.

I/We understand that Indian bank may award the work to more than one contractor and I/We shall make no claims whatsoever if Indian bank accept only a part of my/ our quotation.

I/We unconditionally agree to Indian bank's conditions as stipulated in the quotation documents.

I/We agree to keep our quotation open for **90 (Ninety) days** from the date of opening of quotation.

I/We agree that incase of my/our failure to execute the work in accordance with the specifications and instructions received from Bank during the course of the work, Bank reserves the right to terminate my work order and recover all the dues to the Bank from the payment receivable by me. Further, I/We may also be barred from participating in any type of bid invited by Bank or its subsidiaries in future.

I/We further agree to complete the work within the stipulated time specified in the Appendix to General Conditions of Contract.

**I/We enclose the completed quotation document, Price Bid, Annexure-I & Annexure-II duly filled in and signed in each page.**

Thanking you,

Yours faithfully,

[To be signed by the Authorized Representative of  
QUOTATIONER who has the Power to do so]

Place:

Date :

Name:

Address:

Seal:



**ANNEXURE – I**

**GENERAL INFORMATION OF THE FIRM**

1	Name of Firm	
2	Head Office Address	
3	Address on which Correspondence should be done.	
	Tel. No.	
	Mobile no.	
	E-mail address	
4	Place of incorporation / registration	
5	Constitution of Firm	
i)	Specify, if the firm is	
	a) An individual	
	b) A proprietary firm	
	c) A firm in partnership	
	d) A Limited Company or Corporation	
ii)	Attach a copy of Proprietorship or Partnership Deed or Article of Association or Incorporation of Company as the case may be	
6	Give particulars of empanelment with Public Sector Banks	
7	Give particulars of Work Experience of minimum 5 years of similar type of work	
9.	Other details: a) PANNo. b) GST Registration No. (Copies to be enclosed)	
10.	Any other information considered necessary but not included above	
11.	Names and Titles of Directors and officers with designation to be concerned with this work with Designation of individuals authorized to act for the organization	
12.	Was the applicant ever required to suspend works for a period of more than six months continuously after commencement of works? If so, give the name of the	

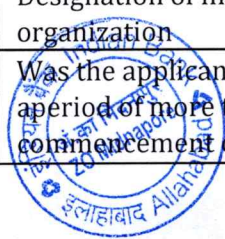



	project and give Reasons thereof.	
13.	Has the applicant or any constituent partner in case of partnership firm, ever abandoned the awarded work before its completion? If so, give the name of the project and give reasonsthereof.	
14.	Hastheapplicantoranyconstituentpartner in caseofpartnershipfirm, everbeendebarred/ black listed for tendering in any organization atany time? If so, givedetails	
15.	Has the applicant or any constituent partner in case of partnership firm, ever been convicted by a court oflaw?If So, give details	

**Note: Only self-attested copies to be furnished.**

**Date :**

**Signature & seal of the applicant**

**Place :**





**Annexure-II**  
**GENERAL TERMS AND CONDITIONS**

**1 Definition of terms / interpretation:**

- Employer/Owner/Bank /Indian Bank/ Accepting Authority shall mean Indian Bank with their Corporate Office at No. 254-260, Avvai Shanmugam Salai, Royapettah, Chennai – 600 014 inter-alia having their Zonal Office at Near Old Water Tank, Station Road MIDNAPORE – 721101 and any of its employees representative authorized on their behalf.
  - Throughout these submission of quotation documents, the terms “bid”, “quotation” and their derivatives (“bidder”/“quotation offerer/firm/contractor”), “bided / quotation submitted / “bidding”/“quotationing”, etc. are synonymous.
  - Day means calendar day. Singular also means plural
  - “Contractor” means the person who's Quotation has been accepted by the Employer and the legal successors in title to such person, but not (except with the consent of the Employer) any assignee of such person.
  - Quotation offerer : The term ‘Quotation offerer’ shall mean the individual or firm or company whether incorporated or not, undertaking the work and shall include legal representative(s) of such individuals or persons composing such firm or company or successors of such firm or company as the case may be and permitted assigns of such individual or firm or company.
2. Quotations which should always be placed in sealed cover, with the name of the work written on the envelope **“Interior Furnishing, Electrical and Data Cabling Works for renovation of existing Premises of KHARAGPUR IB Branch at Kharagpur”** will be received by Chief Manager (P&E), Indian Bank, Zonal Office , Premises Department, MIDNAPORE.
3. The Indian Bank does not bind itself to accept the lowest or any quotation and reserves to itself the right of accepting the whole or any part of the QUOTATION and the Quotation offerer shall be bound to perform the same at the rate quoted.
- a. The rate quoted by the Quotation offerer shall be net (excluding GST), up to the stage of incorporation and handing over site. All taxes including (excluding GST) or any other tax on material or on finished works like Turn-over Tax, including taxes that may be newly introduced subsequent to the quotation etc. in respect of this contract shall be payable by the Firm and the Indian Bank will not entertain any claim whatsoever in this respect.

***The rate quoted should be excluding GST.***

**The Quotation offerer who wishes to quote for the above job should have GST registration and should mention the registration number.** The firm shall give a list of his relatives working with the Indian Bank along with their designations and addresses.

4. No employee of the Indian Bank is allowed to work as a contractor for a period of two years of his retirement from Indian Bank service, without the previous permission of the Indian Bank. The contract is liable to be cancelled if either the contractor or any of his employees is found at any time to be such a person who had not obtained the permission of the Indian Bank as aforesaid before submission of the quotation or engagement in the Quotation offerer's service.
5. The quotation for works shall remain open for acceptance for a period of 90 days from the date of opening of quotation.
6. The Contractor shall sign each page of the quotation and quote their price in the Schedule of Quantities without any omission.
7. *The retention amount at 10% on the value of the bill paid will be held by the Indian Bank. The*



Retention Money (10%) will be released after 15 days of expiry of Defect Liability Period (12 Months from the date of completion of work), subject to satisfactory rectification of defects noticed, if any. Retention Amount held in our Bank's Book will not carry any interest.

8. The acceptance of a quotation will rest with the Indian Bank and the Indian Bank reserves to itself the authority to reject any or all of the Quotations received without the assignment of a reason. Quotations in which any of the prescribed conditions are not fulfilled (or) are incomplete in any respect are liable to be rejected. The Indian Bank reserves the right to accept the quotation in full or in part and the firm shall have no claim for revision of rates or other conditions if his quotation is accepted in parts.
9. Canvassing in connection with quotations is strictly prohibited and the Quotations submitted by the contractors/firms who resort to canvassing will be liable to rejection.
10. All rates shall be quoted on the proper form of the quotation alone. **All the entries to be made legibly in ink only.** Rates written in pencil or any other mode shall not be considered for evaluation and will be rejected.
11. An item rate quotation containing percentage below / above will be summarily rejected. However, where a contractor/firm voluntarily offers a rebate for payment along with sealed quotation, the same may be considered.
12. On acceptance of the work order the name of the accredited representative(s) of the Quotation offerer who would be responsible for taking instructions from the Indian Bank shall be communicated to the Indian Bank.
13. Special care should be taken to write the rates in figures as well as in words and the amounts in figures only, in such a way that interpolation is not possible. The total amount should be written both in words and in figures.
14. The Contractor shall comply with and give all notices required under any law, rules, regulations, or bye-law of Parliament, State Legislature or Local Authority relating to works. If needed, the Contractor has to obtain required permission/ approval from the building secretary/ association. The Contractor shall before commencing the execution of work issue a certificate to the Employer that he has obtained all the permissions Registrations and give all the notices as are required to be obtained or given under law particularly blasting permission, Police permission etc.
15. The Contractor shall be required to maintain the site and the building areas in a neat and clean condition at all times to the satisfaction of the Employer. The Contractor shall especially take care to keep areas free from getting water logged, from concrete/mortar dippings, bricks, steel, shuttering materials or any other material / rubbish.
16. Debris and items removed from the building have to be neatly stacked at site and then periodically removed (maximum of one week), carried away by the Contractor and disposed off as per the rules and regulations of the Local Authorities concerned. No debris shall be thrown loose from upper floors. No floor, roof or other part of the building shall be over-loaded with debris or materials as to render it unsafe.
17. Employer reserves the right to insist on selection of material, workmanship, detailing and finishes, which they consider, is appropriate, and suitable for the intended use. The contractor is not eligible to claim extra on this account.
18. Employer will require the contractor to produce, samples of all the materials, accessories/ finishes prior to procurement/ manufacture. The samples of the materials for the work shall be got approved from the Employer. Failure to comply with these instructions can result in rejection of the work/materials.
19. For painting & Lamination, sample area shall be prepared and the shade got approved. It is also advised to give computer presentation of various colour schemes to the employer before going for sample painting/Lamination,
20. The Contractor should note that he should execute his part of work without causing any damage to





any component of the building and also without disturbing the occupants. Any damage so caused shall be made good at the cost & risk of the Contractor.

21. The successful contractor shall include, in the quoted price, all allied civil works such as chasing in wall, drilling holes etc to support the frames, partitions, make the surface good after grouting, scaffolding required if any to load/ unload the materials etc.
22. The successful contractor shall also be responsible for the safety and security of all their materials and also for ensuring fire prevention steps at all times in the working premises including their part of the work. The successful contractor has to place full time representative at site, the representative should have thorough subject knowledge.
23. The work shall be carried out without disturbing the NEW occupants of other offices. Necessary barricading of the area, if required from the rest of the area shall have to be arranged by the successful contractor at no extra cost. The work is to be organized and executed so as to have least disturbance to the occupants of other offices.
24. No interim payment / Adhoc Payment will be entertained in any case

**25. The contractor should ensure payment of minimum wages + VDA to all labourers / workmen staff employed by him in line with central/ state labour wage act whichever higher.**

The Contractor shall at all times indemnify and keep indemnified the Employer against all losses, claims, damages or compensation including under the provisions of the payment of the Wages Act 1936, Minimum Wages Act 1948, Employer's Liability Act 1938, Workman's Compensation Act 1923, the Maternity Benefit Act 1961, the Bombay Shops and Establishments Act 1947, Industrial Disputes Act 1947, and Contract Labour (Regulation and Abolition) Act 1970 and Employees State Insurance Act 1948, Motor Vehicles Act 1988 or any modifications thereof or under any other law relating thereto and rules made thereunder from time to time or as a consequence of any accident or injury to any workman or other person in or about the work whether in the employment of the Employer or Contractor or not, and also against all costs, charges and expenses of any suit, action or proceedings whatsoever out of such accident or injury or combination of any such claims.

26. From commencement to completion of works, the Contractor shall take full responsibility for the care of the work and for taking precautions to prevent loss or damage to the work to the maximum extent possible and shall be liable for any damage or loss that may arise to the works or any part thereof from any cause whatsoever including causes of fire, lightning, explosion, earthquake, storm, hurricane, floods, inundation, subsidence, landslides, rock slides, riots (excluding civil war, rebellion, revolution and insurrection) or any latent defect or damage and shall at his own cost repair and make good the same so that at all times the work shall be in good order and condition and in conformity in every respect with the requirements of the Contract.

For the purpose of this condition this expression "from commencement to completion of works" shall mean the period starting with the date of issue of Work Order or date of handing over of site whichever is later and ending with issue of Virtual Completion Certificate.

Without limiting the obligations and responsibilities under this condition, the Contractor shall insure and keep insured the works from commencement to completion, as aforesaid, for the full contract value including Price Variation Adjustment if any against the risk of loss or damage from any cause whatsoever including the causes enumerated in the foregoing paragraphs. In the event of there being a variation in the nature and extent of the works, the Contractor shall from time to time increase or decrease the value of the insurance correspondingly. All the premium for the insurance shall be borne and paid by the Contractor.

Before commencing the work, the Contractor shall without limiting his obligations and responsibilities under this condition, insure against any loss of life or injury to any personnel in the employment of Contractor / Sub-Contractor/nominated Sub- Contractor. For this purpose, an insurance shall be taken by the Contractor /Sub- Contractor. Such an insurance shall be taken to include both employees/workmen covered by the Workman's Compensation Act 1923, as well those employees/workmen not covered by the said Act. Separate insurance policies may be taken for employees/ workmen covered by Workman's Compensation Act 1923, and employees / workmen not covered by the said Act. All the premium shall be paid by the Contractor. Policy/Policies taken





under this para for the personnel in employment with the Contractor / Sub-Contractor may be in their Employer's names of the Contractor / Sub-Contractor / nominated Sub-Contractors. In the event of any loss or injury to personnel in employment with the Contractor / Sub-Contractor / nominated Sub-Contractors, the Employer and Contractor shall recover directly from the Insurance Company and ensure that payment of the same is made to the affected parties including the Employer. The policy in original shall be deposited with the Employer.

The Contractor shall at all times indemnify and keep indemnified the Employer against all losses and claims for injuries or damage to any person or any property whatsoever which may arise out of or in consequence of the construction and maintenance of the work and against all claims, demands, proceedings, damages, costs, charges and expenses whatsoever in respect of or in relation thereto. Before commencing the execution of the works, the Contractor shall without in any way limiting his obligations and liabilities under this condition, insure at his cost and expense against any damage or loss or injury which may be caused to any person or property including the employees and directors of the Employer and their property by or in the course of the execution of the works.

27. The Contractor shall take all precautionary measures to ensure the safety of the workmen employed by it. The contractor shall be fully responsible for the any injury or damage caused to the workmen deployed by him at site for carrying out the work and Bank has nothing to do with such happenings and in no way shall be held responsible for the same.
28. The contractor shall maintain all registers as required by the Regional Labour Commissioner and should furnish the same to the Bank or its representative as and when required.
29. If the work is not started within 7 days from the date of issue of work order then Employer may terminate the work order without assigning any reason. If during the execution of the work, the progress of work is not considered to be satisfactory and is not consistent to be in contingent with the period of the completion of the work then the Bank may terminate the work order by giving a 5 days notice to the contractor. In such case the contractor shall be liable to pay the employer any extra cost involved for the completion of the said work and will not obstruct any way in completing the work through other agency. After completion of entire work the contractor shall be paid for the actual work executed by him at the quoted rates after deducting any claims, damages.
30. The time allowed for completing the works is 20 days to be reckoned from 2<sup>nd</sup> day from the date of Work Order / date of handing over site whichever is later.
31. If the Contractor fails to complete any or all the works by the date/s named in **Clause 32** (Date of Completion) or within any extended time (permitted by Bank) then the Contractor shall pay or allow the Employer the sum to be worked out at **1.0%** of contract value per week to be recovered as Liquidated Damages (and not by way of penalty) for the delay, beyond the said date or extended time, as the case may be, during which the works shall remain unfinished and such damages may be deducted from any moneys due or which may become due to the Contractor. The maximum amount of Liquidated damages shall be **10%** of contract value. The contractor shall be bound to extend validity of Insurance Cover till such period of completion as may be considered necessary at their cost.
32. Extension of time: If in the opinion of the Employer/ Architects the works be delayed (a) by reason of any exceptionally inclement weather or (b) by reason of instructions from the employer in consequence of proceedings taken or threatened by or disputes, with adjoining or neighboring owners or (c) by the works, or delay of other contractors nominated by the employer and not referred to in the specification or (d) by the reason of authorized extra and additions or (e) by reason or any combination or works men or strikes or lock-out affecting any of the building trade or (f) from other causes which the employer may consider are beyond the control of the contractor, the employer at the completion of the time allowed for the contract shall make fair and reasonable extension of time for completion in respect therefore. In the event of the employer failing to give possession of the site upon the day specified above, the time of completion shall be extended suitably.  
In case of such strikes or lockouts as are referred to above, the contractor shall, immediately give the employer, written notice thereof. Nevertheless he shall use his best endeavors to prevent delay, and shall do all that may be reasonably required, to the satisfaction of the employer for any extension of time for completion hereunder (which shall be final and binding on the contractor) shall





be promulgated at the conclusion of such strike or lock-out and the employer shall then, in the event of an extension being, granted, determine, and declare the final completion date.

33. The successful contractor shall be required to execute an Agreement in the proforma attached with this quotation document within 7 days from the date of receipt of the notice of acceptance of quotation. In the event of failure on the part of the successful contractor to sign the agreement within the above stipulated period the acceptance of the quotation shall be considered as cancelled.
34. The final bill will be released on satisfactory completion of the entire work and on completion of all the terms and conditions / obligations spelt out and on proper submission of the bill together with the measurements. Final Bill settlement is within 30 days from the date of proper submission of bill & measurements.
35. The Quotation offerer shall separately specify at the end of the QUOTATION the % and value of SGST and CGST as applicable. As on date 9 % CGST and 9% SGST IS APPLICABLE FOR WORKS CONTRACT. Regarding tax part, the tax rate at the time of billing shall rule over and above all documentations. Valid documents shall be produced if asked for at the time before payment. TDS for income tax is as applicable and shall be included in the quoted rates. The comparison for the least bidder shall be made with the basic price of items of work excluding "Goods and Service Tax" part.
36. At any stage i.e. during the execution of work, any kind of change required, whether it is in design or specification, the contractor must inform the concerned Department of the Bank or Architect and after getting the approval, the same has to be incorporated by the contractor.
37. Single Power point & Water for work will be provide by bank at free of cost
38. The contractor shall not directly or indirectly sublet the work to other party without written permission of the bank.
39. The Bank reserves the right to distribute the work for which quotations have been called, among more than one parties, if found necessary. No claim in this respect shall be considered and the contractor agrees to cooperate with other agencies appointed by the Bank.
40. Bank shall not be responsible for any loss or damage to the contractor/ labour due to any natural calamity during the course of construction. Contractor is liable to make good all the damages if any, till the work is completed and handed over to the Bank authorities
41. No advance payment shall be made to the contractor on supply of any material supplied at site for execution; Payment shall be made only after completion of the work, submission of proper bills and measurement and checking at the site by Architect and Bank' Engineer.
42. Contractor agencies are advised (before quoting the rates) to inspect the site of the proposed work and the site from where items are to be buy backed. They must go through specifications and documents. Any clarification, if required, may be taken from the bank before submitting the quote.
43. The quantities mentioned in schedule are provisional and likely to increase /decrease to any extent or maybe omitted thus altering the aggregate value of the contract. No claim for loss of profit/business shall be entertained on this account.
44. The rates quoted by the Contractor shall be firm throughout the work period (including extension of time, if granted) and will not be subject to any fluctuation due to variation in the cost of material or labour.
45. The contractor /vendor failed to carry out the works as per schedule/Quality, the same shall be carry out with different agencies and the actual amount will be deducted from the contractor bills.
46. Payment to the contractor shall be made as per actual work done on site.
47. The contractor agency shall keep particular vigil on his workers to maintain very good workmanship of all items, failing which no payment shall be made and no claim of material/labour used shall be made to him in any case, and the same work shall be executed by him again without charging any extra cost.
48. The Bank reserves the right to accept/reject any quotes without assigning any reasons thereof.
49. Any work got executed in poor workmanship as pointed out by the Bank Official will have to be dismantled and redone by the Contractor on his own cost.
50. Any addition, alteration or correction in the quote shall be signed and stamped properly by the contractor







**DECLARATION :**

I / We hereby declare that I / We read and understood the above terms and conditions and that we shall abide by them if the work is awarded to us.

Signature & Seal of the Contractor



## ARTICLES OF AGREEMENT

**THIS AGREEMENT** is made on this ..... day of ..... month of ..... between Indian Bank and having its Zonal Office at Near Old Water Tank, Station Road MIDNAPORE – 721101 (hereinafter referred to as the “Employer”) which expression shall include its successor, legal heirs and assignees of the one part.

**AND** M/s. .... having its office at

..... (herein after referred to as the “Contractor”) which expression shall include its successor, legal heirs and assignees of the second part.

**WHEREAS** the Employer has caused drawings and quotation documents for “Interior Furnishing, Electrical, Air Conditioning Works and Data Cabling Works for renovation of NEW Premises of KHARAGPUR IB Branch and ATM at KHARAGPUR IB

**AND** whereas the Employer has called for quotation vide ref. no. .... dated.....

**AND** whereas the contractor has submitted the quotation ref. no. .... dated ..... to the Employer on .....

**AND** whereas the Employer has issued the work order ref ..... dated..... to the contractor to do the work.

**AND** whereas the Contractor has agreed to execute the work as per drawings, specifications, conditions of contract and Work Order.

**AND** whereas the Employer has accepted the Contractor's quotation as aforesaid and whereas the QUOTATION submitted by the contractor has been accepted for such sum as may be ascertained to be payable in terms of the Bill of Quantities and which sum is estimated to be Rs. .... (Rupees ..... ) herein after referred to as the said “Contract Agreement”.

### **NOW THIS AGREEMENT WITNESSETH AS FOLLOWS:-**

- 1) In consideration of the said Contract Sum to be paid at the times and in the manner set forth in the said Conditions the Contractor shall carry out and complete the Works in terms and conditions herein contained and according to the general conditions of the contract, notice inviting QUOTATION, special conditions of contract, general scope of work, technical specifications, schedule of rates and instructions to be given by and the supervision of and to the entire satisfaction of the Employer.

#### **2) Contract Price, Taxes and Payment Terms :**

Total contract price is Rs. .... which is inclusive of cost of materials, equipment, installation charges and tools and tackles required for execution of the job. Above price is inclusive of all taxes & duties including excise duty, GST, income tax, octroi etc. in respect of this





contract. No claim in this respect will be entertained. Income tax on payments will be deducted and deposited by Employer in accordance with the sales tax law of the state and the provisions of tax deductions at source under income tax act 1961.

**3) Completion Period:**

**Time is the essence of the Contract.** The work is to be completed in all respects within 20 days reckoned from 2<sup>ND</sup> day from the date of issue of the Work Order or handing over of site whichever is later. If the Contractor fails to complete the job within the agreed time period the Contractor will have to bear liquidated damages as per the relevant clause mentioned in the QUOTATION Documents.

**2) Inspection of Site:**

The Contractor has inspected the site before submitting his quotation and has satisfied himself as to the nature of the work to be executed on the site. Any difficulties which the Contractor may come across in the course of the work shall in no way relieve the contractor to claim or receive extra payment unless the Employer is of the opinion that such difficulties could not have been foreseen and the Employer consents in writing.

**3) Supply of Material and Labour:**

The Contractor shall arrange all labour, materials, equipments, tools, tackles and everything necessary for the completion of the work. The Contractor will assume all responsibility for the safety, protection and accounting of all material and equipment and the work during construction. All materials used by the Contractor shall be of the best quality conforming to the required specification mentioned in the QUOTATION document and will be subject to the approval of the Employer. All such materials not approved by the Employer shall be removed at once by the Contractor at his own expense. The Contractor shall also at his own expense arrange for carrying out any test of materials which the Employer may from time to time require or if so desired by the employer.

**4) Defective Work / Materials:**

If any part of the work done by the Contractor is found defective in workmanship or if bad or inferior materials have been used the Contractor shall at his own risk and cost demolish all such defective work and rebuild the same and / or replace the bad or inferior materials used within a time frame mentioned to the satisfaction of the Employer. The decision of the Employer in this regard shall be final and binding on the Contractor. In case of default of the contractor to remove the defective work and rebuild the same or replace bad or inferior materials as directed by the Employer, the Employer shall be entitled to employ anyone else to carry out the same at risk and cost of the Contractor and recover all expenses incurred in this regard from the contractor.

**5) Inspection of Work:**

During progress of the work the Employer shall be entitled at all times to have access to and inspect the work.

**6) Supervision:**

The Contractor shall provide one or more competent and technical qualified engineers duly and fully authorized to act on his behalf in all matters relating to the works to be carried out under or any other matter concerning this agreement and who shall at all times be present at the works while any work is in progress as per directions, explanations & instructions of Employer.





7) **Compliance with Statutory Regulations & Work Rules:**

The Contractor shall be responsible for complying with the applicable laws / bye laws / Regulations in force from time to time and shall have to bear all statutory liabilities to the workers / personnel engaged for the job. Nothing will be paid extra in this regard. If any amount is paid by the Employer with this regard the same amount shall be deducted from the Contractor's dues. The Contractor shall have to arrange insurance cover for the workers / personnel engaged by him for the job.

8) **Determination of Contract:**

In the event of Contractor failing to keep / adhere to agreed schedule of work, or in the event of the Contractor failing to comply with the provisions of this contract by default and / or negligence and / or suspension of work or in the event of Contractor failing to complete the work within the stipulated period, the Employer may terminate this Agreement forthwith and employ, at the Contractor's risk and cost, another contractor or sufficient number of workmen to complete the work.

9) **Force Majeure:**

This clause will be operative only if the work is delayed by

- a) Acts of God
- b) Earthquake or floods or similar natural calamities.
- c) Serious loss or damage by fire or lightning.

In case any Force Majeure condition herein mentioned occurs and continues for a period exceeding 15 days the parties hereto undertake to sit together and devise ways for expeditious and proper performance of the obligations of the parties under this order.

10) **Arbitration:**

" In the event of any dispute or difference relating to interpretation and application of provisions of the contract and all disputes/ claims whatsoever which shall either during the continuance of the contract or afterwards either between the parties to the contract or the respective representatives touching the construction/ application of any provision/ clause mentioned in the contract or any account or liability between the parties to the contract or as to any act or deed or omission of any party to the contract, in any way relating to these presents, shall be first at the discretion of the Bank attempted to be resolved in good faith by mutual discussion within 30 days of the dispute or question being raised failing which the same shall be settled by arbitration in accordance with provisions of Indian arbitration and Conciliation act 1996.

The Parties concerned shall designate an arbitrator on mutual consent/ consensus. The venue of the arbitration shall be exclusively at MIDNAPORE and any award passed by arbitrator shall be final, conclusive and binding upon the parties and shall be deemed to have been made between parties themselves. The parties to the dispute shall share equally the cost of arbitration as intimated by the arbitrator".

**IN WITNESS** whereof the said contracting parties have set their hands and seals on the day and year first hereinabove witness.

Witness Address

Employer

Witness Address

Contractor





**LIST OF APPROVED MATERIALS FOR FURNISHING WORK AT INDIAN BANK, KHARAGPUR IB BRANCH**

SL NO	ITEM	APPROVED MAKE/ MODEL
1	False Ceiling	INDIA GYPSUM CEILING, SAINT GOBAIN, LAFARGE
2	Inter mediate Channel/Ceiling Section	GYPSTEEL, DIAMOND FRAME
3	Wood Frame Work/ Wood Section All wood must be well seasoned, free from knots, other defects, decay and defects due to handling and transportation. Wherever necessary, provide with anti - termite Treatment.	2 <sup>ND</sup> CLASS TEAK WOOD
4	Wood Skirting / Moulding/ Lipping/ Bidding / Door frame	WHITE BEACH / WHITE CEADER
5	Modular furniture	GODREJ/DECOR X/SPACE WOOD/METHODEX
6	Modular Toilet	MARINO, GREEN
7	Fire Reterdent Paint	INDUSTRIAL GRADE OF NOBLE / VIPER
8	Plywood/ Block board (BWR GRADE)	CENTURY/SHATABDI/ ARCHIDPLY/GREEN PLY
9	Flush Door	CENTURY/GLOBE / ARCHIDPLY/GREEN PLY
10	Laminate (1.0mm thk.)	ADVANCE LAM/MERINO, GREEN LAM/CENTURY
11	Door Closure	GODREJ/ ARCHI (HEAVY DUTY)/DORMA
12	Floor Spring :	GODREJ/ ARCHI (HEAVY DUTY)/DORMA
13	Floor Spring :	GODREJ/ ARCHI (HEAVY DUTY)/DORMA
14	Door Lock/ Door Handles	GODREJ CYLINDRICAL / HAFELE/ HETTICH /DORSET
15	Drawer/ Storage Handle	NEKI / HASSLEY
16	Drawer/ Storage Lock	EBCO / HAFEL / HETTICH DOOSET/GODREJ
17	Screws	GKW / NETTLE FOLD / APPROVED EQUIVALENT
18	Hinges	DORSET/GORG/EBCO
19	Sliding Drawer Channels	EARL BEHARI (EBCO) / CIEF/ HETTICH
20	Adhesive	FEVICOL SH / FEVIMATE TL/ARALDITE
21	Soft board	JOLLY BOARD / APPROVED EQUIVALENT
22	Vertical Blinds	MAC / ANNUMS / WINDOW FASHION/VISTA
23	Aluminium Sections	HINDALCO/JINDAL/NELCO
24	Glass	MODIGUARD / SAINT GOBAIN
25	Readymade Keyboard / CPU Trolley ( metal )	EBCO / DORTEL
26	Paints ( Enamel / Acrylic Emulsion)	ASIAN PAINTS (AS PER BANK APPROVED COLOR)/BERGER
27	Mirror	MODIGUARD / SAINT GOBAIN
28	Wood Preservatives	STP PENTAPHENE PALE / CHLORIPHYROPHOSH
29	Laminates	CENTURY PLY/ SUNMICA/ FORMICA/ GREENLAM
30	All other items not covered above	AS PER SAMPLE APPROVED BY EMPLOYER

**Note -**

- Materials mentioned in the specification shall be used for the work. If specified material is not available prior approval of the Employer shall be taken to use other brands.
- Preference of makes, supply of items should be consulted with client/consultant before effecting of supply.

**NAME AND ADDRESS OF THE CONTRACTOR:**

**SIGN & SEAL OF THE CONTRACTOR:**

**Date:**

**Place:**





**LIST OF APPROVED MATERIALS FOR ELECTRICAL WORK AT INDIAN BANK, KHARAGPUR IB BR**

SL NO	ITEM	APPROVED MAKE
1	MS pipe ISI mark. 16 SWG	BEC / NIC
2	MS pipe ISI mark. 16 SWG	BEC / NIC
3	M.S. fittings (Bend / Elbow / G.I Saddle / 3way circular box)	BEC / NIC
4	PVC Copper Wires insulated HR-FR-LSH-LF (Heat Resistant Flame Resistant Retardant Low Smoke halogen-Lead Free – To be ROHS Compliant	FINOLEX / HAVELL'S/POLYCAB
5	A.C. Starter	NORTH-WEST / CRABTREE/ MDS LEGRAND
6	250 Volt 6/16 Amp. 3 pin modular type switch,socket	MDS LEGRAND / CRABTREE / ABB/ ANCHOR ROMA
7	Capacitor	L&T / HAVELL'S
8	Current Transformer	KAPPA / L&T/ SCHNEIDER (CG) A.E
9	Changeover Switch	L&T / HPL / GEC / HAVELL'S
10	Amps meter & Voltmeter 96x96 mm (Analog)	AE / L&T / ALSTOM / HPL / HAVELL'S
11	Miniature Circuit Breaker & MCB Distribution Boards,RCBO	ABB / L&T(HAGER) / SCHNEIDER(CG)/SIEMENS/ HAVELL'S
12	Armoured Cable	NICCO / FORT GLOSTER / HAVELL'S / CCI
13	Telephone Socket RJ – 11	CRABTREE / ABB / MDS LEGRAND
14	Telephone Cable (0.51mmsq) 10/20 pair	NATIONAL / DELTON / NETCO / FINOLEX / RETCO
15	Lugs	DOWELLS
16	Light Fittings/ Fixtures	HAVELLS /PHILIPS/CROMPTON
17	Terminal Connector	HAVELLS
18	Exhaust Fan	HAVELS / CROMPTON
19	Wall mounted ( Osylating Type) / Pedestal Fan	HALVELS/ CROMPTON / KHAITAN/USHA
20	SFU / SPN / TPN S.M. housing / Open execution front handle with housing	L&T / SIEMENS / HAVELL'S
21	Telephone Connector	KORN TYPE
22	Selector switch (Rotary type)	KAYCEE / A.E / L&T/ SIEMENS
23	Rigid PVC conduit	B.E.C., KALINGA, AKG
24	Clock switch/time switch	L&T
25	Join box 6"x4" MS box heavy type	LOCAL MAKE
26	Bearer Call Bell	ANCHOR/MAX/ROMA
27	Brass Cable gland	ARUN(HEAVY TYPE) / DOWELLS
28	LED Indicator ( bright type)	MIKADOV / L&T / MDS
29	MCCB	SIEMENS / L& T / HAVELL'S
30	Metal Clad socket & plug having scraping earth arrangement	SIEMENS / L&T / SCHNEIDER
31	All other items not covered above	AS PER SAMPLE APPROVED BY EMPLOYER
32	SPLIT AIR CONDITION UNIT	CAREER/HITACHI/LG/DAIKIN/VOLTAS/ BLUESTAR

Note –

1. Materials mentioned in the specification shall be used for the work. If specified material is not available prior approval of the Employer shall be taken to use other brands.
2. Preference of makes, supply of items should be consulted with client/consultant before effecting of supply.

**NAME AND ADDRESS OF THE CONTRACTOR:**

**SIGN & SEAL OF THE CONTRACTOR:**

**Date:**

**Place:**





BUDGETARY ESTIMATION OF FURNISHING JOB FOR KHARAGPUR IB BRANCH, INDIAN BANK					
SR.N O.	DESCRIPTION	QTY	UNI T	RATE	AMOU NT
<b>I</b>	<b>POP &amp; FALSE CEILING WORKS</b>				
a	<b>False Ceiling</b>				
	Gypsum board Ceiling - 12.5mm th. single layer gypsum board fixed on suspended main G.I.channels 60 mmx 36 mm and secondary grid made of 45 mmX 18 mm all as per manufacturers' specifications, including jointing, finishing with gypsum compound, jointing tape and top coat. The surface shall be duly sanded and finished. Rate shall include making all the necessary cutouts for lights, grills,diffusers etc. The rate shall also include providing perimeter channel for grills, lights, diffusers as called for in HVAC and Electrical Drawings.The rate shall also include providing for edge/ angle bits at all corners,drop, necessary taping, filling with jointing compound as per manufacturers specifications. The rate shall be exclusive of trap door which shall be paid for separately. <b>Cost to be quoted Including painting.</b>	1,050.00	Sq.ft		
b	Modular false ceiling made of mineral fibre boards of average size of 24"x24" with Aluminium powder coated framework. (make Armstrong or equivalent. Type - Fine fissured)	200.00	Sq.ft		
<b>II</b>	<b>CARPENTRY AND INTERIOR WORKS</b>				
<b>1</b>	<b>PARTITION WORKS</b>				
a	<b>SOLID PARTITIONS WITH DOOR (upto 8'6"-9'0")</b>				
i	Providing & fixing 3" thick solid partition for made up of 18 gauge 50x50 mm Aluminium section framework at 600 mm c/c both ways (or as directed by the Architect); 12 mm commercial plywood & 1 mm laminate from both sides. Partition should be finished with specified finish as per design. The rate includes providing 35 mm thick flush door with necessary lipping patti polished. Rate includes all necessary hardware ( i.e ball bearing hinges of approved make, door closure, Cylindrical Lock with key, Door stopper etc) Exposed edges of the partition should have 75x12 mm matching wood Patti with groove in between. All provisions to be made for all electrical, networking, telephone etc. boxes onto partition framework at required heights/levels with necessary additional supports &/or scaffolding as required. The rate includes all necessary hardware & cleaning of partition to the satisfaction of the Architect etc. complete.	162.00	Sq.ft		







ii	<b>SOLID PARTITION WITH DOOR-LAMINATED/PAINTED:</b> Providing & fixing 3" thick solid partition for made up of 18 gauge 50x50 mm Aluminium section framework at 600 mm c/c both ways (or as directed by the Architect); 12 mm commercial plywood & 1 mm laminate from both sides. Partition should be finished with specified finish as per design. The rate includes providing 35 mm thick flush door with necessary lipping patti polished. Rate includes all necessary hardware ( i.e ball bearing hinges of approved make, door closure, Cylindrical Lock with key, Door stopper etc) Exposed edges of the partition should have 75x12 mm matching wood Patti with groove in between. All provisions to be made for all electrical, networking, telephone etc. boxes onto partition framework at required heights/levels with necessary additional supports &/or scaffolding as required. The rate includes all necessary hardware & cleaning of partition to the satisfaction of the Architect etc. complete	-	Sq.ft		
iii	<b>SOLID PARTITION - PAINTED:</b> Same as item 1.a-(i) but partiton framework to be covered with both side gypsum board of 12.5mm thickness finished with 3 coats of luster paint of approved shade. Wooden framework of size 50mm x 50mm fixed @450mm c/c bothways				
iv	Same as item 1.a-(i) but with Aluminium framework of 18 gauge of size 50 mm x 38mm. Cost to include wooden inserts of salwood at the door opening for fixing of floor spring pivot etc.				
v	Partition framework with out finish above false ceiling area. Wooden framework of size 50mm x 50mm fixed @450mm c/c bothways				
<b>b</b>	<b>GLAZED PARTITIONS</b>				
i	<b>FULLY /SEMI GLAZED PARTITIONS:</b> Providing & fixing 3" thick partly glazed partition with 10mm thick clear float glass for made up of 18 gauge 50x50 mm Aluminium section framework at 600 mm c/c both ways (or as directed by the Architect); 12 mm commercial plywood & 1 mm laminate from both sides. Partition should be finished with specified finish as per design. The rate includes providing 35 mm thick flush door finished with 1mm laminate of approved make/shade on both sides with necessary lipping patti polished. Rate includes all necessary hardware ( i.e ball bearing hinges of approved make, door closure, Cylindrical Lock with key, Door stopper etc) Exposed edges of the partition should have 75x12 mm matching wood Patti with groove in between. All provisions to be made for all electrical, networking, telephone etc. boxes onto partition framework at required heights/levels with necessary additional supports &/or scaffolding as required. The rate includes all necessary hardware & cleaning of partition to the satisfaction of the Architect etc. complete Basic rate of 12mm thick ply: ----- Rs /sft. Basic rate of Laminate; ----- Rs/sft	383.00	Sq.ft		







ii	<p><b>MAIN FIXED GLAZING with DOOR:</b> Providing &amp; fixing main door &amp; partition made up of 12 mm thk. Clear toughened glass shall be fixed in.Ozon / Enox make patch fitting with necessary hardware.With application of sealant from all sides. Edge polish for all exposed sides of glass. Complete as per design</p> <p>Door size 7'0" x 3'0" - Providing &amp; fixing main door made up of 12 mm thk. Clear toughen glass shall be fixed in.Ozon / Enox make patch fitting with necessary hardware like floor spring, 12" S.S. finished decorative handle pair,&amp; locking arrangement. Edge polish for all exposed sides of glass. Complete as per design</p>	72.00	Sq.ft		
iii	<p><b>SEMI-GLAZED PARTITIONS:</b> Providing &amp; fixing 3" thick partly glazed partition with 8mm thick clear float glass for made up of 18 gauge 50x50 mm Aluminium section framework at 600 mm c/c both ways (or as directed by the Architect); 12 mm commercial plywood &amp; 1 mm laminate from both sides. Partition should be finished with specified finish as per design. The rate includes providing 35 mm thick flush door finished with 1mm laminate of approved make/shade on both sides with necessary lipping patti polished. Rate includes all necessary hardware ( i.e ball bearing hinges of approved make, door closure, Cylindrical Lock with key, Door stopper etc) Exposed edges of the partition should have 75x12 mm matching wood Patti with groove in between. All provisions to be made for all electrical, networking, telephone etc. boxes onto partition framework at required heights/levels with necessary additional supports &amp;/or scaffolding as required. The rate includes all necessary hardware &amp; cleaning of partition to the satisfaction of the Architect etc. complete Basic rate of 12mm thick ply: ----- Rs /sft. Basic rate of Laminate; ----- Rs/sft</p>	56.00	Sq.ft		
iv	<p><b>SEMI-GLAZED LOW HEIGHT PARTITIONS:</b>Providing and fixing low height partition up to 5'height made out of 50 mm*50mm 18mm Gauge aluminium frames at 2' C/C vertically &amp; horizontally with 6mm thick commercial plywood on both sides upto 3' height and above portion with 10mm toughened glass Finished with 1.00 thick laminate of approved shade and design. Basic rate of 6mm thick ply: ----- Rs /sft. Basic rate of Laminate; ----- Rs/sft</p>	-	Sq.ft		
2	<b>BOXING FOR ROLLING SHUTTER AND EXTERNAL CLADDING</b>				
a	<p>P/f BOXING FOR ROLLING SHUTTER up to 450mm wide x 450mm high with open able panels for accessing rolling shutter made of wooden internal framework and 12mm thk marine ply finished with 1.0mm thk laminate of <b>approved shade</b> on all exposed surfaces including boxing top.Openable panel for acceing the rolling shutter to be provided. Rate to include cutouts for lights, necessary hardware, etc, all complete.</p>	1.00	LS		





b	P/f BOXING FOR ROLLING SHUTTER in Aluminium Composite Panel (ACP) with framing of Aluminium Tube sections of min 1.5" x 1" and 20 gauge 2'-0" C/C both ways. Mirror screws to be used. Joints to be finished with Silicon based sealant. ACP thickness of 3 mm minimum. Aluminium foil thickness to be min 0.20 mm., 2'-0" C/C both ways. ACP to be in 2' width panels or distributed equally. Alubond, Eurobond, Fujibond, Alcobond or equivalent ISO certified brands to be used. Shades to be as per bank's approval. Trap door will be 12 mm marine ply finished with ACP.	-	Sq.ft		
C	Providing and fixing panelling on wall. Framing shall consist of Sal Wood 50 mm x 25 mm @ 600mm C/C. Both ways horizontally and vertically on the wall / with Aluminium Sections of 2"x1" as directed by Bank / Architect. This framing would be covered by 6mm thk. Ply (In case of wooden frames), finished with 2mm thick "Aluminium Composite Panel". The rate shall inclusive of necessary fixtures and fittings, sealant etc. complete.				
5	<b>STORAGE CABINETS</b>				
i	<b>Storage Full ht.</b>				
	1' 6" deep x 7' 0" ht.				
	Carcass and shelves out of 3/4" and 1/4" thk. Marine ply of BWR Grade (Alishan/Greenply or Century Ply make)				
	Hardware - S.S. hinges, stoppers, 'Vijayan' locks, S.S. handles				
	Shutter (19 mm thk.) semi solid core faced with approved laminate (1.0 mm) on the exterior and back of shutter & Internal faces all finished with enamel paint of Asian make.	40.00	Sq.ft		
ii	<b>Storage Half ht.</b>				
	Size - 1' 4" deep x 2' 6" ht.				
	Carcass and shelves out of 3/4" and 1/4" thk. Marine ply of BWR Grade (Alishan/Greenply or Century Ply make)				
	Shutter (19 mm thk.) semi solid core faced with approved laminate (1.0 mm thk.) on the exterior and back of shutter and finished with enamel paint internally				
	Hardware -S.S. hinges, stoppers, 'Vijayan' locks, S.S. handles	20.00	Sq.ft		
6	<b>COUNTERS AND DESKS</b>				





	(COUNTERS) Providing and Fixing COMPUTER COUNTERS made out of 19 mm thick bwp grade board of approved brands as listed in the specifications, and as per the attached drawing, all complete with 1.0 mm thick laminate on all visible surface, tabletops, customer top, etc, and all drawers etc. to be painted with 1 coat of primer and 2 coats of 1st quality enamel paint). 12 mm thick glass, MODIGUARD / AIS , branded, to be used on top of the COMPUTER COUNTER. Keyboard Tray to be provided on Special Keyboard Slides, and wristrest to be given. Drawer Slides to be used for all drawers. All locks to be of Godrej. All drawers, cabinets, Keyboard, etc. to be lockable. Footrest to be provided. The Front of the Computer Counter shall have decorative finishing in ply and laminate as shown in the drawing attached. 12mm thick glass as a screen shall be provided in front, with a 3" gap from the counter top. Height of Glass: 12". Glass to be inserted in polished teakwood members, size 2" x 2", appropriately finished				
	3" high skirting box with walnut wood skirting, melamine polish finished				
i	<b>BM</b> workstations in laminate finish MANAGER Table size 5'-0"x2'-9' Or as per availability of space. The table shall be postformed	1.00	No		
iii	<b>SM</b> workstations in laminate finish MANAGER Table size 4'-6"x2'-6' Or as per availability of space. The table shall be postformed	1.00	No		
iii	P/f <b>Officers</b> / Assistant Manager interactive workstations in laminate finish of Table size as per the Drawings. Table shall be postformed	5.00	Nos.		
iv	<b>Senior officer/CM</b> table with interactive workstations in laminate finish. as per the drawings	1.00	Nos.		
v	<b>CASH COUNTER</b>	-	Rft		
	Providing and fixing top, front & side of cash counter made out of 18 mm BWP and termite proof blockboard as per design clad with 1.0 mm thk. Laminated on side and front & the edges to be finished with necessary white beach or white cedar lippings, mouldings, etc. Special 6" drawer to be made for the cash with dividers of 12 mm plywood. the front of the drawer made out of 18mm blockboard finished with 1.0 mm laminate, sides 12 mm th. plywood and bottom to be made of 6 mm plywood. the inside and sides of the drawer to be duly polished. The drawers and shutters to be provided with necessary drawer sliding channels, hinges, locks etc. A leg rest to be provided made out of 18 mm thk. blockboard duly polished. Inside of the unit to be polished in the matching tone. All visible areas to be covered with beach or cedar lippings, mouldings with reddish brown colour polish. Wire manager, CPU trolley, keyboard tray to be provided. 4" ht. laminated skirting to be provided in all visible ares and 12 mm thk. x 18" wide Plain Glass to be provided at counter top customer face horizontally at 3'-9" lvl. The work should be completed as per specification. Cash counter --- 5 rft Open counter --12 rft (spec. same as above)	2.00	Nos.		



vi	Corner Side Table				
	Size: dia 1' 6"	-	Nos		
7	WALL PANELLING				
	P/F paneling with wooden framework of size 50mm x 50mm with 450mm c/c made out of salwood treated with antitermite solution. 9mm thick plywood BWR Grade Marine ply of (Shatabdi/Green panel ply or Century Ply) fixed on frame and finished with 1.00mm thk laminate having 3" wide skirting with 1mm thk groove between skirting and partition and 1mm groove between vertical laminates as per design.	200.00	Sq.ft		
9	LOOSE FURNITURE				
A	MISCELLANEOUS				
i	Roller Blinds	-	Sq.ft		
ii	Frosted/sun control film on glass	0.00	Sq.ft		
iii	P/F All internal signage		Nos		
iv	Notice Board/ Soft Board/Pinup Board	30.00	Sq.ft		
v	CPU Trolley	8.00	Nos		
	LESS BUY BACK ITEMS LIKE WOOD, SECTIONS ETC	1.00	LM		
	TOTAL OF FURNISHING WORK				

### BUDGETARY ESTIMATION OF ELECTRICAL JOB FOR KHARAGPUR IB BRANCH, INDIAN BANK

S.NO.	DESCRIPTION	QTY.	UNI T	RATE	AMOU NT
	PARTICULAR				
1	Supply, laying, connection & testing of light, fan point, wiring by 2x1.5mmsq(2x3/.029) + 1x1mmsq PVC insulated copper flexiable wire maintating the colour code as per direction in PVC conduite of 20mm with ISI mark 1.5mm thickness to conceal in wall partition mending good the damage, complete with PVC circular box, bend to be done as per drawaing including 3 point ceiling rows wherever required GI saddle to be used for fixing,				





	metal flexiable/PVC flexiable pipe may use				
	if requied in partition wall. All PVC pipes				
	should be with ISI mark. No joints will be				
	allowed inside pipe ,light, fan & plug point				
	complete with modular type switch plate &				
	MS box .				
a)	Lighting point complete with modular type				
	switch, plate, M.S. conceal box.				
	Point - 1 Light point control by 01 switch.	18	Nos		
	Point - 2 Light point control by 01 switch.	14	Nos		
	Point - 3 Light point control by 01 switch.	0	No.		
	Point - 4 Light point control by 01 switch.	0	No.		
b)	Exhaust fan point same as item No. 1 complete with modular	2	Nos		
	type switch plate & MS conceal box & 3 pin ceiling rose.				
c)	Wall bracket fan point as above complete with modular type	10	Nos		
	switch, plate & M.S. conceal box. Including one 2pin plug				
	socket, front plate & conceal box at fan end.				
d)	48" dia ceiling fan point as above complete with modular type	2	Nos		
	switch, plate & M.S. conceal box. Including one 2pin plug				
	socket, front plate & conceal box at fan end.				
e)	Call bell point same as as bove complete with modular type	1	No.		
	push switch, plate & M.S. conceal box with buzzer type bell.				
2	Supply Laying of Circuit line 2x2.5mmsq + 1x1mmsq PVC	222	Mts		
	insulated copper wire form MCB DB(LDB) to lighting SB &				
	Raw power plug point (6Amps) rest are same as item no.1.3				
	light board or 6 amps plug connected from one circuite.				
a)	Supply Fixing & connection of modular type 6 amps Plug	10	No.		
	switch complete with Ms box Socket to fixed above table. 03				
	nos plug can be connected from 01 circuite				
b)	Same as above but 16 Amps 6pin socket with 16amps switch	10	No.		
	for raw power point. ( 01 Nos plug connected from one				
	circuite.)				
SL.	PARTICULAR				
4	SUPPLY FIXING & CONNECTION				
	LIGHT FITTINGS / FANS :				





A	Recess mounted 40 watt LED PHILIPS/ HAVELS MAKE FITTING 2'-0"X2'-0"	16	Nos.		
B	PHILIPS/ HAVELS make 1x40 watt Tubelight fittings with truelite with both end cap white	4	Nos.		
C	Recess mounted 18 watt LED PHILIPS/ HAVELS MAKE down lighter.	28	Nos		
D	225 mm dia heavy duty Exhaust fan 230 volt A.C. ( EPC / PHILIPS make).	2	Nos		
E	Wall mounting fan 400 mm dia 230 volt A.C.	0	Nos.		
F	48" CEILING FAN WHITE COLOUR (ORIENT/PHILIPS/HAVELS)	0	Nos.		
G	PHILIPS/ HAVELS make 2x40 watt TL fittings with truelite with both INDUSTRIAL TYPE FIXED DIRECT ON TRUE CEILING.	0	Nos		
H	PHILIPS/ HAVELS make 1x40 watt 2' length Tubelight fittings with truelite with both end cap white	4	Nos.		
5	<b>UPS WIRING :</b>				
a)	Supply fixing & connection of UPS circuit line with 2x2.5+1x1.5mmsq through rigid PVC conduit 20mm dia 1.6 mm wall thickness, with ISI mark, to lay from UPS MCB DB to plug point board. rest same as item no.1 Two nos point to be connected from One circuit.	178	Mts		
b)	Supply fixing & connection of UPS circuit line with 16 sqmm (approved make) wire to be connected from main to UPS for use UPS charging purpose only. Connection must through with MCB .	28	Mts		
c)	Supply fixing of 2x6Amps 5 pin socket + 1x16 Amps 6 pin socket in single board (under table) + 1x16 A switch in another board above table as per direction.	22	Set		
d)	Same as above but 3x6/16, 6pin socket with switch to provide near HUB rack, are to be connected from UPS power.	2	Set		
e)	Supply laying & connection of UPS incoming power line with 2x6mmsq +1x2.5 PVC insulated copper wire rest same as item no item no. 1 from PDB to UPS incoming power switch. including 1 nos outgoing line.	32	mtr		







f)	Supply installation of UPS incoming 63Amps DP MCB with original housing of Legrand make.	4	no		
g)	Supply installation and termination of UPS outgoing power distribution system with 10+2Way SPN DB comprising 8x10Amps SP MCB & 40 Amps DP MCB as main	4	no		
6	<b>LAYING OF CABLE :</b>				
a)	Supply laying fixing main power with 50 mm sq 3.5 core PVC insulated, PVC sheathed Alu. Conductor, 1100 v. grade armoured cable complete with 02 nos 8 SWG bare GI. wire as running earth.	15	Mts.		
b)	End termination of 50 mmsq 3.5 Core armoured cable, complete with brass cable gland, Alu. Lug, PVC tape.	12	End		
7	<b>MAIN ELECTRICAL Cubical type panel.</b>				
7.1	<b>MAIN VTPN DB</b>				
	Supplying, installing, testing & commissioning				
	of 24 Slots, Vertical busbar, MCB type Power Distribution				
	Board (MAIN VTPN DB), flush mounted on wall, sheet				
	metal fabricated, powder coated, having				
	dust-proof and vermin proof, and hinged door				
	with all internals such as DIN rails, neutral-link,				
	interconnected wiring complete with earthing				
	lugs housing following switchgears.				
	1 no., 125A, 4P MCCB as incomer				
	4 no., 63/40A, TP MCB				
	8 no., 40/32/25 A SP MCB				
	6 nos, 20/16A, SP, MCB outgoing	1.00	SET		
i	125 amps 4P CHANGE OVERSWITCH ON LOAD TYPE in sheet steel enclosure complete with all mounting accessories before lighting DB with necessary cable jointing adaptor box	1.00	No		
ii	32/25A roll socket complete with 32/25/16/10 amps DPMCB with 3 pin metal clad socket - waterproof tight (IP 65) for wall unit split AC machine	-	Nos		
iii	40A/32A DP MCB in sheet steel enclosure complete with all mounting accessories for UPS & others	2.00	Nos		
	Providing and Supplying 40 A TP MCB as a master Switch to switch off all the LDB Loads, located at the Entrance of the Branch.	1.00	Nos.		
	<b>DISTRIBUTION BOARDS</b>				



	Supply, installation, testing & commissioning of Distribution Boards surface / flush mounted with Double door containing MCB/ELMCB as incomer and SPMCB as outgoing. All MCBs are of 10KA breaking capacity and ELMCBs/RCCB should be of 30mA/100 MA sensivity. The DB shall have appropriate no. of top and bottom knock outs for outgoing circuits and shall be complete with necessary busbars, interconnection terminals and earth studs. All terminations in DB shall be complete with ferulling, dressing and all circuits shall be properly labeled with PVC strip (sticker type) having identification as per the final approval of Consultant. For UPS DB MCB shall be 'D' type and other MCBs shall be 'C' category for lighting and raw power DB				
i	<b>Lighting &amp; power Distribution Board -</b>	1.00	No		
	12 way TPN DB				
	Incomer 40A 4P MCB C TYPE+elcb30mA				
	Outgoings :6/10 SP MCB, 'C' Type - 36 Nos				
ii	<b>Power Distribution Board (ATM ROOM)</b>	-	No		
	4 way TPN DB				
	Incomer:40A 4PMCB+ ELCB 100 ma				
	Outgoings : 32 A SP MCB - 2 Nos ; 16/20 SP MCB, 'C' Type - 4 Nos				
iii	<b>UPS Power Distribution Board -(FOR 3KVA UPS)</b>	1.00	No		
	12 way SPN DB				
	Incomer:40A DP MCB, 'D' Type				
	Outgoings :16/10 SP MCB, 'D' Type – 10Nos				
iv	<b>UPS Power Distribution Board - UPS DB-2KVA-ATM)</b>	-	No		
	6 way SPN DB				
	Incomer 20A DP MCB, 'D' Type				
	Outgoings :16/20 SP MCB, 'D' Type - 4 Nos				
8	<b>EARTHING STATION :</b>				
a)	Earthing installation as per I.E. rule conforming to <b>IS 3043-1987</b> or its latest amendent by making earth station with <b>600x600x3mm</b> (mini-mun) thick copper plate electrode to be installed such that is top edge shall be at a minimum depth of 3.3mts below ground level after preparation of ground with charcoal, sand ,& salt, connecting the <b>25x3mm</b> thick copper lead in strip (upto 10 mts length) by bolting and brazing to the copper				





	plate complete with Brass bolt of suitable				
	length double nuts & washer including supply &				
	fixing of 50mm dia 2.3Mts long partly perforated				
	G.I. Pipe with funnel for watering arrangement.				
	<b>N.B :- The Copper plate to be buried under</b>				
	<b>3.3Mts depth from ground level, including</b>				
	<b>C.I. Pit 300x300mm with necessary brick</b>	0	Set		
	-				
b)	<b>wall ( For UPS earthing).</b>				
	Spike Earthing with G.I. Electrode 3mts. Long x 50				
	mm dia (Class - B) including accessories and				
	providing masonry enclosure with cover				
	300x300mm plate having locking arrangement				
	and watering funnel Etc. with charcoal,				
	sand & salt at alternate layer as required				
	for electrical panel earthing.	0	No.		
c)	(For main electrical panel earthing.)	0	Mts		
d)	Supply laying 1x8SWG copper bare wire from				
	earth spike to main panel. (Electrolyte wire)				
	Do but with 1x16mm sq insulated				
	copper wire from earth spike to UPS earth				
	bus bar through PVC rigid 20mm dia ISI mark.	0	Mts		
9	<b>A/C. electrification :-</b>				
a)	Supply laying & connection of A/C. line for				
	1.5 / 1TR A/C. window / split with 2x4 + 1x2.5, mm sq				
	through Rigid PVC				
	conduit rest same item no 1.	45	Mts		
b)	S/Fixing AC Box as per company specification with 25 Amp	5	Nos		
	SPMCB with 25AMP Socket				
c)	AC WITH COPPER PIPING:				
i	1.5TR 5 STAR MACHINE WITH INSTALLATION	0	Nos		
ii	1TR 5 STAR MACHINE WITH INSTALLATION	0	Nos		
10	<b>Out door type glow sign board wiring :-</b>				
a)	Supply laying of main line with 2x2.5 + 1x1.5	22	Mts		
	mm sq through MS conduit from main panel				
	to glow sign board.				
b)	Supply installation of 16 amps DP MCB at main				



	entrance Glow sign board WITH TIMMER MDS MAKE	0	Set		
11	Supply fixing of 100Amps TPN HRC type SFU at SEB for main incomming on MS angle. frame & 02 nos Cable end box including connection.	1	No.		
12	<b>Gen set wiring :-</b>				
a)	Supply laying fixing main power with 3.5 core 50Sq.mm PVC insulated,PVC sheathed Alu. Conductor, 1100 v. grade armoured cable complete with 02 nos 8 SWG bear GI.wire as running earth.	17	Mts		
b)	End termination of 3.5 core 50 Sq.mm armoured cable,complete with brass cable gland , Alu. Lug, PVC tape.	4	End		
13	<b>LAN WORK</b>				
D	<b>Data /Voice Network System</b>				
1	Supply & Installation of cat - 6 Data Cable	190.00	Mtr		
2	RJ - 45 Data Socket With Plate	8.00	Nos		
3	RJ - 11 Voice Socket	8.00	Nos		
4	Supply & Installation of Voice Cable - 4 pair Telephone Cable un armoured PVC Sheated .	0	Mtr		
5	10 Pair Tag Block Crome type on MS box	2.00	Nos		
6	P/F 9U Rack	-	Nos		
7	EPABX Box	-	Nos		
8	Patch code-3 Meter	7.00	Nos		
9	Patch code- 1.5 Meter( inside rack to connect router to patch panel)	7.00	Nos		
10	24 Port Switch	1.00	Nos		
11	24 Port Jack Panel	1.00	Nos		
	LESS BUY BACK ITEMS LIKE FULL LENGTH WIRE, GI BOX ETC	1.00	LM		
	<b>TOTAL OF ELECTRICAL AND AC WORK</b>				





	<b>SUMMARY OF FURNISHING &amp; ELECTRICAL JOB</b>				
	FURNISHING WORK				
	ELECTRICAL WORK				
	TOTAL				



Plan - B1

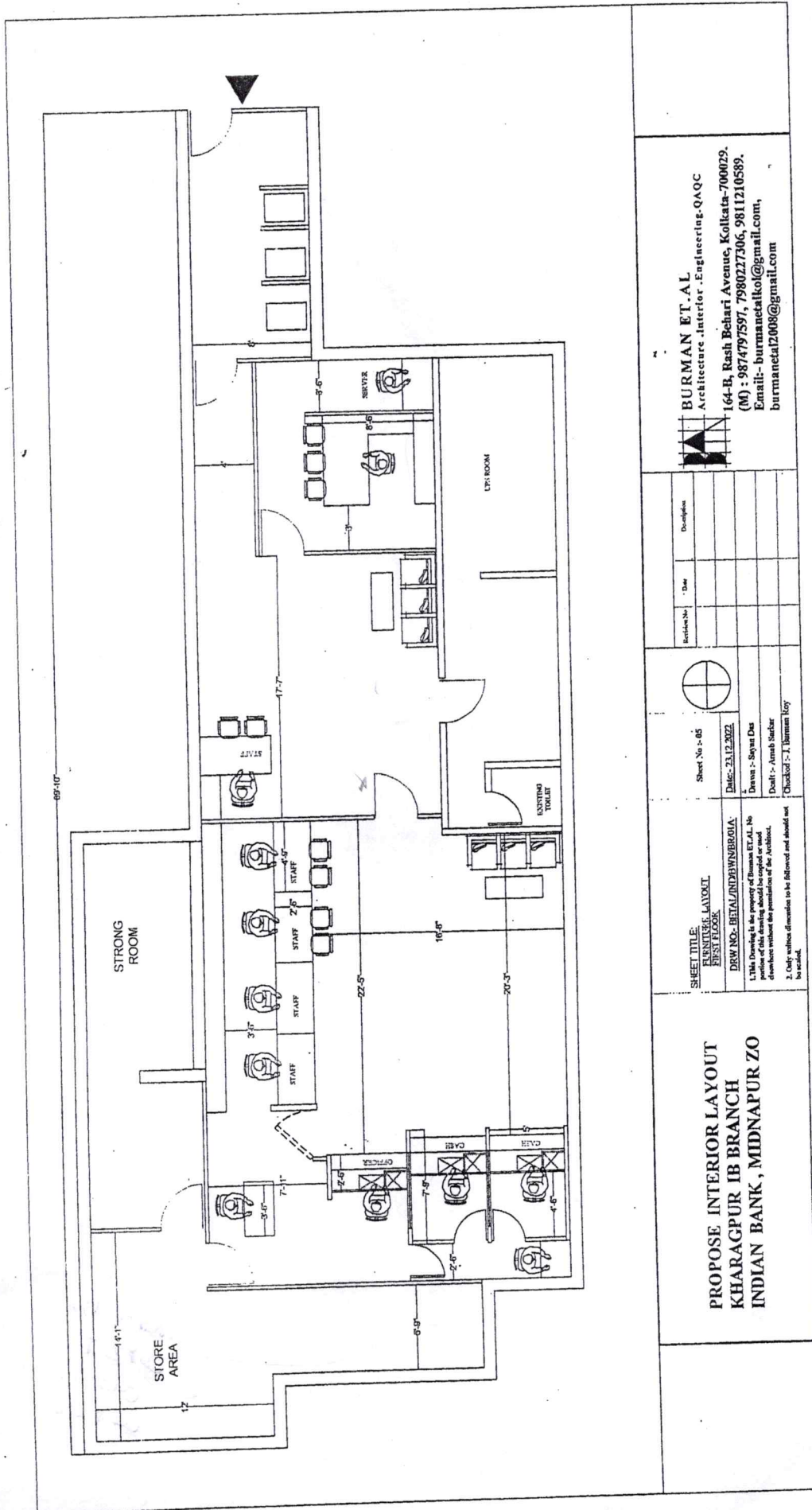

**BURMAN ET. AL**  
 Architecture Interior .Engineering-QAQC  
 164-B, Rash Behari Avenue, Kolkata-700029.  
 (M) : 9874797597, 7980227306, 9811210589.  
 Email:- burmanetalko@gmail.com,  
 burmanetalko12008@gmail.com

Revision No.	Date	Description

Sheet No. - 05  
 Date: 23.12.2022  
 Drawn by: Sayant Das  
 Drafted by: Anish Sarker  
 Checked by: T. Burman Roy

**SHEET TITLE**  
**FURNITURE LAYOUT**  
**FIRST FLOOR**  
 DRW NO.: B1A1/INDIANBANK/IB  
 This drawing is the property of Burman Et. Al. No part of this drawing should be copied or used elsewhere without the permission of the Architect.  
 2. Only sections dimension to be followed and should not be scaled.

**PROPOSE INTERIOR LAYOUT**  
**KHARAGPUR IB BRANCH**  
**INDIAN BANK, MIDNAPUR ZO**

