

OPTION-4

PROJECT
 PROPOSED LAYOUT PLAN OF INDIAN BANK BRANCH AT
 SAIFULLAHGANJ -DISTRICT -SULTANPUR

DRAWING
**FALSE CEILING
 LAYOUT**



SCALE
 N. T. S.
 DATE
NOV-2023

ARCHITECT
MOHIT & ASSOCIATES
 ARCHITECTS, INTERIORS, ESTIMATORS,
 L-2554 VINEET KHAND,GOMTI NAGAR,
 LUCKNOW, MO. -9582218092,7438217659

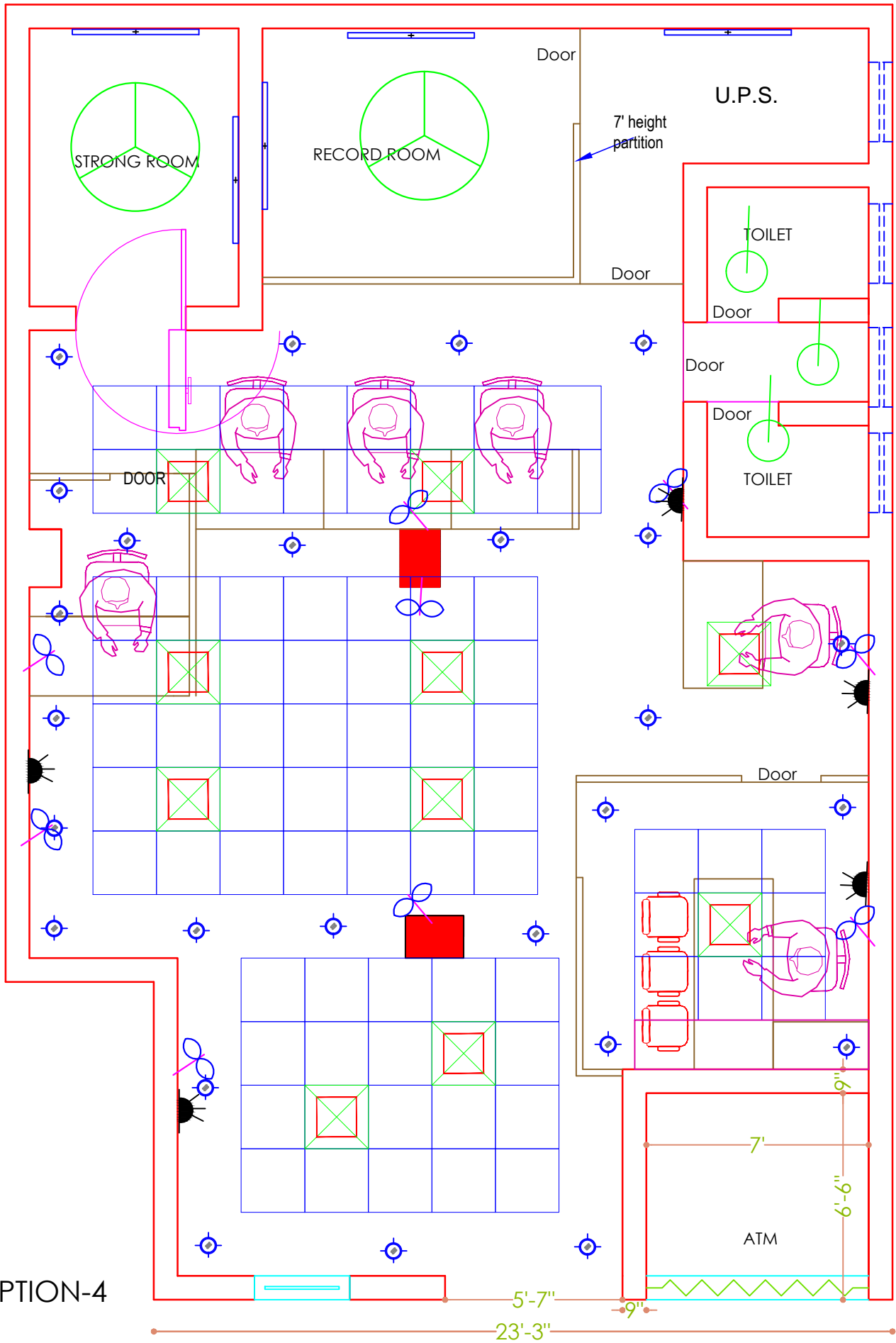

OPTION-4

5'-7"

23'-3"

9"

7'

6'-6"

ATM

PROJECT

PROPOSED LAYOUT PLAN OF INDIAN BANK BRANCH AT SAIFULLAHGANJ -DISTRICT -SULTANPUR

DRAWING

ELECTRIC LAYOUT

NORTH



SCALE

N. T. S.

DATE

NOV-2023

ARCHITECT
MOHIT & ASSOCIATES
 ARCHITECTS, INTERIORS, ESTIMATORS,
 L-2554 VINEET KHAND,GOMTI NAGAR,
 LUCKNOW, MO. -9582218092,7438217659