



PREMISES DEPARTMENT
ZONAL OFFICE HAMIRPUR

TENDER DOCUMENT
INTERIOR FURNISHING, ELECTRICAL & DATA CABLING
WORKS IN NEW PREMISES OF INDIAN BANK
BHANDARA BRANCH, DISTRICT - MAHOBA

Date : 15.01.2024

Issued to:

.....
.....
.....

Last date of submission of Tender	29/01/2024 upto 15:00 HRS at Indian Bank, Zonal Office, Premises Department, 10/379, Rameni Tarauns, Hamirpur - 210301
Date of opening Tender	30/01/2024 at 16:00 HRS Indian Bank, Zonal Office, Premises Department, 10/379, Rameni Tarauns, Hamirpur - 210301
Cost Of Tender	Free Of Cost.

CONSULTANT:

M/s Mohit and Associates
Architects, Interiors & Estimators,

L-2/554-, Vineet Khand,
Gomti Nagar, Lucknow-226010

E-Mail: mohitg.gupta2783@gmail.com
Mobile No: 742821765, 9582218092

INDEX

<u>DESCRIPTION</u>	<u>PAGE NO.</u>
NOTICE INVITING TENDER	3
FORM OF TENDER	4
GENERAL RULES AND INSTRUCTIONS TO TENDERERS	5 - 10
ARTICLES OF AGREEMENT	11 - 13
APPROVED LIST OF MATERIALS	14 - 16
SCHEDULE OF QUANTITIES	17 - 28
DRAWINGS	29 - 30



**INDIAN BANK
ZONAL OFFICE – HAMIRPUR**

NOTICE INVITING TENDER

Indian Bank, Zonal Office HAMIRPUR invites sealed tenders from **Empanelled Contractors** with Indian Bank (single bid system) for proposed Interior Furnishing, Electrical & Data Cabling Works in the New Premises of Bhandara Branch, District - Mahoba. The Tender Documents can be downloaded from the Bank's website (www.indianbank.in) under Tender Column.

1	Name of work	Interior Furnishing, Electrical & Data Cabling Works in New Premises of Bhandara Branch, District - Mahoba
2	Estimated cost of work	Rs. 5.90 Lakh
3	Period of completion	25 days to be reckoned from 5 TH day from the date of issue of the Work Order or handing over of site whichever is later
4	Validity of Tender	90 Days from the date of opening
5	Defects Liability Period	12 Months from the date of virtual completion of work
6	Earnest Money Deposit	Rs.6,000/- (Rupees Six Thousand Only) by way of DD in favour of Indian Bank payable at HAMIRPUR <i>*Firms registered with MSME / NSIC with valid certificates issued by GOI are exempted from submitting EMD along with Tender.</i>
7	Initial Security Deposit (ISD)	After acceptance of Work Order, Contractor shall submit ISD of 2% of the Bid / Contract Amount in the form of DD.
8	Retention Money (RM)	8% of the Bill Amount excluding Taxes
9	Total Security Deposit (TSD) = ISD + RM	10% of the Bid Amount (ISD – 2% & RM – 8%) ISD Amount will be refunded to Contractor within 14 days from the issue of Work Completion Certificate by the Architect and the Retention Money will be refunded after the completion of defect liability period.
10	Interim / Adhoc Payment	No Interim / Adhoc Payment will be paid
11	Liquidated Damages	1% per week of the Contract Value subject to maximum total of 10% of final Contract value
12	Tender Documents	Tender documents can be obtained from Indian Bank, Zonal Office, Premises Department, 10/379, Rameni Tarauns, Hamirpur – 210301 from 15/01/2024 to 29/01/2024 on all working days during office hours and / or can be downloaded from the Bank's website (www.indianbank.in) under Tenders column.
13	Last date of submission of tenders	29/01/2024 upto 15:00 HRS at Indian Bank, Zonal Office, Premises Department, 10/379, Rameni Tarauns, Hamirpur - 210301
14	Date of opening Tender	30/01/2024 at 16:00 HRS Indian Bank, Zonal Office, Premises Department, 10/379, Rameni Tarauns, Hamirpur - 210301

Note:

1. The bank is not bound to accept the lowest tender & reserves the right to accept or reject any or all tenders/bid without assigning any reasons whatsoever.
2. The rates quoted by the tenderer shall be based only on the specifications and conditions of the tender documents.
3. Bank is not liable to make any payment to tenderers for preparation to submit the tender/bid.

ZONAL MANAGER



FORM OF TENDER

**Indian Bank
Zonal Office HAMIRPUR
Premises Department
10/379, Rameni Tarauns,
HAMIRPUR – 210301**

Dear Sir,

**SUB: Invitation of Tender for Interior Furnishing, Electrical & Data Cabling Works
in New Premises of Bhandara Branch, District - MAHOBA**

Having examined the drawings, specifications, conditions and schedule of quantities prepared by you, and satisfying ourselves as to the location of the site and working conditions, I/We hereby offer to execute the above works at the respective rates which I/We have quoted for the items in the Schedule of Quantities.

I/We herewith deposit **Rs.6,000/- (Rupees Six Thousand Only)** by crossed demand draft payable at HAMIRPUR and drawn in favour of Indian Bank as Earnest Money Deposit for the due execution of the works at my/our tendered rates, together with any variations should the work be awarded to me/us.

In the event of this tender being accepted, I/We agree to enter into and execute the necessary contract required by you. I/We do hereby bind myself/ourselves to forfeit the aforesaid Earnest Money Deposit of **Rs.6,000/- (Rupees Six Thousand Only)** in the event of our refusal or delay in signing the Contract Agreement. I/We further agree to complete the work within the stipulated time specified in the Appendix to General Conditions of Contract.

I/We agree to keep our tender open for **90(Ninety) days** from the date of opening of Envelope No.1.

I/We enclose the completed tender documents duly signed under two separate sealed envelopes and the Earnest Money Deposit Rs._____ (Rupees _____ only) by Bank Draft No. _____ dated _____ Issued by _____

Thanking you,

Yours faithfully,

[To be signed by the Authorized Representative of
Tenderer who has the Power to do so]

Place:
Date:

Witness Signature:
Name:
Address:
Seal:

GENERAL RULES AND INSTRUCTION FOR THE GUIDANCE OF TENDERERS

1 Definition of terms / interpretation:

- Employer/Owner/Bank /Indian Bank/ Accepting Authority shall mean Indian Bank with their Corporate Office at No. 254-260, Avvai Shanmugam Salai, Royapettah, Chennai – 600 014 inter-alia having their Zonal Office at 10/379, Rameni Tarauns, HAMIRPUR – 210301 and any of its employees representative authorized on their behalf.
 - Throughout these bidding documents, the terms “bid” and “tender” and their derivatives (“bidder”/“tenderer”), “bidered /tendered”, “bidding”/“tendering”, etc. are Synonymous.
 - Day means calendar day. Singular also means plural
 - “Contractor” means the person whose Tender has been accepted by the Employer and the legal successors in title to such person, but not (except with the consent of the Employer) any assignee of such person.
 - Tenderer: The term ‘Tenderer’ shall mean the individual or firm or company whether incorporated or not, undertaking the work and shall include legal representative(s) of such individuals or persons composing such firm or company or successors of such firm or company as the case may be and permitted assigns of such individual or firm or company.
- 2 Tenders, which should always be placed in sealed cover, with the name of the work written on the envelope “Interior Furnishing Work in New Premises of Bhandara Branch, District – MAHOBA “ will be received by Chief Manager (P&E), Indian Bank, Zonal Office , Premises Department, HAMIRPUR.
- 3 Earnest money amounting to **Rs.6,000/- (Rupees Six Thousand Only)** in the form of Demand Draft drawn in favour of “**Indian Bank**”, payable at HAMIRPUR must accompany each tender. EMD amount will not carry interest. Tender without earnest money will be summarily rejected.
Please note that firms registered with MSME / NSIC under single point registration with valid certificates issued by GOI are exempted from submitting EMD. Necessary Certificates must accompany bid. No other type of certificate is acceptable. The exemption and relaxation in EMD is subject to the validity & acceptance of their registration certificate on the date of opening of Tender.
- 4 The Indian Bank does not bind itself to accept the lowest or any tender and reserves to itself the right of accepting the whole or any part of the tender and the tenderer shall be bound to perform the same at the rate quoted.
- a. The rate quoted by the Tenderer shall be net (excluding GST), up to the stage of incorporation and handing over site. All taxes including (excluding GST) or any other tax on material or on finished works like Turn-over Tax, including taxes that may be newly introduced subsequent to the tender etc. in respect of this contract shall be payable by the Tenderer and the Indian Bank will not entertain any claim whatsoever in this respect.
The rate quoted should be excluding GST.
The tenderer who wishes to quote for the tender should have GST registration and should mention the registration number.
- 5 The Tenderer shall give a list of his relatives working with the Indian Bank along with their designations and addresses.
- 6 No employee of the Indian Bank is allowed to work as a contractor for a period of two years of his retirement from Indian Bank service, without the previous permission of the Indian Bank. The contract is liable to be cancelled if either the contractor or any of his employees is found at any time to be such a person who had not obtained the permission of the Indian Bank as aforesaid before submission of the

tender or engagement in the Tenderers service.

- 7 The tender for works shall remain open for acceptance for a period of 90 days from the date of opening of Tender. If any tenderer who withdraws his tender before the said period, then the Indian Bank shall be at liberty to forfeit Earnest Money paid along with the tender.
- 8 The tender for the work shall not be witnessed by a Tenderer or Tenderers who himself/themselves has/have tendered or who may and had/have tendered for the same work. Failure to observe this condition would render tenders of the Tenderers tendering as well as witnessing the tender liable to summary rejection.
- 9 It will be obligatory on the part of the tenderer to tender and sign the tender documents for all the component parts.
- 10 Transfer of tender documents purchased by one intending Tenderer to another is not permitted.**
- 11 The Tenderer must pay the amount of Earnest Money as mentioned in the Notice of Tender Invitation by Bank Demand Draft payable to Indian Bank. No interest on Earnest Money deposited by the Tenderer shall be allowed. The Tenderer should attach the Bank Draft along with the tender failing which the tender will not be considered. No other mode of payment shall be accepted.
- 12 The Earnest Money Deposit of unsuccessful tenderers shall be refunded within three weeks of award of contract to the successful tenderer or within one week of actual commencement of work whichever is earlier and in any case not later than four months.
- 13 The Earnest Money Deposit of the successful tenderer shall be refunded on the acceptance by the Employer of the Contractor's Demand Draft towards Security Deposit.
- 14 The EMD of the Tenderer, whose tender is accepted, shall be forfeited in full in case he does not start the work by stipulated date mentioned in the award letter.
- 15 The retention amount at 8% on the value of the bill paid will be held by the Indian Bank apart from ISD.** ISD Amount (2%) will be refunded to Contractor within 14 days from the issue of Work Completion Certificate by the Architect and the Retention Money (8%) will be released at the end of Defect Liability Period (12 Months), subject to satisfactory rectification of defects noticed, if any. ISD and Retention Amount held in our Bank's Book will not carry any interest.
- 16 The acceptance of a tender will rest with the Indian Bank and the Indian Bank reserves to itself the authority to reject any or all of the tenders received without the assignment of a reason. Tenders in which any of the prescribed conditions are not fulfilled (or) are incomplete in any respect are liable to be rejected. The Indian Bank reserves the right to accept the tender in full or in part and the tenderer shall have no claim for revision of rates or other conditions if his tender is accepted in parts.
- 17 Canvassing in connection with tenders is strictly prohibited and the tenders submitted by the Tenderers who resort to canvassing will be liable to rejection.
- 18 All rates shall be quoted on the proper form of the tender alone. **All the entries to be made legibly in ink only.** Rates written in pencil or any other mode shall not be considered for evaluation and will be rejected.
- 19 The tenderers shall take care to price his tender rationally. Extreme under pricing or overpricing in item rates, total amount will be considered adversely in the assessment of tenders. The tenderer shall on demand submit the analysis of rates of some items of work if so required by the employer.**
- 20 An item rate tender containing percentage below/above will be summarily rejected.**
- 21 On acceptance of the tender the name of the accredited representative(s) of the Tenderer who would be responsible for taking instructions from the Indian Bank shall be communicated to the Indian Bank.
- 22 Special care should be taken to write the rates in figures as well as in words and the amounts in figures only, in such a way that interpolation is not possible. The total amount should be written both in words and in figures.
- 23 The Contractor shall within 7 days of receiving the WORK ORDER submit **INITIAL SECURITY DEPOSIT**

of 2% of the contract value in the form of a Demand Draft. On acceptance of the Demand Draft, the Earnest Money Deposit shall be refunded to the Contractor.

- 24 The Contractor shall comply with and give all notices required under any law, rules, regulations, or bye-law of Parliament, State Legislature or Local Authority relating to works. If needed, the Contractor has to obtain required permission/ approval from the building secretary/ association. The Contractor shall before commencing the execution of work issue a certificate to the Employer that he has obtained all the permissions Registrations and give all the notices as are required to be obtained or given under law particularly blasting permission, Police permission etc.
- 25 The Contractor shall be required to maintain the site and the building areas in a neat and clean condition at all times to the satisfaction of the Employer. The Contractor shall especially take care to keep areas free from getting water logged, from concrete/mortar dippings, bricks, steel, shuttering materials or any other material / rubbish.
- 26 Debris and items removed from the building have to be neatly stacked at site and then periodically removed (maximum of one week), carried away by the Contractor and disposed off as per the rules and regulations of the Local Authorities concerned. No debris shall be thrown loose from upper floors. No floor, roof or other part of the building shall be over-loaded with debris or materials as to render it unsafe.
- 27 Employer reserves the right to insist on selection of material, workmanship, detailing and finishes, which they consider, is appropriate, and suitable for the intended use. The contractor is not eligible to claim extra on this account.
- 28 Employer will require the contractor to produce, samples of all the materials, accessories/ finishes prior to procurement/ manufacture. The samples of the materials for the work shall be got approved from the Employer. Failure to comply with these instructions can result in rejection of the work/materials.
- 29 For painting & Lamination, sample area shall be prepared and the shade got approved. It is also advised to give computer presentation of various colour schemes to the employer before going for sample painting/Lamination,
- 30 The Tenderer should note that he should execute his part of work without causing any damage to any component of the building and also without disturbing the occupants. Any damage so caused shall be made good at the cost & risk of the tenderer.
- 31 The successful tenderers shall include, in the quoted price, all allied civil works such as chasing in wall, drilling holes etc to support the frames, partitions, make the surface good after grouting, scaffolding required if any to load/ unload the materials etc.
- 32 The successful contractor shall also be responsible for the safety and security of all their materials and also for ensuring fire prevention steps at all times in the working premises including their part of the work. The successful contractor has to place full time representative at site, the representative should have thorough subject knowledge.
- 33 The work shall be carried out without disturbing the existing occupants of other offices. Necessary barricading of the area, if required from the rest of the area shall have to be arranged by the successful contractor at no extra cost. The work is to be organized and executed so as to have least disturbance to the occupants of other offices.
- 34 No interim payment / Adhoc Payment will be entertained in any case.
- 35 ***The contractor should ensure payment of minimum wages + VDA to all labourers / workmen staff employed by him in line with central/ state labour wage act which ever higher.***
The Contractor shall at all times indemnify and keep indemnified the Employer against all losses, claims, damages or compensation including under the provisions of the payment of the Wages Act 1936, Minimum Wages Act 1948, Employer's Liability Act 1938, Workman's Compensation Act 1923, the Maternity Benefit Act 1961, the Bombay Shops and Establishments Act 1947, Industrial Disputes Act 1947, and Contract Labour (Regulation and Abolition) Act 1970 and Employees State Insurance Act 1948, Motor Vehicles Act 1988 or any modifications thereof or under any other law relating thereto and rules made there under from time to time or as a consequence of any accident or injury to any workman

or other person in or about the work whether in the employment of the Employer or Contractor or not, and also against all costs, charges and expenses of any suit, action or proceedings whatsoever out of such accident or injury or combination of any such claims.

- 36 From commencement to completion of works, the Contractor shall take full responsibility for the care of the work and for taking precautions to prevent loss or damage to the work to the maximum extent possible and shall be liable for any damage or loss that may arise to the works or any part thereof from any cause whatsoever including causes of fire, lightning, explosion, earthquake, storm, hurricane, floods, inundation, subsidence, landslides, rock slides, riots (excluding civil war, rebellion, revolution and insurrection) or any latent defect or damage and shall at his own cost repair and make good the same so that at all times the work shall be in good order and condition and in conformity in every respect with the requirements of the Contract.

For the purpose of this condition this expression “from commencement to completion of works” shall mean the period starting with the date of issue of Work Order or date of handing over of site whichever is later and ending with issue of Virtual Completion Certificate.

Without limiting the obligations and responsibilities under this condition, the Contractor shall insure and keep insured the works from commencement to completion, as aforesaid, for the full contract value including Price Variation Adjustment if any against the risk of loss or damage from any cause whatsoever including the causes enumerated in the foregoing paragraphs. In the event of there being a variation in the nature and extent of the works, the Contractor shall from time to time increase or decrease the value of the insurance correspondingly. All the premium for the insurance shall be borne and paid by the Contractor.

Before commencing the work, the Contractor shall without limiting his obligations and responsibilities under this condition, insure against any loss of life or injury to any personnel in the employment of Contractor / Sub-Contractor/nominated Sub- Contractor. For this purpose, insurance shall be taken by the Contractor /Sub- Contractor. Such insurance shall be taken to include both employees/workmen covered by the Workman’s Compensation Act 1923, as well those employees/workmen not covered by the said Act. Separate insurance policies may be taken for employees/ workmen covered by Workman’s Compensation Act 1923, and employees / workmen not covered by the said Act. The entire premium shall be paid by the Contractor. Policy/Policies taken under this para for the personnel in employment with the Contractor / Sub-Contractor may be in their Employer’s names of the Contractor / Sub-Contractor / nominated Sub-Contractors. In the event of any loss or injury to personnel in employment with the Contractor / Sub-Contractor / nominated Sub-Contractors, the Employer and Contractor shall recover directly from the Insurance Company and ensure that payment of the same is made to the affected parties including the Employer. The policy in original shall be deposited with the Employer.

The Contractor shall at all times indemnify and keep indemnified the Employer against all losses and claims for injuries or damage to any person or any property whatsoever which may arise out of or in consequence of the construction and maintenance of the work and against all claims, demands, proceedings, damages, costs, charges and expenses whatsoever in respect of or in relation thereto. Before commencing the execution of the works, the Contractor shall without in any way limiting his obligations and liabilities under this condition, insure at his cost and expense against any damage or loss or injury which may be caused to any person or property including the employees and directors of the Employer and their property by or in the course of the execution of the works. Such insurance to be known as the Third Party Insurance shall be in a sum of **Rs. 1.0 lakh**. The Insurance policy to be so obtained by the Contractor shall be deposited by the Contractor with the Employer within **Seven days** of its issue by the Insurer.

- 37 The Contractor shall take all precautionary measures to ensure the safety of the workmen employed by it. The contractor shall be fully responsible for the any injury or damage caused to the workmen deployed by him at site for carrying out the work and Bank has nothing to do with such happenings and in no way shall be held responsible for the same.
- 38 The contractor shall maintain all registers as required by the Regional Labour Commissioner and should furnish the same to the Bank or its representative as and when required.

- 39 If the work is not started within **7 days** from the date of issue of work order then Employer may terminate the work order without assigning any reason. If during the execution of the work, the progress of work is not considered to be satisfactory and is not consistent to be in contingent with the period of the completion of the work then the Bank may terminate the work order by giving a 5 days notice to the contractor.. In such case the contractor shall be liable to pay the employer any extra cost involved for the completion of the said work and will not obstruct any way in completing the work through other agency. After completion of entire work the contractor shall be paid for the actual work executed by him at the quoted rates after deducting any claims, damages.
- 40 The time allowed for completing the works is **25 days** to be reckoned from **5TH day** from the date of Work Order / date of handing over site whichever is later. Tenderers shall submit a programme (time schedule) for executing the entire project and shall furnish the details of their scheme indicating the proposed deployment of their machinery and resources.
- 41 If the Contractor fails to complete any or all the works by the date/s named in **Clause 40** (Date of Completion) or within any extended time (permitted by Bank) then the Contractor shall pay or allow the Employer the sum to be worked out at **1.0%** of contract value per week to be recovered as Liquidated Damages (and not by way of penalty) for the delay, beyond the said date or extended time, as the case may be, during which the works shall remain unfinished and such damages may be deducted from any moneys due or which may become due to the Contractor. The maximum amount of Liquidated damages shall be **10%** of contract value. The contractor shall be bound to extend validity of Insurance Cover till such period of completion as may be considered necessary at their cost.
- 41 **Extension of time:** If in the opinion of the Employer/ Architects the works be delayed (a) by reason of any exceptionally inclement weather or (b) by reason of instructions from the employer in consequence of proceedings taken or threatened by or disputes, with adjoining or neighbouring owners or (c) by the works, or delay of other contractors nominated by the employer and not referred to in the specification or (d) by the reason of authorized extra and additions or (e) by reason or any combination or works men or strikes or lock-out affecting any of the building trade or (f) from other causes which the employer may consider are beyond the control of the contractor, the employer at the completion of the time allowed for the contract shall make fair and reasonable extension of time for completion in respect therefore. In the event of the employer failing to give possession of the site upon the day specified above, the time of completion shall be extended suitably.
In case of such strikes or lockouts as are referred to above, the contractor shall, immediately give the employer, written notice thereof. Nevertheless he shall use his best endeavours to prevent delay, and shall do all that may be reasonably required, to the satisfaction of the employer for any extension of time for completion hereunder (which shall be final and binding on the contractor) shall be promulgated at the conclusion of such strike or lock-out and the employer shall then, in the event of an extension being, granted, determine, and declare the final completion date. The provision in clause 13 with respect to payments of liquidated damages shall be construed as if the extended date fixed by the employer was substituted for and the damages shall be deducted accordingly.
- 42 The successful tenderer shall be required to execute an Agreement in the proforma attached with this tender document within **7 days** from the date of receipt of the notice of acceptance of tender. In the event of failure on the part of the successful tenderer to sign the agreement within the above stipulated period, the earnest money will be forfeited and the acceptance of the tender shall be considered as cancelled.
- 43 The final bill will be released on satisfactory completion of the entire work and on completion of all the terms and conditions / obligations spelt out and on proper submission of the bill together with the measurements. Final Bill settlement is within 30 days from the date of proper submission of bill & measurements.
- 44 The tenderers shall separately specify at the end of the tender the % and value of SGST and CGST as applicable. As on date 9 % CGST and 9% SGST IS APPLICABLE FOR WORKS CONTRACT. Regarding tax part, the tax rate at the time of billing shall rule over and above all documentations. Valid documents shall be produced if tendered/ asked for at the time before payment. TDS for income tax is as applicable

and shall be included in the quoted rates. The comparison for the least bidder shall be made with the basic price of items of work excluding "Goods and Service Tax" part.

- 45 At any stage i.e. during the execution of work, any kind of change required, whether it is in design or specification, the contractor must inform the concerned Department of the Bank or Architect and after getting the approval, the same has to be incorporated by the contractor.
- 46 Single Power point & Water for work will be provided by bank at free of cost.
- 47 The contractor shall not directly or indirectly sublet the work to other party without written permission of the bank.
- 48 The Bank reserves the right to distribute the work for which quotations have been called, among more than one parties, if found necessary. No claim in this respect shall be considered and the contractor agrees to cooperate with other agencies appointed by the Bank.
- 49 Bank shall not be responsible for any loss or damage to the contractor/labour due to any natural calamity during the course of construction. Contractor is liable to make good all the damages if any, till the work is completed and handed over to the Bank authorities.
- 48 No advance payment shall be made to the contractor on supply of any material supplied at site for execution; Payment shall be made only after completion of the work , submission of proper bills and measurement and checking at the site by Architect and Bank' Engineer.
- 49 Contractor agencies are advised (before quoting the rates) to inspect the site of the proposed work. They must go through specifications and documents. Any clarification, if required, may be taken from the bank before submitting the quote.
- 50 The quantities mentioned in schedule are provisional and likely to increase /decrease to any extent or may be omitted thus altering the aggregate value of the contract. No claim for loss of profit/business shall be entertained on this account.
- 51 The contractor /vendor failed to carry out the works as per schedule/Quality, the same shall be carryout with different agencies and the actual amount will be deducted from the contractor bills.
- 52 Payment to the contractor shall be made as per actual work done of site.
- 53 The contractor agency shall keep particular vigil on his workers to maintain very good workmanship of all items, failing which no payment shall be made and no claim of material/labour used shall be made to him in any case, and the same work shall be executed by him again without charging any extra cost.
- 54 The Bank reserves the right to accept/reject any quotes without assigning any reasons.
- 55 Any work got executed in poor workmanship as pointed out by the Bank' Official will have to be dismantled and redone by the Contractor on his own cost.
- 56 Any addition, alteration or correction in the quote shall be signed and stamped properly by the contractor

DECLARATION:

I / We hereby declare that I / We read and understood the above terms and conditions and that we shall abide by them if the work is awarded to us.

Signature & Seal of the Tenderer

ARTICLES OF AGREEMENT

THIS AGREEMENT is made on this day ofmonth of between Indian Bank and having its Zonal Office at 10/379, Rameni Tarauns,, HAMIRPUR – 210301(hereinafter referred to as the “Employer”) which expression shall include its successor, legal heirs and assignees of the one part.

AND M/s. Having its office at (Herein after referred to as the “Contractor”) which expression shall include its successor, legal heirs and assignees of the second part.

WHEREAS the Employer has caused drawings and tender documents for ‘Interior Furnishing, Electrical & Data Cabling Works in New Premises of Bhandara Branch, District – MAHOBA”

AND whereas the Employer has called for tender vide ref. no. dated.....

AND whereas the contractor has submitted the tender ref. no. dated to the Employer on

AND whereas the Employer has issued the work order ref dated..... to the contractor to do the work.

AND whereas the Contractor has agreed to execute the work as per drawings, specifications, conditions of contract and Work Order.

AND whereas the Employer has accepted the Contractor’s tender as aforesaid and whereas the tender submitted by the contractor has been accepted for such sum as may be ascertained to be payable in terms of the Bill of Quantities and which sum is estimated to be Rs. (Rupees) herein after referred to as the said “Contract Agreement”.

NOW THIS AGREEMENT WITNESSETH AS FOLLOWS:-

- 1) In consideration of the said Contract Sum to be paid at the times and in the manner set forth in the said Conditions the Contractor shall carry out and complete the Works in terms and conditions herein contained and according to the general conditions of the contract, notice inviting tender, special conditions of contract, general scope of work, technical specifications, schedule of rates and instructions to be given by and the supervision of and to the entire satisfaction of the Employer.
- 2) **Contract Price, Taxes and Payment Terms :**
Total contract price is Rs. which is inclusive of cost of materials, equipment, installation charges and tools and tackles required for execution of the job. Above price is inclusive of all taxes & duties including excise duty, GST, income tax, octroi etc. in respect of this contract. No claim in this respect will be entertained. Income tax on payments will be deducted and deposited by Employer in accordance with the sales tax law of the state and the provisions of tax deductions at source under income tax act 1961.
- 3) **Completion Period:**
Time is the essence of the Contract. The work is to be completed in all respects within **25 days** reckoned from 5th day from the date of issue of the Work Order or handing over of site whichever is later. If the Contractor fails to complete the job within the agreed time period the Contractor will have to bear liquidated damages as per the relevant clause mentioned in the Tender Documents.

- 2) **Earnest Money:**
The Contractor has deposited an amount of **Rs.6,000/- (Rupees Six Thousand Only)** as earnest money.
- 3) **Inspection of Site:**
The Contractor has inspected the site before submitting his tender and has satisfied himself as to the nature of the work to be executed on the site. Any difficulties which the Contractor may come across in the course of the work shall in no way relieve the contractor to claim or receive extra payment unless the Employer is of the opinion that such difficulties could not have been foreseen and the Employer consents in writing.
- 4) **Supply of Material and Labour:**
The Contractor shall arrange all labour, materials, equipments, tools, tackles and everything necessary for the completion of the work. The Contractor will assume all responsibility for the safety, protection and accounting of all material and equipment and the work during construction. All materials used by the Contractor shall be of the best quality conforming to the required specification mentioned in the tender document and will be subject to the approval of the Employer. All such materials not approved by the Employer shall be removed at once by the Contractor at his own expense. The Contractor shall also at his own expense arrange for carrying out any test of materials which the Employer may from time to time require or if so desired by the employer.
- 5) **Defective Work / Materials:**
If any part of the work done by the Contractor is found defective in workmanship or if bad or inferior materials have been used the Contractor shall at his own risk and cost demolish all such defective work and rebuild the same and / or replace the bad or inferior materials used within a time frame mentioned to the satisfaction of the Employer. The decision of the Employer in this regard shall be final and binding on the Contractor. In case of default of the contractor to remove the defective work and rebuild the same or replace bad or inferior materials as directed by the Employer, the Employer shall be entitled to employ anyone else to carry out the same at risk and cost of the Contractor and recover all expenses incurred in this regard from the contractor.
- 6) **Inspection of Work:**
During progress of the work the Employer shall be entitled at all times to have access to and inspect the work.
- 7) **Supervision:**
The Contractor shall provide one or more competent and technical qualified engineers duly and fully authorized to act on his behalf in all matters relating to the works to be carried out under or any other matter concerning this agreement and who shall at all times be present at the works while any work is in progress as per directions, explanations & instructions of Employer.
- 8) **Compliance with Statutory Regulations & Work Rules:**
The Contractor shall be responsible for complying with the applicable laws / bye laws / Regulations in force from time to time and shall have to bear all statutory liabilities to the workers / personnel engaged for the job. Nothing will be paid extra in this regard. If any amount is paid by the Employer with this regard the same amount shall be deducted from the Contractor's dues. The Contractor shall have to arrange insurance cover for the workers / personnel engaged by him for the job.
- 9) **Determination of Contract:**
In the event of Contractor failing to keep / adhere to agreed schedule of work, or in the event of the Contractor failing to comply with the provisions of this contract by default and / or negligence and / or suspension of work or in the event of Contractor failing to complete the work within the stipulated period, the Employer may terminate this Agreement forthwith and employ, at the Contractor's risk and cost, another contractor or sufficient number of workmen to complete the work.



10) **Force Majeure:**

This clause will be operative only if the work is delayed by

- a) Acts of God
- b) Earthquake or floods or similar natural calamities.
- c) Serious loss or damage by fire or lightning.

In case any Force Majeure condition herein mentioned occurs and continues for a period exceeding 15 days the parties hereto undertake to sit together and devise ways for expeditious and proper performance of the obligations of the parties under this order.

11) **Arbitration:**

“ In the event of any dispute or difference relating to interpretation and application of provisions of the contract and all disputes/claims whatsoever which shall either during the continuance of the contract or afterwards either between the parties to the contract or the respective representatives touching the construction/application of any provision/clause mentioned in the contract or any account or liability between the parties to the contract or as to any act or deed or omission of any party to the contract, in any way relating to these presents, shall be first at the discretion of the Bank attempted to be resolved in good faith by mutual discussion within 30 days of the dispute or question being raised failing which the same shall be settled by arbitration in accordance with provisions of Indian arbitration and Conciliation act 1996.

The Parties concerned shall designate an arbitrator on mutual consent/consensus. The venue of the arbitration shall be exclusively at HAMIRPUR and any award passed by arbitrator shall be final, conclusive and binding upon the parties and shall be deemed to have been made between parties themselves. The parties to the dispute shall share equally the cost of arbitration as intimated by the arbitrator”.

IN WITNESS whereof the said contracting parties have set their hands and seals on the day and year first hereinabove witness.

Witness Address

Employer

Witness Address

Contractor

List of Materials of Approved Brand And/ Or Manufacture

S.NO.	MATERIALS	APPROVED BRANDS
1	False Ceiling & Cornices	India Gypsum, Armstrong
2	Aluminium Fram	Jindal, Hindalco
2	Wood Framework: All wood must be well seasoned, free from knots, other defects.	Meranti (seasoned) with two coats of wood preservative
3	Wood skirting /mouldings, Lipping /beading	Steam beech/ Mahogany/ Teak wood
4	BWP Marin Ply wood (IS: 710)	Green ply/ Archid/ Century
5	Laminate	Century/ Archid/ Greenlam/ Summica
6	Veneer	Century/ Archid/ Greenlam
7	Wood Preservative	STP- Pentaphene pale / Termination Tor (Pidilite)
8	Adhesive	Fevicol SH (Pidilite) / Araldite/SR- 998/ Century – SH
9	Door Closer	Dorset/ ozone/
10	Floor Spring	Dorma/ ozone
11	Door Lock	Ozone / Hattich/ Godrej
12	Drawer Lock	Ozone / Hattich / Godrej
13	Hardware	GKW
14	Hinges	Ozone / CIEF/ Ebco
15	Screws	GKW/ Nettle fold
16	Carpet	Interface/ Shaw
17	Vertical blinds	MAC decor/ Vista levolor
18	Sun Control Film	3M or equivalent
19	Soft Board / Display Board	Jolly board
20	Paints	Berger/ Asian/ Nerolac
21	Texture paint	Spectrum/ Oikos
22	Ceramic Tiles	Orientalbell , Nitco, , Kajiria
23	Vitrified tiles	Orientalbell , Nitco, , Kajiria
24	Glass & Mirror	Modi Guard/ Saint gobain, Ashai
25	Handle	Stainless steel finish Neki / Hassely/ Hattich
26	MDF Boards	Greenpanel max/ Archid/ Merino
27	Wooden flooring	Green panel max, Archid, Pergo
28	PVC flooring	Armstrong/ Krishna vinyl
29	Sanitary fittings	Toto/ Roca/ Kohler/ Grohe / Jaquar
30		AFC/ Monarch/ PSL/ SPACEWOOD/ STEELCASE

S.NO.	MATERIALS	APPROVED BRANDS
1	PVC fittings	Polycab/ AKG / Precision
2	Wires – PVC insulated copper	Finolex/ Rallison/Polycab/Skytone
3	Cables (armored)	Gloster / Rallison / Havells
4	A.C Starter, Plug Socket	Crabtree / Northwest/ Legrand
5	Light & Power switch socket	Crabtree / Northwest /Philips
6	Telephone Socket	RJ-11 Crabtree/ Philips/MK
7	DB MCB	Legrand/ Hager/ Standard/ Schneider
8	MCB	Legrand/ Havells/ Hager/ Schneider
9	Telephone cable	0.51 Netco / Delton / National
10	Light fitting	PHILIPS/Wipro/Havells
11	Fuse Switch	L&T / Havell's
12	Telephone Connector	Corn
13	Ceiling/ Wall fan	Crompton / Orient / Khaitan
14	Exhaust fan	Crompton / Orient / Khaitan
15	P.V.C tape	Steel Greep
16	Call bell	Max
17	Cable Lug	Dowell's
18	Cable gland	Brass heavy type good quality
19	Distribution board	L&T/ Havells,legrand
20	MS conduit	Heavy duty with ISI mark 16 SWG
21	Starter & single phasing preventer	SEIMENS
22	SPN, TPN, Sheet metal	Havell's / Legrand
23	Pipe Metal	M.S Conduit 16 S.W.G
24	Metal Pipe Fittings	Cast iron with thread & inspection cover
25	Pipe PVC (Rigid Conduit)	AKG / Polypack/Super/Precision
26	PVC fitting for Rigid	-Do-

27	PVC Roll Pipe	Super Dalda or equivalent heavy guage
28	PVC Casing & Casing Fittings	Good quality heavy guage (colour white)
29	Lugs	Dowells
30	Terminals	Essen/Elmex
31	Burglar alarm	Godrej/ Globe detective
32	E-cat 6 Patch panel	Schneider Electric/ Avaya
33	P.A. System	Bosch/ Ahuja
34	CCTV camera	Sony/ Bosch
35	CCTV camera wiring	Crompton/ KEI
36	UPS wiring	Crompton/KEI
37	Aluminum ducting sheet	Jindal/ SAIL
38	AC	Blue Star/ Hitachi/ Daikin Only Copper Coil (Minimum 3 Star rated)

Note –

1. In case of unavailability of any material of specific make an equivalent make can be used only after a written approval of architect/bank. The preference of make/brand of the material listed above will be decided by the architect/Bank. The make/brand of any item will be as mentioned in the drawings issued by the architect.
2. The contractor shall provide samples of all materials in the list of makes as required by the architect. A written approval of these samples shall be sought prior to commencement of any work. Architect/Bank reserves the right to enquire the genuineness of any material used at site directly from the manufacturer
3. Preference of makes, supply of items should be consulted with client/consultant before effecting of supply.
4. Other materials: ISI mark & approved by the Bank.

NAME AND ADDRESS OF THE CONTRACTOR:

SIGN & SEAL OF THE CONTRACTOR:

Date:

Place:

SCHEDULE OF QUANTITIES
INTERIOR FURNISHING WORK IN NEW PREMISES OF INDIAN BANK
BHANDARA BRANCH, DISTRICT - MAHOBA

S NO	DESCRIPTION OF ITEM	UNIT	QTY	RATE (Rs.)	AMOUNT (Rs.)
A	SCHEDULE - 'A' (FURNISHING WORK)				
2	PARTITIONS WORK				
2.1	FULL / LOW HEIGHT SOLID PARTITION	Sq Ft	60.00		
	Full ht. Solid Partition including flush door & strong room partition up to 7' only WITH LOUVRE :- Providing and fixing solid partition, the framing shall made out of aluminum hollow section of 65mm x 37mm size 1.5mm thick of JINDAL / INDAL as internal frame structure placed horizontally & vertically at max distance of 2'-0" x 2'-0" center to center. Fixing 6 mm thick commercial ply on both sides with 1.0mm thick laminate on top of approved shade with groove pattern as per instructions of Architect. The rate shall include the cost of providing skirting of 100mm wide lined with 1mm thk laminate and providing & fixing a border at top of 100mm wide lined with 1mm thick laminate complete. Laminate Should be considered up to two or three color combination. The edge beadings with steam beach wood should be finished with melamine polish if required, frame work above false ceiling done shall not be measured but contractor may factor it while quoting their rates as measurement up to false ceiling level.				
	The rate inclusive of providing & fixing of required flush door of 37mm thick approx. with 1.0mm thick laminate both side with steam beech wood chow-khat of size 75mm x 65mm approx and Item includes Heavy-duty SS ball bearing butt hinges 100 x 5.5 mm (4 Nos. per shutter) with screws etc. The shade of laminate finish to be got approved from Bank. . All as per the design and instructions Bank.				
	Note: - For the purpose of payment partition shall be measured including the area of door/door frames up to false ceiling height.				
	Framework shall be rigidly secured to floor, bottom of slab & existing walls at 2'-0" c/c with dash fasteners.				
2.2	Single skin partition	Sq Ft	0.00		
	As of the above but Providing and fixing single skin partition above false ceiling (where false ceiling is provided only on one side) for a height of up to 600mm or near about soffit of roof using aluminum frame as specified above along with 6mm thick Commercial ply wood lined on only one side and lining with 1mm thick laminate of approved shade and make along with grooves.				
2.3	Full height Glazed partition Manager Cabin	Sq Ft	300.00		
	Same as of Solid ht. partition, providing 8mm thick Modi/saint Gobin float glass above 1'-0" / 3'-0" & up to 7'-0" fixed with steam beech wood beading of finished size 1 1/2" X 1" all along the edge. All edge-to-edge glass joint to be machine cut and polished and sealed with silicon sealant joint shall be located strictly as shown in the drawing. All exposed woodwork to be melamine polished. Item includes frosted/striped/designer glass film of 3m, Avery Dennison or equivalent (basic rate of Film Rs. 50/ Sq Ft) on existing glass as per manufacturer's specifications. All as per the				

	design and instruction Bank.				
2.4	Single window Partitions	Sq Ft	150.0 0		
	Providing and fixing in position Double skin partition 7'-0" height. The framing shall made out of aluminum hollow section of 65mm x 37mm size 1.5mm thick of JINDAL / INDAL as internal frame structure placed horizontally & vertically at max distance of 2'-0" x 2'-0" center to center. Fixing 6 mm thick commercial ply on both sides with 1 mm thick laminate of approved color and shade as per approval of the Architect. The partition to include 8 mm. thick Modi Float glass with etching on the sides and back including a door 3'-0" wide as per the approval with all necessary hardware, night latches etc. All exposed edges to be covered with steam beech wood Beading, 4mm grooves in places as per design duly melamine polished inclusive of all materials, hardware, night latches, labor, T&P, taxes, levies, etc. completed to the satisfaction of the bank & drawing.				
2.5	Low. Height Semi Glazed Partition	Sq Ft	30.00		
	Same as above but of Low height as per design including 10mm Toughened glass with edges polished to be used. All other specs are same as of above, Edges of the partition to be covered with 3" X 1.5" Steam beech wood duly melamine polished molding. 38mm thick flush door: wicket gate also shall be included for a measurement. All as per the design and instruction bank.				
2.6	Front Glazing In head cash cabin & SWO	Sq Ft	15.00		
	Providing & fixing 10mm thick toughened clear float glass to shape for front side of the cash counters including cutting the holes and providing & fixing TW beading polished and tinted to approved shade. (Including SWO/Chief Cashier front Glass).				
2.7	Aluminum grill on the ceiling of Cash cabin	Sq Ft	35.00		
3	DOOR & ACCESSORIES				
3.1	Main Entrance Door & Fixed glazing	Sq Ft	100.0 0		
	Providing and fixing aluminum entrance doors with 12mm float glass (3M frosted sticker) as/design with top & bottom section of 45 by 90mm , 2mm thick section of hindalco/indal anodized in approved color with 25 micron anodizing along with SS C shaped handles of kitch or equivalent make along with floor spring of hemco/everite make. The item also includes door lock completed to the satisfaction of the architect.				
3.5	Supplying and fixing of Dorma/GEZE Dline / Hardwyn/Godrej or approved equivalent Door Closer for wooden door for Branch manager, Banking hall, Chief Cashier, Dinning, UPS, Toilet	Nos	4.00		
3.6	Supplying and fixing of mortice door lock of hardwyn make HML-480 Lock Body 304 Stainless Steel. (in BM Cabin , Store room 0. Cash cabin shall be Godrej Night latch. (atm 1 No.)	Nos	4.00		
3.7	Supplying and fixing of door stopper SS Grade 304, HESSF-2C hardwyn make.	Nos	6.00		
4	WORKING COUNTER				
4.1	CASH COUNTERS	Rft.	5.00		
	Providing and fixing Chief Cash Counter in split-levels @ 2'-6" (height 750mm) & 18" (1140mm) with 2'-6" & 15" wide each respectively. Upper levels having 12mm thick frosted toughened glass (i/c taxes and transportation). Edges of 18" wide counter				

	shall be 12mm thick frosted toughened glass. Lower tier shall be made of 19 mm thick ply wood finished in 1.5mm thick laminate. Exposed edge having steam beech wood edging of size 1 ½" x 1". Vertical face shall have 12mm thick frosted toughened glass as per requirement of design. All exposed surfaces shall be finished with 1.0mm thick laminate of approved shade and color.				
	1 no. prefabricated metal computer key board tray including drawer slides 12.5" x 22" tray with 14" telescopic slides including L – brackets for securing to the table top. Chest of drawers (size 1'-4" x 2'-0" x 2'- 5") made of 19mm thick commercial ply wood having three drawers finished with 1.0mm thick Laminate on all sides. Each drawer shall have locking system and 6" long S.S. brushed finished handle, drawer slides etc. of approved make. All exposed edges of ply wood sealed with Steam beech wood beading of size ¼" x ¾". All beading and exposed wood shall be melamine polished and the Internal surfaces shall be .75 mm thick laminate. Item includes readymade metal powder coated CPU trolley, grommet, footrest for each seat. All complete as per approval and instructions of the Architect / employer. The rate also include providing and fixing painting a foot rest using hard wood 100 x 25mm size 1st class seasoned country frame.				
	Payment will be made only on the centerline measurement. The rate shall include the cost of providing skirting of 100mm wide lined with 1.0mm thick laminate and providing & fixing a border at top of 100mm wide lined with 1.0mm thick laminate complete. The Internal surfaces shall be .75 mm thick laminate.				
4.2	RUNNING COUNTER	Rft.	4.50		
	Providing and fixing staff counter/SWO in split-levels @ 2'-6" (750 mm) & 3'-1" with 2'-6" (750 mm) & 9" wide each respectively. Upper levels having 1 mm thick laminate with 19 mm thick commercial ply top. Lower tier shall be made of 19mm thick ply wood and finished in 1 mm thick laminate. Working top having steam beech wood edging of size 1 ½" x 1". Vertical face shall have 19 mm thick commercial ply over pine wood framework as per requirement of design. All exposed edges of ply wood sealed with Steam beech wood beading of size ¼" x ¾". All exposed surfaces shall be finished with 1.0mm thick laminate of approved shade.				
	The item includes Chest of drawers (size 1'-4" x 2'-0" x 2'- 5") made of 19mm thick commercial ply wood having One drawers at top and a storage cabinet below having shutters of 19mm thick ply wood finished with 1.0mm thick Laminate on all sides. 1 no. prefabricated metal computer key board tray including drawer slides 12.5" x 22" tray with 14" telescopic slides including L – brackets for securing to the table top for each seat. All beading and exposed wood shall be melamine polished and the Internal surfaces shall be .75 mm thick laminate. Item includes 1'-3" high 12mm thick toughened glass above upper tier and readymade metal powder coated CPU trolley, grommet, foot rest for each seat. All complete as per approval and instructions of the Architect / employer. The rate also include providing and fixing painting a foot rest using hard wood 100 x 25mm size 1st class seasoned country frame. Payment will be made only on the centerline measurement.				

	The rate shall include the cost of providing skirting of 100mm wide lined with 1.0mm thick laminate and providing & fixing a border at top of 100mm wide lined with 1.0mm thick laminate complete.				
5	TABLE & FURNITURE				
5.1	MANAGER TABLE (Size:- 6'-0" x 3'-0") ht. 2'-6"	Nos	1.00		
	Providing and fixing tables made out of 19 mm thick commercial ply over hard wood frame work finished with 1 mm thick laminate of approved shade. Top having steam beech wood edging of size 2" x 1 ¾". 10mm thick clear float glass with beveled edges shall be provided on the finished to 19mm thick Comm.ply wood of approved make cladded with 1mm thick. Laminate (color with vertical grain) as per design in all visible areas. All the exposed edges to be covered with wooden steam beech lippings and mouldings duly melamine polish. The drawers to be made out of 19mm thick ply wood with 1.0 mm laminate finish in the front, and bottom to be made out of 6mm plywood and it should play in drawer sliding telescopic channels. The inside of the drawer shall be .75 mm thick laminate. & Table back side will be 1mm laminate. A leg rest to be provided duly polished made out of 3"x2" Wooden Section. The rate inclusive of providing &fixing wooden cabinet to suit the DVR for size 2'X6"X1'9" or as per the requirements)				
	A shutter to be made by 19mm ply wood cladded with1.0mm laminate .The necessary locks handles to be provided in each drawers and shutters. 3" x 1/2" wooden skirting to be provided in all visible areas duly polished. The necessary wire managers (SS) to be provided on the tables and provision for lights to be kept if required in the front of the table. All the exposed areas to be duly melamine polished The work to be completed as per design and approval of the Bank. The table should have key board tray and CPU Trolley to be Modular. All as per the design and instructions Bank the Internal surfaces shall be .75 mm thick laminate.				
5.2	Officer TABLE (Size:- 5'-0" x 2'-6") ht. 2'-6" as per above specification	Nos	1.00		
	without glass top				
5.3	Server TABLE (Size:- 5'-0" x 2'-0") ht. 2'-6" as per above specification	Nos	0.00		
	without glass top				
6	STORAGE & SIDE UNIT				
6.1	Side and Back Unit				
	Providing and fixing Side Unit/ Back unit 400 mm depth made out of 19mm ply wood finished with 1.0mm laminate in all exposed areas and top shall be 1 mm thick. The drawers to be made out of 19mm commercial plywood and cladded with 1.0mm laminate and bottom made out of 6mm common ply duly painted in matching tone and it should play on drawer sliding channels. The shutters to be made out of 19mm commercial ply wood and should play on drawer sliding castors on powder coated channels. The necessary locks, handles, etc to be provided. 3" x1/2 wooden skirting to be provided duly polished as per matching tone all along the visible areas. Inside of the unit shall be .75 mm thick laminate in matching tone. All the exposed edges	Nos	2.00		

	of the boards/ply woods to be covered with wooden lippings/mouldings duly polished all complete. The work to be completed as per approval and specification of the Architect.				
6.2	Low HT cabinet & pantry cabinet	Sq Ft	40.00		
	Providing and fixing Full /Low height Cabiner400mm deep made out of 19mm thick plywood finished with 1.0mm laminate in all exposed areas. The Shutter to be made out of 19mm ply wood in the front clad with 1.0mm laminate(color, vertical grain) and bottom made out of 6mm plywood duly painted in matching tone and shelves 19mm thick common ply wood to fixed inside storage. The shutters to be made out of 19mm ply wood. The necessary locks, handles, etc to be provided. 3" x1/2 wooden skirting to be provided duly polished as per matching tone all along the visible areas. Inside of the unit shall be .75 mm thick laminate finish. All the exposed edges of the boards/ply-woods to be covered with wooden lippings/mouldings duly polished all complete. All as per the design and instructions Bank.				
6.3	Main Electrical Panel Cabinet	Sq Ft	35.00		
	Providing and fixing of DB Shuttering formed of 12mm thick plywood wood on 12mm thick Gypsum board (fire Proof) with finish as per Item no 1 for inside and outside shutters finished with laminate on outer surface with SS (4Nos) louver perforation and necessary hardware, hinges etc complete as per details. All as per the design and instructions Bank. Only front face used for measurement only				
7	OTHER MISCELLANEOUS ITEMS				
7.1	PIN UP / NOTICE BOARD				
	Providing and fixing soft board with necessary framework with 12mm BWR plywood on top 12 jolly boards to be fixed finished with fabric @Rs80, with necessary mouldings duly polished along the periphery. All as per the design and instructions Bank.	Sq Ft	24.00		
7.4	WRITING LEDGER & Cheque & suggestion box	NO	1.00		
	Providing and fixing writing ledge as per design minimum 5 ft length made out 19mm comm. board with necessary grove patterns with 1.0mm laminate. 10mm thick machine polished glass to be provided on top of the writing ledge. Small boxes to be made out of 12mm comm. ply to be made on top of the writing ledge finished with 1.0 mm laminate, inside surfaces shall be .75 mm thick laminate and rate should be included providing fixing of suggestion box & Cheque deposit box as per approval of bank .The work to be completed as per design and approval of the architect.				
7.5	Cheque box	NO	1.00		
	Providing fixing of Cheque deposit box as per approval of bank .The work to be completed as per design and approval of the architect.				
7.6	Suggestion box	NO	1.00		
	Providing fixing of suggestion deposit box as per approval of bank .The work to be completed as per design and approval of the architect.				
7.7	BOXING FOR ROLLING SHUTTER				
	WITH ACP FINISH	Sq Ft	100.00		
	Providing and fixing boxing for the rolling shutters. Framing shall				

	consist of Aluminum Sections of 50 mm x 25 mm @ 600mm C/C. Both ways horizontally and vertically on the wall / with Aluminum Sections of 2"x1" as directed by Bank / Architect. This framing would be covered by with 2mm thick "Aluminum Composite Panel". The rate shall inclusive of necessary fixtures and fittings, sealant etc. complete.				
	Note : rate shall include all necessary hardware fittings, etc.				
7.8	WOODEN PANELLING	Sq Ft	50.00		
	Fabricating and fixing wall/column paneling, the framing shall made out of aluminum hollow section of 65mm x 37mm size 1.5mm thick of JINDAL / INDAL at spacing not exceeding 600mm both ways (horizontal and vertical). Paneling framework to be secured to wall surface/column surface. Paneling framework to be clad on one side with 9mm thick ply finished with 1.0mm thick laminate including skirting of 100mm high & 12mm x 12mm groove at skirting level. All as per the design and instructions Bank.				
7.7	ROLLING/ VERTICAL BLINDS	Sq Ft	40.00		
	Providing and fixing Roller blinds of approved design and shade by the Architect, incl all std fittings as per manufacturer's specification. The work to be completed as per specification and approval of the architect. (approved brand Vista, Hunter Dogulus)				
7.8	Customer Table - (4'-0" X 2'-6")	No	1		
	Providing and making a table of overall size of top as mentioned above. It shall consist of ¾" thick. Comm. Ply top as per design (double edge on outer edge with 1 1/2" thick half moulding on the edges) supported on ¾" thk. Comm. Ply verticals supported on wooden base (as designed by the architect). Suitable wooden moulding as architect design with melamine shall be provided to the edge of the top. All external surfaces to be finished in 1 mm laminate. & the Internal surfaces shall be .75 mm thick laminate.				
	GRAND TOTAL FOR FURNISHING (A)				

SCHEDULE OF QUANTITIES
**ELECTRICAL & DATA CABLING WORKS IN NEW PREMISES OF INDIAN BANK
BHANDARA BRANCH, DISTRICT - MAHOBA**

S. No	DESCRIPTION OF WORKS	UNIT	QTY	RATE Rs	AMOUNT Rs
B	SCHEDULE - 'B' (ELECTRICAL WORK)				
1	ELECTRICAL WIRING & EARTHING				
1.1	Supply, laying, connection & testing of light, fan point, wiring by 2x1.5 mm sq (2x3/.029) +1x1mm sq PVC insulated, multi-strand single core copper conductor FRLS wire maintaining the color code as per direction in PVC conduit of 20mm with ISI mark 1.5mm thickness to conceal in wall partition mending good the damage, complete with PVC circular box, bend to be done as per drawing including 3 point ceiling rows wherever required GI saddle to be used for fixing, metal flexible/PVC flexible pipe may use if required in partition wall. All PVC pipes should be with ISI mark. No joints will be allowed inside pipe, light, fan & plug point complete with modular type switch plate & MS box rate Including the main circuit line 2x2.5 mm sq + 1x1.5 mm sq earth PVC insulated Cu. Wire from DB to switch board, maintaining the color code. Circuit line for lighting switch board & 6Amps plug board are to be drawn from lighting DB to Lighting board & plug point board (independent), 6/16 Amps plug point line are to be draw from power DB as per DB schedule /SLD				
a)	1 light by 1 switch	Nos.	24		
e)	Ceiling fan point with step type electronic regulator	No	12		
f)	Same as above, but for exhaust fan excluding regulator.	No	3		
g)	Same as above 5A Point in the switchboard itself.	No	8		
h)	same as above Wiring for call-bell point including buzzer	No	1		
i)	Wiring (2x2.5mmsq+1x1.5mmsq from power DBs) for independent 6A multi pin socket at walls along with 6A modular type switches board housed in painted MS box (up to 3 independent plug points can be taken in one circuit). For wall Fan	No	1		
1.2	Supply and installation of modular type 2 nos 6A & multi pin sockets with 2 nos 6 Amp one way switch housed in MS box to be fixed in partitions or concealed in wall. The box shall be painted with 2 coats of enamel paint over a coat of red oxide primer including wiring for Raw power socket outlet using 2 R runs of 2.50 Sq mm and single run of 1.5 sq mm PVC insulated multi stranded single core copper conductor FRLS wire in 20mm PVC conduit to be laid in floor, partitions, etc. complete with all accessories (looping 2 sets of 2x6A socket outlet in one circuit- from DB) (Raw power) for counter (Each counter 1 Nos +BM :2 Nos, ATM 1No., Pantry 1No.:)	No	4		
1.3	Supply and installation modular type 16A, 5-pin socket with 16A one way switch housed in MS box to be fixed in partitions or concealed in wall. The box shall be painted with 2 coats of enamel paint over a coat of red oxide primer, the rate shall include wiring fusing 2R 4.0 sq mm & single run of 2.5 sq mm PVC insulated multi stranded single core copper conductor FRLS wire in 25mm PVC conduit to be laid in floor, partitions, etc complete with all accessories (for line printer: or optional)	Nos.	6		

	(up to 2 independent plug points can be taken in one circuit) C.C:1No. BM.;1 No.: Alternative counter 2No + Banking Hall 1 No+ Pantry 1No, ATM :1No)				
1.4	Supply and installation of power supply disconnection arrangement for strong room consisting of 1 no 10A DP MCB housed in manufacturer's powder coated MS box to be fixed inside the strong room and connected with 1 no 3-pin metal clad plug with 2 meter long 3 core 2.5 sq mm PVC insulated flexible copper conductor cable.	Set	1.00		
1.5	AC electrification :-				
(a)	Supply and fixing 25 Amps 3-pin modular socket with 25 Amp one way switch with indicator (near AC indoor unit) housed in manufacturers MS powder coated box to be concealed in wall including Wiring using 2R4.0 sq mm & single run of 2.5 sq mm PVC insulated multi stranded single core copper conductor FRLS wire in 25mm PVC conduit to be laid in floor, partitions, etc complete with all accessories. (for split AC units) -(from Stabilizer to IDU) Supply. (2 Nos for ATM), Stabilizer to be installed in the panel room.	Nos	4		
(b)	Supply and fixing 25 Amp - 3 pin metal clad socket with plug controlled by a 25 Amp SP MCB (for Ac wall mounted stabilizers) housed in manufacturers MS powder coated box to be concealed in wall including Wiring using 2R 4.0 sq mm & single run of 2.5 sq mm PVC insulated multi stranded single core copper conductor FRLS wire in 25mm PVC conduit to be laid in floor, partitions, etc complete with all accessories. (for split AC units) from AC DB to Stabilizer (2 Nos for ATM)	Nos	4		
2	LAYING OF CABLE :				
2.1	Supply laying fixing main power with 50mm sq 3.5 core PVC insulated, PVC sheated Alu. Conductor, 1100 v. grade armored cable complete with 02 nos 8 SWG bear GI wire as running earth. (Meter panel to Main Panel & Dg set to Main Panel)	Mts.	5		
2.2	End termination of 50mmsq 3.5 Core armored cable, complete with brass cable gland, Alu. Lug, PVC tape.	Nos	4		
2.3	- Do - 3.5 x 16 sq mm with 02 nos 8 SWG bear GI wire as running earth. for Light D.B	Mts	25		
2.4	- Do - 3.5 x 25 sq mm th with 02 nos 8 SWG bear GI wire as running earth. for POWER & A.C D.B , UPS & ATM	Mts	30		
2.5	- Do - termination of 25 & 16 Sq mm 3.5 Core	Nos	20		
3	Outdoor type glow sign board wiring :-				
3.1	Supply laying of main line with 2x2.5 +1x1.5 mm sq through MS conduit from main panel to glow sign board.	Mts	25		
3.2	Supply installation of 16 amps DP MCB at main entrance Glow sign board & With Electronic timer as required.	Set	1		
4	EARTHING STATION :				
(i)	Earthing installation as per I.E. rule conforming	Set	2		
	Supply, Installation, Testing and Commissioning of Maintenance Free Earthing system made up of copper bonded rod of 10 feet length, 23 mm dia. (Minimum copper bonding shall be 0.25mm) along with Rod-to Conductor connectors, Earth enhancement material, Pit Cover and other accessories as required and as per specification and other applicable codes (include chamber for earthing, Earthing certificate to be submitted along with the bill).				

(ii)	Supply laying 2x8SWG copper bear wire from earth spike to main panel. (Electrolyte wire)	Mts	20		
5	MAIN ELECTRICAL DISTRIBUTION				
5.1	Main Panel (wall Mounted Type)				
	Supply, fabricating, assembling, internal- connection, testing & connecting with incoming, outgoing power cables & lines as required completing the job of cubical type electrical panel made from 14SWG CRC. M.S. sheet with proper earthing terminal(Nut- bolt &washer) 02 No outside of panel, same nut-bolt to tighten with internal earth busbar of panel situated inside loose wire box(on top portion of panel) On top side of panel cable entry arrangement to be done for incoming & outgoing of lines. Painting powder coating electrical grey/seimens grey to be done one 6"x4" enamel type 440Volt Danger board to fix up on main panel bus-bar cover, components are as follows :-All switches are front handle operated & all MCB knob should be visual, all component to provide in separate compartment only DBs in one compartment.				
	Income - 100A 4P MCCB 25Ka with adjustable thermal & Magnetic trip unit -1 Nos				
	OUTGOINGS -				
	63 Amps 4 pole MCB. = 04 Nos.(AC & Power DB,ATM ,UPS, spare) 40 Amp 4 Pole MCB :2 nos (Lighting DB, Spare) 25 Amps DP MCB = 02 Nos.(sign board , Fire Alarm) Amps Meter 0-100 Amps with 3 Nos. CT & selector switch 96x96mm 01 Set (Changeover should be ON-LOAD type.)				
	100Amps 4pole Cu. Bus Bar. 01 Set. 100Amps 4 pole Change over switch. 01 No. 100 Amps FP MCCB 25KA as Gen - Set main incoming 01 NO.				
	Volt meter 0-500volt A.C. 50 Hz.96x96mm with selector switch. AE make. n 01 Set				
	20mmdia LED indicator lamp 03 Nos.				
	02 Amps Sliding Fuse. 06 Set.				
	150x100mm enamel Danger board 440 volt.				
	(to set on bus bar cover). 01 No.				
	RCCB /ELCB 63 AMP 1 NO				
	Cable entry from top & bottom - removable gland plates (bottom at 2 points) c/w powder coated Grey paint (two coats) with name labels for all incoming & outgoing feeders. The panel shall be complete in all respects including all accessories such as earthing bus, Air ventilators, lifting hooks etc.	Set	1		
5.2	S/F of 3 nos. 100Amps Kit kat set link type with heavy duty neutral link and making its connection from electronic meter c/w wooden board etc.	Set	1		
5.3	POWER DB & AC DB. Make standard/Legrand/ABB, Double door				
	6 way TPN MCB DB with TP MCB as incoming				
	63 TP&N MCB as main				
	16Amps SP MCB - 8 Nos (Ac :3 Nos + 2X6amp : 4Nos and 1Nos spare) + 32AMPS SP X10 NOS (Ac 3 Nos+15 Amp: 6 Nos, 1No Spare)				
	Including Neutral Bar. 01 Set	Set	1		
5.4	LIGHTING DB Make standard/Legrand/ABB				
	6 way TPN MCB DB with TP MCB as incoming				

	63A TP&N MCB as main				
	32 AMPS DB MCB 1No: For Strong room)				
	16 Amps SP MCB - 03 Nos.+ (BM +Toilet) each 1No + 1No spare				
	12 Amps SP MCB - 12 Nos. (Hall - 4Nos + Store room 1 No + External Lighting 1No.:+ Ups 1No + wall Fan 3 Nos.2 No spare)				
	Including Neutral Bar. 01 Set	Set	1		
6	UPS SYSTEM (Branch)				
6.1	UPS Main DB Supply, erection, testing and commissioning of three phase 4 WAY, TPN MCB DB double door type with "C" Curve MCBs, IP 42 powder coated for UPS with 63A 4P MCBs – 1No as INCOMER 32A TP MCBs – 3 Nos. as OUTGOING (UPS :2Nos and 1 set ,: Spare Including all interconnections & accessories etc Make standard/Legrand/ABB	Nos	1		
6.2	Supply & Fixing of 32A DP MCB in 2way SPN Db IP 20 metallic directly on wall Raw power Incoming & Out Going supply for UPS (Branch :2 Nos & ATM 1No.)	Nos	2		
6.3	UPS DB-1 & 2 combined 12 Way SPN MCB DB with 'C' curve MCBs. Incoming: 2 No. 40A DP MCB Outgoing: 8 Nos 6/10A (BM: 1+1 Nos with lighting: Server & Data Rack (1+1) Nos: C.C 2Nos with lighting :counter :2 Nos) SPO MCBs Make standard/Legrand/ABB. Respective UPS lighting to be connected.(BM, C.C, Banking hall 2Nos) or as per SLD	Nos	1		
6.4	Supply and installation of modular type 3 nos 6A multi pin sockets with 2 nos 6A one way switch with indicator housed in MS box to be fixed in partitions or concealed in wall. The box shall be painted with 2 coats of enamel paint over a coat of red oxide primer including making connections complete the rate inclusive of Supplying and running of 3 runs of 2.5 sq.mm UPS DB's to individual power station through .(looping 2 sets of 3X6 A socket outlet in one circuit / or as per SLD the following size of 660 volts grade, Finolex brand PVC insulated wire (For UPS point only).(For B.M, C.C, Server each 2Nos.) +5 Nos for Counter + Rack 1Nos)	Nos	7.00		
6.5	Supply & Laying of 4 runs of 6.0 Sq mm and 2 runs of 2.5 sq mm, PVC insulated, single core, multi-stranded copper conductor cable in suitable rigid / flexible metal conduit from Main UPS DB to auto phase shifter.	mtr	10.00		
6.6	Supply, installation, testing and commissioning of 40A rated 3 phase to single phase auto phase shifter for 3.0 KVA UPS (SLHD of Swift make)	Nos	2.00		
6.7	Supply & Laying of 2 runs of 6.0 Sq mm and 1 run of 2.5 sq mm, PVC insulated, single core, multi-stranded copper conductor cable in suitable rigid PVC conduit from auto match phase shifter to UPS unit	mtr	10.00		
6.8	Supply and Installation of Modular type 2 X 20A plug & socket housed in for UPS output control (Branch 2 Nos)	Nos	3.00		
6.9	Supply & Laying of 2 runs of 4.0 Sq mm and 1 run of 2.5 sq mm, PVC insulated, single core, multi-stranded copper conductor cable in suitable rigid / flexible metal conduit from 3 KVA UPS to UPS DB	mtr	10.00		
XI	Inverter Point wiring				
1.0	Point wiring for 15/16 amp socket (FOR INVERTER) outlet with 4.0sq.mm FR PVC insulated single core multi-strand copper	No	6.00		



	conductor ISI marked in recess 20 mm dia non metallic PVC flexible conduit with 15/16 Amp, 250 V modular type switch & socket, phenolic laminated sheet suitable size ISI marked MS Box & earthing Point with 1 x 1.5 sq.mm FR PVC insulated single core multi-strand copper conductor for loop earthing etc as required as per direction of Engineer in charge. (Make of wire Finolex/ L &T /Anchor / Havells/ V guard/HPL, Make of switch & socket, bell push- Anchor/ Havells/ Legrand/ Wipro)				
2.0	Recessed wiring to sub main in 1 x 1.5 sq mm (FOR INVERTER) FR PVC insulated single core multi-strand copper conductor of ISI marked confirming to IS-694/1990 in 20 mm dia non metallic heavy duty flexible conduit 1.6 mm thick as per direction of Engineer in charge(Make of wire Finolex / L &T / Anchor / Havells/ V guard/HPL, Make of switch & socket, bell push- Anchor/ Havells/ Legrand/ Wipro)	Mtr	25.00		
3.0	Supply and fixing of 16 Amp Top (for inverter installation)with all accessories and connections as per instruction of Electrical Engineer-in-charge	No	2.00		
8	ELECTRICAL FITTINGS (S/I/T/C)				
8.4	TUBELIGHT - LED TUBELIGHT 36 W, LHLDCNVENL8Z018, PHILIPS/WIPRO MAKE. ATM 1 No	Nos	24		
8.5	HANGING LIGHT - LHECDOL5PW1W040 (40WATTS), PHILIPS/WIPRO MAKE	NOS.	2		
8.6	150 mm dia Heavy Duty Exhaust fan 230 volt A.C. (Havells / Crompton make).(UPS & Toilet)	Nos	3		
8.7	Steel body Wall mounting fan 450 mm dia 230 volt A.C. Crompton /PHILIPS/WIPRO MAKE	Nos.	1		
8.8	Supply of Ceiling fan with 1200mm sweep, double ball bearing motor, capacitor, three MS blades die cast Al housing in stove enameled white with, suspension rod including all accessories of approved make. (5 star rated) (ORIENT/KHAITAN) (UPS, Strong room & Store room)	Nos.	12		
	TOTAL FOR ELECTRICAL WORK (B)				

C	SCHEDULE - 'C' (LAN WORK)				
S NO	DESCRIPTION	UNIT	QTY.	RATE	AMOUNT
2.0	DATA SYSTEM - CONDUITING & CABLING				
2.2	Wiring for computer networking from I/O hub to computer workstation with UTP Cat-6 computer cable including providing ferrules at both ends and termination at both ends including providing & fixing frame for with shutter, RJ 45 outlet, faceplate and mounting box complete of modular type, This work includes providing PVC conduits (1/2", 3/4" size or as required) in chases from the I/O hub to the point. The cost includes testing, commissioning etc complete. Note: Do not run more than 3 wire in single pipe & should be concealed. (Server, BM, CC & ATM each 2Nos and counter 5Nos)	Nos.	6		
2.3	Supply of Cat - 6 D-Link patch cord 7' 0" (ATM 1No)	Nos.	6		
2.4	Supply of Cat - 6 D-Link patch cord 3' 0"(ATM 2No)	Nos.	6		
2.5	Supply & fixing 24 Port Jack Panel Make:-D-Link	Nos.	1		
2.6	19" Rack 9U with Glass Door , Locking system Make: APW	Nos.	1		
2.7	24PORT 10/100Mbps Switch	Nos.	1		
	GRAND TOTAL FOR LAN & TELEPHONE (C)				
	GRAND TOTAL-B+C				

Place:

Signature & Seal of the Tenderer

Date:

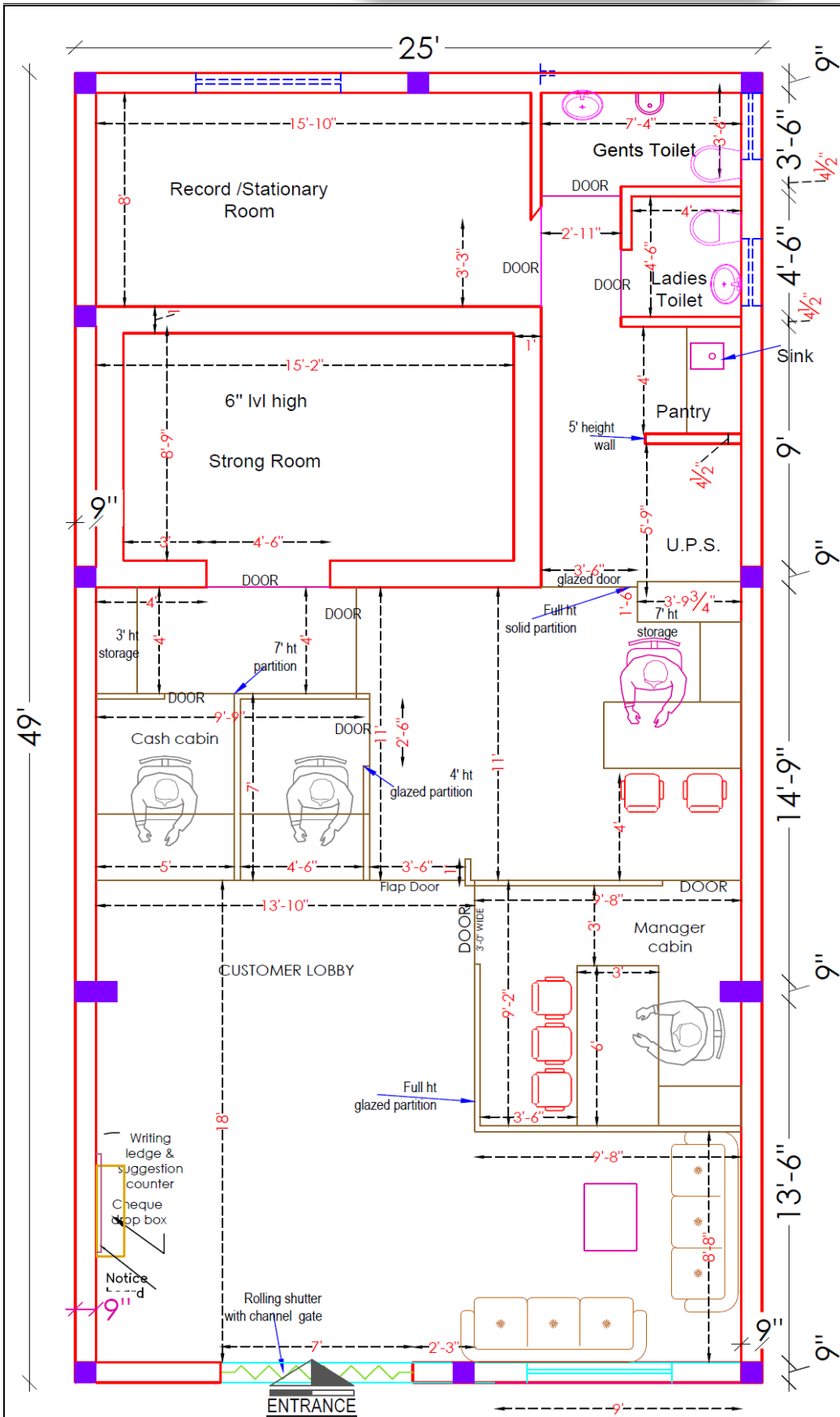

PROJECT
PROPOSED FURNITURE LAYOUT PLAN OF INDIAN BANK
BRANCH AT BHANDARA -DISTRICT-MAHOBA

DRAWING
FURNITURE
LAYOUT

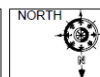

SCALE
N.T.S.
DATE
JAN-2024

ARCHITECT
MOHIT & ASSOCIATES
ARCHITECTS, INTERIORS, ESTIMATORS
L-2-554 VINEET KHAND GOMTI NAGAR
LUCKNOW, M.O. -958218892, 742811959

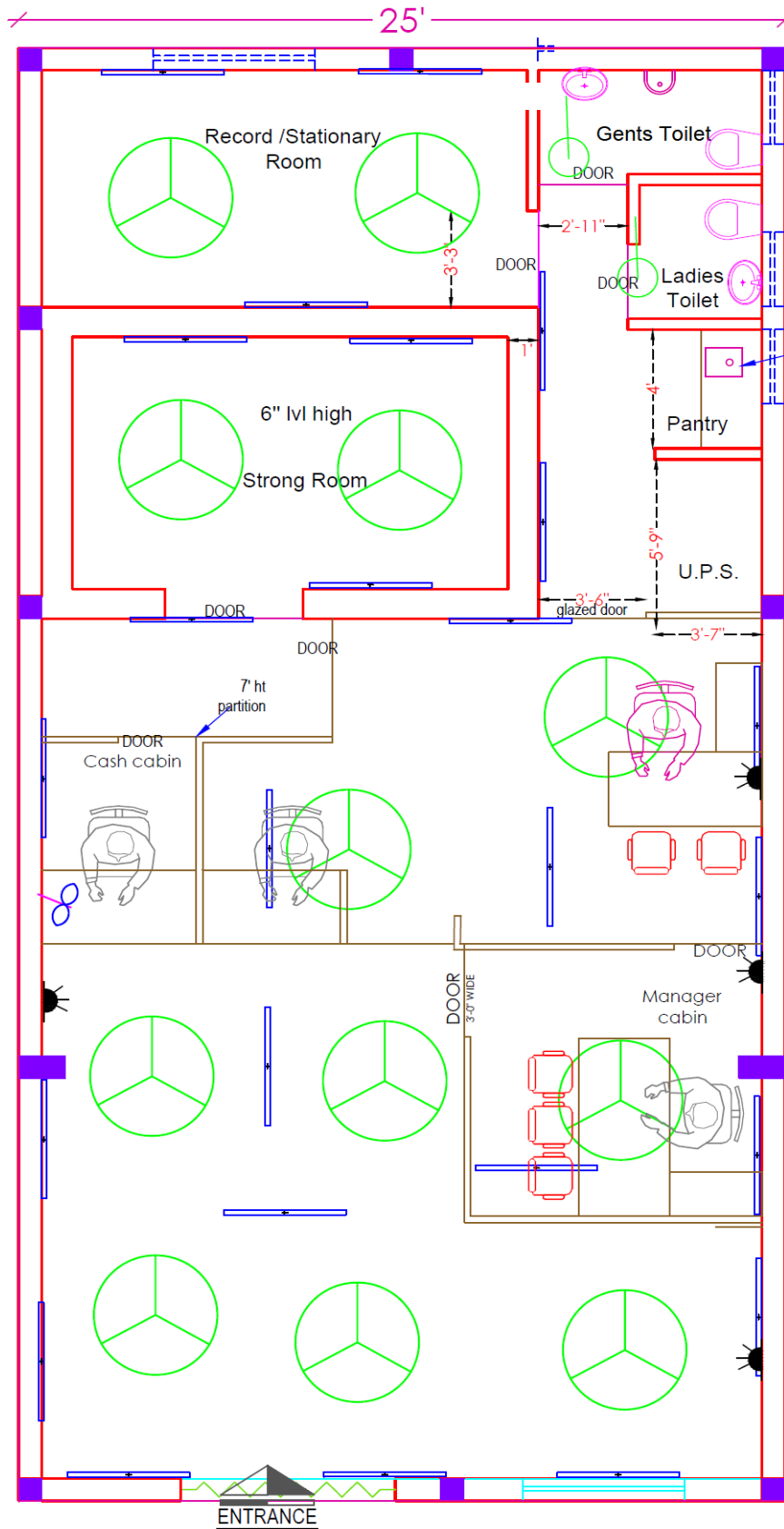

LEGENDS FOR FALSE CEILING BRANCH			
S.NO	SYMBOL	DESCRIPTION	HT.
1.		2x36w CFL RECESS LIGHT	-
2.		1X36W TUBE LIGHT	7'-0"
3.		2X36W TUBE LIGHT RECESS	-
4.		CEILING FAN	-
5.		2X36W TUBE LIGHT Hanging	8'-0"
6.		WALL MOUNTED FAN	6'-6"
7.		EXHAUST	8'-6"
8.		1X11W CFL WALL LIGHT	8'-6"
9.		SWITCH BOARD	4'-6"
10.		POWER POINT	1'-0"
11.		A.C.POINT PROPOSED AC	1'-0"
12.		MAIN LT INCOMING PANEL	
13.		TPN Db	6'-0"

PROJECT

PROPOSED FURNITURE LAYOUT PLAN OF INDIAN BANK
BRANCH AT BHANDARA -DISTRICT -MAHOBA

DRAWING

ELECTRIC
LAYOUT



SCALE

N.T.S.

DATE

JUNE-2023

ARCHITECT

MOHIT & ASSOCIATES
ARCHITECTS, INTERIORS, ESTIMATORS.

L-2/54 VIBHUT KHAND GOMTI NAGAR,
LUCKNOW - MO - 9582118092/743217659