



**INTERIOR FURNISHING AND ELECTRICAL WORKS IN
INDIAN BANK MANAMELKUDI BRANCH PREMISES
S.F.NO:- 220/B, SRB COMPLEX, VADAKKU
MANAMELKUDI, MANAMELKUDI (PO & TK),
PUDUKKOTTAI DISTRICT – 614 620.**

INDIAN BANK

REQUEST FOR QUOTATION (RFQ)

FOR

**INTERIOR FURNISHING AND ELECTRICAL WORKS IN INDIAN BANK MANAMELKUDI
BRANCH PREMISES S.F.NO:- 220/B, SRB COMPLEX, VADAKKU MANAMELKUDI,
MANAMELKUDI (PO& TK), PUDUKKOTTAI DISTRICT – 614 620.**

Ref: No: ZO: TRY: PRE: 2024-2025-MANAMELKUDI BRANCH - 01

Date :

From:

.....
.....
.....

This Bid document contains 10 pages

I N D E X

Sr. No.	DESCRIPTION	PAGE No.
1	INDEX	2
2	NOTICE INVITING QUOTATION	3-5
3	GENERAL RULES AND INSTRUCTION FOR THE GUIDANCE OF BIDDERS	6 - 8
4	TECHNICAL BID	9
5	DECLARATION	10
6	QUOTATION	11 - 30
7	CONCEPTUAL DRAWINGS	31 - 33

**INTERIOR FURNISHING AND ELECTRICAL WORKS IN
INDIAN BANK MANAMELKUDI BRANCH PREMISES
S.F.NO:- 220/B, SRB COMPLEX, VADAKKU
MANAMELKUDI, MANAMELKUDI (PO & TK),
PUDUKKOTTAI DISTRICT – 614 620.**

INDIAN BANK

NOTICE INVITING QUOTATION

Indian Bank, Zonal Office, Salem invites sealed Quotation (Single bid System) for 'INTERIOR FURNISHING AND ELECTRICAL WORKS in Proposed Indian Bank Manamelkudi Branch, S.F.NO:-220/B, SRB Complex,Vadaku Manamelkudi, Manamelkudi (PO & Tk), Pudukkottai District – 614 620, from the experienced and technically qualified contractors.

1.	Name of work	Invitation of tender for 'INTERIOR FURNISHING AND ELECTRICAL WORKS' in Proposed Indian Bank Manamelkudi Branch, S.F.NO:-220/B, SRB Complex,Vadaku Manamelkudi, Manamelkudi (PO & Tk), Pudukkottai District – 614 620.from the experienced and technically qualified contractors.
2.	Earnest Money Deposit	Rs.36,900/-
3.	Period of completion	21 days reckoned from the date of issue of the Work Order
4.	Validity of Quotation	60 Days from the date of opening
5.	Defects Liability Period	6 Months from the date of virtual completion of work
6.	Retention Money/ Security Deposit	5% of the Final Bill Amount (No interim bill will be permitted).
7.	Retention Money/ Security Deposit period	Retention Money will be paid after expiry of defect liability period of one year from the date of payment of final bill.
8.	Liquidated Damages	1% per week of the Contract Value for the delay subject to a maximum total of 5% of Contract value
9.	Tender Documents	The Tender Documents can be downloaded from the Bank's website (www.indianbank.in under Tenders column)
10.	Cost of Tender Document	Nil
11.	Last date of submission of RFQ	11.11.2024 upto 13.00Hrs. at Indian Bank, Zonal Office, Premises, Estate & Expenditure dept, Jenne Plaza, Second Floor ,5-E Bharathiar Salai Cantonment, Trichy – 620 001.
12.	Date of opening RFQ	11.11.2024 at 15.00Hrs. at Indian Bank, Zonal Office, Premises, Estate & Expenditure dept, Jenne Plaza, Second Floor ,5-E Bharathiar Salai Cantonment, Trichy – 620 001.

Note:

1. Technical bid and Price bid should be submitted in single sealed covers.
2. The bank reserves the right to reject any tender/bid without assigning any reason.
3. The rates quoted by the tenderer shall be based only on the specifications and conditions of the tender documents.
4. Bank is not liable to make any payment to tenderers for preparation to submit the tender/bid.

DEPUTY GENERAL MANAGER

Indian Bank, Zonal Office, Trichy,
Jenne Plaza, Second Floor,
5-E Bharathiar Salai Cantonment, Trichy– 620 001.
Ph: 0431–2461501 / 0431- 2461510.
Email: zotrichy@indianbank.co.in

Signature & Seal of the Tenderer

Note:

1.0 GENERAL

Bidders are advised to acquaint themselves fully with the description of work, scope of services, time schedule and terms and conditions including all the provisions of the RFQ document before firming up their Quotation.

Though adequate care has been taken while preparing this RFQ Document, the Bidders shall satisfy themselves that the document is complete in all respects. Intimation of any discrepancy shall be given to this office immediately. If no intimation is received from any Bidder within the last dated of submission of RFW, it shall be considered that the Tender Document is complete in all respects.

2.0 SUBMISSION OF BID

The Bidders shall submit their quotation in line with this RFQ Document.

RFQ Document should be in a proper sealed envelope superscripted as 'INTERIOR FURNISHING AND ELECTRICAL WORKS in Proposed Indian Bank Manamelkudi Branch, S.F.NO:-220/B, SRB Complex,Vadaku Manamelkudi, Manamelkudi (PO & Tk), Pudukkottai District – 614 620.

More than one bid from same owner shall be summarily rejected.

3.0 SITE PARTICULARS

Bidders are advised to inspect and examine the site and its surroundings between **10 am to 5 pm** on any of the working days of the Bank and satisfy themselves before submitting their bids as to nature of work, site conditions, flooring conditions, means of access to the site etc. Non-familiarity with the site conditions will not be considered a reason either for extra claims or for not carrying out the work in strict conformity with the specifications. For site visit you may contact Branch Manager Manamelkudi Branch in 0437-1250221.

4.0 SCOPE OF WORK

4.1 'INTERIOR FURNISHING AND ELECTRICAL WORKS in Proposed 'Indian Bank Manamelkudi Branch, S.F.NO:-220/B, SRB Complex, Vadaku Manamelkudi, Manamelkudi (PO & Tk), Pudukkottai District – 614 620.

4.2 Rates quoted shall be deemed to be inclusive of manpower, material, machinery, tools and tackles, installation, all taxes (except GST), duties, cartage, freight loading & unloading, insurance etc.

4.3 No escalation of whatsoever nature shall be payable in future.

4.4 Only GST will be paid by the Bank. Any other tax shall be payable by the contractor.

4.5 Bank reserves the right to modify/ relax/ withdraw any of the terms and conditions of the contract if it is found necessary in the interest/ benefit of the Bank.

4.6 Prospective Bidders are requested to remain updated for any notices / amendments/ clarifications etc. to the Tender Document through our Banks website. No separate notifications will be issued for such notices / amendments / clarifications etc. in the print media or individually.

4.7 The contract as a whole or part thereof is NON TRANSFERABLE.

5.0 MINIMUM ELIGIBILITY CRITERIA

- 5.1 The bidder should be in Business for the Past 3 Years.
- 5.2 Self attested Copy of GST & PAN number.
- 5.3 24 x 7 local service set –up in Trichy or in Tamilnadu (address proof to be furnished).
- 5.4 Affidavit/ undertaking certifying that the firm has not been blacklisted by anyone (page -10 of this RFQ).

The contractor should have the technical competence, sound financial resources, experience, equipments, manpower and reputation to perform the contract to the satisfaction of Bank.

6.0 EVALUATION CRITERIA/ FINAL SELECTION

- 6.1 Bids submitted without the requisite documents for 5.0 (Minimum Eligibility Criteria) will be summarily rejected and the price quoted by them will not be considered for evaluation. Qualified parties have no right to claim for award of the work. Bank reserves the right to cancel or award the work to any party / Bidder. Bidders who wish to attend the opening of the bids may ensure their presence on the mentioned date and time as specified in the Date sheet.
- 6.2 The lowest bidder (L-1) shall be considered for award of work, though not binding and the decision of the Bank in this regard will be final and binding.
- 7.0 The bank reserves the right to reject any tender/ bid without assigning any reason.
- 8.0 The rates quoted by the bidder shall be based only on the specifications and conditions of the bid documents.
- 9.0 Bank is not liable to make any payment to bidders for preparation to submit the tender/bid.

DEPUTY GENERAL MANAGER

Indian Bank, Zonal Office, Trichy,
Jenne Plaza, Second Floor,
5-E Bharathiar Salai Cantonment, Trichy– 620 001.
Ph: 0431–2461501 / 0431- 2461510.
Email: zotrachy@indianbank.co.in

GENERAL RULES AND INSTRUCTION FOR THE GUIDANCE OF BIDDERS

1. Bids, which should always be placed in sealed cover, with the name of the work written on the envelope "INTERIOR FURNISHING AND ELECTRICAL WORKS in Proposed Indian Bank Manamelkudi Branch, S.F.NO:-220/B, SRB Complex, Vadakku Manamelkudi, Manamelkudi (PO & Tk), Pudukkottai District – 614 620 will be received by Deputy General Manager, Indian Bank, Zonal Office, Trichy, Jenne Plaza, Second Floor, 5-E Bharathiar Salai, Cantonment, Trichy– 620 001.
2. The Indian Bank does not bind itself to accept the lowest or any quote/ bid and reserves to itself the right of accepting the whole or any part of the quote/ bid and the tenderer/ bidder shall be bound to perform the same at the rate quoted.
3. The rate quoted by the Tenderer/ bidder shall be net, up to the stage of incorporation and handing over site. All taxes on material or on finished works like work's contract tax, Turn-over Tax, including taxes that may be newly introduced subsequent to the tender/ bid etc. in respect of this contract shall be payable by the Tenderer/ bidder and the Indian Bank will not entertain any claim whatsoever in this respect except the GST to the overall bid amount.
4. The Tenderer/ bidder shall give a list of his relatives working with the Indian Bank along with their designations and addresses.
5. No employee of the Indian Bank is allowed to work as a contractor for a period of two years of his retirement from Indian Bank service, without the previous permission of the Indian Bank. The contract is liable to be cancelled if either the contractor or any of his employees is found at any time to be such a person who had not obtained the permission of the Indian Bank as aforesaid before submission of the tender/ bid or engagement in the Tenderer/ bidders service.
6. The tender/ bid for works shall remain open for acceptance for a period of 90 days from the date of opening of Tender/ bid. If any tenderer/ bidder who withdraws his tender/ bid before the said period, then the Indian Bank shall be at liberty to debar the contractor from the panel.
7. The tenderer will have to deposit an amount Rs.38, 000/- in the forms of DD in favour of Indian bank payable at Trichy at the time of submission of tender as EMD. The employer is not liable to pay any interest on the earnest money. The earnest money deposit of the unsuccessful tenderers will be refunded without any interest soon after the decision to award the work is taken or after the expiry of the validity period of the tender. **Firms having valid MSME registration are exempted from Earnest Money Deposit.** Retention money shall be deducted from the final bill @ 5 % of the final bill. This will be refunded after completion of the Defect Liability Period of 12 months, provided he has satisfactorily carried out all the work and attended to all the defects in accordance with the conditions of the contract. No interest is allowed on retention money.
8. The acceptance of a quote will rest with the Indian Bank and the Indian Bank reserves to itself the authority to reject any or all of the quotes received without the assignment of a reason. Quotes in which any of the prescribed conditions are not fulfilled (or) are incomplete in any respect are liable to be rejected. The Indian Bank reserves the right to accept the quote in full or in part and the tenderer/ bidder shall have no claim for revision of rates or other conditions if his quote is accepted in parts.
9. Canvassing in connection with quotes is strictly prohibited and the tenders/ bids submitted by the Tenderer/ bidders who resort to canvassing will be liable to rejection.

All rates shall be quoted on the proper form of the quote alone. **All the entries to be made legibly in ink only.** Rates written in pencil or any other mode shall not be considered for evaluation and will be rejected.
10. An item rate quote containing percentage below/ above will be summarily rejected. However, where a tenderer/ bidder voluntarily offers a rebate for payment along with sealed quote, the same may be considered.

**INTERIOR FURNISHING AND ELECTRICAL WORKS IN
INDIAN BANK MANAMELKUDI BRANCH PREMISES
S.F.NO:- 220/B, SRB COMPLEX, VADAKKU
MANAMELKUDI, MANAMELKUDI (PO & TK),
PUDUKKOTTAI DISTRICT – 614 620.**

11. On acceptance of the tender/ bid the name of the accredited representative(s) of the Tenderer/ bidder who would be responsible for taking instructions from the Indian Bank shall be communicated to the Indian Bank.
12. Special care should be taken to write the rates in figures as well as in words and the amounts in figures only, in such a way that interpolation is not possible. The total amount should be written both in words and in figures.
13. The Contractor shall comply with and give all notices required under any law, rules, regulations, or bye-law of Parliament, State Legislature or Local Authority relating to works. If needed, the Contractor has to obtain required permission/ approval from the required statutory bodies/ organizations.
14. The Contractor shall be required to maintain the site and the building areas in a neat and clean condition at all times to the satisfaction of the Employer. The Contractor shall especially take care of their materials free from getting drenched or damaged.
15. Debris and unwanted items have to be neatly stacked at site and then periodically removed (maximum of one week), carried away by the Contractor and disposed off as per the rules and regulations of the Local Authorities concerned. No debris shall be thrown loose from upper floors. No floor, roof or other part of the building shall be over-loaded with debris or materials as to render it unsafe.
16. Employer reserves the right to insist on selection of material, workmanship, detailing and finishes, paint which they consider, is appropriate, and suitable for the intended use. The contractor is not eligible to claim extra on this account.
17. Employer will require the contractor to produce, samples of all the materials, accessories/ finishes prior to procurement/ manufacture. The samples of the materials for the work shall be got approved from the Employer. Failure to comply with these instructions can result in rejection of the work/ materials.
18. The Tenderer/ bidder should note that he should execute his part of work without causing any damage to any component of the building and also without disturbing the occupants or other contractors. Any damage so caused shall be made good at the cost & risk of the tenderer/ bidder.
19. The successful tenderer/ bidders shall include, in the quoted price, all allied works and no extra payments will be made for any such case arises.
20. **The successful contractor shall also be responsible for the safety and security of all their men & materials** and also for ensuring fire prevention steps at all times in the working premises including their part of the work. The successful contractor has to place full time representative at site, the representative should have thorough subject knowledge. **Bank will not be responsible for any untoward accident caused by the negligence of the contractor.**
21. **Only final bill will be permitted after completion of works.** The bills in proper forms must be duly accompanied by detailed measurements in support of the quantities of work done and must show deductions for all previous payments, retention money etc. The Employer after detailed scrutiny of the final bill shall certify full payment within **10 days** of the date of receipt of bill from the Contractor subject to submission of documentation as required.
22. **The contractor should ensure payment of minimum wages + VDA to all laborers / workmen staff employed by him inline with central/ state labour wage act whichever higher.**
 - a) The Contractor shall at all times indemnify and keep indemnified the Employer against all losses, claims, damages or compensation including under the provisions of the payment of the Wages Act 1936, Minimum Wages Act 1948, Employer's Liability Act 1938, Workman's Compensation Act 1923, the Maternity Benefit Act 1961, the Bombay Shops and

**INTERIOR FURNISHING AND ELECTRICAL WORKS IN
INDIAN BANK MANAMELKUDI BRANCH PREMISES
S.F.NO:- 220/B, SRB COMPLEX, VADAKKU
MANAMELKUDI, MANAMELKUDI (PO & TK),
PUDUKKOTTAI DISTRICT – 614 620.**

Establishments Act 1947, Industrial Disputes Act 1947, and Contract Labour (Regulation and Abolition) Act 1970 and Employees State Insurance Act 1948, Motor Vehicles Act 1988 or any modifications thereof or under any other law relating thereto and rules made there under from time to time or as a consequence of any accident or injury to any workman or other person in or about the work whether in the employment of the Employer or Contractor or not, and also against all costs, charges and expenses of any suit, action or proceedings whatsoever out of such accident or injury or combination of any such claims.

23. The contractor shall affect the insurance necessary and indemnify the Employer entirely from all responsibility in this respect. The insurance must be placed with an Insurance Company approved by the Employer and must be jointly in the name of the contractor and the Employer and the policy lodged with the latter. The scope of insurance is to include damage or loss to the contract itself till this is made over in a complete state. Insurance is compulsory and must be effected from the very initial stage. The contractor shall also be responsible for anything which may be executed from damage to any property arising out of incidents, negligence, or defects carrying out of this contract.
24. The Employer shall be at liberty and is hereby empowered to deduct the amount of any damages, compensations, costs, charges and expenses arising or accruing from or in respect of any such claim for damages from any sums due or to become due to the contractor.
25. The contractor shall maintain all registers as required by the Regional Labour Commissioner and should furnish the same to the Bank or its representative as and when required.
26. If the work is not started within **4 days** from the date of issue of work order then Employer may terminate the work order without assigning any reason. If during the execution of the work, the progress of work is not considered to be satisfactory; and not in proportion to the commitment made, inconsistent with the period of completion of the work provided in the Time schedule, then the Bank may terminate the work order by giving an immediate final notice to the contractor.
27. The time allowed for completing the works is **21 days** to be reckoned from the date of Work Order. Tenderer/ bidders shall submit a programme (time schedule) for executing the entire project and shall furnish the details of their scheme indicating the proposed deployment of their machinery and resources.
28. If the Contractor fails to complete any or all the works by the date/s named in "Date of Completion" or within any extended time (in case Bank Permits) then the Contractor shall pay or allow the Employer the sum to be worked out at **1.0%** of contract value per week to be recovered as Liquidated Damages (and not by way of penalty) for the delay, beyond the said date or extended time, as the case may be, during which the works shall remain unfinished and such damages may be deducted from any moneys due or which may become due to the Contractor. The maximum amount of Liquidated damages shall be **5%** of contract value. The contractor shall be bound to extend validity of Insurance Cover till such period of completion as may be considered necessary at their cost.

DEPUTY GENERAL MANAGER,

Indian Bank, Zonal Office, Trichy,
Jenne Plaza, Second Floor,
5-E Bharathiar Salai Cantonment, Trichy– 620 001.
Ph: 0431–2461501 / 0431- 2461510.
Email: zotrichy@indianbank.co.in

Signature & Seal of the Bidder

DETAILS

S. No.	Particulars	Details to be filled
1	Name & Designation of Contact Person	
2	Mobile No (s) of the Contact Person / Firm	
3	Address for Communication	
4	Office / Local service set-up in Chennai address	
5	E-mail address of Contact Person / Firm	

(Signature of Authorized Signatory)

Name & Designation

Contact No.

NAME OF THE AGENCY WITH SEAL

DECLARATION

To

DEPUTY GENERAL MANAGER

Indian Bank, Zonal Office, Trichy,
Jenne Plaza, Second Floor,
5-E Bharathiar Salai Cantonment, Trichy– 620 001.
Ph: 0431–2461501 / 0431- 2461510.
Email: zotrichy@indianbank.co.in

I hereby declare as below:

- 1) All the information furnished by me/ us here above is correct to the best of my knowledge and belief.
- 2) I/We have no objection if enquiries are made about the work listed by me/ us in the accompanying sheets/ annexures.
- 3) I/We agree that the decision of Indian Bank in selection of L-1 bidder will be final and binding to me/ us.
- 4) I/We hereby confirm that my/ our firm has not been disqualified / debarred / blacklisted by any Governments, Semi-governments, PSUs, Banks including any of the Offices/ Branch of Indian Bank/ erstwhile Allahabad Bank as on the date of publication of this notice.
- 5) I/We hereby confirm that all information, particulars, copies of certificates and testimonials submitted are correct and genuine. I am / We are, therefore, liable to face appropriate actions as deemed fit by the Indian Bank in the event of any of the information, particulars, copies of certificates and testimonials are not found correct and genuine.

PLACE :

DATE:

NAME & DESIGNATION

NAME OF THE TENDERER WITH SEAL

AVANTI GARDE

DESIGN CONSULTANTS

#1281, Trichy Road, Coimbatore – 641 018, Tamil Nadu, India.

Voice: 98422 30124.

E-mail: ar_anand@consultant.com

TENDER FOR INTERIOR FURNISHING WORKS

**TENDER FOR INTERIOR FURNISHING, ELECTRICAL,
AND DATA CABLING WORKS**

OF

M/s. INDIAN BANK – MANAMELKUDI BRANCH

AT MANAMELKUDI, PUDUKKOTTAI, TAMIL NADU.

ARCHITECTS

**S. VIJAY ANAND., B.Arch., Mem COA., AIIA,
DESIGN CONSULTANTS**

#1281, Trichy Road, Coimbatore – 641 018, Tamil Nadu, India.

Voice: 98422 30124.

**ARCHITECTURE PLANNING STRUCTURES
INTERIORS & LANDSCAPE**

**TENDER FOR THE INTERIOR FURNISHING, ELECTRICAL ,
DATA CABLING WORKS FOR M/s. INDIAN BANK,
AT MANAMELKUDI BRANCH, PUDUKKOTAI, TAMIL NADU.
(INCLUDING ATM ESTIMATE)**

SUMMARY SHEET

Sl. No	Type of Work		Amount
			<u>(Rs.)</u>
I	Interior Furnishing Works - Branch		
1	Interior Works		Rs.
2	Electrical Works		Rs.
3	Total		
II	Purchase of SFVM Items including Furniture, Furniture fixtures, Electrical fittings and		
4	Furniture and Furniture Fixtures		Rs.
5	Electrical Fittings and Fixtures		Rs.
6	Total		
7	Data Cabling Works		Rs.
8	Interior Works - ATM		Rs.
9	Electrical Works - ATM		Rs.
III	TOTAL (3+6+7+8+9)		Rs.
	SAY		Rs.
	<i>(In words: _____)</i>		

Notes: All items are excluding of GST and other applicable taxes, unless specified

Notice: TENDERERS MUST VISIT THE SITE AND INSPECT FOR THEMSELVES THE ACTUAL WORKS TO BE CARRIED OUT BEFORE SUBMITTING THE TENDER,

TENDER SCHEDULE FOR THE INTERIOR WORKS
AT M/s. INDIAN BANK, MANAMELKUDI BRANCH,PUDUKKOTTAI ,TAMIL NADU.

S.No	Particulars	Qty.	Unit	Rate (Rs.)	Amount (Rs.)
1	FALSE CEILING (Gypsum Board) Providing and fixing suspended false ceiling, which includes providing and fixing G.I. Perimeter channels of size 0.55mm tk having one flange of 20mm and another flange of 30mm and a web of 27mm along with perimeter of ceiling, screw fixed to brick wall / partition with the help of nylon sleeves and screw at 610 mm centres. Then suspending G.I. Intermediate channels of size 45mm, 0.9mm thick with two flanges of 15mm each from the soffit at 1.22 mts centre to centre with ceiling angle of width 25mm x 10mm x 0.5mm tk fixed to soffit G.I. clean and steel expansion fasteners. Ceiling section of 0.55mm thickness having knurled web of 51.5mm and two flanges 26mm each with clips of 10.5mm are then fixed to the intermediate channel with the help of connecting clips and in direction perpendicular to the intermediate channel at 457mm centre to centre. 12.5mm tapered edge Star Brand / India Gypsum Gypboard (conforming to IS-2095-1982) is then screw fixed to ceiling sections with 25mm dry wall screws at 230mm centres. Screw fixing is done mechanically either with screwdriver or drilling machine with suitable attachment. Finally the boards Properly finished with topcoat as per Architect direction. (This includes painting) - Manager Cabin & Banking Hall	261.00	Sft		
1.1	FALSE CEILING (Armstrong) Providing & fixing in position false ceiling in Armstrong 600 x 600mm x 15/16 mm Dune supreme RH 99 Prima tile with tegular edge frame work as specified by Armstrong co. with suspends wherever required. Making necessary framework for A.C ducting, if any, and necessary cutouts for diffusers and light fittings, taping and finishing to proper line & level, including making grooves and trap doors for A.C unit in 18 mm thick M.R grade plywood with Stainless steel hinges & locks with moulding 1" x 1" for edges including finishing with white plastic emulsion paint etc.complete in all respects. (Note: - Only the plan area will be measured for payment. No payment will be made for cutouts, grooves, mouldings etc.)				
a.)	Manager Cabin & Banking Hall	696.00	Sft		

S.No	Particulars	Qty.	Unit	Rate (Rs.)	Amount (Rs.)
2	SOLID FULL HIGH WOODEN PARTITION Providing and fixing in position fully glazed Full Ht plywood partitions with use of country wooden / Al sections 2 ½” x 2 ½” of size spaced 2’0” x 2’0” both horizontally & vertically in a grid fashion, for a thickness of 3”, both sides of the section to be finished with 6mm tk plywood duly treated for termite resistance and finished with 1 mm tk laminate as per direction. All openings are to be strengthened on the edges with additional wooden sections in order to fix glass (float glass). Inclusive of fixed glazing of size 5’6”x 4’0” with 5mm tk glass fixed as per specification. 3” high laminate skirting to be provided. Item to include door of size 3’0" x 7’0" with etching and frosting as per design and 2” x 2” aluminium section for door sides and glass sides and T.W door frame to take 8mm thick glass with etching and frosting. All exposed surfaces to be finished with Teak Wood lipping in melamine polish of matching laminate colour as directed including all necessary stainless steel finish fittings/ hardware, door closers, Godrej locks and wood preservative paint etc. as per list of approved material and as approved by the project consultant/ bank complete in all respects. Skirting to be provided as per architect direction. (Note : In case of false ceiling, the vertical frames & supporting members to be fixed with true ceiling but the area of partition payable will be below the false ceiling only)				
a.	Up to a height of 10’0” from finished floor level - banking hall (back office, dining, pantry, stores & Safe room)	590.00	Sft		
b.	Half ht wooden partitions				
i.	Up to a height of 2’0” from counter top for front of counters.	58.00	Sft		
ii.	Up to a height of 3’0” from finished floor level for Wicket Gate	12.00	Sft		
iii.	Up to a height of 4’6” from finished floor level for side partition	18.00	Sft		
3	FULL HT BISION PANEL / HILUX / V BOARD PARTITION <i>(Paint finish)</i> Providing and fixing in position fully glazed Full Ht Bision Panel / Hilux / V Board Partition comprising of GI floor channels 48 mm x 50 mm & 0.45 mm thk at 4’0” intervals fixed with 8mm tk fiber cement board on both sides & joints filled with joint tape & jointing compound. All openings & doors to be reinforced with GI intermeditate channels of .7mm thk. Both sides finished with putty & emulsion paint of approved shade & colour. Item to include door of size 3’0" x 7’0" with etching and frosting as per design and 2” x 2” aluminium section for door sides and glass sides and T.W door frame to take 8mm thick glass with etching and frosting. Inclusive of fixed glazing of size varying as per site condition with 8mm tk glass fixed as per specification including painting. Skirting to be provided as per arc direction. (Up to a height of 10’0" from FFL)				
a.	Up to a height of 10’0” from finished floor level for store/dining	N.A	Sft		
b.	Up to a height of 3’0” from 8’0" to 11’0" level for UPS room	N.A	Sft		

S.No	Particulars	Qty.	Unit	Rate (Rs.)	Amount (Rs.)
4	<p>FULL HIGH GLAZED PARTITION</p> <p>Providing and fixing in position fully glazed full height partition work in frame work at 2' x 2' grid (horizontally and vertically) comprising of 2" x 1½" T.W section and/ or as per frame work with 6mm plywood on both sides finished with 1mm thick laminates of approved shade and colour. Item to include door of size 3'0" x 7'0" with etching and frosting as per design and 2" x 2" T.W. member for door sides and glass sides and T.W door frame to take 8mm thick glass with etching and frosting. All exposed T.W surfaces to be finished in melamine polish of matching laminate colour as directed including all necessary stainless steel finish fittings/ hardware, door closers, Godrej locks and wood preservative paint etc. as per list of approved material and as approved by the project consultant/ bank complete in all respects.</p> <p>(Note : In case of false ceiling, the vertical T.W members to be fixed with pucca ceiling but the area of partition payable will be below the false ceiling only)</p>				
a)	manager cabin partition (9'6" ht) & front entrance door	252.00	Sft		
6	<p>BULK CASH CAGE PARTITION (without doors) TYPE I - (Laminate finish)</p> <p>Providing and fixing in position fully glazed Full Ht Bision Panel / Hilux / V Board Partition of GI floor channels 48 mm x 50 mm & 0.45 mm thk at 4'0" intervals fixed with 8mm tk fiber cement board on both sides & joints filled with joint tape & jointing compount. All openings & doors to be reinforced with GI intermeditate channels of .7mm thk. Both sides finished with 1mm thk laminate of approved shade & colour. Item to include door of size 3'0" x 7'0" with etching and frosting as per design and 2" x 2" aluminium section for door sides and glass sides and T.W door frame to take 8mm thick glass with etching and frosting.</p> <p>All exposed surfaces to be finished with Teak Wood lipping in melamine polish of matching laminate colour as directed including all necessary stainless steel finish fittings/ hardware, door closers, Godrej locks and wood preservative paint etc. as per list of approved material and as approved by the project consultant/ bank complete in all respects. Skirting to be provided as per archietct direction.</p>				
i	Side & back portion of the cash cage and the specification as stated above. up to a height of 7'6" from finished floor level	85.00	Sft		
ii	Front portion & Top portition of cash cage with float glass as stated above and as per detail enclosed. Up to a height of 3'0" from counter top.including top portion (top Al grills)	60.00	Sft		

S.No	Particulars	Qty.	Unit	Rate (Rs.)	Amount (Rs.)
7	BULK CASH CAGE DOOR Fabrication and fixing of partly glazed door for rest of the area using 4" x 2 1/2" country wood frame filled with 8mm glass duly worked (partly fused pattern) as per the architect design. The door is to be fixed with pivots at top and bottom running on a flat hinge with necessary accessories, fixed on the outer side to be flush with the partition. All hardware locks, handle & brass hinges etc for the door to be provided as per the design approved by the architect. Frame to be painted with automotive paint to match that of the partition. The door to be provided				
i	Cash Cage - 2'6" x 7'0" – 1 No	21.00	Sft		
8	GLAZED DOOR Fabrication and fixing of glazed door for cabins using 4" x 2 1/2" country wood frame filled with 8mm glass duly worked (fused pattern) as per the architect design. The door is to be fixed with pivots at top and bottom running on a flat hinge with necessary accessories, fixed on the outer side to be flush with the partition. All hardware locks handle and brass hinges etc for the door to be provided as per the design approved by the architect. Frame to be painted with automotive paint to match that of the partition. Size - 3'0" x 7'0" x 3 Nos, for BM Cabin & Back office	63.00	Sft		
9	NORMAL DOOR Full ht.solid 33mmthk flush door of size as specified fully finished in 1mm laminate of equivalent brand, pattern, provided with door closer, edge lipping lock and SS handle all complete including 4" x 3" wooden door frame. Size - 3'0" x 7'0" x 3 Nos (Safe room, Stores, Dining & wash area) Sliding Door - 2'6" x 7'0"	63.00	Sft		
		N.A	Sft	N.A	N.A
10	ENTRANCE DOOR Fabrication and fixing of front entrance door made of 12mm thick glass (Fused Glass to be worked as per the design). With the help of 6" x 2 1/2" Burma teak sections both on top and bottom. Brushed steel SS pipes worked as handrail per detail. The door is to be fitted with pivot on top and bottom with floor spring Everlite or ISI approved and all accessories etc complete. Size - 5'0" x 7'0" x 1 No branch	35.00	Sft		
11	EXTERNAL FIXED GLASS (for branch up 7'0" ht) P/F fully glazed partition upto 8'0" ht. 8mm thk float glass with 4" x 2" aluminium box section 4 sided frames with powder coating of approved colour - 20 micron thk. (up to ht of 8'0")	15.75	Sft		

S.No	Particulars	Qty.	Unit	Rate (Rs.)	Amount (Rs.)
12	FAÇADE OF ENTRANCE DOOR Providing and fixing in position Aluminium composite panel boxing with PVDF coating & LDPE core laminated Eurobond/ Altobond/ Alukbond exterior grade 4mm thick with composite of (0.5mm - 3mm – 0.5mm) including fabrication for the same with aluminium sections, required hardware, silicon sealant (Dow corning 789) masking tape, necessary scaffolding etc.complete in all respects.	32.00	Sft		
13	WALL PANELLING Fabrication & Paneling with 8mm tk branded Bision Panel / Hilux / V Board Partition and finished with 4mm tk OST duly polished / 1mm tk laminate to match the interior décor, as per architect direction. (Free standing coloumns in Banking hall, Waiting longue, Board room, Disucssion room, ZM cabin) etc complete.				
a	Wall panelling - BM Cabin	187.50	Sft		
b	Coloumn panelling - Banking Hall	142.50	Sft		

TOTAL AMOUNT

Rs:

(In words:

).

Notes: All items are excluding of GST and other applicable taxes, unless specified

TENDER SCHEDULE FOR THE ELECTRICAL WORKS
AT M/s. INDIAN BANK, MANAMELKUDI BRANCH,PUDUKKOTTAI ,TAMIL NADU.

S.No	Description	Qty	Unit	Rate (Rs.)	Amount (Rs.)
1	Supply & laying of following PVC insulated copper wire in suitable PVC conduit pipe/PVC channels as per site condition) necessary clampings etc ., for branch				
a	4C x 25 sq mm AL Ar UG Cable from EB Mains to main power panel.	40.00	mtrs		
b	4C x 6 Sqmm + 1R x 4.0 Sqmm copper cable from main power panel to UPS input Mains 4 point & AC DB	45.00	mtrs		
c	4C x 4 Sqmm + 1R x 2.5 Sqmm copper cable from main power DB to Lightning DB's .	40.00	mtrs		
d	2 x 4 Sqmm + 1R x 2.5 Sqmm copper wire for Raw Power DB's, UPS Output DB's & AC DB, AC DB to AC units	330.00	mtrs		
e	2 x 2.5 sq mm + 1 x 1 sq mm MCB to computer (UPS.)	230.00	mtrs		
f	2 x 2.5 sq mm + 1 x 1 sq mm RAW power & lightings (including sinage lighting)	320.00	mtrs		
g	1 x 6 sq mm from dedicated UPS Earth pit to UPS	82.00	mtrs		
2	Supply & Wiring using 3 run of 4 sq mm and 2 run of 2.5 sq mm 600 V grade. PVC insulated FR copper wire through 25 mm dia PVC conduit with all necessary accessories like bend collar, saddle, screws etc. complete - from main panel to UPS mains.	38.00	mtrs		
3	Supply & installation of 63 A 4 P change over switch with SS enclosure	1.00	No		
4	Supply & intallation of UPS Power 3Nos 6 A 3 Pin sockets, 1No 16A switch in suitable box - modular type. Work stations -7 Nos., Server - 1 No. 6A (5 pin socket) Manager cabin - 1 No.,	11.00	Nos		
5	16 A 3 Pin Metal Plug & soket with 1No 25A SP MCB for . <i>(Including 2 nos for ATM)</i>	7.00	No		

- 6 Supply & intallation of RAW power for BC , POF,OTB and front office tables 16 A 3 pin sockets. 1 no 6 A switch in suitable box modular type 9.00 Nos
- 7 Supply & wiring for light points/ fan point wiring using 3 x 1.5 sq mm PVC insulated copper wire in suitable PVC conduit pipe with all accessories - concealed in wall including supply and fixing of switch boxes, 6 A switches, ceiling rose etc. 65.00 points
- 8 Supply, Fixing and wiring of wall fan with 1 No 6A socket with 6A Switch with all necessary wirings.(Modular type) 10.00 points
(Burglar alarm & CCTV camera points at BM Cabin)

NET TOTAL AMOUNT (A)

Rs:

(Rupees:

Notes: All items are excluding of GST and other applicable taxes, unless specified

TENDER SCHEDULE FOR THE FURNITURE FIXTURES WORKS
AT M/s. INDIAN BANK, MANAMELKUDI BRANCH,PUDUKKOTTAI ,TAMIL NADU.

S.No	Particulars	Qty.	Unit	Rate (Rs.)	(Rs.)
1	<p>MANAGER TABLE (with out side credenza) Fabrication and erection of manager's table made of 18mm thick water proof plywood duly treated for termite resistant, finished with 1.5mm thick laminate on all outer sides the inner sides are to be finished with 2 coats of putty 1 coat primer and 2 coats of enamel. The table to be provided with drawers, cupboard and a CPU cabinet. The drawers with 12mm plywood are to be fitted with microscopic slide for smoother functioning. The cupboard is to be fixed with box type hinges and locks are to be provided for both with all necessary handles fixtures etc. The CPU cabinet with necessary perforations for ventilation and wiring. Additional drawer for pencils and accessories to be provided. The table top to be pasted with 1.5 mm thick laminates and edges to be finished with teak wood beadings as per specification given by architect. The total work is to be done as per the drawing and the colours etc. to be consulted with the architect.</p> <p>Size: 6'0"x 3'0" (with one set of drawers and cabinets).</p>	1.00	No		
2	<p>STORAGE CABINET (HALF/FULL HEIGHT) Fabrication of Storage cabinets upto a height of 2'6"/7'0", size 1'3"/1'6" wide and 1'3" deep, made of 18mm thick termite treated, water proof plywood. The backside of the cabinet is to be covered with 12mm thick plywood. The front door is to be lipped with teak wood on all four sides. The doors are to be fitted with 3" brass hinges and proper locks are to be fixed. The outer sides of the cupboard are to be finished with 1.5mm thick laminate. The inner side of the cabinet is to be finished with 2 coats of putty and 2 coats of enamel.</p>				
i	Full height (FCB) Stores & UPS 7'0" ht	135.00	Sft		
ii	Half height (HCB) Behind BM cabin & RDO (3'0"ht)	40.00	Sft		

3 **SIDE CREDENZA**

Fabrication of Storage cabinets up to a height of 2'6", as per drawing wide and 1'3" deep, made of 18mm thick termite treated, water proof plywood. The backside of the cabinet is to be covered with 8 mm thick plywood. The front door is to be lipped with teak wood on all four sides. The doors are to be fitted with 3" brass hinges and proper locks are to be fixed. The outer sides of the cupboard are to be finished with 1 mm thick laminate. The inner side of the cabinet is to be finished with 2 coats of putty and 2 coats of enamel.

BM cabin, RDO& CTB table (5 Nos) 40.00 Sft

4 **RUNNING COUNTERS - TABLE**

a **Type II (Straight Profile Counters).**

Fabrication and erection of running counter made of 18mm thick water proof plywood duly treated for termite resistant, finished with 1.5mm thick laminate on all outer sides the inner sides are to be finished with 2 coats of putty 1 coat primer and 2 coats of enamel. Each clerical space in the running counter is

to be provided with drawers, cabinets and a CPU cabinet. The drawers with 12mm plywood are to be fitted with microscopic slide for smoother functioning. The cupboard is to be fixed with box type hinges and locks are to be provided for both with all necessary handles fixtures etc. The CPU cabinet with necessary perforations for ventilation and wiring. Counter top to be pasted with 1.5mm thick laminate and edges to be finished with teak wood beadings as per specification given by architect. The total work is to be done as per the drawing and the colours etc. to be consulted with the architect.

i Laminate skirting as per the design is to be fixed on the outer bottom of the counter.

ii

Country wood, wooden footrest to be provided. All exposed edges to be finished with flat teak wood beadings duly polished to match that of the laminated sheet.

26.00 Rft

5 BULK CASH COUNTER Table

Fabrication and erection of cash counter made of 18mm thick water proof plywood duly treated for termite resistant, finished with 1mm thick laminate on all outer sides the inner sides are to be finished with 2 coats of putty 1 coat primer and 2 coats of enamel. Each clerical space in the cash counter is to be provided with drawers, cupboard and a CPU

cabinet. The drawers with 12mm plywood are to be fitted with microscopic slide for smoother functioning. The cupboard is to be fixed with box type hinges and locks are to be provided for both with all necessary handles fixtures etc. The CPU cabinet with necessary perforations for ventilation and wiring. The counter top to be pasted with 1.5mm thick laminate and edges to be finished with teak wood beadings as per specification given by architect. The total work is to be done as per the drawing and the colours etc. to be consulted with the architect.

i	2'6" wide counter	5.00	Rft
ii	1'0" wide counter	5.50	Rft

6 PANTRY COUNTER - DINING -TUFTHRY COUNTER

Fabrication and Fixing of running dining counter of 19 mm plywood finished with 1mm tk laminate on the outer exposed sides and duco automotive paint on the inner sides so as to match the color of the interiors. The work has to be completed as per architect's direction.

a.)	Daftry / Pantry counter	N.A.	Rft
-----	-------------------------	------	-----

7 SUGGESTION BOX & CHEQUE DEPOSIT BOX

Fabricating and fixing of suggestion box made of 18mm and 12mm plywood with drawers and lock arrangement at the bottom and a slit at the top. 12 mm glass ledge with beveled edges to half round shape suitably supported on plywood as per design. The box is to be finished with automotive paint so as to match the colour of the interiors

1.00	No
------	----

8 NOTICE BOARD

Fabrication and fixing of Notice board made of wooden frame filled with soft board covered with fur. The colour of the fur is to be selected by the Architect. The outer frame of the notice board is to be finished with automotive paint so as to match the colour of the existing wall.

(Size 4'0" x 3'0")	12.00	Sft
--------------------	-------	-----

9 **WRITING LEDGE**

Fabricating and fixing of writing ledge and brochure holder size 6'0" x 1'0" made of 12mm glass supported with 18 mm marine plywood stand finished with duco automotive paint so as to match the color of the interiors. Glass edges beveled to half round shape suitably supported on plywood as per design. 4 mm tk plain glass without tints fixed in grooves for brochure holder as per design. The work has to be completed as per architect's direction.

1.00 No

10 **MIRROR PANELING**

MIRROR PANELING in toilets & strong room made out of 6mm thk mirror of Modi/ Ashahi/ Saint Gobain with 8mm thk marine ply base with necessary moulding etc., as approve by the Architect. (2' x 2.5' + (1.5' x 2.5' x 2 Nos)

N.A No N.A N.A

11 **OVER HEAD STORAGE (above lintel ht)**

Supply fabrication and erection of over hrad storage for additional storages out of ms pipes of size 4" x 2" x 2mm thk and top covered with 19mm thick chequered plate to form base for loft storage. The entire grid assembly of pipes to be supported by puncturing the existing walls to provide for suitable bearing within the existing brick walls for the main frames. The punctured openings to be properly sealed off with baby jelly concrete and cement plaster and finished with paint as per architect direction. The ms sections to be painted with touch up putty, 2 coats of zinc chromate and finished with 2 coats of enamel paint as per architect direction. (safe room, infront of strong room & dining and back office area)

- a Loft 1 - Hand wash area
- b Loft 2 - Store room area

N.A Sft N.A N.A
N.A Sft N.A N.A

12 **BOXING FOR ROLLING SHUTTER**

Box with open able shutter & ceiling in 19mm tk ply for rolling shutter servicing with support in wooden frame, etc& complete with paint finish on all the sides

108.00 Sft

TOTAL AMOUNT

Rs:

(In words: _____)

Notes: All items are excluding of GST and other applicable taxes, unless specified

TENDER SCHEDULE FOR THE ELECTRICAL FITTING WORKS
AT M/s. INDIAN BANK, MANAMELKUDI BRANCH,PUDUKKOTTAI ,TAMIL NADU.

S.No	Description	Qty	Unit	Rate (Rs.)	Amount (Rs.)
I	<u>Fixtures & Fittings :</u>				
	Supply, delivery at site, receiving, storing, handling, carriage at site, assembling, erection including the drop down rods,chains,hooks & accessories connecting, testing and commissioning of the following Ceiling / wall mounted light fixtures including the lamps etc complete. (All fixtures to be of Wipro/ Philips/Havells make only and lamps of GE / Osram make only). (the rates are net and inclusive of cutouts and fixing).				
1)	Supply, fixing & connecting of following MCB DBs with necessary interconnections. Double Door type - concealed in wall as per site condition				
a)	MAIN POWER MCB DB: This DB comprising of the following : Incoming: 125 A 4 P MCCB(25 Kilo amps) 1 No.				
(i)	63 A TP MCB = 1 for A/C				
(ii)	40 A TP MCB = 3 for ,UPS,Lightning,Raw power				
(iii)	63 A TP MCB = 1 for Spare				
	8way TPN vertical D.Door DB For MCCB Provision.	1.00	set		
b)	Lighting MCB DB : incoming: 40 A 4 P MCB - 1 No : Outgoing 10 A SP MCB - 9 Nos: Enclosure: 4 way TPN DB				
		1.00	set		
c)	UPS INPUT MCB DB: Incoming: 40 A 4 P MCB 1 No Outgoing: 20 A 2 P MCB 2 Nos Enclosure: 4 Way TPN DB				
		2.00	set		
d)	UPS OUTPUT CIRCUIT MCB DB: incoming 40 A 2 P MCB 1 Nos Outgoing: 10 A SP MCB 7 Nos Enclosure: 4 way 12 W SPN DB				
		2.00	set		

S.No	Description	Qty	Unit	Rate (Rs.)	Amount (Rs.)
e)	RAW POWER MCB DB: incoming 40 A 2 P MCB 1 Nos Outgoing: 10 A SP MCB 8 Nos Enclosure: 4 way TPN DB	1.00	set		
f)	AC POWER MCB DB: Incoming; 40 A 4 P MCB 1 No Outgoing: 20 A 2 P MCB 7 Nos Enclosure: 6 Way vertical DB	1.00	set		
II <u>FIXTURES & FITTINGS:</u>					
Supply, delivery at site, receiving, storing, handling carriage at site, assembling, erection including the down rods as required at site, connecting, testing and commissioning of the following Ceiling / wall mounted light fixtures including the lamps. (All fixtures to be of Wipro/Philips/Havells make only and lamps of GE / Osram make only). All electrical fixtures to be five star rated.					
a)	1 x 33 w LED square downlight Recess Mounted (Philips RC 375 B 30S) (2' x 2' fitting) (Incl Frame)	24	Nos		
b)	1 x 22 w Philips Square Ultraslim (Al body) 9"x 9"	9	Nos		
c)	1 x 15 w LED Ultraslim Round light (Al body)	6	Nos		
d)	1 x 5w / 7w LED Ultraslim spot light (Al body)	2	Nos		
f)	CG Wall Mount Fan (<i>Crompton / Usba</i>) with Metal enclosures	6	Nos		
g)	48" CG Highspeed Ceiling Fan (<i>Crompton / Usba / Havells</i>)	3	Nos		
h)	1 x 21 w LED Tube fitting Smart Bright 4feet (Al body)	10	Nos		
i)	Exhaust fan (9" exhaust almonored) Including provision for Opening & plstring wherever req (Toilet & UPS Battery Room)	3	Nos		
63					
II <u>General:</u>					
a)	Rectifying, Testing, Erection and Commissioning of existing light points with fittings	5	Nos		

S.No	Description	Qty	Unit	Rate (Rs.)	Amount (Rs.)
------	-------------	-----	------	---------------	-----------------

III EARTHING

- | | | | | | |
|---|---|---|-----|--|--|
| 1 | Providing dedicated earthing with 600 x 600 x 315 mm copper plate along with 50 mm dia. 10ft long GI pipe with other accessories in the earth filled with necessary salt, charcoal, etc, for upe it should be covered with GI manhole cover with necessary civil works. dedicated earth pit with earth resistance less than 1 ohm. A dedicated earth pit preferably the distance between one earth pit to another earth pit should not be less that 8ft inspection pit. | 1 | set | | |
| 2 | INSTALLATION OF UPS EARTH:
Providing earth station comprising of 300 X 300 X 3mm copper plate with earthing resistance less than 2 ohms including watering PVC/GI pipe with funnel excavation back filling salt filling salt and coal filling in layers 10" x 10" masonry chambers with sand plaster etc complete as per architect direction. | 2 | Nos | | |

TOTAL AMOUNT

Rs.

(In words: _____)

Notes: All items are excluding of GST and other applicable taxes, unless specified

TENDER SCHEDULE FOR THE DATA CABLING WORKS
AT M/s. INDIAN BANK, MANAMELKUDI BRANCH,PUDUKKOTTAI ,TAMIL NADU.

S.No	Description	Qty	Unit	Rate (Rs.)	Amount (Rs.)
I Telephone And Data Cabling Works					
1	Supply & laying of I.O Telephone point including cable in suitable PVC conduit pipe	7	Nos		
2	Supply & laying of 2 pair Telephone cable in suitable PVC conduit pipe	205	mtrs		
3	Supply & installation of RJ 11 Telephone socket(modular type)	7	Nos		
4	Supply & laying of 10 pair Telephone cable for Leased/ISDN Line including casing capping etc., Complete.	180	mtrs		
5	Supply & installation of 10 pair krone block in suitable MS Enclosure with locking arrangements	1	No		
6	Supplying & Fixing of HCL CAT 6 10/100/1000 Mbps UTP Cable including the cost of laying the cable & PVC conduit pipe etc.complete (including ATM)	295	mtrs		
7	Supply & installation of RJ 45 information Outlets (excluding ATM)	11	Nos		
8	Supply & providing of RJ 45 HCL CAT 6 patch cords - 3 Feet	11	Nos		
9	Supply & providing of RJ 45 HCL CAT 6 patch cords - 7 Feet	11	Nos		
10	Supply & Fixing of 10.5" 6U Rack with power manager & Cable Manager with fasteners including the cost of rack fixing etc.complete	1	No		
11	Supply & Fixing of HCL 24 Port 10/100/1000 Mbps Fast Ethernet Switch (existing to be reused)	1	No	N.A.	N.A.
12	Supplying & Fixing of HCL CAT 24 Port Patch Panel including punching & Fixing etc.complete	1	Nos		

TOTAL AMOUNT

Rs:

(Rupees: _____)

Notes: All items are excluding of GST and other applicable taxes, unless specified

Tender Schedule for Interior furnishing works for
M/s. Indian Bank, ATM of Manamelkudi Branch,Pudukkottai,Tamilnadu.

S.No	Particulars	Qty.	Unit	Rate (Rs.)	Amount (Rs.)
1	<p>FALSE CEILING (Gypsum Board)</p> <p>Providing and fixing suspended false ceiling, which includes providing and fixing G.I. Perimeter channels of size 0.55mm tk having one flange of 20mm and another flange of 30mm and a web of 27mm along with perimeter of ceiling, screw fixed to brick wall / partition with the help of nylon sleeves and screw at 610 mm centres. Then suspending G.I. Intermediate channels of size 45mm, 0.9mm thick with two flanges of 15mm each from the soffit at 1.22 mts centre to centre with ceiling angle of width 25mm x 10mm x 0.5mm tk fixed to soffit G.I. clean and steel expansion fasteners. Ceiling section of 0.55mm thickness having knurled web of 51.5mm and two flanges 26mm each with clips of 10.5mm are then fixed to the intermediate channel with the help of connecting clips and in direction perpendicular to the intermediate channel at 457mm centre to centre. 12.5mm tapered edge Star Brand / India Gypsum Gypboard (conforming to IS-2095-1982) is then screw fixed to ceiling sections with 25mm dry wall screws at 230mm centres. Screw fixing is done mechanically either with screwdriver or drilling machine with suitable attachment. Finally the boards Properly finished with topcoat as per Architect direction.</p> <p>(This includes painting) - Manager Cabin & Banking Hall</p>	40.00	Sft		
2	<p>FALSE CEILING (grid ceiling)</p> <p>Providinf and Fixing of ceiling tiles of size 600 mm x 600 mm with grid in GI (galvanized Iron) powder coated framing work as per manufacturer specification, cut-outs to be made for accommodating lighting fixtures. Ply backing of 4-6 mm should be provided for electrical fixtures. Armstrong, Nittobo, India Gypsum or equivalent make.</p>	53	Sft		

3 MAIN ENTRANCE DOOR

Fabrication and fixing of front entrance door made of 12mm thick glass (Fused Glass to be worked as per the design). With the help of 6" x 2½" Burma teak sections both on top and bottom. Brushed steel SS pipes worked as handrail per detail. The door is to be fitted with pivot on top and bottom with floor spring Everlite or ISI approved and all accessories etc complete.

(The above inclusive of stickers and frosting
Of bank logo, push pull stickers etc complete.)
(Size - 3'0" x 7'0")

25.00 Sft

4 EXTERNAL FIXED GLAZING

Providing and fixing external fixed glazing comprising of 8 mm Modifloat, Saint Gobain, Asahi or equivalent make clear glass with top, bottom and vertical frame comprising of black powder coated aluminium members. Approximate 82.5 to 100 mm top, bottom & vertical member with clip sections. Antishatter film to be laminated from inside the ATM room on one side of the glass. There can be a variation of plus or minus 15 mm in the dimensions of aluminium sections.

32.00 Sft

5 WOODEN PARTITION WITH 6MM PLY WITH ALUMINIUM SKELETON

Providing and fixing wooden partition comprising of 6 mm plywood on both sides, Skeleton of aluminum sections 50mm X50mm of Jindal or Indal make, 1.5' c/c both ways, laminate 1.0 mm on one side and enamel paint in 3 coats on other side, provision to be made to accommodate aircon louvers, provision for exhaust fan, grooves, to be made as per customized

design. Ply to be of IS 303, BWR grade OR IS 710 Grade (For internal work). Ply to be IS 710 Grade (For external work exposed to atmosphere). Partition above false ceiling should be covered with 9 mm ply on the visible side and should be finished with enamel paint on the other side. Provision for electrical conduits , switches etc to be made in the partition. Aluminum sections to be provided upto ceiling level, bottom of slab.

a)Between ATM machines (2'0" x 7'0"ht)

N.A Sft N.A N.A

b)Above Entrance door

40.00 Sft

c)Partition for UPS Room

N.A Sft N.A N.A

6	PANELING WITH 1.0 MM LAMINATE WITH 6MM PLY WITH ALUMINIUM SKELETON Providing and fixing in position ply paneling with Skeleton of aluminium sections 50mmX 38 mm of Jindal or Indal make, 2' 0"c/c both ways, 6 mm plywood with 1.0 mm laminate of approved shade and make, in plumb, line and level complete as directed. Ply to be of IS 303, BWR grade. Paneling above false ceiling will be covered with 6 mm ply without laminate.	281.00	Sft		
7	PLASTIC PAINT INTERNAL Providing and Fixing plastic paint in 2 coats of Asian /Nerolac/ ICI / JNN or equivalent make with surface preparation, primer and 2 coats of putty complete. (of approved shade)	N.A	Sft	N.A	N.A
8	STORAGE SHELF Providing and fixing a wooden shelf of size 3'6" x 2'0" x 2'6" ht comprising of 18mm thick marine ply with 1.5 mm laminate on top and bottom and all the exposed sides of 18mm thickness of the ply, with 3 coats of enamel or French polish paint, wire manager (circular slot) for passing cables, These shelves should be placed on the steel angles	N.A	LS	N.A	N.A
9	ROLLING SHUTTER BOX (Included in branch estimate) Box with open able shutter & ceiling in 19mm tk ply for rolling shutter servicing with support in wooden frame, etc& complete with paint finish on all the sides	N.A	Sft	N.A	N.A
10	WRITING LEDGE Fabricating and fixing of writing ledge and brochure holder size 4'0" x 1'0" made of 12mm glass supported with 18 mm marine plywood stand finished with duco automotive paint so as to match the color of the interiors. Glass edges beveled to half round shape suitably supported on plywood as per design. 4 mm tk plain glass without tints fixed in grooves for brochure holder as per design. The work has to be completed as per architect's direction.	1.00	No		

TOTAL

Rs:

(In Words:

)

Tender Schedule for Electrical Works at
M/s. Indian Bank, ATM of Manamelkudi Branch, Pudukkottai, Tamilnadu.

S.No	Description	Qty	Unit	Rate(Rs.)	Amount(Rs.)
Electrical Works – On Site ATM					
a	Supply & intallation of UPS Power 3Nos 6 A 3 Pin sockets, 1No 16A switch in suitable box - modular type.	3.00	Nos		
b	Supply & intallation of RAW Power 6 A 3 Pin sockets, 1No 16A switch in suitable box - modular type.	1.00	Nos		
c	4C x 4 Sqmm + 1R x 2.5 Sqmm copper cable from main DB to ATM main DB's .	30.00	mtrs		
d	2 x 4 Sqmm + 1R x 2.5 Sqmm copper wire from main DB to A/C units (2 A/c units)	30.00	mtrs		
e	2 x 2.5 sq mm + 1 x 1 sq mm MCB to ATM (2) UPS point	40.00	mtrs		
f	2 x 2.5 sq mm + 1 x 1 sq mm lightings from DB to switchbo:	25.00	mtrs		
g	P/F electrical cables / switches / sockets / distribution boards for ATM Room as below.				
h	3 Phase Main 4 way DB	1.00	No		
i	40 A 4 P MCB for incoming	1.00	No		
j	20 A 2 P MCB for outgoing including A/C	5.00	No		
k	10 A SP MCB for lighting	3.00	No		
l	20 A 2 P MCB DB with enclosure for UPS points	3.00	No		
m	Lighting points	6.00	No		
n	5/15 amps. Power points	4.00	No		
o	16 A 3 Pin Metal Plug & socket with 1No 25A SP MCB for A/C control	2.00	No		
4	<u>EARTHING</u>				
a	INSTALLATION OF UPS EARTH: Providing earth station comprising of 300 X 300 X 3mm copper plate with earthing resistance less than 2 ohms including watering PVC/GI pipe with funnel excavation back filling salt and coal filling in layers 10" x 10" masonry chambers with sand plaster.	1.00	No		

NET TOTAL AMOUNT (A)

Rs:

(Rupees: _____).

Notes: All items are excluding of GST and other applicable taxes, unless specified

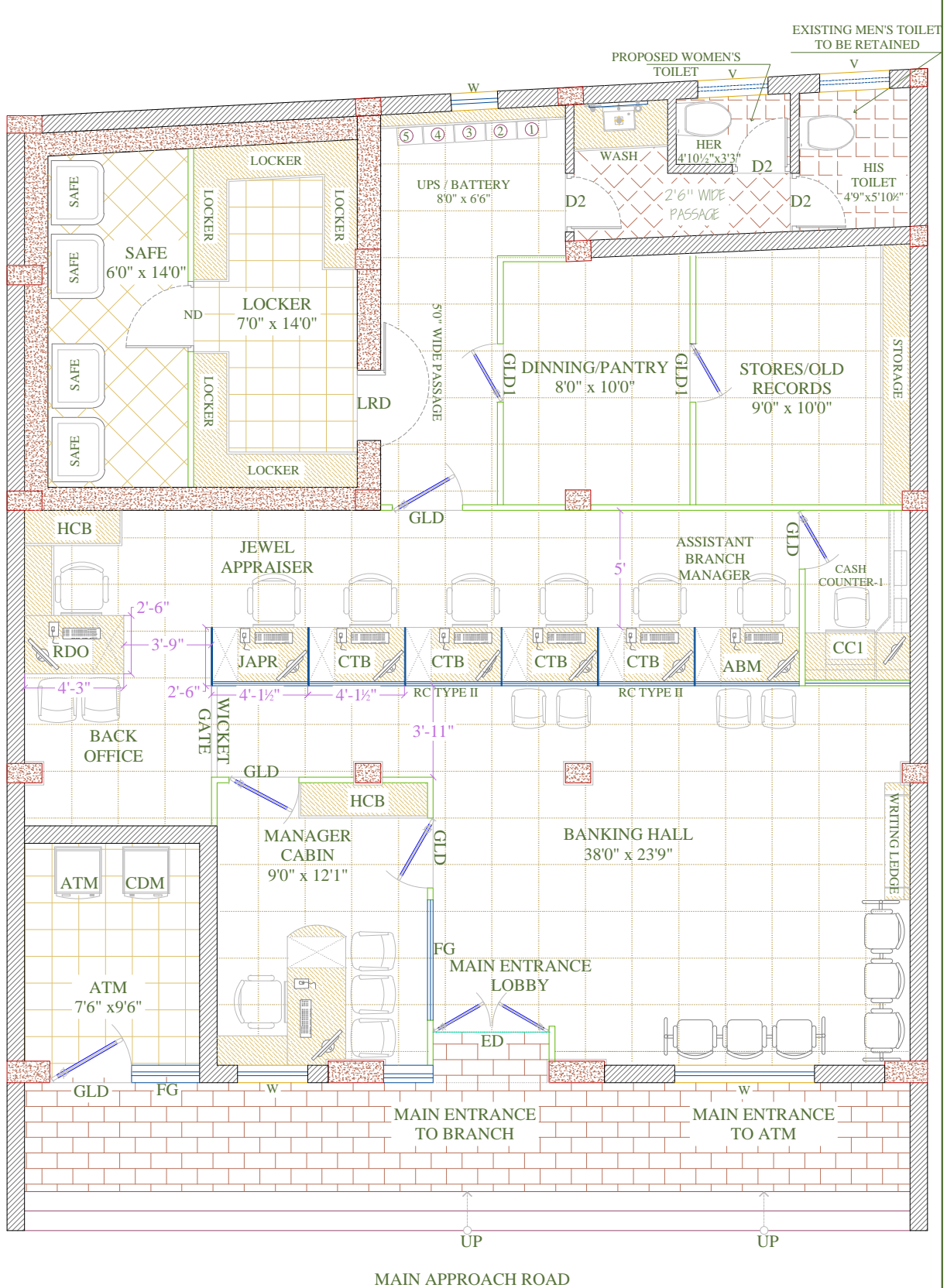

PROPOSED INTERIOR LAYOUT

PLAN FOR
M/S. INDIAN BANK,
AT MANAMELKUDI BRANCH,
TAMIL NADU.

NOTES:



SCALE:

ALL MEASUREMENTS ARE IN FEET & INCHES. THE DRAWING STRICTLY TO BE READ AND NOT MEASURED.

TITLE: SCHEMATIC DRAWING - INTERIOR LAYOUT PLAN
GROUND FLOOR PLAN OPTION VI

AVANT GARDE

ARCHITECT:
 S. VIJAY ANAND B. Arch, Mem COA, AIAA.

DESIGN CONSULTANTS

ARCHITECTURE & INTERIORS
 #1281, TRICHY ROAD
 COMBATORE - 641 018
 Ph: 98422 30124.

AREA DETAILS :

DRAWN BY: YASMIN

CHECKED BY: ANAND

DATE: 21.10.2024

PLATE NO:INB/MANAMELKUDI/SD/GF/INT/06

**PROPOSED INTERIOR LAYOUT
PLAN FOR
M/s. INDIAN BANK,
AT MANAMELKUDI BRANCH,
TAMIL NADU.**

NOTES:

NORTH

AREA DETAILS :

TITLE: SCHEMATIC DRAWING - ELECTRICAL LAYOUT PLAN
GROUND FLOOR PLAN OPTION VI

SCALE:

DRAWN BY: YASMIN

DATE: 21.10.2024

CHECKED BY: ANAND

ALL MEASUREMENTS ARE IN FEET & INCHES. THE DRAWING STRICTLY TO BE READ AND NOT MEASURED.

AVANT GARDE

ARCHITECT: S. VIJAY ANAND B. Arch, Mem COA, AIAA.

DESIGN CONSULTANTS
ARCHITECTURE & INTERIORS
#1281, TRICHY ROAD
COMBATORE - 641 018
Ph: 2301 246, Fax: 2301 191

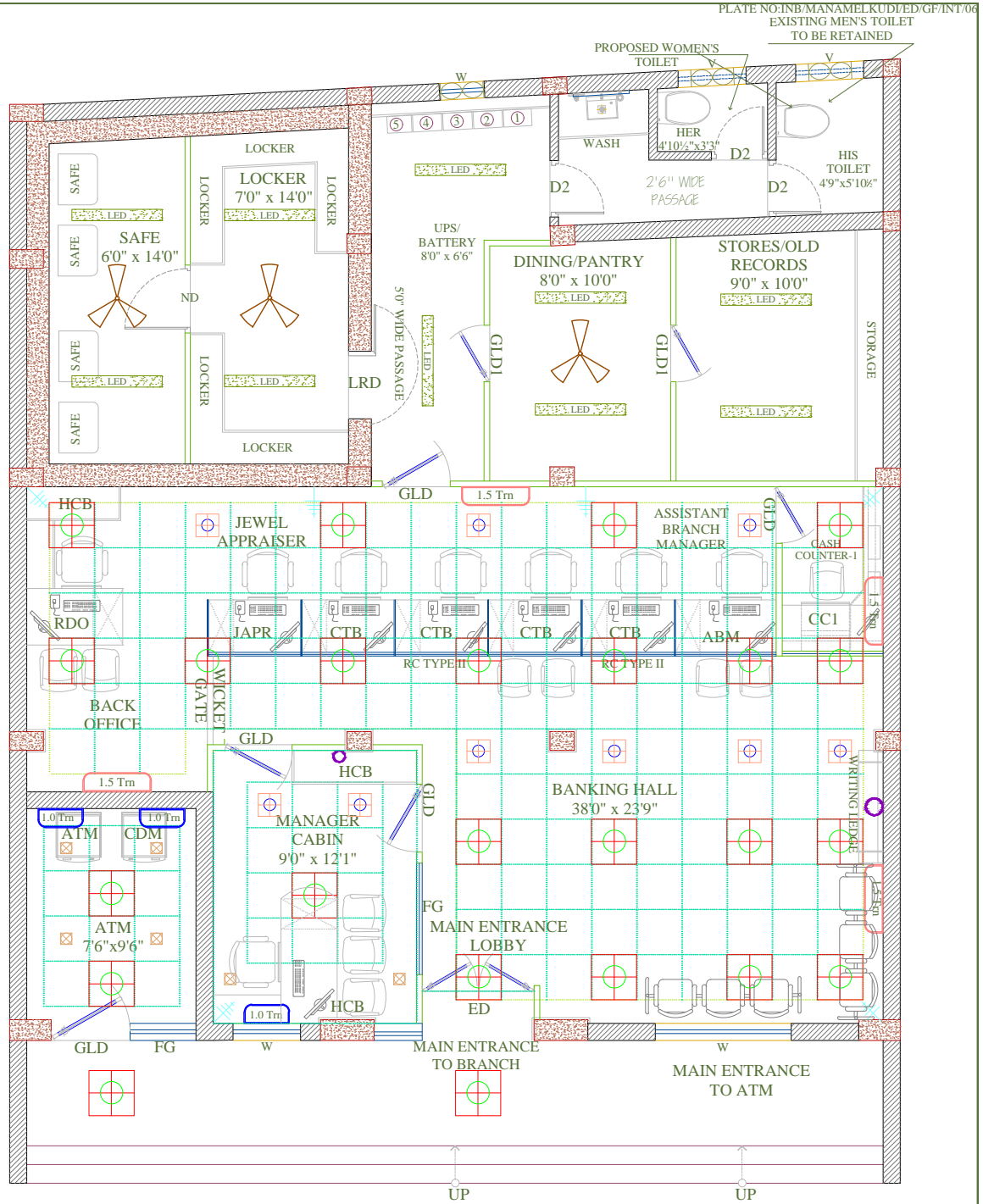

LEGEND:

	1 x 36 w LED (2' x 2') Square downlight	24 Nos		1x 21 w LED tubelight fitting (Philips smart bright)	10 Nos.		1.0 Trn AC unit	3 Nos
	1 x 22 w LED Ultraslim Square down light (9" x 9")	9 Nos		Wall Fan	6 Nos		1.5 Trn AC unit	4 Nos
	1 x 15 w LED Ultraslim Square down light	6 Nos.		Ceiling fan	03 Nos.		2.0 Trn AC unit	Nil
	1x 5/7 w LED Spot lights	2 Nos		Exhaust fan	03 Nos.		2.5 Trn AC unit	Nil

MAIN APPROACH ROAD

PROPOSED INTERIOR LAYOUT

PLAN FOR
M/S.INDIAN BANK,
AT MANAMELKUDI BRANCH,
TAMIL NADU.

NOTES:



NORTH

AREA DETAILS :

TITLE:
 FALSCE CEILING DRAWING - INTERIOR LAYOUT PLAN
 GROUND FLOOR PLAN OPTION VI

SCALE:

ALL MEASUREMENTS ARE IN FEET & INCHES
 THE DRAWING STRICTLY TO BE READ AND NOT MEASURED

DRAWN BY:
 YASMIN

CHECKED BY:
 ANAND

DATE: 21.10.2024

PLATE NO:INB/MANAMELKUDI/SD/GF/INT/06

AVANT GARDE

DESIGN CONSULTANTS

ARCHITECTURE & INTERIORS
 #1281, TRICHY ROAD
 COIMBATORE - 641 018
 Ph:98422 30124.

ARCHITECT:
 S.VIJAY ANAND B.Arch, Mem COA, AIIA.

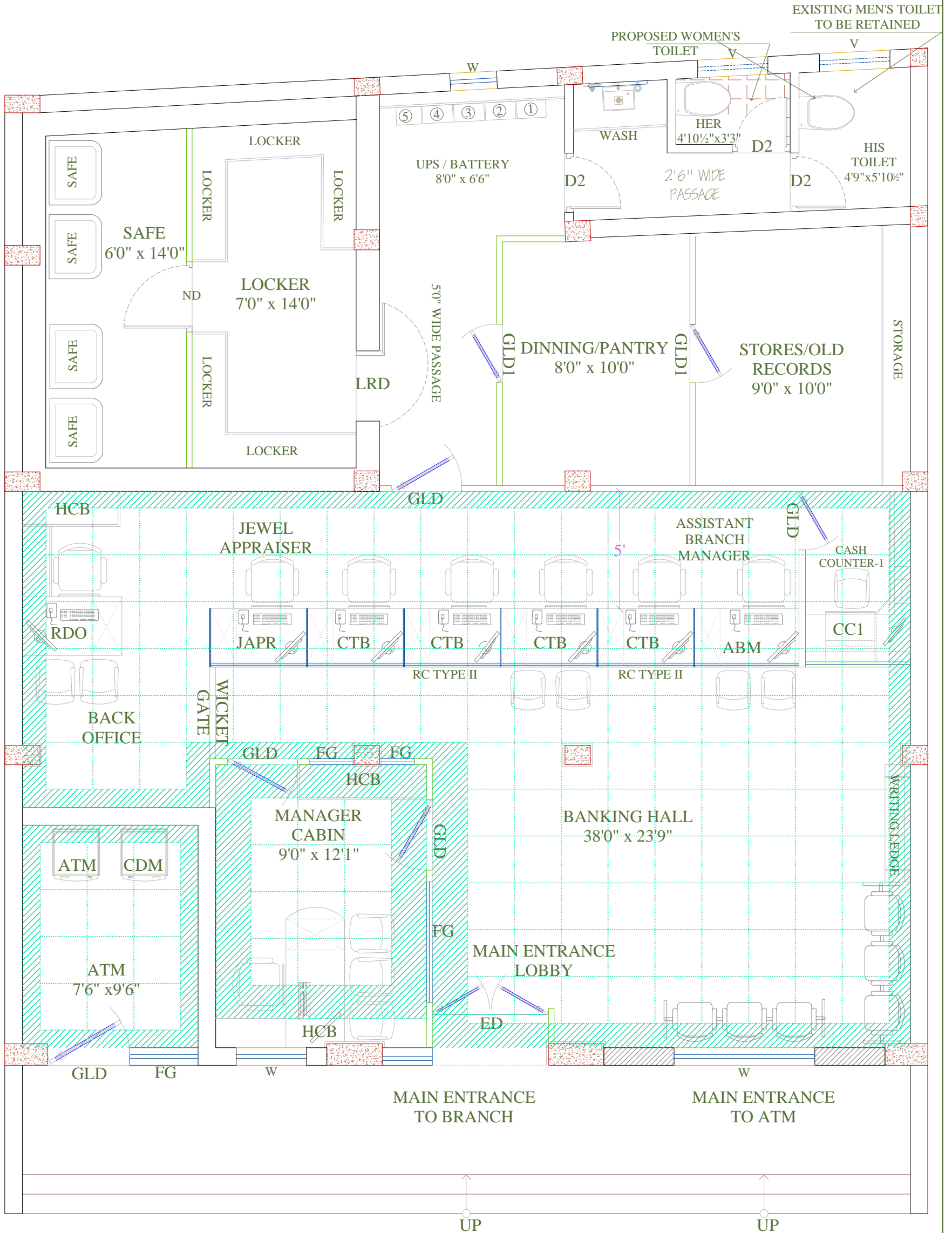

LEGEND



2x2 grid false ceiling to detail (armstrong)

MAIN APPROACH ROAD

UP

UP

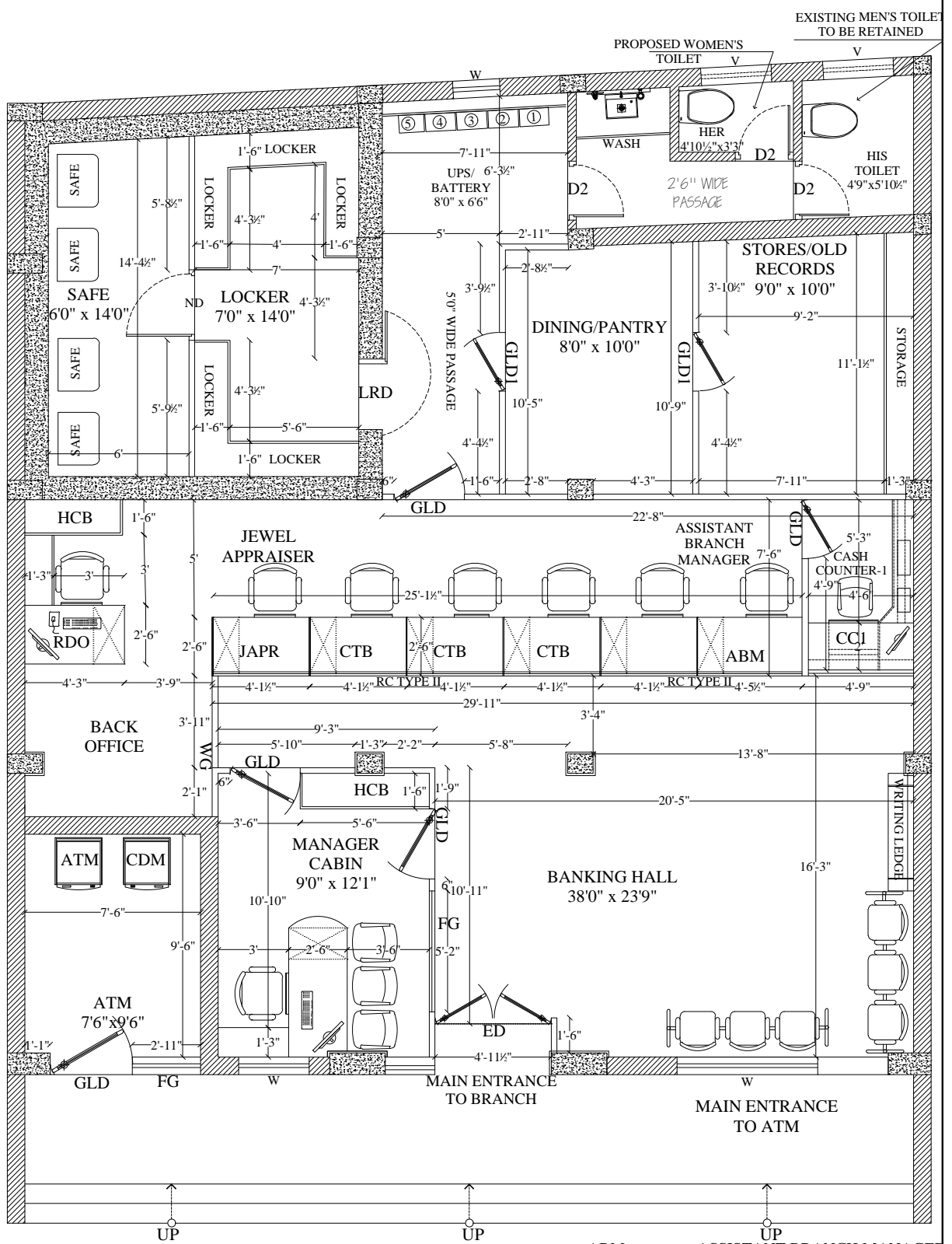

LEGENDS		MAIN APPROACH ROAD		ASSISTANT BRANCH MANAGER	
ED	ENTRANCE DOOR	LRD	LOCKER ROOM DOOR	ABM	JEWEL APPRAISER
GLD	GLAZED DOOR	CC	CASH (COUNTER) CABIN	JAPR	RUNING COUNTER TYPE II
ND	NORMAL DOOR	MTB	MANAGER'S TABLE	FCB	FULL HEIGHT CABINET
		OTB	OFFICER'S TABLE	HCB	HALF HEIGHT CABINET
				CC	CARPET

PROPOSED INTERIOR LAYOUT

PLAN FOR
M/S. INDIAN BANK,
AT MANAMELKUDI BRANCH,
TAMIL NADU.

NOTES:

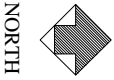

NORTH

TITLE: WORKING DRAWING - INTERIOR LAYOUT PLAN
GROUND FLOOR PLAN OPTION VI

SCALE: N.T.S

ALL MEASUREMENTS ARE IN FEET & INCHES & THE DRAWING STRICTLY TO BE READ AND NOT MEASURED

ARCHITECT: S. VIJAY ANAND Barch, Mem COA, AIAA.

DESIGN CONSULTANTS
ARCHITECTURE & INTERIORS
#1281, TRICHY ROAD
COMBATORE - 641 018
Ph: 2301 246, Fax: 2301 191

AREA DETAILS :

DRAWN BY: YASMIN

CHECKED BY: ANAND

DATE: 21.10.2024

PLATE NO:INB/MANAMELKUDI/WD/GF/INT/06