

**PROJECT**

**PROPOSED INTERIOR FURNISHING FOR INDIAN BANK AT THARANGAMBADI BRANCH**

**NOTE**

- 1) ALL DIMENSIONS ARE IN FEET & INCHES
- 2) DRAWING TO BE READ IN CONJUNCTION WITH DETAILS
- 3) ALL DESCREANCIES MUST BE BROUGHT TO THE NOTICE OF THE ARCHITECT
- 4) SAMPLE OF FURNITURE TO BE APPROVED BEFORE EXECUTION

**AREA DETAILING**

BANKING HALL	4204	SFT
SAFE ROOM	296	SFT
ATM	100	SFT
TOTAL	1600	SFT

**FALSE CELING AREA**

BANKING HALL	999	SFT
ATM	100	SFT
TOTAL		

**SCHEDULE OF JOINERIES (PROPOSED)**

MD	SEMI GLAZED DOOR	5'0" X 7'0"
SD	SAFE ROOM DOOR	3'6" X 7'0"
D	SEMI GLAZED DOOR	3'0" X 7'0"
D1	SEMI GLAZED DOOR	2'6" X 7'0"
D2	SEMI GLAZED DOOR	2'6" X 5'0"
D3	FLUSH DOOR	3'0" X 7'0"
D4	FLUSH DOOR	2'6" X 5'0"
WD	WICKET DOOR	3'0" X 3'0"
SC	SIDE CREDENZA	2'6" B

**TITLE**

**WORKING DRAWING**



**DRAWN : D.J.VIJAY**

**SCALE : 1"=8'0"**

**JOB NO: I5-2024**

**DATE : 16.09.2024**

**SHEET SIZE: A4**

**ARCHITECT**

**Ar. T.MAYILVAHANAN, M.E., A.I.I.A., M.C.A., P.h.d.,**

**COS CONSULTANCY SERVICES**

ARCHITECTURE, INTERIORS, STRUCTURAL ENGINEERS & DESIGNERS

6/13, Kamaraj Nagar 4th Street,

Tallakulam, Madurai - 625002

Phone : 0452 - 2521869

Email id: cosquant93@gmail.com

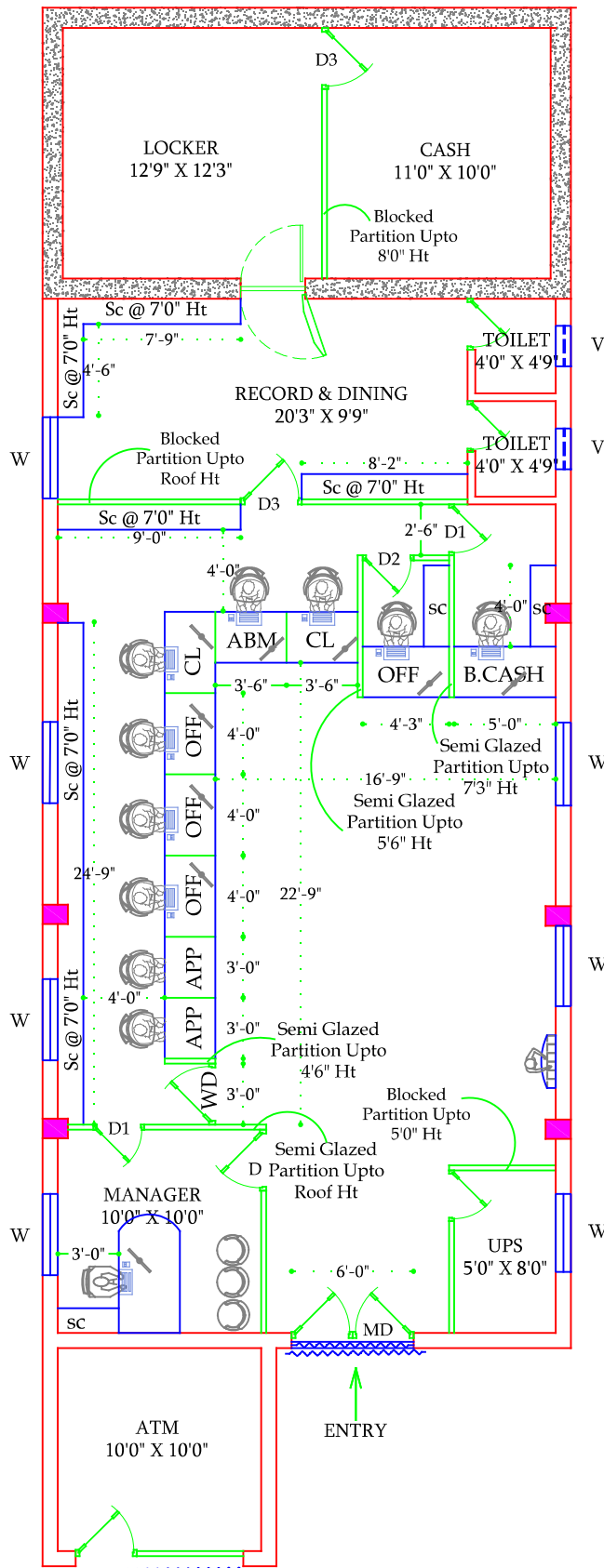

V

V

W

W

W

10