

BOQ. AUNDHAI ,BRANCH, RAJNANDGAON.**INTERIOR WORKS**

S.NO	ITEM AND SPECIFICATION	QTY	UNIT	RATE	AMOUNT
1	<u>PARTITION</u>				
a	<u>PARTIALLY GLAZED PARTITION</u>	233.00	sqft		
	Providing and fixing at site Partly glazed wooden partition with 2" x 2" pine wood/ hard wood section to be fixed as a frame to the partition placed at 2' x 3' c/c, the frame is to be sandwich with 6.0mm commercial ply from both the sides and to be finised with approved shade of 1.0mm laminated finish, the middle portion of the parititon to have larger openings (as per the drawing) with 8.0mm glass with approved itching pattern. All the exposed edges to be finished with steam wood beadings properly polished to match the existing shade of laminates. The cost of partition shall include all labour, materilas, etc complete.				
b	<u>SOLID / OPAQUE PARTITION</u>	193.30	sqft		
	Providing and fixing at site Opaque wooden partition with 2" x 2" pine wood/ hard wood section to be fixed as a frame to the partition placed at 2' x 3' c/c, the frame is to be sandwich with 6.0mm commercial ply from both the sides and to be finised with approved shade of 1.0mm laminated finish, the middle portion of the parititon to have larger openings (as per the drawing). All the exposed edges to be finished with steam wood beadings properly polished to match the existing shade of laminates. The cost of partition shall include all labour, materilas, etc complete.				
2	<u>DOOR OF PARTITION</u>				
a	<u>DOOR FOR GLAZED PARTITIONS</u>	66.50	sqft		
	Providing & fixing at site 35 mm thick flush doors shutters of approved make to be laminated on both faces with 1.0 mm thick laminate of approved colour & make with 35 x 5mm steam beach wood beading on edges of door. The door is to be fixed to main frame made with 4" heavy duty brass hinges The glass portion is 8 mm. thick float glass with itching.All edges of the door shall have steam beech wooden beading propoerly polished to match the existing laminated finish. door closer, mortice locks, door stoppers, handles all acessories, labour etc. complete.				
b	<u>DOOR FOR OPAQUE PARTITIONS</u>	52.50	sqft		
	Providing & fixing at site 35 mm thick flush doors shutters of approved make to be laminated on both faces with 1.0 mm thick laminate of approved colour & make with 35 x 5mm steam beach wood beading on edges of door. The door is to be fixed to main frame made with 4" heavy duty brass hinges.All edges of the door shall have steam beech wooden beading propoerly polished to match the existing laminated finish. door closer, mortice locks, door stoppers, handles all acessories, labour etc. complete.				
3	<u>FULLY GLAZED PARTITION(TOUGHNED)</u>	35.00	sqft		
	Providing and fixing of fully glazed partion with 12mm thick toughned glass fitted with heavy duty SS patch fittings at the interval of mimimum 2' interval at top, bottom and sides as per site condition.				
4	<u>ENTRANCE DOOR/façade</u>	25.00	sqft		
	Providing and fixing of fully glazed door with 12mm thick toughned glass fitted with heavy duty SS patch fittings at the interval of mimimum 2' interval at top, bottom and sides as per site condition.				
5	<u>STORAGE</u>	54.00	sqft		
	Providing and fixing at site storage cabinet fully covered from all sides and 16" deep including necessary shelves as per the design and specifications				

	with openable shutters made up of 19mm BWP ply, The rear portion is to be closed with 8.0mm ply. Front of the cabinet is to be finished with 1.0mm thick laminate with approved pattern with different colour laminated finish of approved shade & colour with Proper Steam Beachmoulding, beadings, and different colour laminate as per pattern in shutters and in skirting strictly as per the design, pattern, including all necessary fittings, such as locks,handles. The inside portion is to be finished with .8 laminate. The cost shall include all materials, labour, accessories etc complete.				
6	<u>FALSE CEILING</u>				
	<u>GYPSUM CEILING</u>	347.00	sqft		
	Providing and fixing gypsum false ceiling. in 12.5mm thick Gypboard (POP) plain false ceiling with GI suspended from RCC slab/ Beam as approved by Bank/ Architect including G.I. Parameter Channels of size 0.55 mm thick having one flange of 20mm and another flange of 30mm and web of 27mm along with parameter of ceiling,screw fixed, to the brick wall / partition with the help of nylon sleeves and screws at 600mm C/C. The suspended G.I. Intermediate channels of size 45 x 0.9 mm thick with two flanges of 15mm each from the soffit at 1200mm C/C with GI cleats and steel expansion fasteners. Ceiling sections of 0.55mm thick having web of 51.5mm and two flanges of 26mm each with lips of 10.5mm are then fixed to intermediate channel with help of connecting clips and in direction perpendicular to intermediate channel at 457 mm C/C. 12.5mm Tapered edge Gypboard channel at 457mm C/C in both the directions screwed fixed to the ceiling section with 25mm dry wall screws at 230mm C/C screw, fixing is done mechanically with drilling machine and suitable attachment. Finally the boards are to be jointed and finished with jointing compound, paper tape and two coats of top Coat, suitable for Gypboard (As recommended practice of India Gyp.) For light fittings incutouts etc are to be made with a frame of parameter channels of size 20 x 27 x 30 x 0.5mm thick supported suitably. Angle beads, edge bends, control joints as required to be provided. The quoted rates to include all the above items, ceiling to be painted with minimum two coats of plastic emulsion paint including base preparation. etc. complete.				
	<u>ARMSTRONG CEILING</u>	512.00	sqft		
	Providing and fixing of false ceiling at all heights of 600mmx600mmx12mm armstrong mineral fiber ceiling tiles of type IBIZA RH-90 laid on armstrong prelude XL exposed grid systems with 9mm wide T Section flanges colour white. The frame work comprise of main runner spaced at 1200mm centers securely fixed to the structural soffit approved hangers at 1200mm maximum centers. Hangers (GI wire) to be fixed by approved roof plug and screws etc. The last hanger at the end of each main runner should not be greater than 450mm from the adjacent wall. flush fitting 1200mm along cross tees (with double stitching) to be interlocked between main runners at 600mm c/ c to form 1200x600mm modules. Cut cross tees longer than 600mm to be supported independently. 600mmx600mm modules to be formed by fittings 600mm long flush fitting cross tees centrally between the 1200mm cross tees. Perimeter trim to be armstrong wall angle secured to walls at 450mm maximum centers.				
7	<u>PANELLING</u>				
a	<u>WALL PANELLING</u>	50.00	sqft		
	Providing and fixing at site column paneling with IInd class steam beach wood 2" x 1.25" battens to be fixed over column as per the requirement to be finished with 9.0mm BWP Grade ply finished with Mettalic colour laminated finished with given design. The cost shall include all materials, labour etc complete.				

8	<u>MISCELLANEOUS</u>				
a	<u>NOTICE BOARD</u>	1.00	nos		
	Providing & fixing at site notice board of size 3' x 2' to be made up of Steam Beach wood frame of size 2" x 1" wooden section with 5.0mm plain glass The Notice board shall have 19.0mm soft board lining at back with approved shade of cloth, and lockable shutter strictly as per the design & drawing etc complete.				
b	<u>SUGGESTION & COMPLAINT BOX</u>	2.00	nos		
	Providing & fixing at site drop & complaint box of size 1' x 1'3" to be made up of 1st class Steam Beach frame of size 1" x 1" wooden section in front 6.0mm plain glass The boxes shall have 12.0mm ply with approved shade of laminate, and lockable shutter strictly as per the design & drawing etc complete.				
	<u>WRITING LEDGE</u>	1.00	nos		
c	Providing & fixing of writing desk made of 18mm plywood & 1.0mm thk laminate. The 12mm glass top writing desk must be fixed at 3'9" ht from the floor & pockets for keeping the vouchers must be fixed on the desk top. All the external exposed surfaces of the desk must be covered with laminates. All inner surfaces must be finished with one coat of primer & three coats of synthetic enamel paint. All the edges / corners must be protected with 6mm thk teak wood plain bead The top edge of the skirting must be protected with 12mmX12mm quarter round of teak wood. All the teak wood must be finished with three coats of clear zink polish.				
d	<u>DOOR FIXTURES:</u>				
	Providing and fixing of door fixtures.				
	a) Door handle mortise type Godrej, Door set make	6	nos		
	b) Door Stopper	7	nos		
	c) Floor Machine	2	nos		
	d) Door closure	7	nos		
	e) SS handle 12" long	4	nos		
	GLASS FILM:	50.00	Sqft		
	BANK LOGO:	2.00	nos		
2	<u>FURNITURES</u>				
	Providing & fixing of furnitures of 18mm, 12mm & 6mm thk ply wood. Table top & shutters of 18mm thk ply wood & 1.0mm thk laminate. The table top & all other surfaces must be covered with laminates. All inner surfaces must be finished with one coat of primer & three coats of synthetic enamel paint. All the edges / corners must be protected with 6mm thk teak wood plain bead. 4" high skirting of 12mm thk plywood must be fixed to all the exposed outer surfaces of the table & must be covered with laminate.				
a	BM table 5'6" x 2'6" x 2'6"	1.00	NOS.		
	Side Credenza 3'x1'6"x2'6"	3.00	NOS.		
	Officer's Table 5'x2'6"x2'6"	2.00	NOS.		
10	Dismetalling of existing civil & Electrical work if any as per architect in charge.	1.00	NOS.		
	<u>TOTAL FOR INTERIOR WORKS</u>				

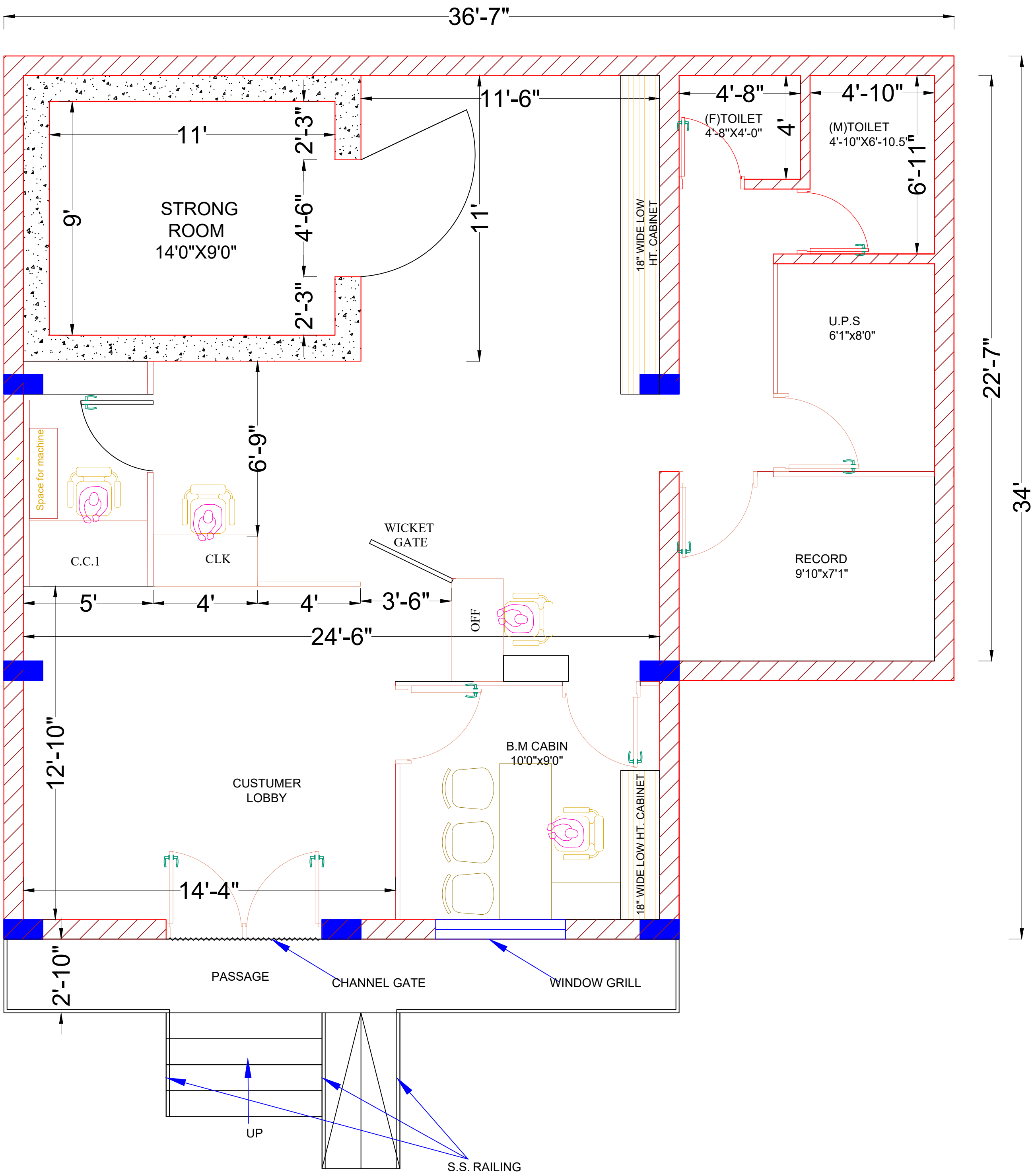

DATE	27-12-2024	REV.	01
SCALE	NTS	CHECKED BY	AR. PIYUSHRAJ VERMA
DESIGN BY	AR.ANSHUL SENGAR	DRAWN BY	ER. CHANDRAHAS

THIS DRAWING AND THE DESIGNS ON WHICH IT IS BASED ARE THE COPYRIGHT AND PROPERTY OF MS. G.T DESIGN STUDIO AND THEIR USE IS CONDITIONED UPON THE USERS AGREEMENT NOT TO REPRODUCE OR TO USE FOR ANY OTHER PURPOSE WHOLLY OR IN PART ANY DETAILS THEREIN WITHOUT THE SPECIFIC WRITTEN PERMISSION OF MS. G.T.DESIGN STUDIO,RAIPUR.

DWG TITLE	PROPOSED LAYOUT PLAN AREA-(922.00 SQUARE FT.) (EXCLUDING WALLS, COLUMN)
PROJECT TITLE	INDIAN BANK BRANCH AUNDHAI (C.G) RAJNANDGANV (C.G.)

ARCHITECT	G.T. DESIGN STUDIO ARCHITECTS + PLANNERS + INTERIOR DESIGNERS ENGINEER'S + PROJECT MANAGEMENT'S " ? ? ? ? ? "
P-27,Kavita Nagar,Avanti Vihar,Raipur-492001,Chhattisgarh. Voice :- +91-9424114546,+91-9907402063 Off.-0771-4011330 Email :- gtdsarchitect@gmail.com,gt_designstudio@rediffmail.com	

SHEET NO.	AD01
-----------	-------------

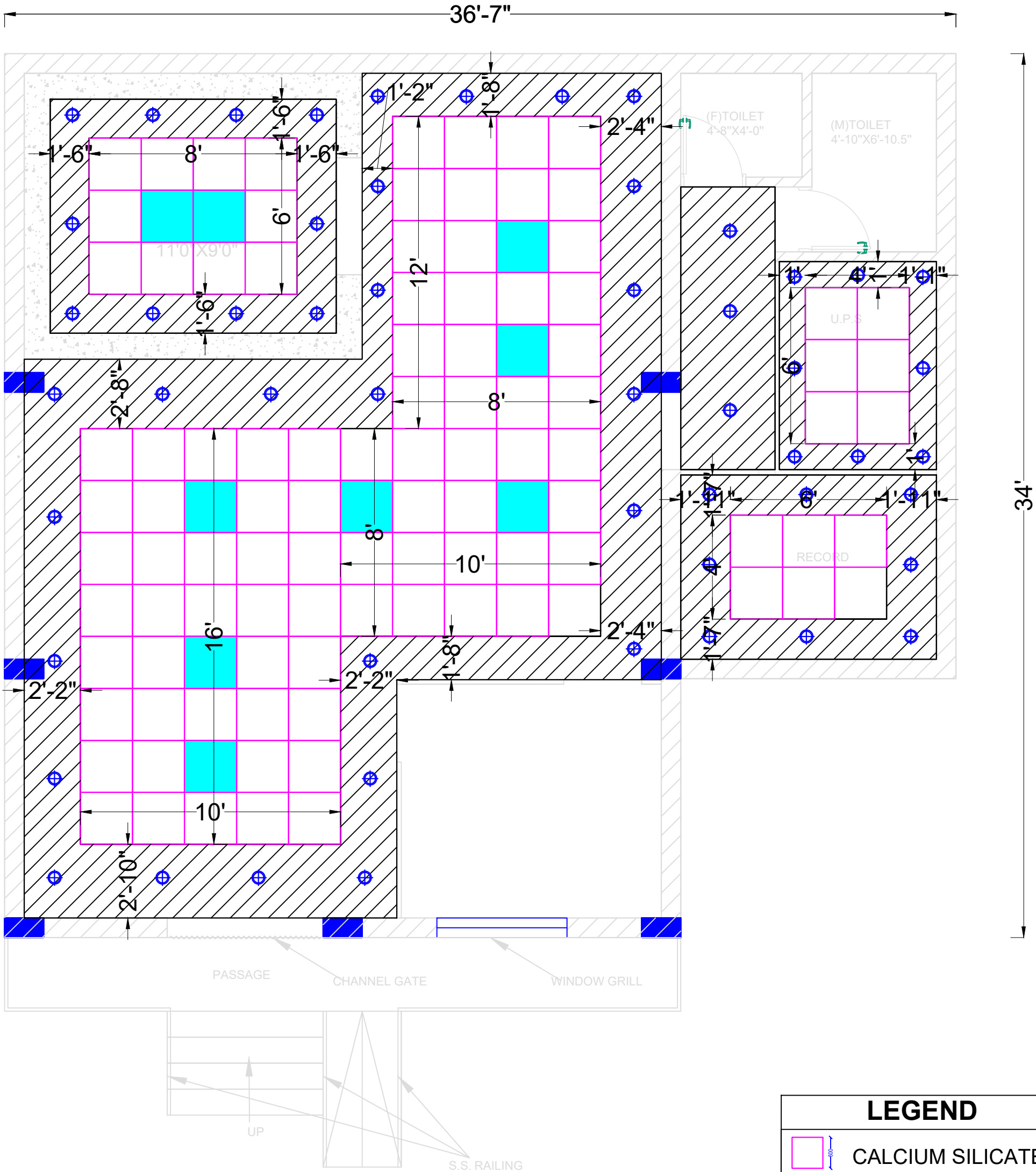

LEGEND

CALCIUM SILICATE

GYPSUM

DATE	25-09-2024	REV.	00
SCALE	NTS	CHECKED BY	AR. PIYUSHRAJ VERMA
DESIGN BY	AR.ANSHUL SENGAR	DRAWN BY	ER. CHANDRAHAS

DWG TITLE

PROPOSED FALSE CEILING LAYOUT
(EXCLUDING WALLS, COLUMN)

ARCHITECT

G.T. DESIGN STUDIO

ARCHITECTS + PLANNERS + INTERIOR DESIGNERS

ENGINEER'S + PROJECT MANAGEMENT'S

" ? ? ? ? ? "

P-27,Kavita Nagar,Avanti Vihar,Raipur-492001,Chhattisgarh.
Voice :- +91-9424114546,+91-9907402063 Off.-0771-4011330
Email :- gldsarchitect@gmail.com,gt_designstudio@rediffmail.com

SHEET NO.

AD02

PROJECT TITLE
INDIAN BANK BRANCH AUNDHAI (C.G)
RAJNANDGANV (C.G.)

THIS DRAWING AND THE DESIGNS ON WHICH IT IS BASED ARE THE COPYRIGHT AND PROPERTY OF MS. G.T.DESIGN STUDIO AND THEIR USE IS CONDITIONED UPON THE USERS AGREEMENT NOT TO REPRODUCE OR TO USE FOR ANY OTHER PURPOSE WHOLLY OR IN PART ANY DETAILS THEREIN WITHOUT THE SPECIFIC WRITTEN PERMISSION OF MS. G.T.DESIGN STUDIO,RaIPUR.