PART-A

TENDER DOCUMENT

(Terms & Conditions with Drawings)

PROPOSED INTERIOR FURNISHING & ELECTRICAL WORKS OF “INDIAN BANK- BRANCH- HAMIDIA ROAD-2, DISTT- BHOPAL (M.P.)

ASHISH SHRIVASTAVA

(CHARTERED ARCHITECT& INTERIOR DESIGNER)

KUSHI & ASSOCIATES

(Architects, Interior Designers & Govt. approved Valuers)

11, Swastik Complex, Russel Crossing

Jabalpur – 482001 ,

Mob. 9425150793, 9131343384,

E-mail : kushiarchitect101222@gmail.com

**TENDER DOCUMENT FOR INTERIOR FURNISHING, &
ELECTRICAL WORKS OF “INDIAN BANK- BRANCH- BRANCH-
HAMIDIA ROAD-2, DISTT- BHOPAL (M.P.)”**

- SALE OF TENDER STARTS ON: 25.07.2025 FROM 10.00 A.M.
- SALE OF TENDER CLOSING ON: 18.08.2025 UP TO 2.00 P.M.
- LAST DATE OF SUBMISSION: 18.08.2025 UP TO 3.00 P.M.
- DATE OF OPENING: 18.08.2025 AT 03:30 P.M.

NAME OF THE FIRM : -----

ADDRESS OF FIRM : -----

SECTION – 1

NOTICE OF INVITATION TO TENDER

Sealed, item rate, tenders are invited in the prescribed format from experienced contractors empanelled for carrying out jobs in Indian bank Bhopal zone for execution of "INTERIOR FURNISHING & ELECTRICAL

WORKS OF "INDIAN BANK"- BRANCH-HAMIDIA ROAD-2, DISTT- BHOPAL (M.P.) As per following details:

Name of the work :	"INTERIOR FURNISHING & ELECTRICAL WORKS OF " INDIAN BANK"- HAMIDIA ROAD-2 BRANCH, DISTT- BHOPAL (M.P.)
Tender Fees	: Rs.250.00 by way of DD in favour of Indian Bank payable at Bhopal
Earnest Money Deposit	: Rs.5,000.00 by way of DD in favour of Indian Bank payable at Bhopal (*Firms registered with MSME / NSIC with valid certificates issued by GOI are exempted from submitting EMD along with bid.)
Percentage if any to be deducted from bills	: 10% (Retention money of the contract value)
Period of Completion	: 4 (FOUR) weeks
Validity of Tender	: 90 days
Date of Issue of Tender	: From 25.07.2025 up to 10:00 AM on 18.08.2025 on any working day during Office hours
Tender Cost	: 10,67,358.00 (approx)
Last date of submission of Tender	: Up to 3.00 p.m. on 18.08.2025
Date & Time of opening the Tender	: 3.30 p.m. on 18.08.2025

1) The tender document can be downloaded from our bank's website / GOVT. portal or obtained from the Office of the Deputy General Manager, Indian Bank, Zonal Office, BHOPAL (M.P.) Pin 462023 and should be submitted in original, dully stamped, and sealed in the same office with requisite tender fees.

2) The item rates under the contract include for full, final & entire completion of all works in all respects described in contract & as shown in drawings forming part of the contract. Contractor must quote item rates for all the items of work. Tenders will be opened in the presence of contracting agencies or their authorized representatives.

3) Tenders are to be submitted in a sealed envelope cover super scribed "Tender for "INTERIOR FURNISHING & ELECTRICAL WORKS OF " INDIAN BANK"- BRANCH-HAMIDIA ROAD-2, DISTT- BHOPAL (M.P.) The tenderer must use only the tender forms issued for the purpose to fill in the rates intimation of tender quoted by letter, telegram / telex will not be acceptable.

4) Tenderers are advised not to make any alternation / modification in the tender documents, item of work or in any respect whatsoever. Violation of this requirement will make the Tender Liable for rejection.

5) If any information furnished by the applicant is found incorrect at a later stage, he shall be liable to be debarred from taking up the work in Indian Bank.

6) The Bank reserves the right to verify the particulars furnished by the applicant independently.

7) Bank is not bound to accept the Lowest (L1) bidder and reserves the right to accept or reject any or all the tenders without assigning any reason whatsoever.

8) In case of postal delivery, the tenderer has to ensure that tender is reached before the due date and time. The bank will not be responsible for damage in the transit and delay of receipt to tender, if any or sent by a special messenger. Tender received late shall be rejected.

9) Bidder Should be in same line of activity minimum for the past 3 years in carrying out similar nature of works ending 31.03.2025. (Please furnish Work Order / Client's Completion Certificate / Empanelment Letter issued by PSBs / PSUs / Central Government / State Government to confirm the same.)

10) Bidder Should have Registered Office in Bhopal and Should have valid GST No. (Please furnish requisite document as proof.)

11) Every page of the tender documents should be signed by the person or persons submitting the tender in token of his / their having acquainted himself / themselves with the General and Special Conditions of Contract, Specifications etc., as laid down. Any tender with any of the documents not so signed will be subjected to rejection.

12) No consideration will be given to a tender received after the time stipulated above and no extension will be allowed for submission of the tender. The Union Bank of India shall not be bound to accept the lowest tender and reserves the right to accept or reject any or all the tenders without assigning any reason whatsoever.

13) This notice inviting tenders, the conditions of tender and the duly completed form of tender etc. will form part of the Agreement to be executed by the successful tenderer with the bank.

The following document forming a part of tender are enclosed herewith

1. Introduction
2. Tender Notice
3. Special Instructions & Conditions
4. Letter of Offer
5. Form of Agreement
6. Preamble to B.O.Q.
7. Mode of Measurement
8. List of Approved Manufacturers for Materials
9. Bill of Quantities

This tender notice shall form part of the contract and non-submission of tender in the above manner will render your offer liable for rejection.

FOR INDIAN BANK, ZONAL OFFICE, BHOPAL
DGM

TENDER NOTICE

Subject: “INTERIOR FURNISHING & ELECTRICAL WORKS OF “INDIAN BANK”- BRANCH-HAMIDIA ROAD-2, DISTT- BHOPAL (M.P.)

Sealed item rate tenders are invited by Deputy General Manager, **Indian Bank, Zonal Office, BHOPAL (M.P.) Pin 462023**. The work to be completed within **4 weeks** from 7th days of the date of acceptance of work order placed by Indian bank.

The tenderers are required to complete form of tender, price the schedule of quantities and sign each page of tender documents before submission. The completed set is to be enclosed in a sealed envelope addressed to: Deputy General Manager, **Indian Bank, Zonal Office, BHOPAL (M.P.) Pin 462023**.

1. Tenders will be received up to **18.08.2025** hours on **15.00 hrs**.
2. No tender will be received after the expiry of the time notified for receiving tenders under any circumstances whatsoever.
3. The tender will be opened at **15.30** hours on **18.08.2025** at above address in the presence of authorized representatives contracting agencies.
4. Tender shall remain valid for acceptance for a period of 90 days from the notified last date of tender submission.
5. The Bank reserves the right to reject any or all tender received without assignment of any reasons thereof.
6. The tender rate against each item of work / price indicated in the schedule of quantities and rates / price should be indicated both in words and figures. In case of any discrepancy, the rates indicated in words would prevail.
7. The rates quoted against each item of work / price should be for the complete finished item of work and include all labor, material, taxes, overhead, duties, etc. Any statutory change in the tax structure after opening of the tender shall be reimbursed by the Bank as per actual.
8. **Successful bidder i.e., L1 agency after getting the contract has to deposit Rs. 5000.00 (Micro and Small Enterprises (MSEs) as defined in MSE Procurement Policy issued by Department of Micro, Small and Medium Enterprises (MSME) as performance security in the form of DD in name of INDIAN BANK Payable at Bhopal which will form part of retention money and will be kept with Bank for a period of 12 months i.e., defect liability period. No interest shall be payable on amount withheld in the shape of security deposits. (Total of performance security and retention money)**
9. L1 Agency will be required to submit a Bid Security Declaration accepting that if they withdrawer modify their Bids during the period of validity, or if they are awarded the contract and they fail to sign the contract, or to submit a performance security before the deadline defined in the request for bids documents, they will be suspended for the period of time specified in the request for bids documents from being eligible to submit Bids for contracts with the entity that invited the Bid.
10. Performance Security paid by contractor shall be forfeited by the Bank if contractor fails to undertake the job if he is communicated about acceptance of his rates.
11. All tenders in whom any of the prescribed conditions are not fulfilled or incomplete in any respect are liable to be rejected. This tender notice shall form part of the contract documents.

GENERAL CONDITIONS OF CONTRACT

Subject: “INTERIOR FURNISHING & ELECTRICAL WORKS OF “INDIAN BANK”- BRANCH-HAMIDIA ROAD-2, DISTT- BHOPAL (M.P.)

General Instructions to Contractor:

Inspection of sites: The contractor shall visit and examine the site and satisfy as to the nature and correct dimensions of work and facilities for obtaining material and shall obtain generally his own information on all matters affecting the execution of work. No extra charge made in consequence of any misunderstanding or incorrect information on any of these points on the ground of insufficient description will be allowed. All expenses incurred by the contractors in connection with obtaining information for submitting this tender including his visit to site and efforts in compiling the tender shall be borne by the tenderer and no claims for reimbursement thereof shall be entertained.

Safety Regulations: The contractor shall take all the necessary precautions while working and to safeguard adjacent property, Bank's property, Bank's employees, and traffic persons

Compliance to local laws: The contractor shall conform to the provisions of any Act of the Legislature relating to the work and to the Regulation of Bye Laws of any authority. He shall also obtain the permission of the Municipality or any other Authorities if required under the existing rules.

Site cleaning: All the rates quoted are inclusive of removal of rubbish / debris collected during the progress of work, rejected material and clearance of site before and after the work is completed. Not more than one truck load shall be stored that to for not more than 3 days. The contractor shall arrange to remove the same immediately. If the contractor is failing to remove the same and the expenses shall be recovered from the contractor and he will not dispute for the expenses so incurred.

Vouchers / bills: Contractor shall upon the request of the Bank furnish bills, invoices, accounts, receipts and other vouchers for all materials brought on site to prove that the material purchased are as mentioned in the specification.

Contractor's responsibility: The work will from time to time be examined by Project Architect, but such examination shall not in any way exonerate the contractor from the obligation to remedying any defects which may be observed at any stage of the work or after the same is completed.

Dismissal from work: The contractor shall upon the written request of the Project Architect immediately dismiss from the work any person employed by him thereon, who may in the opinion of the authority be incompetent or misconduct himself and such person shall not be again employed on the work, without the permission of the bank.

Order of work, etc.: Bank reserves the right to fix the order in which the various items of work involved are to be executed. However, the contractor shall be responsible for the completion of the entire job within the item limit specified failing which liquidated damages as mentioned in below clause shall be recovered from the contractor.

Commencement of work: The work must be started within 3 days upon accepting the work order and the programme for carrying out the various jobs shall be drawn out in consultation with the Project Architect. Adequate labour force shall be provided to complete the work within the specified period. Proper security aspects should be taken care of by adequate vigilance in view of the importance of the building. Default in compliance with the programme so finalized shall entail operation of liquidated damages as stated.

Subletting the work: The contractor shall not directly or indirectly sublet the work to other party without written permission from the bank.

Quantities of works are provisional: The quantities mentioned in schedule are provisional and likely to increase / decrease to any extent or may be omitted thus altering the aggregate value of the contract. No claim for loss of profit / business shall be entertained on this account

Distribution of work: The Bank reserve the right to distribute the work for which quotation have been called, among more than one parties, if found necessary. No claim in this respect shall be considered and the contractor agrees to cooperate with other agencies appointed by the bank.

Third party damage: The contractor shall be responsible for all injury to persons, animals, building, and building structure, any damage to road, streets, and footpaths and shall rectify it at its own cost.

Insurance cover: All the workers of the contractor as well as his sub-contractor must be properly covered by an Insurance Policy under Workman's Compensation Act and Fatal Accidents Act. The contractor at his own expenses arrange to effect and maintain until the virtual completion of the contract, insurance policy in the joint name of the Bank and the contractor against this risk to be retained by the Bank until the virtual completion of the work, and indemnify the Bank from all the liabilities arising out of such events. In case of delay, contractor shall arrange to extend insurance policy till work is completed.

Delay & Extension of time: All the work should be completed within the specified period in the tender. If the work is delayed due to the reasons beyond the control of the contractor, he should applying to the Bank explaining, therein the reasons for such delays, immediately and if in the opinion of Bank's authorities the delay is justified, the contractor shall be granted extension in time limit.

Certificate of virtual completion: As soon as the work is completed, the contractor shall inform in writing such completion to the Project Architect who will inspect the work and if satisfied will issue the certificate that the work has been virtually completed and the defects liability period shall commence from the date of such certificate.

Defect liability period: The defects or other faults which may appear during the defect liability period which is 12 months after the virtual completion of the work, arising in the opinion of the bank due to inferior quality of material or bad workmanship not in accordance with the contract, contractor shall make good at his own cost within a reasonable time. In case of default, Bank may employ and pay other agencies to amend and make good such defects and all expenses / damages / losses shall be recoverable by Bank or may be deducted from any money due to the contractor

Arrangement of work: The contractor shall organize the work in such a way that the office users or the nearby public area put to no hardships and the working of the office is not affected. The contractor shall take adequate care during the progress of work to protect the office property like stationery, furniture, etc. In case of any damage, the same shall be made good by the contractor. Contractor is agreed to work after office hours for which no extra cost shall be considered.

Stacking of material: The contractor is not to stack any of his material recklessly so as to endanger the safety of the building and cause any nuisance to the occupants and the public.

Extra charges: It must be clearly understood that all the conditions of contracts are intended to be strictly enforced and that no extra charges in respect of extra work will be allowed unless they are clearly outside the spirit and meaning of the condition and unless such work shall have been ordered in writing.

Protection of material and work: The contractor shall be responsible for storing and watching his own material and protecting the work at his own cost. The contractor and his worker will be allowed to use lift after office hours. However, no paint drums or heavy bag of cement / paint will be allowed to be taken into the lift. Any damage / spoiling of lift / floor / dado caused during such act will have to be made good by the contractor at his own expenditure.

Electric supply: The contractor shall make his own arrangement for Electricity required for the work.

Approval of samples: The contractor shall furnish well in time before work commence at his own cost, color samples, samples of material or workmanship that may be called by Project Architect for approval. Rates quoted shall cover for such preliminary work.

Workmanship: The work involved calls for a high standard of workmanship combined with speed. All the glass panes, door handles / hinges, electric fitting, fans, furniture records, floors etc. are to be thoroughly cleaned after work is completed. Any damage to the flooring, tiles, dado, paneling or any other part of the building, etc. shall be made good at the cost of the contractor to the entire satisfaction of the Bank. Contractor shall make all arrangements for shifting of furniture / records and keeping the same in its original position after he finishes the work on daily basis. The contractor at his own cost shall provide brown paper, polythene, tarpaulin etc. for protecting furniture / fixtures, paneling, electrical, fittings, records, etc.

Interpretation of documents / drawing: Except where otherwise provided in the contract all questions and disputes relating to the meaning of the specifications, design drawings and instructions herein before mentioned and as to the quality of workmanship or materials used for the work or as to any other question, claim, right, matter or thing whatsoever, in any way arising out of or relating to the contract, designs, drawings specifications, estimates, instructions, orders or these conditions or otherwise concerning the works, or the execution or failure to execute the same whether arising during the progress of the work or after the completion or abandonment thereof shall be referred to the competent authority of the Bank whose decision shall be final and binding on the contractor.

Use of scaffolding: The contractor shall allow the use of scaffolding erected by them to any other agency employed by the Bank during the contract period without any payment.

Provisional Item: If ordered by the Bank, contractor shall be required to carry out provisional items at the same conditions and rates as applicable for this contract.

Measurements of all concealed items: Measurements of all concealed items of work and extra item if any, shall be got recorded by the Project Architect before they are checked up.

Measurements: All measurement tapes shall be of steel and all scaffolding and ladders that may be required for taking measurements shall be supplied by the contractor.

Cleaning during the work: The rates quoted shall include cleaning of ceiling roses, electric switches, boards, window panes etc. after the repairing leaving the site neat and tidy from time to time.

Complying I.S. specification: Unless otherwise mentioned in the contract, the latest Indian Standard Code for material specifications, method of work, and mode of measurements shall be followed. The payment shall be made on the basis of actual measurement of work done to be submitted along with bill.

Price Fluctuation: The rates quoted by the contractor shall be firm throughout the currency of contract (including extension of time if any granted) and will not be subject to any fluctuation due to variation in the cost of material or labour.

The successful tenderer if called upon to do so, shall obtain a letter from the approved trade manufacturer whose product is used, if found necessary by the Bank confirming that the manufacturer shall provide all the technical assistance and supervision during the execution of the work at all such places as directed and the contractor shall bear the expenses, if any, for such

supervision and technical assistance supplied by the trade manufacturer.

Testing of materials: If at any point of time during the work, if Bank authorities desire to carry out the tests of certain materials, the contractor shall arrange for the same and submit the test report without any extra cost to the Bank.

The contractor shall note that they should bring to the notice of the Architect / Engineer any breakage in glass window before starting work. However, if any glass window is found to be broken during the repairing work, the same shall be replaced by the contractor at his own cost.

Conditional tenders: Conditional tenders are liable to be rejected.

Rates of non-tendered items: The successful tenderer is bound to carry out any item of work necessary for the completion of the job even though such items are not included in schedule of quantities.

Abandonment of work: If in any case the work required to be abandoned, the contractor shall not be entitled for any claims and he will be paid as per the actual work done till that period.

The Bank reserves the right to accept / reject the lower or any or all tenders in part or in whole without assigning a reason there for.

Decision of the Bank shall be final and binding on any matter connected with the work. The matter of any dispute shall be decided after mutual discussions based on the terms and conditions of this contract. However, if the matter cannot be resolved then the same shall be referred to the respected, qualified person in the field agreed to both the parties and his opinion shall be binding on both the parties. However, this is pre course to any legal action in this regard.

Incomplete quotation: Incomplete quotations shall be summarily rejected

Payments: The contractor shall be paid by the Bank from time to time under interim payment on account of works executed and when the value of work equal to the approximate value named in the Appendix as 'Value of work for Interim Certificate' has been executed in accordance with this contract.

When the work has been virtually completed and Bank's Architects / Engineer has certified in writing that the work has been completed on the basis of detailed measurements and has made a final scrutiny and that there is no dispute items, rates, ad quantities, the contractor shall be entitled to the payment of the final bill in accordance with the final certificate which will be honored within the period specified in the Appendix as period of honoring final certificate.

The contractor shall be paid by the Bank within the period named in Appendix (period of honoring certificate) after such certificate has been delivered to the employer by the Project Architect. Project Architect has power to withhold any certificate in the work or any part thereof are not carried out to his satisfaction or the contractor fails to show the desired progress or fails to follow the instructions given or in case of breach of this contract.

For water proofing works on traces, bathroom, WC, Chajja, work has to be executed through the agency specialized in waterproofing. Contractor will have to submit a guarantee of 10 years on stamp papers as per the format to be prescribed by the Bank.

The contractor is requested to sign each page of the quotation and put rubber stamp, seal below his signature and seal the quotation in an envelope.

Liquidated damages: If the contractor fails to maintain the required progress or to complete the work and clear the site or before the contract or extended date period of completion, he shall without prejudice to any other right, pay as agreed compensation amount of 1 % of contract amount per week of delay subject to maximum of 10 % of contract amount as liquidated damages.

Records & measurements: Measurements shall be taken jointly by Project Architect and contractor and shall without extra charges provide assistance with appliance, labour and other things necessary for the work and measurements will be signed and dated by both the parties on completion of measurements.

Safety measures: The contractor at his own cost shall provide tarpaulins on the external side of the building at the time of breaking plaster etc. to safeguard adjacent property, Bank's property, employees, traffic, etc. The contractor shall follow all the safety measures while carrying out the work. Employer that is Bank shall not be liable for any compensation due to accident, any mishap or negligence.

If there is delay in commencement of work for any reason, the employer that is Bank shall not be liable for any compensation.

If at any point of time during the progress, it is observed that the contractor is not progressing the work with due diligence, care and lagging much behind the schedule or fails to gear up the work despite instructions from Project Architect, the employer (Bank) reserves the right to terminate the contract with 7 days notice. In such case, the contractor shall be liable to pay the employer any extra cost involved for the completion of the said work and will not obstruct any way in completing the work through other agency. After completion of entire work the contractor shall be paid for the actual work executed by him at the quoted rates after deducting any claims, damages. In case of such termination the security deposit held by the Bank will be forfeited

Although the number of coats of paints / polishing / white washing are specified the contractor will have to additional coats if the surface is not to the satisfaction of the Project Architect and there shall be no extra payment on account of such coats

First Aid: The contractor shall be responsible for all first aid and he shall keep the site fully equipped to meet such emergency.

Supervision: The contractor is required to have on site during all working hours a competent supervisor (acceptable to Bank) who will be responsible for the conduct of worker and who has authority to receive and act on such instructions issued by the Architect / Engineer of Bank.

All work shall be carried out in a workman-like manner to the entire satisfaction of the Architect / Engineers.

Contractor shall follow all rules / regulations in force and should possess the license for employing labour and also follow all safety measures, labor bye law and shall be responsible for any lapse.

Transfer of Tender Documents: Transfer of tender documents purchased by one intending tenderer to another is not permissible.

Safety: The contractor shall carry out the entire work in a workman like manner having full regard for the safety of the men working at site. All safe practices shall be strictly adhered to by the workmen of the contractor like wearing helmets, safety belts when working at heights, gloves when handling sharp objects and reinforcement, eye shields during welding, safety shoes, etc. The contractor shall protect sides of openings in floor slabs, edges of slabs, stairs, stairwells etc. with barricades, warning signs / lights and educate all his workmen regarding following safe working practices. He shall provide first aid boxes at site.

In spite of following safe methods, in case of any unfortunate accident, the contractor shall indemnify the employer against any expenses or claims towards treatment or compensation.

A Daily Diary Register: A daily diary register (with cement and steel stock statement) will be kept in the Engineer's Office or the site office. The contractor or his representative will furnish every day at 9.00 hrs. details of work for the day proceeding and the diary will be written up every day and jointly signed by the Engineer and the Contractor or their representatives in token of its correctness.

Nuisance: The contractor shall not any time do cause or permit anyone to do or cause any nuisance on the site or do anything which shall cause unnecessary disturbance of inconvenience to the Employer or to the owners, tenants or occupiers of other properties near the site and to the public

generally.

Rights, remedies and powers:

- l) Termination of contract due to contractor's default. If the contractor:
- a. Abandon the contract.
 - b. At any time defaults in proceedings with the works with due diligence and continues to do so after a notice in writing of seven days from the Engineer or Project Architect or Employer, or
 - c. Commits default in complying with any of the terms and conditions of the contract and does not remedy it within **3days** after a notice in writing is given to him in that behalf of the Engineer or Project Architect or Employer.
 - d. Persistently disregards the instructions of the Engineer, Project Architect or contravenes any provision of the contract, or
 - e. Fails to remove materials from the site or to pull down and replace work after receiving from the Engineer, Project Architect notice to the effect that the said materials or works have been rejected.
 - f. Fails to complete the works or items of work on or before the stipulated date (s) of completion, and does not complete them within the period specified in a notice given in writing in that behalf by the Engineer, or Project Architect of Employer, or
 - g. Offer or gives or agrees to give to any person in the Employer's service or to any other person on this behalf, any gift or consideration of any kind as an inducement or reward for doing or forbearing to do so for having done or forborne to do any act in relation to the obtaining or execution of this or any other contract for the Employer, or
 - h. Shall enter into a contract with the Employer in connection with which commission has been paid or agreed to be paid by him or to his knowledge, unless the particulars of any such commission and the terms of payment thereof have previously been disclosed in writing to the Employer / Engineer, or
 - i. Being an individual, or if a firm, any partner thereof, shall at any time be adjudged insolvent or have a receiving order or order for administration of his estate made against him or shall take any proceedings for liquidation or composition (other than a voluntary liquidation for the purpose of amalgamation or reconstruction) under any Insolvency Act for the time being in force or make any conveyance or assignment of his effects or composition or arrangement for the benefit of his creditors or support so to do, or any application be made under any Insolvency Act for the time being in force for the sequestration of his estates or if a trust deed be executed by him for benefit of his creditors, or
 - j. Being a company, shall pass a resolution or the court shall make an order for the liquidation of its affairs, or a appointed or circumstances shall arise which entitle the court or debenture holders to appoint a receiver or manager, or
 - k. Shall suffer an execution being levied on his goods and allow it to be continued for a period of 21 days, or
 - l. Assigns, transfers, sublets (engagement of labour on a piece work basis or of labour with materials not to be incorporated in the work, shall not be deemed to be sub-letting) or attempts to assign, transfer or sub-let the entire works, or any portion thereof without the prior written approval of the employer.

-
- I) The Bank may, without prejudice to any other right or remedy which shall have accrued or shall accrue thereafter as the Employer by written notice determine the contract either as a whole or in part.
 - II) Upon such determination of the contract in whole or in part, the security deposit with the Employer in respect of the contract shall stand forfeited to the Employer without in any way effecting the rights of the Employer.
 - III) Rights of the employer after determination of the contract due to contractor's default.

The Engineer shall on such determination have powers to:

 - a. Take possession of the site and any materials equipment, plant, implements stores etc. thereon, and / or
 - b. Carry out the incomplete work by any means at the risk and cost of the contractor.
 - IV) On determination of the contract in full or in part, the Engineer shall determine what amount, if any, is recoverable from the contractor for completion of the works or part of the works or in case the works or part of the works is not to be completed, the loss or damage suffered by the Employer. In determining the amount, credit shall be given to the contractor for the value of the work executed by him up to the time of cancellation or the value of contractor's materials to be present so as to record the measurements in his presence. If the contractor fails to be present in response to the notice, the recording of measurements shall be proceeded with ex-parte and the measurements as recorded shall be binding the contractor.
 - V) The Bank shall have the right to use contractor's plant, machinery and materials on the balance work but shall not in any way be responsible for any damage or loss of the same and the contractor shall not be entitled to any compensation thereof.

SEAL AND SIGNATURE OF CONTRACTOR

APPENDIX TO THE CONTRACT DOCUMENTS

- Subject:** "INTERIOR FURNISHING & ELECTRICAL WORKS OF "INDIAN BANK"-
BRANCH-HAMIDIA ROAD-2 , DISTT- BHOPAL (M.P.)
1. Defect liability period : **12 months** from the date of virtual Completion of work.
 2. Date of commencement : **7th days** after the contract is accepted by the contractor.
 3. Date of completion : **4 (FOUR)** weeks.
 4. Liquidated damages : 1% of contract amount per week / day of delay Subject to maximum
Of 10% of contract amount For the works of less than 6 month
Completion Period.
 5. Earnest Money to be submitted : **Rs. 5000.00** Micro and Small Enterprises (MSEs) as defined
in MSE Procurement Policy issued by Department of Micro,
Small and Medium Enterprises (MSME)
 6. Percentage if any to be deducted from bills: **10%** (Total of performance security and retention money)
- .

To,

The Deputy General Manager,
Indian Bank,
Zonal Office
BHOPAL (M.P.)

Dear Sir,

LETTER OF OFFER

Sub: "INTERIOR FURNISHING & ELECTRICAL WORKS OF "INDIAN BANK"- HAMIDIA ROAD-2 BRANCH, DISTT-BHOPAL (M.P.)

With reference to the tender regarding the above work invited by you, we have to state as under.

We declare that before quoting the rates, we have visited the site and our rates are as per present site condition. In the event of this TENDER being accepted, I / We agree to enter in to and execute the necessary contract documents as required by you.

As required by you, I / We are returning herewith the documents (in single) duly signed by us at each page in token of our acceptance of the provisions in the documents.

We hereby offer to execute and complete the whole of the works strictly in accordance with the said conditions of contract, special conditions of contract, specifications and drawings at the rates set out against each of the items of work in the schedule of quantities. the total cost included in the above is Rs. _____ /- (Rs. _____ only).

We have carefully read and clearly understood the conditions of contracts, special conditions of contract, special conditions of contract and specifications. We agree to complete the work at the rate / rates quoted by me / us in the schedule of quantities and within the specified time from the date of work order awarding the work to us.

We understand the work is to be completed within scheduled time period.

Our rates are firm, include and cover all cost, expenses, liabilities of every description and all risk of every kind to be taken in execution and handing over the work to the Bank. The VAT, Service Tax, Sales Tax (State & Central), works contract tax, octroi, duties, municipal tax, general tax and any other taxes applicable and prevailing from time to time on such item for which the same are livable and the rates quoted by us are inclusive of the same.

Thanking You,

Yours faithfully,

Name :
Address :
Tel. No. :
(Fax. No.) :
Mobile No. :

FORM OF AGREEMENT

(On stamp paper of Rs.100/-)

THIS AGREEMENT made this Day of,25.....
between..... Deputy
General Manager, Indian Bank, Zonal Office, BHOPAL (M.P.) Pin 462023 hereinafter called " the owner
") of one part and
.....
Of or whose registered office is situated at
.....
.....(hereinafter called : " the Contractor ") of the other
part.

WHEREAS the Owner is desirous of

..... (hereinafter called " the work
") at
.....

and has caused drawings and Bills of Quantities showing and describing the work to be done to be
prepared by or under the direction of
.....

AND WHEREAS the Contractor supplied the owner with a fully priced copy of the said Bills of
Quantities (which copy hereinafter referred to as " the Contract Bills ") AND WHEREAS the said
drawings (hereinafter referred to as " the Contract Drawings ") and The Contract Bills have been
signed by on behalf of the parties hereto : AND WHEREAS the contractor has deposited the sum of
Rupees.....

..... With the owner for due performance of this Agreement.

NOW IS HEREBY AGREED AS FOLLOWS :

For the consideration hereinafter mentioned the contractor will upon and subject to the conditions
annexed carry out and complete the work shown upon the contract drawings and described by or
referred to in the Contract Bills in the said conditions.

The Owner will pay the Contractor the sum of Rupees

..... (hereinafter referred to as " the Contract Sum ") or such other
sum as shall become payable there under at the times and in the manner specified in the said
conditions.

The term " ARCHITECT " in the said conditions shall mean the ASHISH SHRIVASTAVA, Kushi &
Associates, (Architects, Interior Designers), 11, Swastik Complex, Russel Crossing Jabalpur -
482001,Mob. 9425150793, 9131343384 in the event of his death or ceasing to be the "
ARCHITECT " for the purpose of this contract, such other person as the owner shall nominate for
that purpose, not being a person to whom the contractor shall object for reasons considered to be
sufficient by employer. Provided always that no person subsequently appointed to be the "
ARCHITECT " under this contract shall be entitled to disregard or overrule any certificate or
opinion or decision or approval or instruction given or expressed by earlier "ARCHITECT".

The said conditions there to shall be read and constructed as forming part of this agreement, and
the parties hereto shall respectively abide by, submit themselves to the conditions and perform the
agreements on their parts respectively in such conditions contained.

Any dispute arising out of the contract shall be referred to Arbitration as per the condition
stipulated in clause of " Special condition of contract ".

AS WITNESS the hands of the said parties.

Signature of the Employer

&

Name _____

Designation _____

Date _____

Signature of Contractors along with seal

Address of Company

Name _____

Designation _____

Date _____

LIST OF FURNISHING MATERIAL

LOCK BOARD	Make of Material
Plywood	Archid / Century / Kenwood / Green / Mayur or equivalent (6mm, 9mm, 12mm, 19mm)
Laminates	Formica /Greenlam / Century / Durian/ Archid or equivalent (1.0 / 1.5mm thick)
Black Board	Archid / Century /Marino or equivalent
Soft Board (Pin up Board)	Jolly Board, Western India Plywood or Equivalent.
Gyp Board	India Gypsum or equivalent
Metal Ceiling	Luxelon, Super seal, Trident, Armstrong or Equivalent.
Vertical Blinds	Vista, Universal or equivalent
Screws	GKW / Mettle fold or equivalent.
Brass Hinges	Reliance / Punit heavy duty or equivalent
Hardware	Shalimar, Everite / Reliance or equivalent (Brass powder coated)
Drawer shutter lock	Vijayan / Godrej (3 Set of keys) or equivalent.
Ball catch	Magnetic (M-2) / Brass or equivalent.
Door lock / Handles	4-C ACME, Golden, Godrej, Ultra or equivalent.
Veneer	Anchor, URO . Durian / Century/ Bhutan tuff / Prince/ or equivalent.
Adhesives	Fevicol (SH), Mowicoll, Mahacol, Araldite or equivalent
Wood Preservatives	Woodgaurd, PPCI, Black Japan or equivalent.
Door closure	Yale / Efficient Gazets, Everite Hyper or equivalent.
Glass	Modi / Triveni / Hindustan Palington / Asahi / Saint Gobin
Glass tinted	Same as above.
Melamine Polish	Asian Paint, MRF, Nerolac or equivalent
	French . Zinc oxide or equivalent
Paint	ICI, Burger, Nerolac, Asain
AC Grill	Air Products, Omicron, Patrawala
Vitrified tiles	Marbonite of HR Johnson, Navin
Ceramic Tiles	Johnson & Johnson, Kajaria, Nitco, Regency or equivalent
Alu. Door & Window Sections	Ajit India / Jindal / Indal / Bhansail or equivalent of 25 microns.
Floor springs	Everite / Hemco / Hyper or equivalent
Wood preservative	Asain Paint / British Paint or equivalent
Cement	L &T / Narmada / ACC / Ambuja / Birla or equivalent of 43 / 53 grade as required.

White Cement	Birla Cement. JK Cement or equivalent
Sun Control film	Garware or equivalent.
Stainless steel sink	Nirali / Diamond or equivalent.
Carpet	Hitkari / Modi / Trans Asia or equivalent.
Rubber foam	34 density mm foam
WC seat cover	Commander / Patel / Supreme or equivalent
Toilet paper holder	Parry ware / Hindustan / Nycer or equivalent

NOTE : All materials shall confirm to IS / BIS respective numbers.

- Commercial ply shall conform to IS 303.
- Marine Ply shall conform to IS 710
- Block Board shall conform to IS 1659.

APPROVED LIST OF ELECTRICAL MATERIAL

Description	Brand
M.C.B. / RCCB / RCBO	POLYCAB / ABB/HAVELLS
Distribution Boards	LEXIC / HAGER / ABB
Switch Fuse Units With HRC fuses	GE / L&T / ABB
Moulded Case Circuit Breaker (MCCB)	ABB (T max) / L & T (D sine)
Air Circuit Breakers	ABB (EMEX/L&T(C POWER)
Change Over Switches	GE / L&T / HH ELCON
Cable Glands and Sockets	SIEMENS
PVC insulated Copper conductor wires	FINOLEX / RR / POLYCAB
Telephone Wires and cables	FINOLEX / (RPG/BIRLA ERRICSON POLYCAB
Television Coaxial cable	FINOLEX / RR /RPG / L&T
PVC / XLPE Insulated 11 KV / 1.1 KV Cables	NICCO/ FINOLEX/ POLYCAB
Switches and Sockets outlets (Conventional piano type)	MK / ANCHOR
Switches and Sockets outlets (Modular type)	MK / ANCHOR
Industrial outlet	LEXIC / HAGER / ABB
MIS Conduits and Accessories	B.E.C./AKG/MK
PVC Conduits and accessories	AKG/BEC/CAP/SEIKO / [POLYCAB
Fluorescent/ LED Tube Fitting	PHILIPS /Havells
Incandescent/ LED Light Fitting	PHILIPS / BAJAJ/Havells
Hpmv/hpsv/ halogen Lamp	PHILIPS / WIPRO
Wall Fans/ Ceiling Fans / Exhaust Fans	CROMPTON / BAJAJ
Floor / Wall Raceways to date	MK/ LK/ MDS
Computer networking - outlet	AMP/SYSTEMAX / LUCENT
Electronic Energy Meters	SECURE / L&T
UPS	EMERSON / POWERWARE / TATA LIBERT
Ceiling Rose holders	ANCHOR
Buzzers/Bell Push bell	ANCHOR
MCB Distribution Board	MOS/LEGRAND/SIEMENS /HAGER
HRC Switch Fuse nits	SIEMENS ABB/GE/L&T
Cable Glands/Lugs	SIEMENS/DOWELLS
Electronic Regulator	MK/ANCHOR/ROMA/DEGRAND/MDS

NOTE:

Sr. No.	Description
1.	The choice of the final makes shall be made by the BANK AND ARCHITECT
2.	The samples or Cat. No. of all type of switches & light fittings should be approved before execution.

SEAL AND SIGN OF THE CONTRACTOR

PREAMBLE TO BOQ

Abbreviations:

R.M.T	:	Running Meter
Sq. Mt.	:	Square Meter
Sq. Ft.	:	Square Foot
Cu. Mt.	:	Cubic Meter
T.W.	:	Teak Wood
Q.R.O.	:	Quote Rate Only
C / C	:	Centre to Centre
M.T.	:	Metric Ton
C.P.	:	Chrome Plated
NO.	:	Numbers
MM	:	Millimeter

1. All dimensions are in M.K.S. unless otherwise stated.
2. The quoted rate shall be all inclusive and cover the cost of material including wastage, freight, all types of taxes, duties, royalties, erection, construction, testing of materials if required samples brought for approval, tools and taxes, plant and equipment, supervision, overheads, profit and any other expenditure incurred for completion of work as per drawings, specifications and to the full satisfaction of BANK / Architect.
3. The rates quoted shall be valid for working at all heights, depths and on all floor levels. No extra payment shall be made for scaffolding, staging, ladders etc for transportation of men and materials at higher or lower levels.
4. The item rate specifications are indicative. the contractor will have to carry out the work in accordance with the drawings, technical specifications and / or other conditions laid down in tender document and to the full satisfaction of BANK / Architect.
5. Quantities mentioned against respective items are approximate and can vary to any extent. Payment shall be made on actually executed quantities.
6. No claims shall be entertained in case of increase / decrease quantities of any item and also to add / delete any item in totality. BANK / Architect reserve the right of operating any item for any work.
7. Rates for painting shall include cleaning glass panels, floors etc.
8. After completion of work the site shall be handed over absolutely clean, after ensuring that all floors, walls etc are spotlessly clean.
9. Rates of all items shall remain constant irrespective of floor level and nmo extra shall be paid for handling and stacking of materials, removing debris etc from the site.
10. Unless otherwise noted, the method of measurement will be as per I.S. 1200.
11. BANK / Architect reserve the right of operating all ' Quote Rate only ' items.
12. Wherever contractor proposes to use 'equivalent 'makes (i.e. other than specified) he shall obtain BANK's prior approval. BANK may ask Architect before giving approval to the same. Any additional cost and time lost due to this will be on Contractor's account and no claims will be entertained.
13. The rate of partition, paneling shall include necessary additional framework supports that may be required to suit site conditions or stability of the item. Decision of Architect in regards to the need for such additional supports shall be final.
14. All wooden frame work/ member size mentioned as out of, shall be full size with maximum planning tolerance of 3 mm both ways.
15. Rates for doors include all brass oxidized heavy duty hardware, locks, floor springs, door springs, door closer, special door handles etc as specified in relative terms.
16. Size and type of door closer/ floor spring shall be suitable for type of door. The contractor shall give guarantee for performance of door closer / floor spring from manufacturer.
17. Rates for partitions, paneling shall include making of necessary cut outs, chasing to be made for conduits, switch boards etc.
18. Rates for painting and polishing shall include cleaning glass panels, fans floor etc.
19. After completion of work the site shall be handed over absolutely clean, after ensuring that all laminates, floors walls etc are spotlessly clean.
20. Contractor shall clean the site and mark the lining out on the floor with adhesive tape for approval. The same shall not be paid separately.
21. In case of loose furniture, the specification for side unit or rear side credenza unit in any item shall be same as the specification of the table in that item.

22. All key hoos should be fixed with metallic key hole ring.
 23. Key for all locks should be different and no key should match with two different locks.
 24. Rates shall include for following:-

PLASTERING:

- Work at all levels, heights and in all situations and profiles.
- Double scaffolding, working platforms / Tarpaulin curtains.
- Coving, drip moulds, grooves, recesses, ornamental bands etc.
- A coat of white wash for near plaster soon after curing period is over.
- Work in narrow width and small quantities unless special provision is made to the contrary.
- Preparation of surface by ranking out joints in brick or by hacking the concrete surface and wetting the surface before plastering wherever required.
- Thickness of plaster exclusive of the thickness of key i.e. grooves and open joints in brick work, stone work etc.
- Chambers of any width, internal and external rounded angle.
- Curling, protection and cleaning of all surfaces.
- Keeping all plastered surfaces well wetted for at least 7 days.

PAINTING & POLISHING:

- Works at all heights and use of all scaffolding, necessary for execution of work and for inspection.
- Preparing surfaces to receive finishing coats.
- Putting sand papering and dusting of surface in between coats where applicable.
- Work on cornices, narrow bands and widths, grooves etc.
- Finishing to approved matt textures, complete as directed.
- Spreading and removing, covering to doors, windows, floors, fittings etc to protect them from splashes.
- Washing floors, cleaning glass, joinery, electric fittings etc and leaving premises clean and tidy.
- Mode of Measurement

S.No.	Particulars	Method of Measurement	Multiplying Factors
1	Paneled doors & Windows	Measured flat not girthed including frame	1.125 for each side
2	Fully glazed		0.5 for each side
3	Partly glazed & paneled		1.0 for each side
4	Flush door		1.0 for each side
5	M.S. Grill & Collapsible door		1.0 for painting all over
6	Rolling Shutter	Measured flat not girthed including frame	1.25 for each side

Mode of Measurements:

- Partition, Paneling : Sq. Ft. Area - one side only
- Painting : Sq. Ft. Finished area only
- Rounding off Measurements : All measurements shall be rounded off to nearest 2 decimal points.

PART-B

TENDER DOCUMENT
(SPECIFICATION & QUANTITIES)

**PROPOSED INTERIOR FURNISHING & ELECTRICAL WORKS
ORKS OF “INDIAN BANK, BRANCH-HAMIDIA ROAD-2, DISTT-
BHOPAL (M.P.)**

INDIAN BANK, ZONAL OFFICE, BHOPAL (M.P.)

**QUOTED RATES FOR PROPOSED INTERIOR FURNISHING & ELECTRICAL WORKS FOR
INDIAN BANK, BRANCH- HAMIDIA ROAD-2, DISTT-BHOPAL (M.P.)**

S. NO.	WORKS	AMOUNT
		(Rs.)
1	TOTAL QUOTED AMOUNT FOR INTERIOR FURNISHING	
2	TOTAL QUOTED AMOUNT FOR FURNITURE WORKS OF BRANCH	
3	TOTAL QUOTED AMOUNT FOR ELECTRICAL WORKS	
	TOTAL RS.	

Seal and Signature of Contractor

Date:-

**BILL OF QUANTITIES OF INTERIOR WORKS FOR INDIAN BANK AT
BRANCH AND ATM –HAMIDIA ROAD-2, DISTT- BHOPAL (M.P.)**

1. FURNISHING WORK

S. No.	PARTICULARS	UNIT	QTY	RATE	AMOUNT
1a	Gypsum Ceiling:- Providing and fixing false ceiling as per approved plan with Gypsum board (India Gypsum) 12 mm thick on frame consisting of main and cross runners of GI section of 2.5" size @ 2.85 kg/12 feet and 1.75" @ 2.9 Kg/12 feet connected with screws to form a grid of not more than 2'x2'. Opening for lights and fans to be provided. The ceiling height shall not be less than 9'6" from the floor. The rate includes all extra frame work required to hold the concealed light fixtures, jointing with compound and fibre tape 3mm gypsum punning/ plastering and 3 coats of Asian/Nerolac Acrylic emulsion paint.(With patta) &(White colour shed)	Sqft	450		
1b	Armstrong Ceiling: Providing, fabrication and fixing of false ceiling at all heights of 600 mm x 600 mm x 12 mm armstrong mineral fibre ceiling tiles of type BIZA RH - 90 laid on armstrong prelude XL exposed grid systems with 9 mm wide T Section flanges colour white. The framework comprise of main runner spaced at 1200 mm centers 1200 mm maximum centers. Hangres (GI wire) to be fixed by approved roof plug and screws etc. The last hanger at the end of each main runner should not be greater than 450 from the adjacent wall. Flush fitting 1200 mm long cross tees (with double stitching) to be interlocked between main runners at 600 mm enter from 1200 x 600 mm modules. Cut cross tees longer than 600 mm to be supported independently 600 mm x 600 mm modules to be formed by fittings 600 mm long flush fitting cross tees centrallybetween the 1200 mm cross tees. Perimeter trim to be armstrong wall angle secured to walls at 450 mm maximum centers. (Armstrong, gyproc,USG Ceiling) in White colour.	Sqft	530		
2	Low Hight Partition- Low Height Partition (Solid) with 8mm glass Upto ht. of 4'-0"" in Banking hall for officers laminated and inclusive of door.				

a	Sal wood/hollock or Equivalent frame of section 2.5"x1.5" fixed in position with 2.5" to 3" long steel neetle fold screw. The vertical and horizontal members being placed at 2' c/c as per	Sqft	20		
---	--	------	-----------	--	--

	site condition as directed.				
b	Panel for solid partition fixing 8 mm water proof plywood, anti termite, borer proof plywood of century, Duro or Alpine make on both the sides of frame work with fevicol SH and headless nails of 17 nos of 1.25" length and securing the cover with 1.5" long steel nettled fold screw. Making the plywood surface level before fixing the laminate/veneer. (Formica, green lame, merino)				
c	1 mm th laminate/ mica fixing on inside of panel with 1.5 mm th. Groove in the panel as per the design with provision of the openings in the panel for switch boards, box and cuts in frame for carrying conduits if necessary, and fixing 1.0 mm laminate on the outside face of shade and colour a per AB colour scheme given in the tender specification with 8mm glass to be given in the design. The open edge are to be blocked by teak wood bead of required size and design.(Formica, green lame, merino)				
3	Partly Glazed Full height Partition with doors – (B.M. Cabin , Cash cabin) Supplying and erecting full height party glazed partitions (upto false ceiling height) as per drawing and conforming to the following specifications : (century ply, green ply or Duro ply)				
	basic frame work : Sal wood/hollock or Equivalent sections, treated with two coats of wood preservatives, 50 mm wide x 50 mm (minimum) at maximum 600 mm horizontal or vertical spacing as per site conditions. Vertical members shall be suitably, anchored and at ceiling level to ensure rigidity. Exposed frame members in the glazed portions shall have wider spacing (approx. 1800 mm. clear) as per instructions. Exposed members shall be finished with 1.00 mm thick laminate sheet of same or combination shades, over 6 mm mm thick BWR grade plywood facing including 4x6 mm grooves at locations as per instruction including door and fittings.				

	skin membrane : (solid portion upto 900 mm from floor level and from 2100 mm to false ceiling with 6 mm thick BWR grade plywood on each face, with grooves formed as per drawings/ instructions.				
	finishing : 1.0 mm thick laminate sheet of same or combination shades as per instructions.				
	skirting : 100 mm high x 12 mm thick polished teak wood skirting on both faces, with NC lacquer in mat finish				
	glazing : (For Branch Manager cabin & Cash Cabin) 8 mm. thick clear float glass fixed with continuous steam beech/teak wood glazing beads of approved shape (finished 35x25 mm) all round polished and coated with NC lacquer finish. The rate should also include cost for decorative etching on one side of the glass.				
	Quoted rates shall include all necessary materials accessories and labor and also allow provisions for electrical /telephone/computer wiring conduits and switch boxes etc. (Materials for wiring conduits and switch boxes shall be separately paid for.)	Sqft	390.00		
4	FULL HEIGHT WITHOUT GLAZED PARTITION WITH DOOR - (RECORDS AND UPS-MEZZANINE FLOOR) :- FULL HEIGHT WITHOUT GLAZED PARTITION WITH DOOR:- Supplying and erecting Full height partitions (upto max. 2800 mm. high) as per drawing and conforming to the following specifications : basic frame work : teak wood frame work sections, treated with two coats of wood preservatives, 75 mm finished at 600 mm horizontal or vertical spacing as per site conditions. skin membrane : 6 mm thick BWR grade plywood on each face, with grooves formed as per drawing/instruction. finishing : 1.0 mm thick laminate sheet of same or combination shades as per instructions. edge moulds : All free top / end surfaces shall have polished teak wood skirting with NC lacquer finish. Note:-The ply, boards, laminates should be make of Green/Century/ Duro)	Sq.ft.	332.00		

5	Flap Door - Providing and fixing of 3'-6" wide & 4'-0" high flap door as per drawing				
	a) Flap Door with door closure.	No.	1		
6	Cheque drop box -Providing and fixing cheque drop box of size 450mm 750mmx300 mm with a slit opening of 10mmx150 mm and openable shutter of 250x262mm size with glass fixed above 1.5 m above ground level. All exposed surface to be pasted with matching laminate and inside with .1mm liner mica. The cost includes that of necessary fittings.	No.	1		
7	Customer writing table -Providing and fixing customer writing table 900mm circular made of 12 mm thick ply board supported on pedestal with necessary fixtures. The top to be provided with shelves for keeping forms/slips etc. all exposed surface to be paste with mica to match the ambience.	No.	1		
8	Suggestion box -Providing and fixing standing free suggestion box made of ply board 12mm thick 450mm long x 300mm deep x 900 mm high. The box shall have open able shutter with glass & all necessary fixtures.	No.	1		
9	Notice board - Providing and fixing notice board in ply board of 6mm fixed on a frame of 50mmx25mm well seasoned wood polished and top fixed with bead. 12mm thick soft board cladded with fabric of matching colour and shade complete with all fixtures necessary as required. (3 No's)	Sqft	72.00		
10	Panel box-Providing and fixing boxing comprising of 2" X 2" wood frame work. 12mm marine plywood trap with magnetic catch. Entire boxing finished with enamel paint of approved shade of panel box with 12mm ply board shutter with louver and the top pasted with mica of matching colour complete.	Sqft	160.00		
11	Frosted Film-Providing & pasting frosted film (3M, Garware make) on glass work partition of entrance as required as directed by the consultant/Architect.	Sqft	90.00		
12	Logo-Providing & pasting frosted film (3M, Garware make) logo on entrance door as directed by the Consultant.	No.	2		

13	Main Door with partition (BRANCH & ATM) - Providing & fixing main door & partition made up of 12 mm thk. Clear toughened glass shall be fixed in Ozon / Enox make patch fitting with necessary hardware. With application of sealant from all sides. Edge polish for all exposed sides of glass. Complete as per design .Door size 7'0" x 3'0" - Providing & fixing main door made up of 12 mm thk. Clear toughen glass shall be fixed in. Ozon / Enox make patch fitting with necessary hardware like floor spring, 12" S.S. finished decorative handle pair, & locking arrangement. Edge polish for all exposed sides of glass. Complete as per design	Sqft	126.00		
14	Wall Panelling with laminate finish – Providing and fixing in position ply 28aneling with hardwood framing of approximate 2” x 1.5” section at 2’ 0” c/c both ways, 9 mm plywood with 1.0 mm laminate (Royale Touch, Sunmica, Formica) in scheme as per approved colors complete as directed .	Sq.ft.	130.00		
	TOTAL AMOUNT				

2. FURNITURE AND CABINETS

S. No.	PARTICULARS	UNIT	QTY	RATE	AMOUNT
A	Providing and fabrication of table (with keyboard tray) having table body of 18mm, 12mm & 6mm thk plywood and table top & shutters of 19mm thk block board. The drawer unit must have one drawer mounted on drawer slider and shuttered shelf under it. A readymade metallic keyboard tray must be fixed under the table top. A round, PVC cable crossing socket (cable manager) must be fixed on the table top for power/data cable crossing. A foot rest, made of 19mm thk block board must be fixed and a CPU carrier, on the footrest level must be fixed. The table top and all other exposed surfaces must be covered with 1.0mm thk laminate. All inside/hidden surfaces must be finished with one coat of primer and three coats of synthetic enamel paint. All the edges and corners must be protected with 6mm thk plain teak wood bead. 4” high skirting				
	must be fixed on exposed surfaces. All the teak wood must be finished with 3 coats of synthetics paint. Automatic locks and handles must be fixed in drawers & shutters.				

1	BM TABLE Table Size – 1830 mm x900 mm x750 mm Side Unit Size – 1050 mm x 450 mm x 750 mm	No.	1		
2.	OFFICER TABLE Table Size - 1220 mm x 760 mm x760 mm Side Unit Size - 910 mm x 450 mm x 750 mm	No's	4		
3	CLERKS COUNTER (WITH CASH CABIN) - Providing and fixing at site front Officer counter 5'-0" in length & 2'-9" in width with provisions of drawer units as per drawings to be made up of 19mm BWP ply make only and finished with 1.0mm Metallic steel finish laminate with provision of keeping computer in left side with customer top of 12 mm thick glass with round molding front side & with proper provisions of wires/data cabling beneath the table . The drawers are to be provided with heavy telescopic sliding rail. The counter shall have computer sliding Key Board tray to be fixed in it. A glass of 8 mm thick of 15" height with round edge & etched fixing with side & bottom of heavy steel brackets fitted to the counters of customer facing side should be properly fixed as per instructions from the Architect. It should be folding in provisions. The front of the counter shall have different color laminate of metallic steel finish laminate and front design as per drawing to be followed strictly. A CPU trolley is to be provided with castor wheels to be placed below the table. All the another fittings should be CP Brass including hinges also. All exposed edges of counters to be finished with Ist quality teak wood beading /molding to be properly polished with melamine polish, the cost shall include all materials, labour etc. complete. (Glass should be make of Saint Gobin/ Modi float)	No.	3		

3	Low Height / Full Height Cabinet: Providing and fabrication of 3' / 7'high and 1'6" deep file/storage cabinet with cabinet body of 18mm,12mm & 6mm thk plywood. One row of drawers (mounted on drawer slider) must be there on the cabinet and shuttered shelf under the drawer must be provided. The shutters of the shelves must be of 19mm thk block board. All the external exposed surfaces of the cabinet must be covered with 1.0mm thk laminate. All the internal/hidden surfaces must be finished with one coat of primer and three coats of synthetic enamel paint of matching colour of the laminate. All the edges/corners of the plywood must be protected with 6mm thk plain teak wood bead. 4" high skirting must be fixed on exposed surfaces. All the exposed teak wood surfaces must be finished with three coats of melamine polish. Multipurpose lock and handle (Godrej make) must be fixed on shutters and drawers.				
---	--	--	--	--	--

a	low height - 1220 mm Height (Rear to officers, Manager cabin)	Sqft	66.00		
b	Full height - 2130 mm Height (Records)	Sqft	192.00		
4	Cash counter: Providing and fixing of Cash cabin with 12mm front glass railing providing and erecting in position cash counter /cash work station of approx . Size 1400mm(L)X 750MM(w)X 750MM(H) inclusive of 1500mm high ,375mm wide customer writing top & drop down flap box 600mmx300mm with rear partition including door 750x2250mm made of 18mm thk.commercial ply with 1mm thk. laminate & 12mm thk. glass on the top of the counter & 8mm thk. glass on the side partition MS power coated ke board try ,cashier drawer of commercial ply etc complete. partition ht. up to 7' with back side glazed door and and top with aluminium grill side wall partition 8mm thk. glass as per drawing inclose and as per instruction of the architect.	No.	1		
				TOTAL	

SIGNATURE WITH RUBBER STAMP OF CONTRACTOR

DATE-

**BILL OF QUANTITIES OF ELECTRICAL WORKS FOR INDIAN BANK
BRANCH AND ATM- HAMIDIA ROAD-2 , DISTT- BHOPAL (M.P.)**

ELECTRICAL WORK

S. No.	PARTICULARS	UNIT	QTY	RATE	AMOUNT
1	Providing and fixing, testing and commissioning for point wiring two nos. 1.55 sq. mm/2.5 sq.mm or 4.0 sq.mm PVC insulated single core stranded copper conductor wire 1100 volt grade (for Ph&N) and one nos. 1.0 sq. mm/ 1.5 sq. mm PVC insulated single core stranded copper conductor wire 440 volt grade, for earth wire 1.6 mm th. 25 mm dia BEC / NIC / AKG make PVC conduit pipes. All wires are to be ISI mark approved / specified make Anchor/ Finolex / Havells complete with all drops upto boards, stapples, accessories and hardware etc. Installing the conduit in slabs, wall etc.The point shall include modular type switches of MK Anchor, Roma, Crab tree make as approved / specified in required combination including electronic regulator, 6 ASP control switch 3-plate ceiling rose, angle or staight holder adequate size to mount control switches for lights, fan sockets. Sockets for half points and ceiling fan regulator. rate must also include the cost of circuit wiring with 2x2.5 sqmm+1x1.5 sqmm				
a	Light points. & exhaust fan points	No.	68		
b	Fan with regulator (ceiling + bracket) (2x1.50 sq.mm + 1x1.5 sq.mm)	No.	2		
c	Call bell points inclusive of call bell .	No.	1		
e	16 Amp 3/5 pin point (2x2.5 sq.mm +1x1.5 sqmm)	No.	18		
f	Ac point -supply instalation of AC point with following item in surface / concealed manner 32 A D.P. 1 way switch with neon, plate & box 20 amp. 10 amp. Twinsocket with plate & box including 2x4.0 + 1x1.5 sqmm cu. Wire along with copper wiring from indoor to out door unit with pvc conduit etc complete.	No.	7		
g	Providing, supplying and installation the concealed (Complete with replastering and painting)25mm dia Drain pipe from AC unit inside to branch to the outdoor of premises as instructions by Architect – Make Finolax of drain pipe etc.	R.mtr.	90		

2	Telephone Socket Point -Supplying, fixing and testing of telephone socket point wiring with two line telephone wire of approved Anchor Havells/Finolex make in 1.6 mm th 1" dia PVC conduit pipe including double line tel-Jack (modular type) on the switch board.	No.	2		
	10 pair tag block	No.	1		
3	UPS POINTS: Wiring for computer terminal points with 2x1.5Sqmm + 1x1.5 Sqmm PVC insulated copper conductor recessed in wall/under counter in PVC pipe/flexible pipe/casing capping as required. Rate inclusive of 3 nos. 6 amp switch & socket (5pin) (modular) with fuse & indicator i/c of box, base plate & cover plate, making all connections complete. (Average length 15M)	No	15		
4	TIMER				
A	providing & installation of electronic digital no/off timer 2 stage for Ac beaing upto 3000 watt with , 40 AMP DPMCB in enclosure	No.	1		
B	Providing and installation of electronic digital no/off timer, load bearing up to 800 watt for glow sign board with 20Amp pp MCB in enclosure	No.	1		
C	M.S. STAND				
	MS-STAND (POWDER COATED) -Providing and fixing of lockable caging for outdoor unit grouted on wall or on roof with open able shutter made of 10 X 10 mm MS square bars placed vertically @ 5" c/c welded with 40 X 3 mm MS flat all- round. The frame shall be of angle 35mm*35mm and it shall be fixed to wall or roof with proper MS bracket to tackle the weight of outdoor unit. Item includes all necessary hardware, priming coat, synthetic enamel paint, hanger, clamps other accessories etc. All complete as per approval and instructions of the employer.Size shall be adequate for AC outdoor size & sufficient space around the outdoor suitable for servicing purpose for Outdoor unit.	No	7		

D	<p>Stabilizer shall be Automatic version with copper coil transformer and the voltage selection range shall be minimum depending on lowest peak recorded average in a month. Precise output voltage range (130V-170V to 240V -270 V). Ensure the rating of Stabilizer shall be in accordance with max rated power of ACs considering instantaneous peak load fluctuation.</p> <p>Providing and fixing Stabilizer with 3-4 step relay and input voltage range of 130-270 V and output to be 230-240 V (Blue bird/ Logic state/ Inline/ V-Gaurd/Equivalent Reputed Make) (copper winding). 5 KVA (For 1.5/ 2.0 TR Split AC)</p>	No	7		
5	<p>Inverter Wiring (From Inverter at UPS room to the mentioned points) - using 2*2.5 + 1*2.5 Sq.mm Copper Conductor FRLS wires from DB to first 6A, 5 Pin modular socket controlled by one 6A switch and looped to the nearest second point with same 2*2.5 + 1*2.5 Sq.mm copper conductor wires FRLS insulated 1100V grade (max 3 points per circuit).</p> <p>1850 inverter = 1600 watt for 125 va tubular battery.</p> <p>36 wx4 no = panal light 9wx6no= Down lighter Wall fan - 40wx4 no For 8 hours</p>	Job	1		
6	<p>Supplying and laying of Extra copper refrigerant piping with nitrile rubber pipe insulation, both of size as specified by the manufacturer suitable for 1.0 TR/ 1.5/2.0 TR Split type AC (From Indoor to outdoor Units) Beyond 10 M.</p>	Rm	84		
7	<p>Ceiling Fan-Supply and fixing of the 48 inch 3 blades Ceiling fan of Orient/ Crompton greaves / Philips make, including fixing & as per all respect etc. including connection with all necessary materials as required.</p>	No.	2		
8	<p>Wall Mounted Fan -Supplying, erecting and testing of approved / specified Wall mounted fans (METAL BODY) 400 mm dia. make As specified in tender document or approved by concerned office in charges, speed regulators etc. 230-250 volts with connections, raw bolts/anchor hole fastener completely finished make of Philips or Usha</p>	No.	14		

	or Crompton greaves as required.				
9	Exhaust Fan-Supply and fixing of the 300 mm METAL exhaust fan of Crompton greaves / Philips make, including making hole in the wall for fixing and making up for the civil damages etc. as required. including fixing & as per all respect etc.(2 No's-Toilets + 1 no's-UPS)	No.	4		
9	Supply, installation, testing, & commissioning of lighting fixtures. All fixtures should be complete with all accessories such as lamps, starters, low loss copper chokes,PF improvement capacitors etc. The fixtures should be complete with ball & socket type vibration dampers & all accessories with necessary down rods. Above specification governs all work specified below:				
a	ELECTRICAL FIXTURES & FITTINGS Supply, laying, testing and commissioning of Recessed mounting mirror optics luminaries LED (34 Watt – 4 lamps) of Havells /Philips complete with its electronic driver fittings etc in all manner - size- mm- 2'x2" including fixing & as per all respect etc.	No.	18		
b	Down Light:- P&F recessed mounted down lighters (Wipro: WCP 32218 2 x 18W LED (TC-D)	No.	17		
c	Tube light -Supply and fixing of LED (T-5) 20 W tube 4'-0" make of Crompton greaves / Philips make.	No.	9		
10	Supply and installation of circuit in app. make 1.6 mm thick, 25 mm dia PVC pipes and at places where decorum is to be maintained in PVC casings with approved make PVC insulated wire as under. The rate shall be inclusive of all necessary fittings like junction boxes, tees, bends, saddles screws etc complete. PVC pipe to be of BEC/NIC/AKG make and wire of Havel, Anchor Finolex make.				
a	10x4 sq.mm + 1x1.5 sq. mm	Rm	94		
11	Supply and installation and connection of modular type app./ specified switch and socket (ANCHOR-ROMA OR M.K. MAKE) complete with PVC box plate screws and all other accessories. Rate must also include the cost of circuit wiring with 2x2.5 sqmm + 1x1.5 sqmm				

	3 Nos. socket + 2 Nos. switches (6A)	No.	19		
12	LAN- (LOCAL AREA NETWORKING) FOR COMPUTERS :				
a	Supply and Installation of following factory fabricated patch cords (UTP-CAT 6) complete with connectors on both sides.				
	Two Meter length.	Nos.	11		
b	Supply and laying of Four Pair UTP CAT 6 LAN cables in 1 mm thick 20 or 25 mm dia pvc conduit t / Floor trunking with RJ-45 connector. including Supply and fixing of modular type Information Outlets with suitable size M.S./ PVC modular boxes complete with insulation displacement connectors etc suitable for CAT 6 UTP Cabling. One Port	Nos.	11		
c	Supply, Installation, Testing and Commissioning of the following Rack on existing wall / table / plateform etc i/c fixing of equipment/ accessories etc as required.				
	9 U Rack.	Nos.	1		
13	D-Link Switch :- Providing and fixing at site 24/48 port D link make cat-6 data switch	Job	1		
14	CHEMICAL EARTH STATION (One for branch electrical work & One for UPS system):- Installation, Testing , commissioning of CHEMICAL EARTH STATION Based on Earthing Electrode with inbuilt copper strip/GEL/GAF based. Should have resistance < 1 Ohm and should be < 2V between neutral and earth. Suitable electrode be used as per the site requirements. Earth enhanced compound powder (Gel) with hardener to be provided minimum 20Kg per site/ Back Fill/Site Filled compound (BFC/BSC)- 100 Kg. Earthing Warranty for 5 years. The electrode should be minimum 60mm dia and 3 Meter length.or 80mm dia and 2 Meter length. Dedicated earthing for computer systems, with all respect as per your required specification. Included to above item - Construction of earth pit chamber incl. Necessary brickwork, concrete, plastering S/F of CI cover of size 12" x 12".In addition to above item - Providing and fixing 2 X 8 SWG dia. earth wire in PVC conduit on surface or in recess for loop earthing along with the existing surface/ recess cable as required.	Nos.	2		

15	CHANGE OVER SWITCH: Providing and fixing at site 100 Amp manual change over switch to be fixed at the site inclusive of necessary wiring all materials, labor, etc. complete to be fixed before LDB.	Nos	1		
16	Supplying and laying 25 x 3mm copper strip direct on wall / in ground with screws and washer including soldering / welding com.	Rm	48		
17	DISTRIBUTION BOARD & MAIN BOARD a) Supplying, fixing in position, testing and commissioning of following type of 1.6mm thick sheet steel enclosed wall mounted dust and vermin proof, factory fabricated from b) MCB manufacturers indoor type distribution board with hinged cover (double door) with locking arrangement with copper phase bus, neutral and earth bars complete as required suitable for use at 3 phase 440 V/single phase 250V 50c/s supply.				
	INCOMER				
17(a)	1 Nos. RCCB 100 Amp. 100 A TPN insulated Aluminum Bus Bar 1 Set+ 100A TPN A1 bus bar no on load c/ SW 100A 2 Nos. RCB 63A (TPN) 2 No. MCB 40A (TPN)	No	1		
17(b)	LDB (4x4 TPDB – double door) I/C 63 A() O/G SP-7 Nos. 10 A, SP-5 Nos-32 A SET AS ABOVE	No	1		
18	U.P.S. DISTRIBUTION BOARD FOR OUTGOING SUPPLY Supply, Installation, Testing and commissioning of the surface / recess mounting following way Double door RCB D.B. Single phase distribution board (Consumer unit) for single phase out going with IP 422 protection incl. The followings accessories – a) 1 No. SPN RCB DB 12 way b) 1 No. 25 amp DP RCB c) 10 Nos. SP RCB 6 amp. Including Electrical connection, earthing, making good all the damages, painting, cleaning the site, etc. complete as per site requirement and as directed.	No	1		
19	Supply & fixing 40 A TPN MCB with enclosure for UPS Incomer	No	1		
				Total	

SIGNATURE WITH RUBBER STAMP OF
CONTRACTOR

DATE-

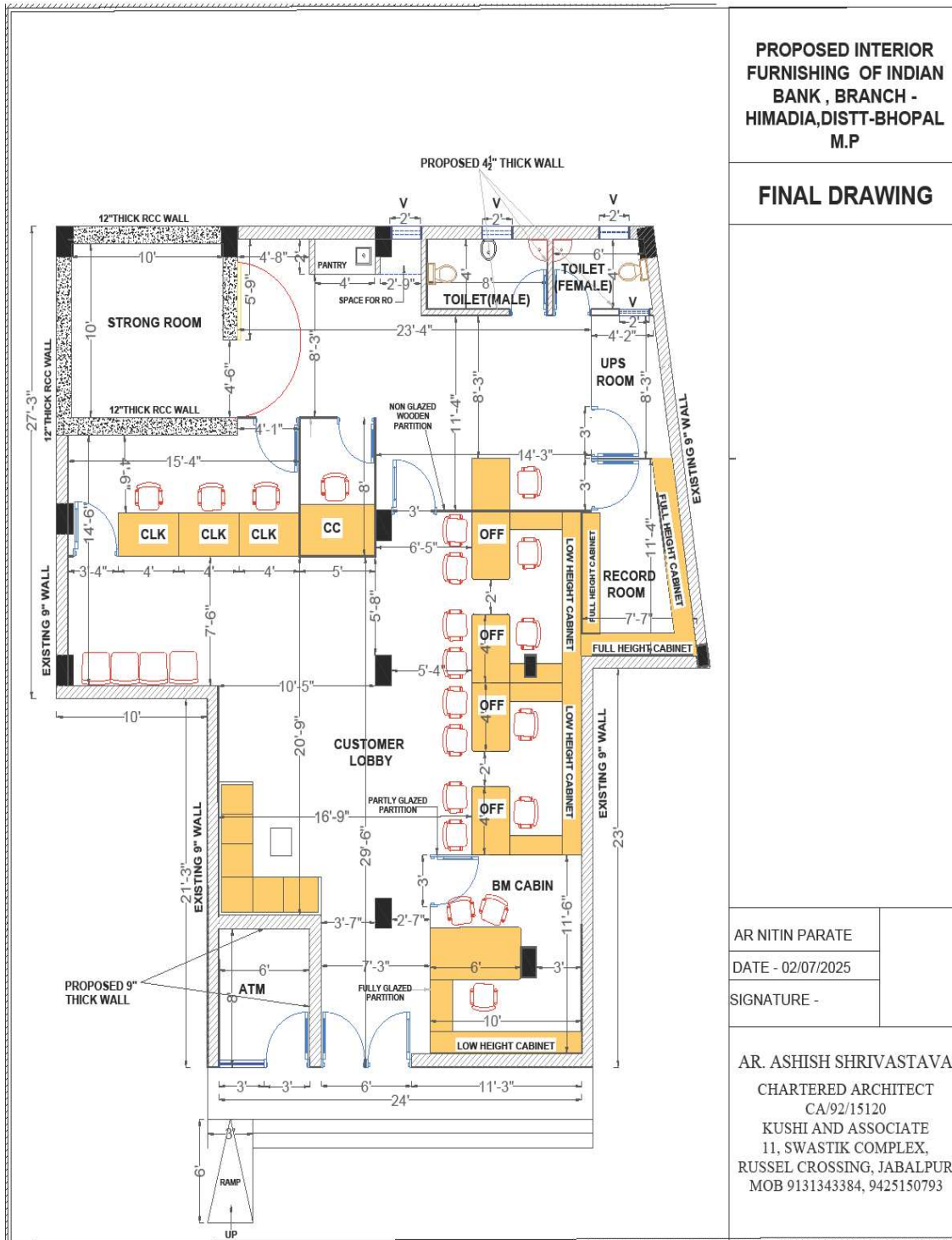

Signature of Contractor
 Tender Document for Indian bank- HAMIDIA ROAD-2 BRANCH

