



INDIAN BANK, F.G.M.OFFICE , JAIPUR

PART – I

TECHNICAL BID

SPECIFICATIONS

&

CONDITIONS OF CONTRACT

(ONLY FOR EMPANELLED CONTRACTOR)

FOR THE

INTERIOR FURNISHING , ELECTRICAL , A.C. WORK

F.G.M.OFFICE , JAIPUR

ARCHITECT

YASH GARG DESIGNER'S ,
106, NANDPURI COLONY, MALVIYA NAGAR, JAIPUR
Mobile: + 91-9929595589
Email : ygdesigners@yahoo.in

MEMORANDUM

Sealed, item rate, tenders are invited in the prescribed format from EMPANELLED contractors at INDIAN BANK (EMPANELLED AT JAIPUR/DELHI) for execution of INTERIOR FURNISHING,ELECTRICAL & AC WORK.

- a) Tender Document : INTERIOR FURNISHING, ELECTRICAL,
A.C. Works of F.G.M.OFFICE , JAIPUR
- b) Date of issue in Website : From 13.12.2025 to date of submission
- c) Last date of Submission of Tender : 20.12.2025 up to 3.00 p.m.
- Place of Submission of Tender : The Office of Asst. General Manager,
Indian Bank , F.G.M. OFFICE,
Panch Batti , M.I. Road, Jaipur 302003
- d) Opening of technical bid By : 22.12.2025 up to 11:30 a.m.
- e) Time of Completion of the Project : 30 Days from the date of Commencement
- f) Earnest money deposit : Rs. 92,000.00/- D. D. only in favor of
INDIAN BANK payable at JAIPUR. (D.D.
Will be attached in technical bid only)
(No requirement for MSME Firms)
: Rs. NIL if downloaded from bank
website.
- g) Tender Form Fees : 5% of the accepted value of tender
(including earnest money) to be paid
to the Bank within 7 days of the
Intimation of acceptance of tender.
- h) Initial security deposit : 10% of total amount (Including initial
security deposit to be deducted from
running bills if any).
- i) Retention money : Either one week from the date of
acceptance letter or the day on which
contractor is instructed to take
possession of the site, whichever is
later
- j) Date of Commencement
- k) Refund of total security : The initial security deposit comprising
of EMD shall be refunded to the

contractor along with
accrued interest upon issue of
certificate of virtual
completion by the

l) Release of Retention money

interim certificates

n) Minimum period of
Submitting Interim bills

m) Minimum value of work For
Architect

a) 50% of the retention money will be
released on completion of work and issue
of virtual completion certificate by the
Architect.

b) Balance 14 days after the end of defects
liability period.

: 60% of work

: 15 days

o) Defects liability period

:12 (twelve) months from date of completion TENDER NOTICE

To,

Dear Sir,

Sub: Interior & Furnishing , electrical and A.C. of Premises for Indian bank , F.G.M. OFFICE , JAIPUR .

Indian Bank invites sealed tenders in two bid systems from **Empaneled contractor in Jaipur / Delhi zone**

Tender copies will be available for download only from the website of
<http://www.indianbank.com/tenders.asp> from 13.12.2025

Download Tender document from web site only,

The tenders may be submitted in the following manner:

Envelope No. 1 (Tender Fee and EMD):

Entity	Favoring	Amount	DD/Banker's Cheque payable at
EMD (Refundable)	Indian bank	92,000/- Ninety-two Thousand rupees only	JAIPUR

		Applicable MSME firms are not required to submitted EMD	
--	--	---	--

The Tenderer must also submit the Mandatory Information strictly in Bank's prescribed Performa. Indian bank Empaneled letter will be based on the Mandatory Information and supporting documents submitted along with the tender documents, as well as Architect & Bank's scrutiny of the same and/or inspection of works carried out by the Tenderer. Bank reserves the right to accept or reject any tender without assigning any reason whatsoever.

Envelope No. 2 (Technical Bid):

☐ Mandatory Information (strictly in the Bank's prescribed Preform) ☐ Other supporting documents & credentials of the tenderer.

Must not contain any commercial information. Any Commercial discloser in the Envelop no. 1 or 2 will disqualify the tenderer without any further scrutiny.

The tenderer shall submit the completed tender documents duly signed in an envelope marked with name of work.

Envelope No. 3 (Commercial Bid/Price Bid):

☐ Commercial Bid/Price Bid.

Tender Bids received in any form other than mentioned above will be disqualified.

Sealed tenders in the prescribed tender form, with the tender fees and EMD, along with the Mandatory Information etc. and commercial bid (herein under after called as price bid), should be addressed to

The Office of Field General Manager,
Indian Bank , F.G.M. OFFICE, Panch
Batti , M.I. Road, Jaipur 302003

and super scribed "Tender for interior & furnishing work of Premises for Indian Bank, F.G.M. OFFICE, JAIPUR

Eligibility Criteria:-

I] Indian bank Empanelment letter.

II] Applicable MSME Certificate for non EMD .

III] EMD D.D.

IV) Bidder should have their office / branch office in Rajasthan/ its nearby area of the project site.

V) Tenderer /Bidder should have main activity as Contractor ship otherwise tender shall be rejected .Tender / Bidder should also to submit their Pan, GST Tax Registration No. and also submit documentation for the same.

VI) Bidder should have valid electrical licenses in the name of firm office / branch office in Rajasthan/ its nearby area of the project site.

In addition to above, the criteria regarding satisfactory performance of works, personnel, establishment, detail of infrastructure, equipment etc may be incorporated in the Technical bid.

Sealed Tender must be dropped in a tender Box placed at “Indian Bank, F.G.M. OFFICE, JAIPUR” not later than 3:00 p.m. on 20.10.2025.

Tender should be addressed to

The Office of Field General Manager,
Indian Bank , F.G.M. OFFICE,
Panch Batti , M.I. Road, Jaipur 302003

Tenders of the prospective bidders (TECHNICAL BID) will be opened at 11:30 a.m. on 22.10.2025.

Defect Liability Period shall be twelve (12) Months from the date of issuance of virtual completion Certificate of the works.

Validity of offer shall be 90 days from the date of opening of Bid. The Bank does not bind itself to accept the lowest or any tender and reserves itself the right to accept or reject any or all tenders, either in whole or in part, without assigning any reason for doing so.

INSTRUCTIONS TO TENDERERS:

1.0 Location:

1.1 The site is located at JAN PATH, SHYAM NAGAR , JAIPUR

1.2 Tenderers must get acquainted with the proposed work and study drawings, designs, specifications, conditions of contract and other conditions carefully before tendering. The Tenderer shall seek clarifications on any item, if required, prior to submitting his tender. No request of any change in rates or conditions for want of information on any particular point shall be entertained after receipt of the tenders.

1.3 The Tenderer is advised to inspect the site to ascertain the nature of site, access thereto, location, facilities for procurement of materials, labour rates and execution of the work. The Tenderer shall be deemed to have full knowledge of the site and drawings whether or not he actually inspects them.

2.0 Submission of Tender:

Sealed Tender along with price bid shall be dropped in The Office of Field General Manager, Indian Bank , F.G.M. OFFICE, Panch Batti , M.I. Road, Jaipur 302003

and as per details given here under. The rates shall be filled in the Schedule given in, of the tender document. In case of any queries, the Tenderer may contact following:

INDIAN BANK : CM , F.G.M. OFFICE, JAIPUR

Architect : YASH GARG DESIGNER'S,
106, NANDPURI COLONY, MALVIYA NAGAR,
JAIPUR. 9929595589

2.1 The tender shall be submitted in single bid in a sealed envelope. The envelope containing the tender offer shall be duly super scribed with the name of work .

2.2 The Tenderer is requested to quote strictly as per the terms and conditions and specifications given in the tender document and not to stipulate any deviations. However, deviations, if unavoidable, should be indicated separately indicating the specific page number and clause number against which the deviations are made. Wherever specifications of certain works are not available they shall be deemed to be done as per relevant I.S code.

2.3 Addenda to this tender document, if issued, must be signed and submitted along with the tender document.

2.4 All pages to be initialled:

All signatures in tender documents shall be dated and stamped. All pages of tender documents shall be initialled at the lower right hand corner or signed wherever required in the tender papers by the Tenderer or by a person holding power of attorney authorizing him to sign on behalf of the Tenderer before submission of tender.

2.5 Rates to be in figures and words:

The Tenderer should quote in English both in figures as well as in words the rates and amounts tendered by him in the Schedule of Rates for each item and in such a way that interpolation is not possible. The amount for each item should be worked out and entered and requisite totals given of all items both in figures and in words. The tendered amount for the work shall be entered in the tender and duly signed by the Tenderer.

2.6 Corrections and Erasures

No corrections and alterations in the entries of tender papers shall be permitted. If any they shall be signed and dated in full by the Tenderer. Corrections with white fluid and overwriting are not permitted.

2.7 The tender shall contain the names, postal address of the residence and place of business of authorized person signing the tender and shall be signed in /his usual signature. Partnership firms shall furnish the full names of all Partners in the tender. It should be signed in the partnership name by all the partners or by duly authorized representative followed by the name and designation of the person signing. Tender by a Corporation shall be signed by an authorized representative, and a power of Attorney on their behalf shall accompany the tender. A copy of the partnership deed of the firm with names of all partners shall be furnished.

2.8 When a Tenderer signs a tender in a language other than English, the total amount tendered should, in addition, be written in the same language. The signatures should be attested by at least one witness.

2.9 Witness:

Witnesses and sureties shall be persons of status and propriety and their names, occupation and address shall be stated below their signatures.

3.0 Information required along with tender:

The following details are required to be submitted along with tender:

- a) List of Sub contractors to be employed.
- b) List of equipment proposed to be deployed for work.
- c) Site Organization chart with bio-data of Resident Engineer and key personnel proposed to be deployed at site.
- d) Income Tax Clearance and Sales Tax clearance certificates.
- e) Power of Attorney in the name of persons who has signed the tender document.
- f) BAR/PERT Chart.
- g) Each Tenderer shall submit with his tender a list of large works of like nature he has executed giving details as to their magnitude and cost, the proportion of work done by the contractor in it and the time within which the works were completed. The Tenderer shall also submit along with his tender a list mentioning the names of manufacturers of specialized items.

4.0 Any printing or typographical errors/omission in tender document shall be referred to the Architect/Interior Designers appointed by the Bank and their interpretation regarding correction shall be final and binding on Contractor.

5.0 Transfer of Tender Documents:

Transfer of tender documents purchased by one intending Tenderer to another is not permitted.

6.0 Earnest money:

6.1 The Tenderer shall pay the amount of Earnest Money as mentioned in the Notice Inviting Tender, by Bank Demand Draft/Banker's Cheque payable to Indian bank, at JAIPUR. No interest on Earnest Money deposited by the Tenderer shall be allowed. The Tenderer should attach the bank draft/banker's Cheque along with the tender failing which the tender will not be considered.

6.2 The Earnest Money of the unsuccessful Tenderers will be refunded in form of same DD Submitted by them within a reasonable period of time without any interest.

6.3 The Earnest Money deposited by the successful Tenderer shall be retained as part of Security Deposit.

6.3.1 The Security Deposit shall be forfeited if the Contractor fails to observe any terms and conditions of the Contract.

7.0 Validity:

Tenders submitted by Tenderers shall remain valid for acceptance for a period up to 90 days from the date of opening of tender. The Tenderers shall not be entitled during the period of validity, without the consent in writing of Bank to revoke or cancel his tender or to vary the tender given or any terms thereof.

8.0 Addenda:

- 8.1 Addenda to the tender document may be issued if required to clarify documents or to reflect modifications to the design or contract terms.
- 8.2 Each addendum issued by the Architect/Interior Designer will be distributed to each person or organization to which a set of tender documents has been issued. Each recipient will submit the same along with his tender. All addenda issued by the Architect/Interior Designer shall become part of Tender Documents.

9.0 Right to accept or reject tender:

- 9.1 The acceptance of a tender will rest with the Bank who does not bind themselves to accept lowest tender and reserve to themselves the authority to reject any or all the tenders received without assigning any reasons. They also reserve the right of accepting the whole or any part of the tender and the Tenderers shall be bound to perform the same at the rates quoted. All tenders in which any of the prescribed conditions are not fulfilled or are incomplete in any respect or there is any correction not duly signed and dated by the Tenderer are liable to be rejected. For this purpose Tenderer shall quote rates for various items which will be self sufficient to meet their whole costs for executing any / every item. No demand for variations in rates for items executed shall be entertained on the plea of the Bank deciding to delete, alter or reduce the quantities specified in respect of the any item.
- 9.2 The work may be awarded to one or more agencies duly splitting the work at the entire discretion of the Bank and the Architect/Interior Designer. The quoted rates shall hold good for such an eventuality.

10.0 Rates:

- 10.1 The Bank is not concerned with any rise or fall in the prices of materials and labour. The rates quoted shall include all costs, allowances or any other charges including any enhanced labour rates etc. which may become effective for any reason including those due to acts of Government/ Statutory Bodies enacted from time to time by the State and or the Central Government. Under no circumstances, shall the Bank be held responsible for compensation or loss to the contractor due to any increase in the cost of labour or materials etc. G.S.T. WILL PAID EXTRA BY BANK
- 10.2.1 The rate quoted in the tender shall also include electric and water consumption charges for construction and erection. If power and water are available at the site, the Contractor shall have to make his own arrangements to obtain the connections from the available sources at his own expense and maintain an efficient service of electric light and power and water and shall pay for the services consumed and maintain the installations at his own cost. If no power and water are available at the site, the Contractor shall have to make his own arrangements to obtain power and water connections and maintain at his own expense an efficient service of electric light and power and shall pay for the electricity consumed.
- 10.3 The rate quoted in the tender by the contractor should include cost of -3- sets of 10" x 12" Photographs done by a reputed professional photographer, of the completed work.
- 10.4 Contractor to include cost of pest control treatment of the entire site, including white ants, Roaches, rodents for one year from date of virtual completion of the contract.

- 11.0 Contractor to coordinate and assist the Architect/Interior Designer in obtaining all Statutory approvals including MMC, CFO and any other State and Central rules in force. Any expenses incurred in obtaining such approvals are deemed included in the rates quoted by the Contractors.
- 12.0 The entire interior work shall be guaranteed to be free from manufacturing defects, defective workmanship or materials and any defects that may appear within 12 months from the date of issue of completion certificate which in the opinion of the Bank/Consultants have arisen from bad manufacturing, workmanship or materials, shall upon intimation be made good by the Contractor at his own cost within the time specified. During the said period of 12 months the Contractor shall without any extra cost, carry out all routine and special maintenance of the Interior and attend to difficulties and defects that may arise. The Tenderer / Contractors shall associate with him during the execution and free service period, the operation and maintenance staff of the Bank.
- 13.0 Payments for the work to be executed under this contract shall be made as per the tender Document and no variation in the mode of payment will be acceptable. The Tenderer shall guarantee that the work shall conform to the detailed specifications.
- 14.0 Signing of the contract:
- a. The successful Tenderer shall be required to execute an agreement in the proforma attached with this tender document within 45 days from the date of receipt of the notice of acceptance of tender. In the event of failure on the part of the successful Tenderer to sign the agreement within the above-stipulated period. The Bank reserves the right to forfeit the earnest money/ security deposit and cancel the contract.
 - b. Until the Agreement is formally signed, the Work Order / Letter of Acceptance of Tender issued to the successful Tenderer and accepted by him shall be operative and binding on the Bank and the Contractor.
- 15.0 On acceptance of the tender, the name of the accredited representatives of the Tenderer who would be responsible for taking instructions from the Bank shall be mentioned by the Tenderer.
- 16.0 If so decided, the Bank reserves the right to appoint PMC (Project Management Consultant) or any other agency to get the quality of works checked, measurements recorded, including certification of bills etc.
- 17.0 The Bank reserves the right to reproduce partly or fully the items executed on site anywhere in the country premises and no copyright claims shall be made by any contractor of any description from the Bank.
- 18.0 The Bank has the right to delete items, reduce or increase the scope of work without the contractor claiming any compensation for the reduction in the scope of work.
- 19.0 Notices to local bodies:
- The contractor shall comply with and give all notices required under any law, rule, regulations or bye laws of parliament, state legislature or local authority relating to works . the contractor shall before commencing the execution of work issue a certificate to the bank / architect / consultant that he has obtained all the permission registrations and give all the notices as are required to be obtained or give in under law .
- 20.0 I / We hereby declare that I / We have read and understood the above instructions for the guidance of the Tenderers.

Witness _____

Signature of Tenderer

Address _____

Address _____

Date : _____

Date:_____

LIST OF APPROVED MANUFACTURERS FOR DIFFERENT MATERIALS TO BE USED IN THIS PROJECT

Names of materials and finished approved by the Architect /Employer are listed below: However equivalent materials and finished of any other specialized firms may be used, In case it is established that the brands specified below are not available in the market are subject to the approval of the alternative brand by the Architect. Original materials will be delivered on site, no other substitute will be allowed.

INTERIOR MATERIAL

S. NO.	ITEM	DESCRIPTION
1.	MDF / PLYWOOD/ BLOCK BOARD ,	CENTURY/ ASIAN/ ARCHID/ GREENPLY / KITPLY OR EQUIVALENT
2.	LAMINATE SHEET	Archidlam / National / Formica / Greenlam / Royal touch / MARINO
3.	VENEER	Green / DURO / Century / Timex / Anchor or equivalent
4.	PARTICLE BOARD	Archidply /Greenlam/Century / KITPLY/ MARINE BOARD equivalent ISI make
5.	ACRYLIC SHEET	ICI, GE or equivalent ISI make
6.	MARINE GRADE PLYWOOD	Century, Kitply, Greenply, Anchor, Orchid, Prince
7.	ADHESIVE	Fevicol / Aratdite/Anchor or equivalent
8.	SOLID SURFACES {CURION}	DUPOINT/HI-MAC/ STARON OR equivalent
9.	MARINE GRADE BLOCK BOARD	Century, Kitply,Greenply, Anchor, archid or equivalent
10.	FLUSH DOORS	CENTURY/ KITPLY / GREENPLY / ANCHOR/ ORCHID OR EQU.
11.	POLISH	ASIAN /DULEX OR EQU.
12.	LATEX	MM Foam or equivalent Ist make
13.	HIGH DENSITY FOAM	U Foam or equivalent ISI make
14.	LOCKS,	Godrej / Haffle / Hettich / Ebco or equivalent
15.	STORAGE HARDWARE	Godrej / Haffle / Hettich / Ebco or equivalent
16.	SCREWS, NAILS & OTHER ACCESSORIES	GKW / Nettle ford or equivalent
17.	FALSE FLOORING	Kebao , Armstrong , AMF or equivalent
18.	VINYL FLOORING	Armstrong ,gerftor, Eurotex ,
19.	CARPET	Unitex, Armstrong
20.	WOODEN LAMINTED FLOORING	Pergo / Armstrong / Euro / Squarefeet or equivalent
22.	HARDWARE FOR GENERAL STAFF AREAS	Dorma / Euro/ Ozone / Enox / Ebco /Hamco or equivalent

23	HARDWARE FOR MAIN GLOSS DOOR	Dorma / Euro/ Ozone / Enox / Ebco /Hamco or equivalent
24	DOOR CLOSERS	Dorma / Euro/ Ozone / Enox / Ebco /Hamco or equivalent
25	FLOOR SPRINGS	Dorma / Euro/ Ozone / Enox Ebco /Hamco or equivalent
26	FLOOR SPRINGS FOR MAIN GLASS DOORS	Dorma / Euro/ Ozone / Enox / Ebco /Hamco or equivalent
27	ALUMINIUM SECTIONS FOR PARTITIONS	JINDAL / TATA STEEL OR EQU.
28	FALSE CEILING: GYPSUM	India Gypsum / Saint Gobin / Asia
29	FALSE CEILING: GRID{ AS APPROVED}	Armstrong / AMF or equivalent
30	FALSE CEILING: GRID{ METAL CEILING}	Unimech / AMF / Armstrong /
31	GI SECTIONS	Lndta Gypsum / Saint Gobin / Jinda\ or equivalent
32	ACOUSTICAL FALSE CEILING: MINERAL FIBER BOARD	Armstrong, Hunter Douglas / Peritex or equivalent
33	POP PUNNING	GYPROCK / INDIAN GYPSUM / BIRLA
34	PAINT	ASIAN / NEROLAC / DULEX / BERGER OR EQU.
35	EXTERIOR PAINT	ASIAN / NEROLAC / DULEX / BERGER OR EQU.
36	A.C.P. (INTERIOR & EXTERIOR)	Alstone / Eurobond / Alucobond
37	CYLICON	G E/ Dow coming / Wacer
38	ROLLING / VERTICAL BLINDS	Vista / Perltext / Wlnfab / Mac or equivalent
39	FROSTED FILM	Garware or equivaient
40	ALUMINIUM SKIRTING50MM	Jlndal or equivalent
41	WATER PROOFING	Pldillte or equivalent
42	HARDWOOD	Salwood / Teakwood /kapoor
43	AUTOMATED ROLLING SHUTTER	Gandhi automation / Toshi automatic systems /akash rolling shutter
44	GLASS	Saint Gobln / equivalent

PLUMBING MATERIAL

1	CP FITTING	Jaquar/Hindware or equivalent
2	SANITARY WARE	Hindware / Cera / Parrywar or equivalent
3	SANITARY FITTINGS	Jaquar/Hindware
4	GEYSER	Bajaj / Sphere Hot/ Crompton /racold vguard/ havells
5	STAINLESS STEEL SINK	Nirali / Diamond or equivalent
6	C.I. PIPE	Bengal Iron Corporation or equivalent ISI make
7	URINAL PARTITION GLASS	Merino / Saint Gobain/ Modi/ Asai

8	GI PIPE	Tata/ Jindal / Zenith or equivalent
9	CP FITTING	Pince /Astral or equivalent
10	PVC & CPVC PIPE	Pince /astrai or equivalent

CIVIL MATERIAL

1	Ceramic Tiles / Vitrified Homogenous Glazed Tiles	HR Johnson, Kajaria. Nitco, ASL or equivalent
2	Cement	Ultratech , ACC, JK Cement , Ambuja
3	Chemical Fasting { Tiles }	Pidlite, Fosroc, Eurokart
4	Steel	Sail, Tiscon, Ispat ,Tata

ELECTRICAL MATERIAL

S. NO.	ITEM	DESCRIPTION
1.	Light Fixtures & Lamp	Philips / Wipro / Osram / Havells / Crompton g./halonix
2.	Ht Cable	Polycab/ Havells/HPL
3.	Modular Switches	ABB, Legrand, /MK/ ANCHOR/ ELLEYS/ ROMA
4.	Dlp Trunking	Legrand /Schneider
5.	Power Cable	CCI / SKYTONE/ UNIVERSAL/ LAPP/ TORRENT
6.	End Termination	RYCHEM/ MAHINDRA/ ELMEX
7.	Panel	CROMPTON/ L&T/ C&S
8.	Fan	CROMPTON/ HAVELLS/ BAJAJ/ USHA
9	Raceway & Alu. Trunking	TATA./ JINDAL/ ZENITH
10.	Casing & Caping	FINOLEX /CAP or Equivalent
11.	Weather Proof Socket Outlet With MCB	ABB/ MDS/ LEXIXC/ Neptune/ Elcon- Clipsil, Siemens, Schneider {Merin Gerin}
12.	Miniature Circuit Breaker	MDS/ LEXIS/ siemens/ HPL
13.	MCB distribution board in steel housing{ double door}	ABB / LEXIS/ siemens/ HPL
	DISTRIBUTION	
14.	MV Contractor/ Timer/ Relays/Starters	Legrand /Schneider{MG}/ ABB/ Siemens/ L&T
15.	Moulded Case Circuit Breakers	Legrand /Schneider{MG}/ ABB/ Siemens/ L&T
16.	SFU / FUSES	HPL /Schneider{MG}/ ABB/ Siemens/ L&T Siemens
17.	ACB	Schneider{MG}/ ABB / Siemens/ L&T
18.	Single Phase Preventer {Current Base}	L&T , Minilec
19.	Raising Mains & Tap Off {Power Coated}	Zeta, C&S, Siemens
20.	MV Switch Boards {Powder Coated}	Tricolite Electrical Industries, conlec Engineers Pvt.

		Ltd, Vidyut Control Pvt Ltd., Trinitron Milestone Switchgear, Unilec Ltd, Madhu Electricals\ Advance Electro Control Pvt Ltd.
	LOW TENSION SYSTEM	
21.	Light & Fan Wire	Polycab, Finolex, Hawells
22.	Telephone Wire	Delton, Skyline, Finolex, Rallison, Batra Henley
23.	Telephone Tag Blocks	Krone / Pouyet/ TVS
	Cable & Accessories	
24.	1100 volts grade cables	CCI, Universal, Fort Gloster, Polycab, RPG {Asian}, Nicco
25.	Cable lugs	Dowells
26.	Cable compression glands	Peeco/ Comet
27.	Capacitor Bank ISI MARK	GE POWER / BHEL/ EPCOS/ L&T
28.	Lighting Arrestor	Altas / Alstom/ GE Power
29	Protection & Other Relay	ABB/ Siemens/ Schneider/ L&T/ Allen Bradley
	Internal Wiring Related Works	
30.	MCB/ RCCS/ Isolators {ISI} MARKED MCB DB	L&T Siemens/ Schneider/ Legrand
31	PVC CONDUIT	CAP/ BEC/ Seiko/ AKG
32	PVC Insulated Copper Wire ISI Marked	SKYLINE/ FINOLEX/ POLYCAB/ HAVELLS
33	TELEPHONE CABLE	SKYTONE/ DELTON/ NICCO/ POLYCAB/ FINOLEX
34	Switch, TV & Telephone Socket & Boxes {Modular Type}	CPL/ LEGRAND/ ABB/ ANCHOR
	MISCELLANEOUS ITEMS	
35	LIGHTING PROTECTION UNIT	Erico / Pheonix/ INDELEC
36	RELAYS	L&T/ ABB/ Siemens/ BCH
37	CONTRACTORS	I&T/ GE Power/ BCH/ Siemens/ ABB
38	CHANGEOVER SWITCH	C&S/ Havells/ L&T/ HPL
39	KWH,PF,FREQUENCY METER	BHEL/ AE/ Havells/ L&T/ ALSTOM
40	PUSH BUTTONS	L&T/ Siemens
41	TIMERS	L&T/ Legrand/ Schneider/Siemens/GE
42	TIMER SWITCH	L&T/ Legrand/ Schneider/Siemens/GE
	NETWORKING	
43	SWITCHES	Brocade/Cisco/ Digi-Link/ 3Com/ Nortel/ Foundry/ DLink
44	PATCH PANEL, PATCH CORD & I/O	Digi-Link / TyCo(AMP) / Schneider/ D-Link
45	CABLE	Digi link/ Clipser/ National/ Polycab/ Lapp/ Finolex
46	RACKS	Comrack / HCL / Valrack / APW President
	MODULAR	
47	Extruded Aluminum Sections	Hindalco, Sant aluminum, Midi extrusions
48	Pre Laminted Particle Board	Action Tesa, Associate Décor, Asis, Century (interior grade - 2
49	PVC Lipping	Rehau, Dolkin
50	Hinges/ Storage And Pedestal Locks/ Minifix Fittings / Sliding Channels Etc.	Ebco, hafele, Hettich or equivalent

51	8 mm Glass	Modi, Saint gobain, Asahi
52	Door Locks For Cashier Cabin	Godrej, Enox, Doorset, Ultra, Ebco
53	Hydraulic Door Closer	Yele, Enox, Everite, Ebco
54	Powder Coating	paramount, Narolac
55	Fabric For Panel	Response
56	Mdf	8mm / 10mm / 12mm / 18mm MDF

Date :

Place :

[To be signed by the Authorized
Representative of Tenderer holding
Power of Attorney]



INDIAN BANK, F.G.M.OFFICE , JAIPUR

PART – II

FINANCIAL BID

SPECIFICATIONS

&

CONDITIONS OF CONTRACT

(ONLY FOR EMPANELLED CONTRACTOR)

FOR THE

INTERIOR FURNISHING , ELECTRICAL , A.C. WORK

F.G.M.OFFICE , JAIPUR

ARCHITECT

YASH GARG DESIGNER'S ,
106, NANDPURI COLONY, MALVIYA NAGAR, JAIPUR Mobile:
+ 91-9929595589
Email : ygdesigners@yahoo.in

S.No	Title	Description	Unit	Quantity	Rate	Amount
		False ceiling				
1	Gypsum False Ceiling	P&F false ceiling with Gypsum Board 12.5mm thick fixed to a metal frame with cove design comprised of ceiling channel of size 80mm X 26mm X 0.5mm @ every 600 mm centres, inter channel 45mm X 15mm X 0.9mm @ every 1220mm centres, peri-meter channel 20mm X 26mm all along the wall, strap hanger suspendeds 25mm X 0.5mm with nuts and bolts 6.4mm x 12.7mm, connecting clip 2.64mm thick, dry walls screw 25mm long , soffit cleat. 27mm X 37mm X 25mm X 1.6mm thick and dash fastener/ rawl plug 12.5mm dia X 35mm long with 6mm dia bolt. The joint of gypsum board to be taped 3 times and sealed with jointed compound with three coat plastic emulsion paint finished. Cut-out are provided to accommodate luminaries, air conditioning grills and fire warming detectors if any. The rate to include two or more coats of approved paint after preparing the surface. All fitting to be separately hung from the ceiling and should not rest on the false ceiling.	Sqm.	144		
2	Grid False Ceiling	<p>The grid false ceiling shall be provided in the Banking Hall, Manager's etc. The ceiling height and level shall be determined at the perimeter. The minimum height of the ceiling cavity should be 100mm. All service fittings integrated within the suspended ceiling must be independently supported from the ceiling grid by a structure designed for the purpose.</p> <p>Ceiling tiles</p> <p>Shall be Armstrong Fine fissured Classic lite RH99 of 16mm thickness. Suspension system Shall be of Armstrong Trulok Silhouette reveal profile grid system with 15mm flanges incorporating 3mm central recess in global white with black reveal. Silhouette main runners and cross tees to have mitred ends and "birdsmouth" notches to provide mitred cruciform junctions.</p> <p>♦ Installation</p> <p>Main runners will be placed at 1200mm centers securely fixed to the structural soffit by approved hangers at 1200mm maximum centers and not more than 150mm from spliced joints. The last runner at the end of each main runner should not be greater than 600mm from the adjacent wall. 1200mm long cross tees to be interlock between main runners at 600mm centers to form 1200x600mm modules. Cross tees longer than 600mm require independent support. 600x600mm modules to be formed by fitting 600mm long cross tees centrally between the 1200mm cross tees. The 1200mm cross tees to have central "birdsmouth" notches to facilitate fitting of 600mm cross tees. The perimeter trim to be Armstrong Trulok equal wall angle of white color secured to walls at 450mm maximum centers.</p>	Sqm.	120		
		Full Height Partition				
3	Full Height Partition (Wooden with Laminate)	providing ,fabricating & fixing of partition made out with unanodised ALUMINIUM Framework consisting of 2" X 1" section placed at min 2'x2' horizontally & vertically (as per site requirement) with 12mm thick water proff mdf finished with 1mm thick designer textured laminates in two or more colours as per design(of approved shade) on both sides (as approved by bank engg/ architect) . The sides /top shall be finished with teak wood beading (3"x 1") with PU finish . This partition will be above 3' ht. with 12mm thick clear glass / of aqua blue shade (approved make) . measurment will be upto false ceiling level.				
		Partition as above in Sqft. (top width including partition glass & ht. will be measured for payment)	Sqm.	84		
4	Low Height Partition (Wooden with Laminate)	providing fabricating & fixing of partition made out with unanodised aluminium Framework consisting of 2"x1" placed at min 2'x2' horizontally & vertically (as per site requirement) with 12mm thick water proff mdf finished with 1mm thick designer textured laminates in two or more colours as per design (of approved shade by bank engg/ architect) on both sides. The sides / top shall be finished with teak wood beading (3" x 1") with PU finish. This partition will be upto 3' ht. with 18" ht. 12mm thick toughened clear glass / aqua blue shade (approved make). The partition shall also be provided with 12mm toughened glass partition between counter upto 4'-6" ht. with 6" x 3" x 15" pillar. (Partition in sqft. including glass ht. & width will be measured for payment)	Sqm	63		
		Wall Finishing / Panelling				
5	column /wall panelling (Laminate)	Providing & fabricating of coloumn / wall panelling made out with un-anodised aluminium Framework consisting of 1" x 1" pipe placed at min. 2'x2' horizontally & vertically (as per site requirement) with 12 mm water proof MDF . aluminium Framework with PLYWOOD Board skinning 1mm thick designer textured laminates in two or more colours as per design (of approved shade by bank engg/ architect) the coloumns / wall & necessary vinyl prints , jali work etc. as per approved drawings. The rates are including the design provided in the approved drawing.	Sqm.	157		
6	A.C.P. PANELLING (INTERNAL 3 mm)	Proving and fixing in position Aluminium composite panel Boxing with PVDF coating & LDPE core laminated Eurobond / Altobond/ Alukbond Exterior Grade 4 mm thick with composite of (0.5mm - 3mm- 0.5mm) including fabrication for the same with aluminium sections, required hardware, silicon sealant (Dow Corning 789) masking tape, necessary scaffolding etc. complete in all respects.	Sqm.	37		
		STORAGE CABINET				

7	storage cabinate (Laminate top)	Providing and fixing wooden storage 450 mm wide having sides, partitions shelves and shutter made of 19 mm th. Board with 1 mm th. DESIGNER TEXTURED laminates as per design with all other exposed internal / external surface provided with Duco paint with melamine coating complete with side hinged sutter complete with handles , locks etc. (for the purpose of contractor's payment only front elevation area of a cabinate will be measured.	Sqm	64		
		TABLE/ COUNTERS & RACKS				

ESTIMATE OF INTERIOR & FURNISHING WORK FOR INDIAN BANK F.G.M. OFFICE, AT JANPATH, SHYAM NAGAR , JAIPUR.

8	regional head table	Supply & fixing in position branch head table (size 8'0" X 4'0") made out of 19 mm thick BWR board with 4mm th. /teak veneer with high glass PU FINISH on table top complete. Drawers shall have ball bearing slides & locks etc. complete internal surface shall be finished with .8 mm th. laminated with high glass white laminate. each table shall have the provision of key board with ball bearing slides Arrangement 12mm in Toughened glass top & 12mm in Toughened glass modesty panel .The provision of side trac (upto 4' x 2.5" as per site) is included in the rate . The Design will be as per drawing approved	No.	1		
9	6'0"x 3'0" table	Supply & fixing in position table (size 6'0" x upto 3'-0") made out of 19 mm thick board with 1 mm white laminate top at 2'6" ht. curved in front & sloping down wards upto 1;3" , CPU & keyboard tray as per single window counter & shutters complete as for single window cabinets completed in all respects . The table top will have glass of 12 mm th. with 1" beveling is also included in the item .	No.	1		
10	5'6" x 2'6" table	Supply & fixing in position table (size 5'-6" x upto 2'-6") made out of 19 mm thick board with 1 mm white laminate top at 2'6" ht. curved in front & sloping down wards upto 1;3" , CPU & keyboard tray as per single window counter & shutters complete as for single window cabinets completed in all respects . The table top will have glass of 12 mm th. with 1" beveling is also included in the item .	No.	2		
11	5'0" x 2'6" table	Supply & fixing in position table (size 5'-0" x upto 2'-6") made out of 19 mm thick board with 1 mm white laminate top at 2'6" ht. curved in front & sloping down wards upto 1;3" , CPU & keyboard tray as per single window counter & shutters complete as for single window cabinets completed in all respects . The table top will have glass of 12 mm th. with 1" beveling is also included in the item .	No.	7		
12	centre table	Providing & Keeping centre table made out of 18 /12 mm thick plywood & 6/12 mm thick the fleiply as per design . The top should be finished with edges of 2" thick the vertical support should be of 24" dia. Etc. complete with necessary hardware . The top surface with edges should be finished with 12 mm th. salt colour dupont corian solid surface etc. complete as per detailed drawing & instruction of Architect / engineer.	No.	3		
13	WORK STATION	Supply & fixing in position L shape work station (size 5'-0" x upto 2'-6" main table top and 5'0" x 2'0") made out of 19 mm thick board with 1 mm approved laminate top at 2'6" ht. in front & 2'0" side upto 1;3" , CPU & keyboard tray as per single window counter & shutters complete as for single window cabinets completed in all respects . The table top will have glass of 12 mm th. with 1" beveling is also included in the item .	RM	18		
14	CONFERENCE TABLE	CONFERENCE ROOM TABLE: 14'0" x 3'0" (rectangular Shape), Formed of 19 mm. th. BWR grade plywood with modesty panel, the front/back and sides of the worktop to be thickened to 1-1/2" and covered with teak/beech wood moulding 1 1/2"x3/4", duly stained, polished and melaminated, and the top to have 4 MM veneer finished with pu high gloss finish (Glossy) of approved shade and colour including external surfaces finished with 1.5 mm. th. laminate, internal surfaces to be finished with 0.8mm thk laminate all complete as per the Architects design and standard specification.	Nos.	1		
		TOUGHNED GLASS WORK				
15	12 MM TH. TOUGHENED GLASS PARTITION	FULLY GLAZED 12 MM TH. TOUGHENED GLASS PARTITION As above item no 1 Aa (both side gyp. board finished partition but partition shall have 12 mm th. Toughened plane glass fixed with 1 1/2" x 1" teak wood moulding finished with white high gloss laminate 4mm teak wood veneer finished with stainless steel "D" Brackets etc . Complete as per detailed drawing & innstuction of Architect /Engineer .	Sqm	35		
16	12 MM TH. TOUGHENED GLASS Door	12 MM TH. TOUGHENED GLASS Cabin door providing & fixing main doors/cabin made out of/cabin door made out of HNG/ Asahi India MAKE 12 MM TH. toughened plain glass in single piece with computerised diamond cut & diamond edge polish including making required cutout holes for lock , handles , pivot patch fitting , corner fitting hinges etc. the rate is inclusive of patch fitting of dorma make floor spring , pivot patch fitting with cover plate locks handles , singsges with necessary hardware etc. as per intructions of Architect/Engineer.	SQM	18		
		FINISHING WORKS				
17	Roller Blinds	Providing and fixing Roller blinds of required width & Length quality of approved make fabric made of 100% polyester thickness 0.30mm with Acrylic coating resistance to Cracking & Fraying and treated for dust repellency, UV proof , virtually maintenance free having plastic bottom chain thickness of chain 0.50mm and diameter-3mm, weight per sqm 201g, Degree of opacity 100%, Light frastness 4/6, Plastic with metal bottom weight - 116.20mmX48.30mm and suitable coating on exterior, including all fixtures and fittings complete in all respect as per design/color/shade including requisite installation brackets etc as required for installation at site with anchoring arrangements complete as directed.	Sqm	50		
18	FLUSH DOOR	Providing and fixing flush door with 35mm water proof door with 1mm high glass laminate (of approved shade) on both sides The item includes 75C50mm TW choukhat , 7 lever mortise lock, SS handle, stopper hinges, paint/polish etc complete	Sqm.	12		

19	Louver Shutter for electrical panel	Providing & fixing Shutter Boxing for rolling shutter made 19mm thick fire resistant boards such as Bison board etc. finished with 1.0mm thick laminate including hinged cover as per approval of Architect / Bank's Engineer.	Sqm	4		
20	3 M FROSTED FILM	Providing & fixing in position '3M' make frosted glass film in stardust range fixed to glass as per pattern. Area of application to be measured as maximum length x maximum height of application on that particular piece of glass.	Sqm.	100		
21	BANK LOGO	BANK LOGO (SIZE -100 CM DIA)providing & fixing 12 mm th. Translucent arcylac of required size with proper LED lightening behind. The cutting should be done on CNC MACHINE with proper edge polishing made of measurement -per number.	No.	3		
22	WALLPAPER	Providing & fixing wall paper on wall / partition as per approval of Architect & Engineer. Wall paper basic rate : Rs 200/- per sqm	Sqm.	40		
		Total Excluding GST (A)				

ESTIMATE OF ELCTRICAL WORK FOR INDIAN BANK F.G.M. OFFICE, AT JANPATH, SHYAM NAGAR , JAIPUR.

	General Notes:-				
a)	Rates to include all scaffolding, carriage of materials to and from the site in lead of beyond 5 kms, and working in a running branch premises.				
b)	Wire Routing provided through the walls / floor / roof etc., rates to include cutting of wall and refinishing the same finely complete.				
c)	Points include complete length of wiring, conduiting and accessories upto designated places as per the design and drawings.				
d)	Electrical contractor shall have to make the layout for cutting of lights etc. at site.				
e)	All newly done electrical wiring/ DB/points/ earthing etc. will be used as per instructions of architect/ engineer.				
1.	<u>LIGHT & FAN POINTS:-</u>				
	P & F light points, fan points, call bell points, sockets etc. with 2 X 1.5 sq. mm. PVC insulated 1100 V grade FRLS, copper conductor wires and 1.0 sq. mm copper earth wire in concealed / surface using ISI mark medium guage MS pipes of 25 mm dia 1.50mm thick conduits accessories such as bends, tees saddles, draw boxes, mounting boxes, innerplates, cover plates, ceiling rose etc. (where ever required) and plug etc. The circuit wiring starting from DB to point control box / switch box using 2 X 2.5 sq. mm and 1.5 sq. mm earthing PVC insulated wiring color code to be provided. Identification ferrules at both end to be provided. (Flexible conduit / elbow NOT allowed). The conduits to be fixed in ceiling with proper clamps / wall / floor and felling the chase with cement mortar and finish the same in original form / wooden partition / above false ceiling with proper clamps (Wherever required as per standard specifications)				
	SWITCH & SOCKET - NORTH WEST (PC Plus)/ MK (Wrap around)/Anchor (Wood)/Havells (Crabtree)/ABB(Classic Luminia)/legrand Steel Conduit:- AKG/BEC/JINDAL/STEEL KRAFT				
	Notes:-				
	All wires shall be FRLS only (Polycab/RR/Finolex/KEI)				
	All material shall be approved make as mentioned in the tender.				
	Color codes must be maintained				
	No flexible conduit & elbows will be allowed.				
	Each circuit shall have independent earth wire.				
	Each point must be seperately earthed.				
	Circuit wiring is to be included in point wiring rates.				
	One S.B. can have max. 10-12 switch including 6 Amp. Socket				
	Boxes fixed in the wooden/ plywood partitions may be PVC				
(a)	One point controlled by one 6 Amp. Modular switch & switch board at SB level	Nos.	40		
(b)	Two points controlled by one 6 Amp. Modular switch & switch board at SB level	Nos.	20		
(c)	Three/ Four points controlled by one 6 Amp. Modular switch & switch board at SB level	Nos.	6		
(d)	Wall fan/ Exhaust fan point controlled by one 6 Amp. Modular switch & switch board at SB level and 6 Amp. 3 pin socket at designed place.	Nos.	15		
(e)	6 Amp. Socket with switch & light indicator at switch board places.	Nos.	15		
(f)	Call bell point with anchor make Ding Dong Bell	Nos.	4		

(h)	Emergency Light point (On UPS) (Including separate phase, neutral, earth) and to be in separate switch boards.	Nos.	15		
2.	<u>POWER POINTS</u> :-				
	Same as item no. 1, including providing & fixing 16 Amp. 6 pin sockets with 16 amps switch with wiring by using 2x2.5 sq. mm PVC insulated copper conductor wire with independent 1.5 sq. mm earth wire from D. B. to first 1st socket and 1st socket to 2nd socket with 2.5 sq. mm and 1.5 sq. mm earth wire including providing and Fixing complete in all respects.				
(a)	Power point (Direct) with 2x 4.0 sq mm copper conductor wires.	Nos.	15		
(b)	Power point (Loop) with 2x 2.5 sq mm copper conductor wires. (Only one or two loop points are allowed.)	Nos.	10		
3.	<u>A. C. POINTS</u> :- C&S/Havells/Legrand/HPL/ABB				
(a)	A.C. point wiring with 2 X 4.00 sq. mm insulated copper conductor wire (FRLS) & 1 X 2.5 sq. mm copper conductor wire for earthing from AC DB to AC point in 16 swg GI conduit AC point including supplying and fixing of module A.C. Box with 3 Pin metal clad pin top and 25/32 Amp. SP MCB "C" series. (Wiring must be from DB to stablizer to MCB near indoor unit to Indoor Unit.)	Nos.	12		
4.	<u>DISTRIBUTION BOARDS</u> :-				
	P & F sheet metal distribution boards of approved make double door type and making necessary connections etc complete with all MCBs of C series 10 KA. (LEGRAND/ SCHNEIDER/ SIEMENS/C&S/HPL)				
	All MCB`S must be 'C' series, 10 KA				
(a)	T P N 4 WAY DB :- (For Lighting) Having Incomer : 40 Amp. 4-P MCB OUT GOING : 10 Amp. SP MCB - 12 NOS	Nos.	1		
(b)	T P N 4 WAY DB :- (For Power/ AC) Having Incomer : 63 Amp. 4-P MCB GOING : 16 Amp. SP MCB - 12 NOS	Nos.	1		

(c)	T P N 4 WAY DB :- (For A.C.) INCOMER: 100 Amp. 4 P, Heavy Duty MCB S & F 4 way SP MCB 32 Amp MCB - 12 NOS (Out going)	Nos.	1		
(d)	S P N 12 WAY DB :- SP MCB 6 Amp = 10 Nos. DP MCB 63 Amp = 1 NOS.	Nos.	2		
(e)	S P N 4 WAY DB :- with two number 63/40 A DP MCB with enclousure	Nos.	1		
(f)	S P N 4 WAY DB :- TPN MCB 63 Amps	Nos.	2		
5.	<u>LIGHT & FAN FIXTURES</u> :-				
	P & F light fixture & accessories as per the following details and making connections, assembling, fixing, testing & installation with 3 years warranty. Following Fixtures including all accessories & extension chords as maybe necessary complete. All CFL / Flurescent fixtures (except down lighters) to be hung from the RCC ceiling by sitable chain / rods) all to fixture rates to include 3 years warranty. Including all removing, shifting, repairing, fixing, welding, cutting, instalation, testing, commissioning work of existing or proposed items for the folowing work. Including making good, proper finish of walls, floor and roof with masonary, R.C.C., plaster, pop, puty, primer, paint, etc. complete in all respects. Including color temp. for light fixtures must be 6500k. Dealer authorisation certificate with invoice detail required. Technical specification minimum 100 lumens per watt, Pf>.90, THD<20%				
(a)	Philips RC 380B LED Full glow 24" X 24" (6500K)/Halonix/Panasonic/Wipro	Nos.	35		
(b)	Philips Green LEDi 15 Watt DN 194 B (6500K)/Halonix/Panasonic/Wipro	Nos.	30		
(c)	Philips LED Tube lights 18 W/ 22 W (6500K) /Halonix/Panasonic/Wipro	Nos.	15		
(d)	mettalic Wall fan 400 mm - Crompton High flow of capacitor start, three speed wall mounting/cabin fan of following sweep with the help of anchor bolts including making connection testing etc. as required. Each wall fan should be connected through independent switch and socket of 6Amp.(Crompton/ Almonard/Havells)	Nos.	15		

(e)	Exhaust fan 300 mm - Crompton/ Almonard of Heavy duty capacitor start 1400 RPM single phase ISI marked Exhaust fan, IS:2312 marked including making opening if required, making connections testing etc. as required.(Crompton/ Almonard/ Usha/ Havells)	Nos.	8		
(f)	S& F of Rope Light with driver (Philips/ Bajaj/ HPL/ Osram/ Havells)	Rmts.	200		
(g)	P&F of ceiling Fan Metal body 4800 mm Sweep (Crompton/ USHA/ Bajaj)	Nos.	0		
(h)	Decorative spot led light of 1 watt to 5 watt led (6500K)/BAJAJ/philips/HAVELLS	Rmts.	18		
(i)	Decorative picture led light wall mounted of 3 watt to 5 watt led (6500K)/BAJAJ/philips/HAVELLS	Nos.	5		
6.	<u>CABLES WIRES</u> :-				
	P & L heavy duty armored cable on saddles wherever exposed and with aluminium lugs, cable termination with gland, aluminium lugs properly crimped, etc. complete. Including reusing of the existing cables wherever required as per direction of Bank Engineer/ Architect, vendor is bound to execute the items. All existing and proposed cables to be lay out in existing cable tray. Complete in all respects as per direction of Bank/ Architect.				
	XLPE Cable (Polycab/ Finolex/ RR/KEI)				
a)	3.50 core X 90 sq. mm Al. armoured cable with 2 X 8 SWG G.I. wire in PVC conduit for earthing including cables termination with gland, Al. lugs properly crimped of required size.	Rmts.	60		
b)	3.50 core X 35 sq. mm Al. armoured cable with 2 X 8 SWG G.I. wire in PVC conduit for earthing including cables termination with gland, Al. lugs properly crimped of required size.	Rmts.	40		
c)	3.50 core X 25 sq. mm Al. armoured cable with 2 X 8 SWG G.I. wire in PVC conduit for earthing including cables termination with gland, Al. lugs properly crimped of required size.	Rmts.	60		
d)	4.0 core X 10 sq. mm Aluminium Armoured cable for UPS to UPS DB including cables termination with gland, Al. lugs properly crimped of required size. (UPS OUTPUT TO UPS DB) & (UPS INPUT TO UPS DB)	Rmts.	100		
7.	<u>U.P.S. POINTS & CIRCUITS</u> :-				
	P & F ups points in 2 mm thick PVC conduit with 2 X 2.5 sq. mm insulated copper wire along with 1 X 1.5 sq. mm PVC insulated wire for earthing including bends, nipples, junction, M.S. switch boxes each to have 3 nos. 6 A 5 pin modular socket 1 X 6 A indicator controlled by 1 X 16 A modular type switch compl fine finish incl. making necessary connection & start of equipment as per details. Complete in all respects as per direction of Engineer/ Architect. Make as specified above)				
(a)	DIRECT POINT	Nos.	35		
(b)	LOOP POINT (Only one point to be loop.)	Nos.	20		
8.	<u>EARTHING</u> :- (Ashlok, JK, Ash, REIL)				
(a)	Supply and installation of pipe-in-pipe technology Copper Earth Electrode earthing system modelt-39 with outer diameter of 80 mm length 2000 mm embedded in the soil with masonry inspection pit along with cover etc. complete in all respect. The work should be got carried out through bank's authorized Company only. Each pit installation test certificate to be submitted after measurement of earth resistances as per the provision in IS 3043 (ups out DB earthing). The inspection pit should be visible and at a proper place.	Nos.	2		

(b)	Supply and installation of pipe-in-pipe technology ASHLOK Copper Earth Electrode earthing system modelt-T19 with outer diameter of 50mm length 2000 mm embedded in the soil with masonry inspection pit along with cover etc. complete in all respect. The work should be got carried out through bank's authorized vender only. Each pit installation test certificate to be submitted after measurement of earth resistances as per the provision in IS 3043 (Panel ups input DB earthing).	Nos.	1		
(c)	P & L 2 X 8 SWg copper earth wire at designated place in PVC conduit (Pit to Panel/ Pit to UPS)	Mtrs.	150		
9.	<u>MAIN PANEL</u> :-				

	Designing manufacturing, installing, testing and commissioning of cubical type MAIN PANEL CPRI approved made from 16 SWG CRCA sheet steel, "type base M.S. channel for grouting on floor complete with MCCB, MCBs, meters, C.T., etc. complete in all respect, insulated bus bar with near shrinkable PVC sleeve in suitable bus bar chamber, wiring, name plates, danger plates, earth bus etc. & comprising of compartments with hinged doors and rubber gasket, bus bar chamber with bolted door and rubber gasket etc. the panel being of dust & vermin proof construction and to be painted with primer and smoke gray paint (minimum two coats) to look attractive. The panel should be comprising with the following : (Degree of Protection IP-54)	Nos.	1		
	INCOMER: -				
	ALL MCCB SHOULD HAVE 25 KA SHORT CIRCUIT CURRENT CAPACITY (C-				
(i)	250 Amp 4 - P, MCCB (3 Phase) 1 Nos.				
(ii)	150 Amp 4 - P, ON LOAD change over switch				
(iii)	300 Amp. Capacity aluminum bus bar for ATM & system room heat shrinkable proper insulation with heat shrinkable proper insulation with color coded. Analog ammeter and voltmeter with selector switches three number indicating lamp R-Y-B Phase indicators with 2 amp. back up HRC fuses & Energy Meter with KWH and PF indication (Back up Fuse protection)				
	OUT GOING : -				
	ALL MCCB SHOULD HAVE 25 KA SHORT CIRCUIT CURRENT CAPACITY				
	DOUBLE BUS BAR PANEL				
	DG SUPPLY ONLY FOR LIGHT, POWER, UPS, ATM ONLY				
	A.C. SHOULD NOT OPERATE ON DG SUPPLY				
	All MCCB must have 25 KA S.C. current capacity				
	All outgoing feeder should have separate door and compartment.				
	Each outgoing feeder shall be with indicator.				
(i)	100 Amp 4 - P, MCCB (3 Phase) 2 Nos. (A.C.)				
(ii)	63 Amp 4 - P, MCCB (3 Phase) 4 Nos.				
	(Power, light. A.T.M., UPS)				
(iii)	16 Amp DP, MCB (1 on each Phase) 2 Nos.				
(iv)	63 Amp 4 - P, MCB (3 Phase) 4 Nos.				
10	TELEPHONE POINT :-				
a)	S,F,T,I,C, Etc. of telephone tag box (krone) suitable for 50 pair housed in GI box with cover of suitable size including termination.	Nos.	1		
b)	S, L, T, I, C Telephone point with 4 pair telephone cable from main supply to various counters, tables, walls, partitions, etc.with colour coding identification on both ends. Including 0.6 mm dia annealed with tinned screen protected CU conductor PCC sheathed 2 pair telephone cable in PVC conduit 2.00 mm thk. conduit as required. Including S & F modular type plate with telephone outlet box and RJ-11 sockets with housed in zinc passivated box/ PVC box with suitable connector strip in recessed wall/ partition as required. S & F modular type telephone outlet 1 pair coaded outlet.	Nos.	25		
11	NETWORKING POINT :-				
	Computer networking points with 4 pair, 24 AWG UTP Cat 6 Cable as per latest ammendments of TIA /EIA 568 B.2-1 Specifications in PVC Conduits including making connections to Information outlets and Patch Panels with ferruling at both ends for identifica				

(a)	Computer networking points with 4 pair, 24 AWG UTP Cat 6 Cable as per latest ammendments of TIA /EIA 568 B.2-1 Specifications in PVC Conduits including making connections to Information outlets and Patch Panels with ferruling at both ends for identification with necessary tools for punching, stripping, crimping and testing required. Cost including Faceplate for Flush Mount Information Outlets Single Aperture with screw hole covers & Icon Tree Size 86mmX86mm including pvc/ ms box. (Cat 6 cable: Molex/ Avaya/Penduit/AMP) (Face plate i/o : Molex/ Avaya/Penduit/AMP)	Nos.	60		
(b)	Supply , Installation and Testing of 4 pair , 100 Ohm, 24 AWG , E Cat 5 UTP, flexible , Double ended Patch Cords along with 2 No of RJ 45 connectors with strain relief boots as per TIA /EIA 568 B.2 Specifications including making connections to Inform outlets of lengths.				
	1.0 Meter as required .Molex/ Avaya/Penduit/AMP)	Nos.	40		
	2.0 Meter as required. Molex/ Avaya/Penduit/AMP)	Nos.	40		
(c)	P,F,T,I,C, Etc. of Data/ server rack of 16 U Rack with all required PATCH PANEL /accessories i.e. PDU unit, exhaust fan complete in all respect.	Nos.	1		
(d)	24 port patch panel for rack with all accessories	Nos.	2		

12	MUSIC - CUM - PA - SYSTEM				
a)	S & I of point wiring for music - cum PA system comprising of 2x 1.0 sqmm stranded , copper conductor , flexible PVC insulated and PVC Sheathed wire pulled through 20 mm dia .PVC heavy gauge conduits and looped from one speaker to other and to the volume control and control switch wherever applicable and finally terminated at Tag Block.	pts	6		
b)	S & I of Philips / Bosch/Ahuja make music speaker 24 w flush mounted on the false ceiling with proper clamping arrangement	Nos.	6		
c)	S & I of volume control - cum - ON - OFF switch flush mounted on wall along with other electrical switches .The size and plate of the regulating knob should match with other switches nearby (MK make)	Nos.	1		
d)	S & I of 100 Watts BOSCH/Ahuja make Central Music System Amplifier and MP3/CD Player with FM facility of make Samsung/Onida/LG	set	1		
		Total Electrical work (B)			

ESTIMATE OF AR CONDITIONING WORK FOR INDIAN BANK F.G.M. OFFICE, AT JANPATH, SHYAM NAGAR ,
JAIPUR.

Sr. No	Description	Unit.	Qty.	Rate	Amount
	OUTDOOR UNIT'S				
1.0	Supply of Modular type outdoor units, with all BLDC scroll Inverter compressor for cooling and heating application. The unit must runs with two no's of inverter compressors above 16HP along with the same shall having minimum COP of 3.7 at standard condition at 100% load. All inverter capacity controlling compressor is suitable for 380~415 volts, 3 Phase, 50 Hz. Condenser Fins should have factory anticorrosive coating treatment and same treatment should have third party certification from UL/TUV under the standard Salt Spray test method of ISO21207. All ODU unit compressors should have inbuilt oil level sensor so as to ensure reliable oil return technology to further add additional safety for Compressor. The manufacturer must be an OEM of its compressors and should be having manufacturing and NABL certified testing facility in India. The Outdoor PCB should be having the technology to be cooled by refrigerant. Outdoor unit must not having any de-ration up to 39 deg ambient and should have wide operation range from -5° C to 53° C. The outdoor unit must have the feature of Record running parameters of last 3 minutes before failure, for fault analysis & easy and faster trouble shooting.. Make:-				
a	26 HP (Heating & Cooling)	Nos	1		
2	INDOOR UNIT'S				
	Supply, of Indoor units equipped with pre-filter, fan section with suitable static fan, multispeed motor, coil section with DX coil, outer cabinet, drain pan, insulation, pipe connections etc. of various capacities as per specifications including wireless remote.				
	4 WAY CASSETTES UNIT.				
a	1.0 Tr Cassette 4 Way	Nos	4		
b	2.0 Tr Cassette 4 Way	Nos	2		
c	3.0 Tr Cassette 4 Way	Nos	6		
3	ACCESSORIES.				
	Y Branch IDU	Nos	10		
4	ITC FOR OUTDOOR UNIT				
	26 HP (Heating & Cooling) cost to include complete installation, testing, commissioning including gas filling charges	Nos	1		
5	ITC FOR INDOOR UNIT'S instalation only				
	4 WAY CASSETTES UNIT.(840 x 840)				
a	1.0 Tr Cassette 4 Way	Nos	4		
b	2.0 Tr Cassette 4 Way	Nos	2		

c	3.0 Tr Cassette 4 Way	Nos	6		
6	Refrigerant Piping for VRV / VRF System				
a	Supply, installation, testing and commissioning of interconnecting high pressure copper refrigerant piping work suitable for refrigerant R 410A duly insulated with XLPE Class O plain type tubular insulation between indoor & outdoor units as per specifications. existing pipe upto 19.1 mm shall have 13 mm insulation thick and above shall have 19 mm insulation thick complete as per specification as required by the company specifications. bidder has to submit drawings and piping plan approved by the company and architect prior to start the work	Rmt	250		
7	Condensate Drain Piping				

	Supplying, installing, testing and commissioning, rigid PVC (Drain) piping complete with fittings, supports as per specifications and duly insulated with 6 mm thick closed cell nitrile.				
a	25 mm dia pipe, Insulation Thickness - 6 mm	Mtr.	60		
b	32 mm dia pipe, Insulation Thickness - 6 mm	Mtr.	60		
8	TRANSMISSION WIRING.				
	Supplying and drawing following sizes of PVC insulated Copper conductor cables of 1.1 KV Grade in the existing surface PVC conduit as required				
a	2C x 1.5 Sq mm Unarmoured (For Transmission)	Mtr.	250		
9	Lifting and Shifting of Outdoor Unit	Nos	1		
10	Odu Stand	Nos	1		
Basic Total Amount Installation (GST Extra)					

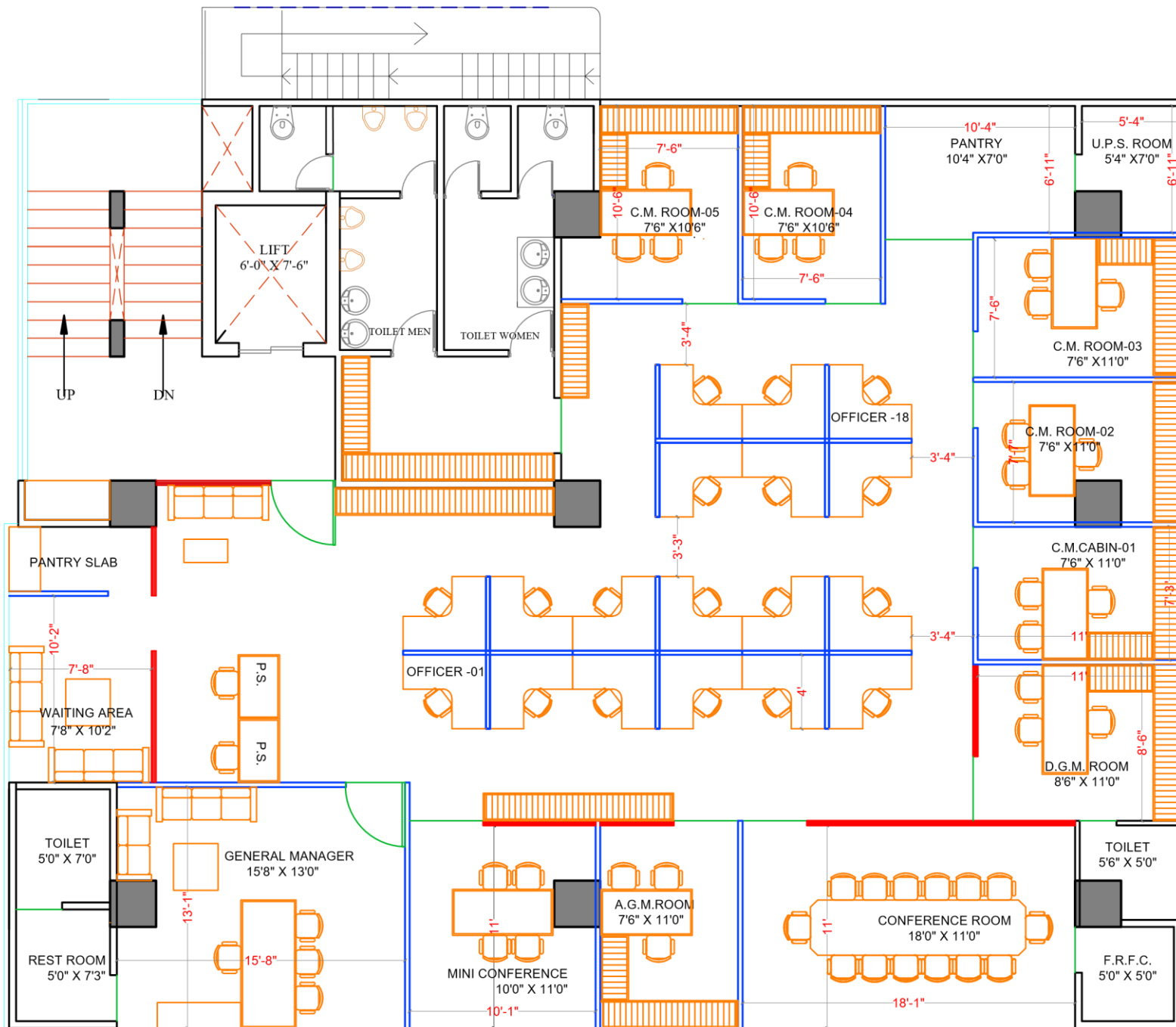

REVISED PROPOSAL
PLAN-06

PROPOSED INTERIOR FOR :-
INDIAN BANK,
FGMO , JANPATH,
SHYAM NAGAR, JAIPUR.

YASH GARG DESIGNER'S

ARCHITECTS
PLANNERS
INTERIOR DESIGNERS
LANDSCAPERS

106, NANDPURI COLONY,
MALVIYA NAGER ,
JAIPUR 302017.
PH.NO: 9929595589
E-MAIL:
yashgarg_2004@yahoo.co.in

DATE
13-12-2025

SCALE:-
N.T.S.

DWG.NO.
P.P. 03

PROJ.NO.
IN 21.01.27

N
W
S
E

THIS DRAWING AND DESIGN IS THE SOLE PROPERTY OF ARCHITECT YASH GARG AND SHALL NOT BE TRACED COPIED REPRODUCED MODIFIED LENT OR MADE UNAUTHORISED USE OF IN ANY OTHER MANNER WITHOUT THE WRITTEN PRIOR CONSENT OF THE ARCHITECT